

# U-LINE

COMMERCIAL





# Cultivated Experience

As a leading American manufacturing expert since 1962, U-Line is known for our advanced refrigeration systems, meticulous engineering, and comprehensive expertise across multiple markets including hospitality, foodservice, marine, and residential. Since our founding, the United States Patent and Trademark Office has issued over 50 patents to U-Line.

U-Line is also backed by the largest global manufacturer of commercial kitchen equipment, Middleby Corporation. Middleby products are chosen by 97 out of 100 U.S. food service chains. Middleby's patented innovations have earned top industry and customer awards, including Equipment Supplier of the Year.

*Our commercial products & components  
are used in America's largest coffee chains,  
retail giants, and restaurants.*

**U-LINE**  
COMMERCIAL

Explore our Commercial Collection at [u-line.com/commercial](http://u-line.com/commercial).



# Agile Solutions

Our lineup offers modular and scalable solutions for hotels, restaurants, stadium suites, bars, serving stations, entertainment areas and other commercial applications. Our Commercial Collection offers a robust design with modern features:

- Durable stainless steel construction
- Versatile installation options
- Convection cooling for optimal air flow and temperature regulation
- 1-year parts and labor warranty; 5-year sealed system parts warranty

*We offer solutions for a variety of applications, currently including over 50 models, with more to come.*

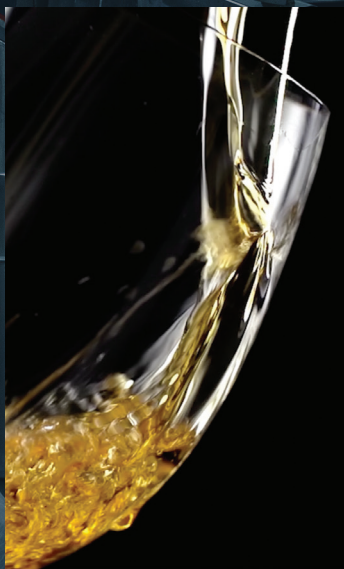





## Refrigerators & Wine Refrigerators

Available in 15", 18", and 24" footprints, our undercounter options allow you to have what you need, where you need it most.



## Dispensers

Creamy nitro cold-brew, refreshing beer, and chilled wine on-tap with our 15" and 24" ready-to-serve dispensing options that accommodate a variety of keg sizes and tanks.



## Ice Machines

Serve the ever-popular nugget ice in your beverages and cocktail creations. Customize the ice density from soft and chewable to dense and compact with multiple adjustable ice settings.



## Back Bar Refrigeration

With configurable options and multiple sizes, our refrigeration stations provide higher capacity refrigeration storage, fully stocked with the latest technology and adjustable interiors.



## Reach-In Refrigerators & Freezers

Preserve produce, meats, and everything in between in varying size options with solid and glass door configurations.



## Base & Multi-Door Refrigerators & Freezers

Convenient undercounter access to chilled & frozen items. Perfect for chef stations, bars, and beyond.



## Blast Freezers/Chillers

Rapidly chill ingredients for culinary creations. Powerful functionality fit for your space.



## Pizza & Food Prep Table Refrigerators

Complete food preparation stations perfect for assembly of pizzas, sandwiches, and more.



## U-Chill®

The incredible in-counter cooling cylinder designed to take serving chilled bottles to the next level. U-Chill® sets any space apart from the rest.





## Product Specifications

# Configurable Back Bar Refrigeration



CBR532-SS



CBR552-SS



CBR572-SS



CBR592-SS



CBR532-SG



CBR552-SG



CBR572-SG



CBR592-SG

Project:	Notes:
----------	--------

### Features

- Convection cooling system provides a quick cool down and consistent temperature
- Stainless steel inside and out
- Temperature range: 33°F - 70°F
- Bright white & blue LED interior lighting
- Automatic defrost
- Field reversible door(s) with lock(s)
- Adjustable coated wire shelves
- High efficiency compressor
- NSF/ANSI Standard 7 compliant

### Specifications

Model	CBR532/CBR632	CBR552/CBR652	CBR572/CBR672	CBR592/CBR692
Dimensions	34 9/16" H x 32" W x 24 3/4" D	34 9/16" H x 52" W x 24 3/4" D	34 9/16" H x 72" W x 24 3/4" D	34 9/16" H x 92" W x 24 3/4" D
Internal Volume	6.25 cu ft	12.52 cu ft	19.74 cu ft	28.5 cu ft
Refrigerant	R600a (2.12 oz)	R290 (4.06 oz)	R290 (4.06 oz)	R290 (4.06 oz)
Running Amps	1.7	1.7	2.0	2.0





## Product Specifications

### Configurable Back Bar Refrigeration

Model Details			
Model	Description	Voltage/Hz	Shipping Weight
UCBR532-SS01A	32" Back Bar, 1 Solid Door, Lock, Condenser Right, 3 Wire Shelves, Solid Top, Stainless Steel	115v / 60hz	302 lb
UCBR552-SS01A	52" Back Bar, 2 Solid Doors, Locks, Condenser Right, 6 Wire Shelves, Solid Top, Stainless Steel	115v / 60hz	382 lb
UCBR572-SS01A	72" Back Bar, 3 Solid Doors, Locks, Condenser Right, 9 Wire Shelves, Solid Top, Stainless Steel	115v / 60hz	496 lb
UCBR592-SS01A	92" Back Bar, 4 Solid Doors, Locks, Condenser Right, 12 Wire Shelves, Solid Top, Stainless Steel	115v / 60hz	542 lb
UCBR532-SG01A	32" Back Bar, 1 Glass Door, Lock, Condenser Right, 3 Wire Shelves, Solid Top, Stainless Steel	115v / 60hz	302 lb
UCBR552-SG01A	52" Back Bar, 2 Glass Doors, Locks, Condenser Right, 6 Wire Shelves, Solid Top, Stainless Steel	115v / 60hz	382 lb
UCBR572-SG01A	72" Back Bar, 3 Glass Doors, Locks, Condenser Right, 9 Wire Shelves, Solid Top, Stainless Steel	115v / 60hz	496 lb
UCBR592-SG01A	92" Back Bar, 4 Glass Doors, Locks, Condenser Right, 12 Wire Shelves, Solid Top, Stainless Steel	115v / 60hz	542 lb
UCBR632-SS01A	32" Back Bar, 1 Solid Door, Lock, Condenser Right, 3 Wire Shelves, 1 Tap & Drain Hole, Stainless Steel	115v / 60hz	302 lb
UCBR652-SS01A	52" Back Bar, 2 Solid Doors, Locks, Condenser Right, 6 Wire Shelves, 1 Tap & Drain Hole, Stainless Steel	115v / 60hz	382 lb
UCBR672-SS01A	72" Back Bar, 3 Solid Doors, Locks, Condenser Right, 9 Wire Shelves, 2 Taps & Drain Holes, Stainless Steel	115v / 60hz	496 lb
UCBR692-SS01A	92" Back Bar, 4 Solid Doors, Locks, Condenser Right, 12 Wire Shelves, 2 Taps & Drain Holes, Stainless Steel	115v / 60hz	542 lb

**Factory build options include:** Condenser on left side, glass & solid door combinations

Accessories		
Model	Description	Shipping Weight
ULACOMLEGS4	4, 6" Adjustable leveling legs for CBR532 & CBR552	10 lb
ULACOMLEGS6	6, 6" Adjustable leveling legs for CBR572 & CBR592	14 lb
ULACOMCASTERS4	4, 6" Casters for CBR532 & CBR552	12 lb
ULACOMCASTERS6	6, 6" Casters for CBR572 & CBR592	17 lb
ULASHELF24	Slide out metal shelf	9 lb
ULAWINERACK24	Slide out wine rack	8 lb
ULABIN24	Slide out bin	9 lb
ULATAPSINGLE	Single Beer Tap Tower Kit	20 lb
ULATAPDOUBLE	Double Beer Tap Tower Kit	24 lb
ULABACKBARCOFFEE2	2 Tap Nitro Coffee Kit	10 lb
ULABACKBARCOFFEE3	3 Tap Nitro Coffee Kit	11 lb
ULABACKBARCOFFEE4	4 Tap Nitro Coffee Kit	12 lb
ULAWINETAP1	Single Tap, Low Profile Coupler, Regulator, & Nitrogen Tank	16 lb
ULAWINETAP2	Double Tap, Low Profile Coupler, Regulator, & Nitrogen Tank	20 lb





# Product Specifications

## Configurable Back Bar Refrigeration

**CBR532**

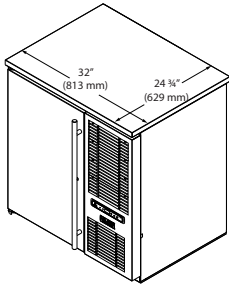

**CBR552**

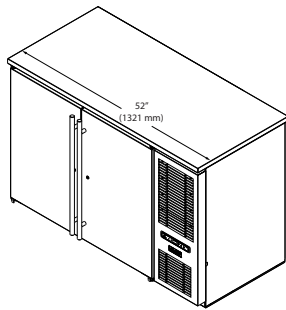

**CBR572**

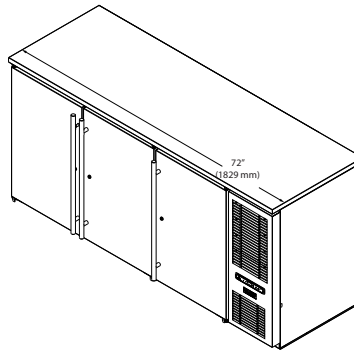

**CBR592**

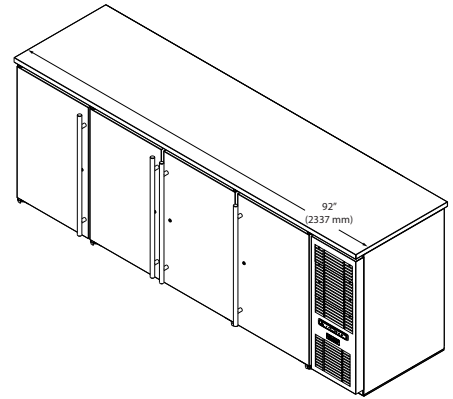

**Side**

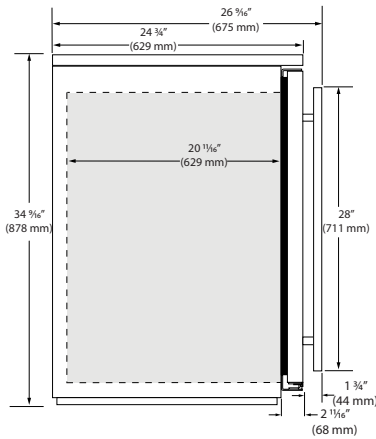

**Front**

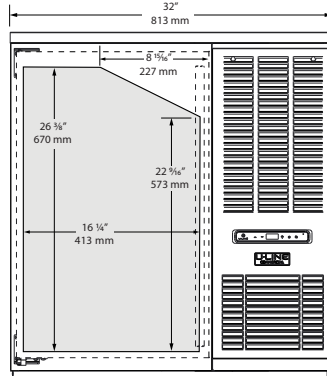

**Top**

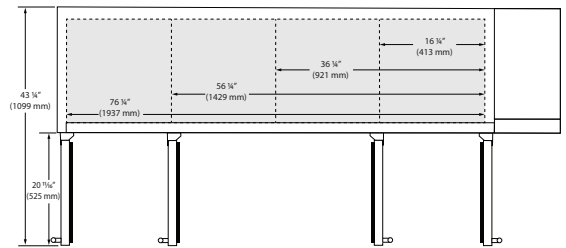

### Tower 2 3/4" (70 mm)/Drain 1" (25 mm) Location

### Back Panel

**CBR672**

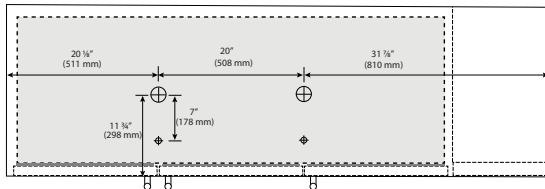

**CBR652**

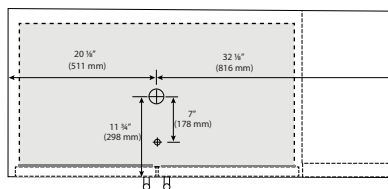

**CBR692**

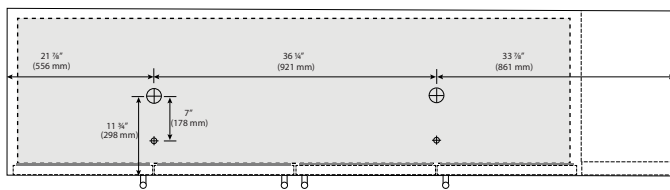

**CBR632**

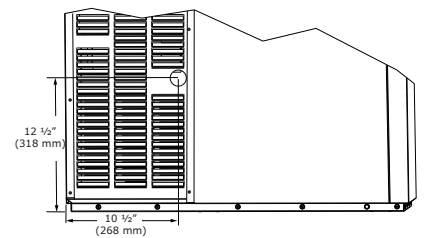
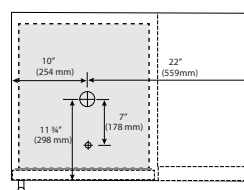

### Commercial Warranty

1 Year (parts & labor) / 5 year sealed system (parts)  
See complete warranty for details

### Notes

- Dimensions/image shown are for refrigeration unit on right



## Product Specifications

# 15" Refrigerators / Wine Refrigerators

CRE515: 15" Refrigerator

CWC515: 15" Wine Refrigerator



CRE515-SG CRE515-SS CWC515-SG CWC515-SS

Project:	Notes:
----------	--------

### Features and Specifications

Convection cooling system provides a quick cool down and consistent temperature			
U-Adjust™ Interior: 19 possible positions			
Refrigerator models include 2 slide-out metal shelves			
Wine Refrigerator models include 5 slide-out wine racks			
Stainless steel cabinet, grille, and full-wrap door with lock			
Full-depth lower interior with a volume of 2.9 cu ft			
Dimensions: 33 11/16" H x 14 15/16" W x 22 15/16" D			
Designed for built-in or freestanding applications			
Temperature range: 34°F - 70°F			
High efficiency variable speed compressor with 1.2 running amps			
Environmentally friendly R600a refrigerant			
UCRE515-SG: 1.06 oz	UCRE515-SS: 1.23 oz	UCWC515-SG: 1.06 oz	UCWC515-SS: 1.23 oz

### Model Details

Model	Description	Voltage/Hz	Shipping Weight
UCRE515-SG33A	Refrigerator 15" Reversible Hinge Stainless Glass	115v / 60hz	108 lb
UCRE515-SS33A	Refrigerator 15" Reversible Hinge Stainless Solid	115v / 60hz	96 lb
UCWC515-SG33A	Wine Refrigerator 15" Reversible Hinge Stainless Glass	115v / 60hz	111 lb
UCWC515-SS33A	Wine Refrigerator 15" Reversible Hinge Stainless Solid	115v / 60hz	99 lb

### Accessories

Model	Description	Shipping Weight
ULACASTERKIT15	15" Caster Kit for UCWC & UCRE	13 lb
ULAWINERACK15	Slide-out rack	8 lb
ULABIN15	Slide-out bin	9 lb
ULASHELF15	Slide-out metal shelf	4 lb





## Product Specifications • 15" Refrigerators / Wine Refrigerators

**Top**

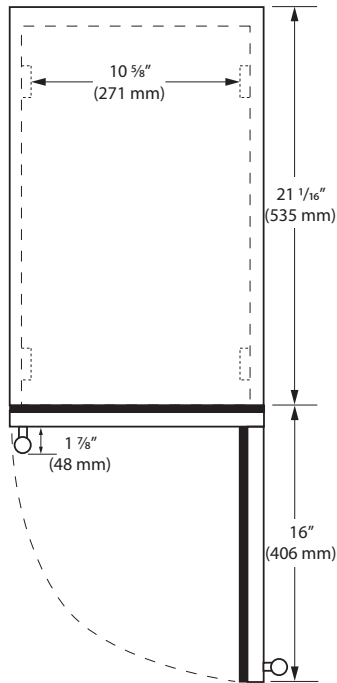

**Front**

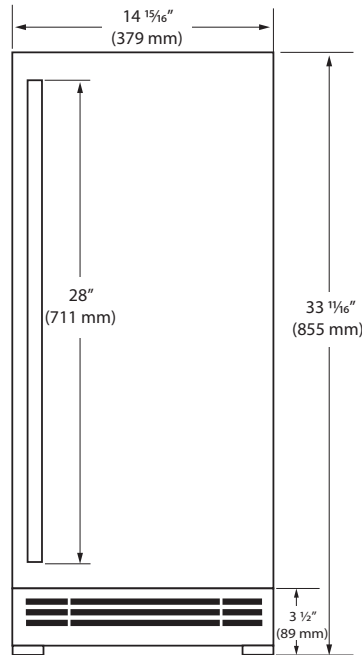

**Side**

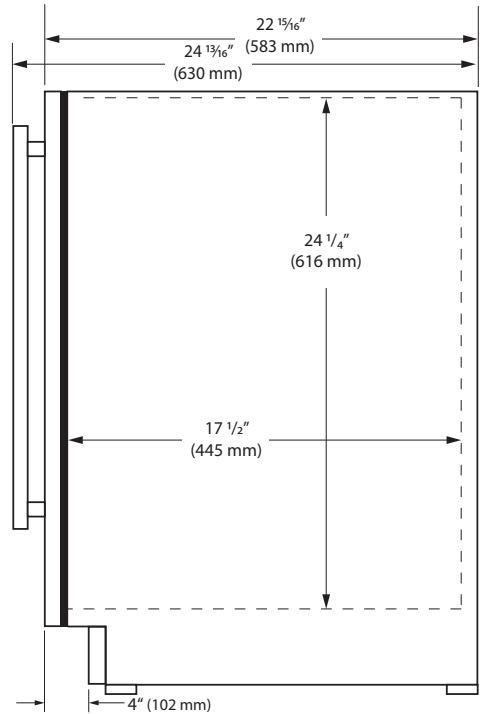

**Back**

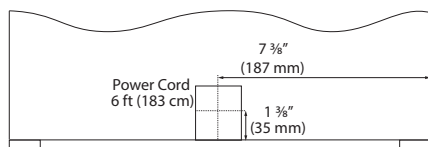

**Cabinet Cut-Out**

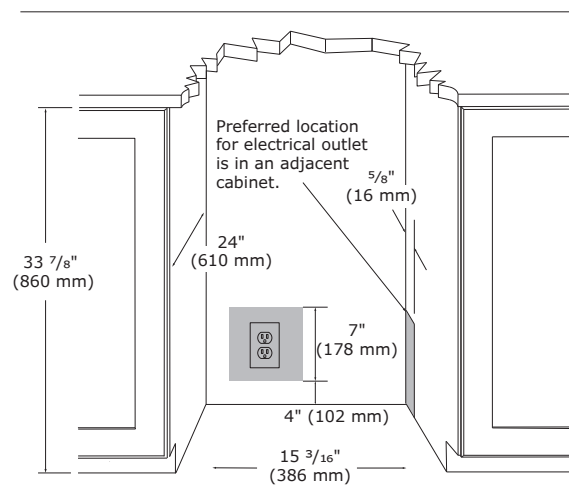

### Commercial Warranty

1 Year (parts & labor) / 5 year sealed system (parts)  
See complete warranty for details

### Installation Notes

- Power cord extends 2" beyond total depth
- No additional clearance is needed for ventilation
- Do not obstruct front grille air flow



## Product Specifications

# 18" Refrigerators / Wine Refrigerators

CRE518: 18" Refrigerator

CWC518: 18" Wine Refrigerator



CRE518-SG



CRE518-SS



CWC518-SG



CWC518-SS

Project:	Notes:
----------	--------

Features and Specifications			
Convection cooling system provides a quick cool down and consistent temperature			
U-Adjust™ Interior: 19 possible positions			
Refrigerator models include 2 slide-out metal shelves			
Wine Refrigerator models include 5 slide-out wine racks			
Stainless steel cabinet, grille, and full-wrap door with lock			
Full-depth lower interior with a volume of 3.7 cu ft			
Dimensions: 33 1/16" H x 17 3/4" W x 22 15/16" D			
Designed for built-in or freestanding applications			
Temperature range: 34°F - 70°F			
High efficiency variable speed compressor with 1.2 running amps			
Environmentally friendly R600a refrigerant (amounts below)			
UCRE518-SG: 1.23 oz	UCRE518-SS: 1.34 oz	UCWC518-SG: 1.23 oz	UCWC518-SS: 1.34 oz

Model Details			
Model	Description	Voltage/Hz	Shipping Weight
UCRE518-SG33A	Refrigerator 18" Reversible Hinge Stainless Glass	115v / 60hz	131 lb
UCRE518-SS33A	Refrigerator 18" Reversible Hinge Stainless Solid	115v / 60hz	118 lb
UCWC518-SG33A	Wine Refrigerator 18" Reversible Hinge Stainless Glass	115v / 60hz	134 lb
UCWC518-SS33A	Wine Refrigerator 18" Reversible Hinge Stainless Solid	115v / 60hz	121 lb

Accessories		
Model	Description	Shipping Weight
ULACASTERKIT18	18" caster kit - for UCWC & UCRE	13 lb
ULAWINERACK18	Slide-out wine rack	8 lb
ULABIN18	Slide-out bin	9 lb
ULASHELF18	Slide-out metal shelf	4 lb





# Product Specifications • 18" Refrigerators / Wine Refrigerators

## Top

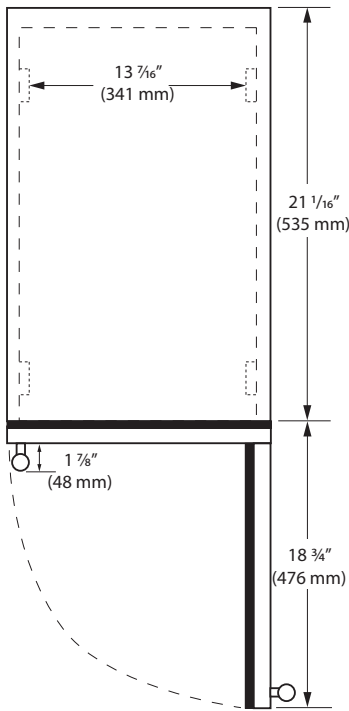

## Front

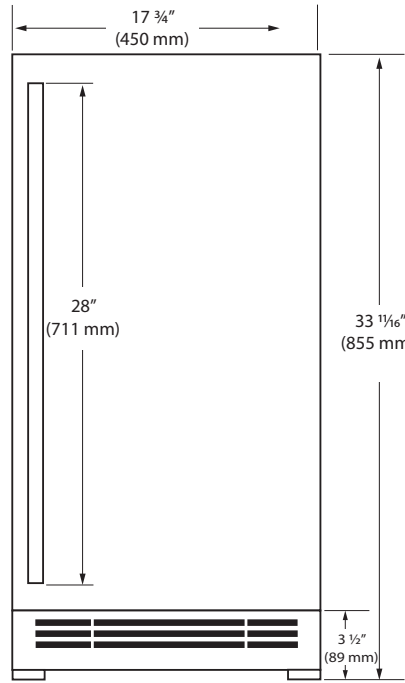

## Side

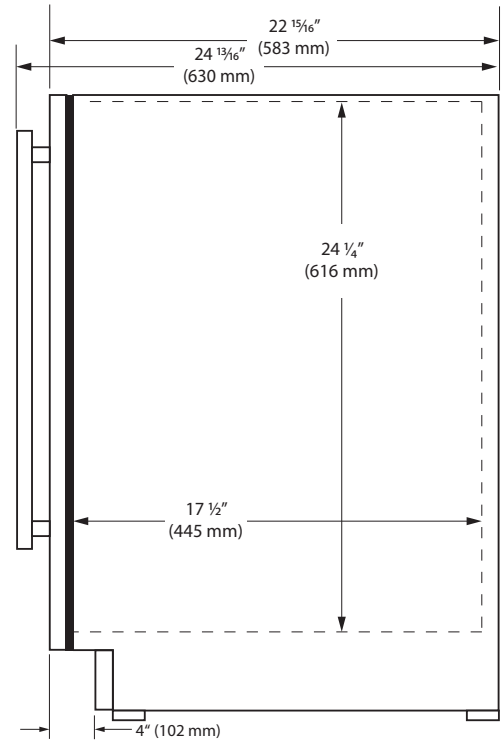

## Back

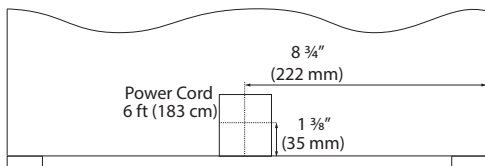

## Cabinet Cut-Out

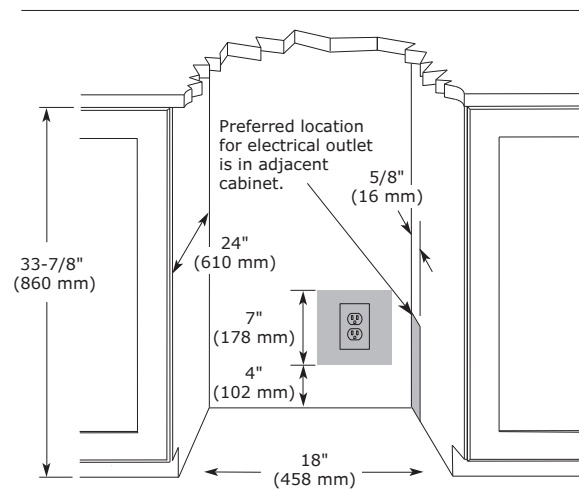

### Commercial Warranty

1 Year (parts & labor) / 5 year sealed system (parts)  
See complete warranty for details

### Installation Notes

- Power cord extends 2" beyond total depth
- No additional clearance is needed for ventilation
- Do not obstruct front grille air flow

### 24" Refrigerators / Wine Refrigerators

CRE524: 24" Refrigerator

CWC524: 24" Wine Refrigerator



CRE524-SG



CRE524-SS



CWC524-SG



CWC524-SS

Project:	Notes:
----------	--------

#### Features and Specifications

Convection cooling system provides a quick cool down and consistent temperature			
U-Adjust™ Interior: 19 possible positions			
Refrigerator models include 2 slide-out metal shelves			
Wine Refrigerator models include 5 slide-out wine racks			
Stainless steel cabinet, grille, and full-wrap door with lock			
Full-depth lower interior with a volume of 5.2 cu ft			
Dimensions: 33 1/16" H x 23 5/8" W x 22 1/16" D			
Designed for built-in or freestanding applications			
Temperature range: 34°F - 70°F			
High efficiency variable speed compressor with 1.2 running amps			
Environmentally friendly R600a refrigerant (amounts below)			
UCRE524-SG: 1.34 oz	UCRE524-SS: 1.06 oz	UCWC524-SG: 1.34 oz	UCWC524-SS: 1.59 oz

#### Model Details

Model	Description	Voltage/Hz	Shipping Weight
UCRE524-SG33A	Refrigerator 24" Reversible Hinge Stainless Glass	115v / 60hz	165 lb
UCRE524-SS33A	Refrigerator 24" Reversible Hinge Stainless Solid	115v / 60hz	150 lb
UCWC524-SG33A	Wine Refrigerator 24" Reversible Hinge Stainless Glass	115v / 60hz	168 lb
UCWC524-SS33A	Wine Refrigerator 24" Reversible Hinge Stainless Solid	115v / 60hz	153 lb

#### Accessories

Model	Description	Shipping Weight
ULACASTERKIT24	24" caster kit - for UCWC & UCRE	13 lb
ULAWINERACK24	Slide-out wine rack	8 lb
ULABIN24	Slide-out bin	9 lb
ULASHELF24	Slide-out metal shelf	4 lb





# Product Specifications • 24" Refrigerators / Wine Refrigerators

**Top**

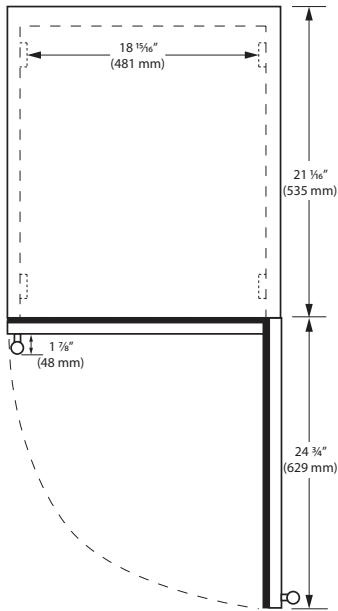

**Front**

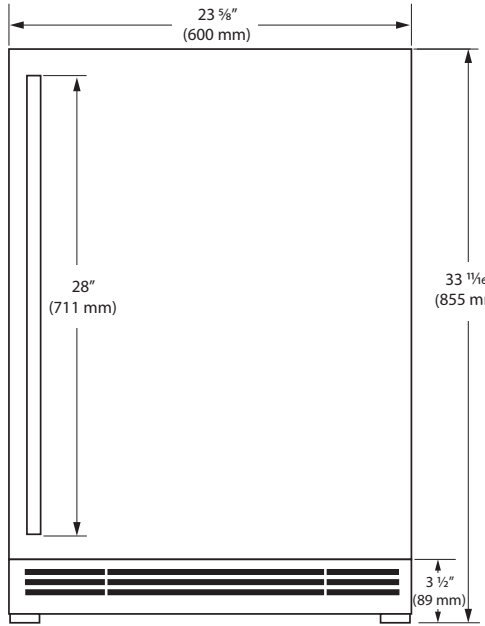

**Side**

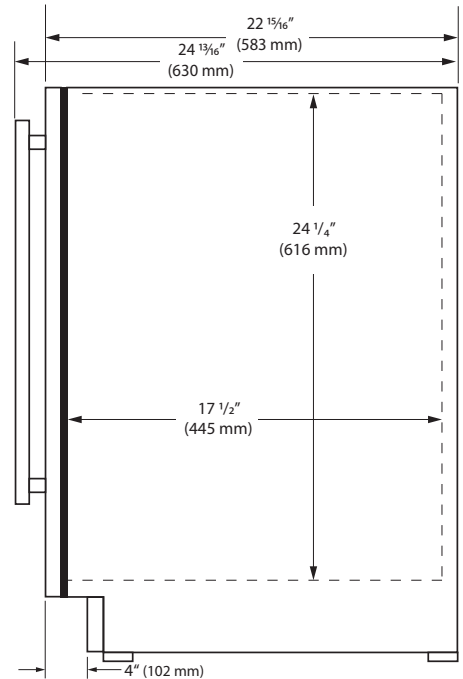

**Back**

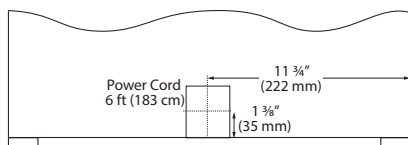

**Cabinet Cut-Out**

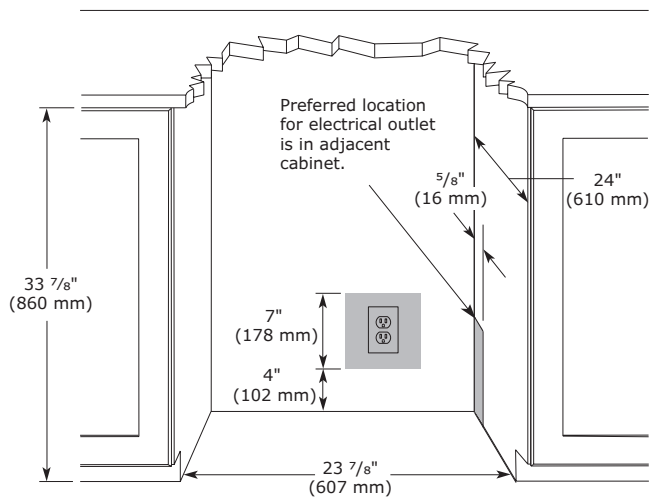

## Commercial Warranty

1 Year (parts & labor) / 5 year sealed system (parts)  
See complete warranty for details

## Installation Notes

- Power cord extends 2" beyond total depth
- No additional clearance is needed for ventilation
- Do not obstruct front grille air flow

CDE215H: Tap 1: Nitro Coffee • Tap 2: Still Coffee

CDE215F: Tap 1: Beer



Coffee dispensers utilize patent-pending technology trusted by America's largest coffee chain



CDE215H

CDE215F

Project:	Notes:
----------	--------

### Features and Specifications

Includes: refrigeration cabinet, dispensing tower, tubing, hardware, black tap handles, drip tray, and casters		
Convection cooling system provides a quick cool down and consistent temperature		
Stainless steel cabinet, grille, and full-wrap door		
Full-depth lower interior with an interior volume of 3.6 cu ft		
Removable lower interior stainless steel liner		
CDE215H holds up to one 5 gallon cornelius keg & one 10 lb / 38 cu ft nitro tank		
CDE215F holds up to one 1/6 barrel & one 10 lb / 38 cu ft CO <sup>2</sup> tank		
Cabinet Dimensions: 34 1/2" H x 15" W x 25 15/16" D (see diagram for tower heights)		
Temperature range: 34°F - 60°F		
Designed for built-in or freestanding applications		
High efficiency variable speed compressor with 1.2 running amps		
Environmentally friendly R600a refrigerant	CDE215H: (1.06 oz)	CDE215F: (1.23 oz)

### Model Details

Model	Description	Voltage/Hz	Shipping Weight
UCDE215HSS03A	Cold Coffee 2 Dispenser 15" Reversible Hinge Stainless Solid	115v / 60hz	86 lb
UCDE215FSS03A	Beer 1 Dispenser 15" Reversible Hinge Stainless Solid	115v / 60hz	80 lb

### Accessories

Model	Description	Shipping Weight
ULANITROTANK	22 cu ft Aluminum Nitro Tank	5 lb
ULACOFFEEKEG	2.5 gal Coffee Keg	6 lb
ULANITROREG	Nitrogen Regulator	3 lb
ULACOFFEECLEAN	Coffee Dispenser Cleaner (1 Box of 5 Packets)	1 lb





# Product Specifications • 15" Dispensers

## Top

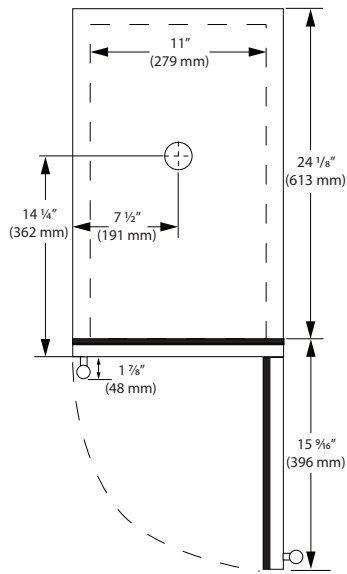

## Front

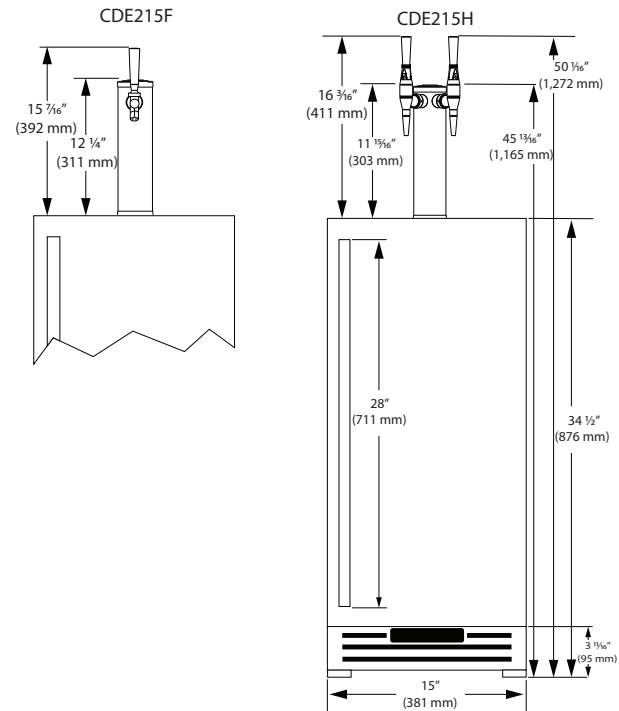

## Back

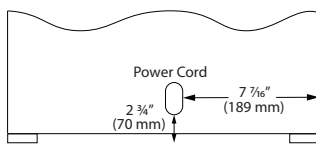

## Side

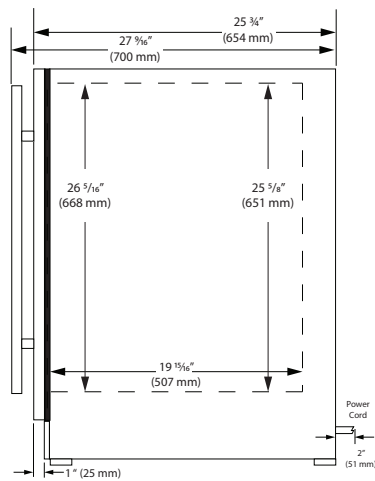

## Cabinet Cut-Out

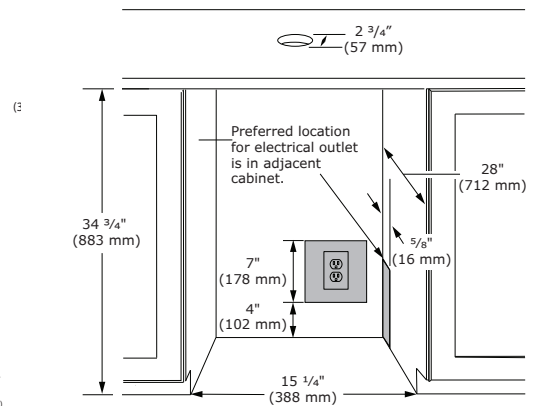

## Commercial Warranty

1 Year (parts & labor) / 5 year sealed system (parts)  
See complete warranty for details

## Installation Notes

- Power cord extends 2" beyond total depth
- No additional clearance is needed for ventilation
- Do not obstruct front grille air flow

### 24" Dispensers

- CDE224B: Tap 1 & 2: Nitro Coffee • Tap 3: Still Coffee
- CDE224C: Tap 1 & 2: Nitro Coffee • Tap 3 & 4: Still Coffee
- CDE224D: Tap 1: Beer • Tap 2: Beer
- CDE224E: Tap 1: Nitro Coffee • Tap 2: Still Coffee • Tap 3: Wine • Tap 4: Beer



CDE224B

CDE224C

CDE224D

CDE224E



Coffee dispensers utilize patent-pending technology trusted by America's largest coffee chain

Project:	Notes:
----------	--------

#### Features and Specifications

Includes: refrigeration cabinet, dispensing tower, tubing, hardware, black tap handles, drip tray, and casters
Convection cooling system provides a quick cool down and consistent temperature
Stainless steel cabinet, grille, and full-wrap door
Full-depth lower interior with an interior volume of 6.3 cu ft
Removable lower interior stainless steel liner
CDE224B holds up to three 5 gallon cornelius kegs & one 10 lb / 38 cu ft nitro tank
CDE224C holds up to four cornelius kegs (two 5 gallon and two 3 gallon) & one 10 lb / 38 cu ft nitro tank
CDE224D holds up to one ½ barrel or three ¼ barrels & one 5 lb / 22 cu ft CO <sup>2</sup> tank
CDE224E holds up to one 5 gallon cornelius keg, one ¼ barrel, one ¼ slim barrel, & two 5 lb / 22 cu ft tanks (one CO <sup>2</sup> one nitro)
Cabinet Dimensions: 34 ½" H x 23 5/8" W x 23 1/8" D (see diagram for tower height)
Temperature range: 34°F – 60°F
Designed for built-in or freestanding applications
High efficiency variable speed compressor with 1.2 running amps
Environmentally friendly R600a refrigerant (1.23 oz)

#### Model Details

Model	Description	Voltage/Hz	Shipping Weight
UCDE224BSS03A	Cold Coffee 3 Dispenser 24" Reversible Hinge Stainless Solid	115v / 60hz	134 lb
UCDE224CSS03A	Cold Coffee 4 Dispenser 24" Reversible Hinge Stainless Solid	115v / 60hz	134 lb
UCDE224DSS03A	Beer 2 Dispenser 24" Reversible Hinge Stainless Solid	115v / 60hz	134 lb
UCDE224ESS03A	Cold Coffee, Beer, Wine 4 Dispenser 24" Reversible Hinge Stainless Solid	115v / 60hz	134 lb

#### Accessories

Model	Description	Shipping Weight
ULANITROTANK	22 cu ft Aluminum Nitro Tank	5 lb
ULACOFFEEKEG	2.5 gal Coffee Keg	6 lb
ULANITROREG	Nitrogen Regulator	3 lb
ULACOFFEECLEAN	Coffee Dispenser Cleaner (1 Box of 5 Packets)	1 lb

### Top

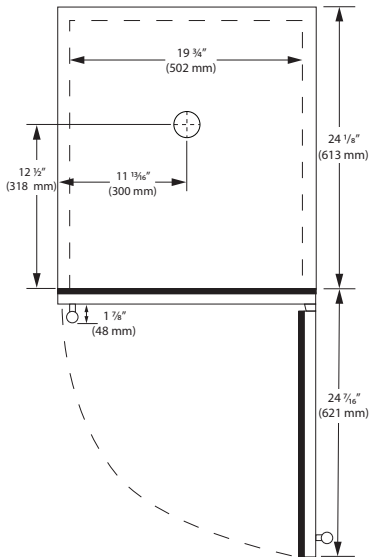

### Front

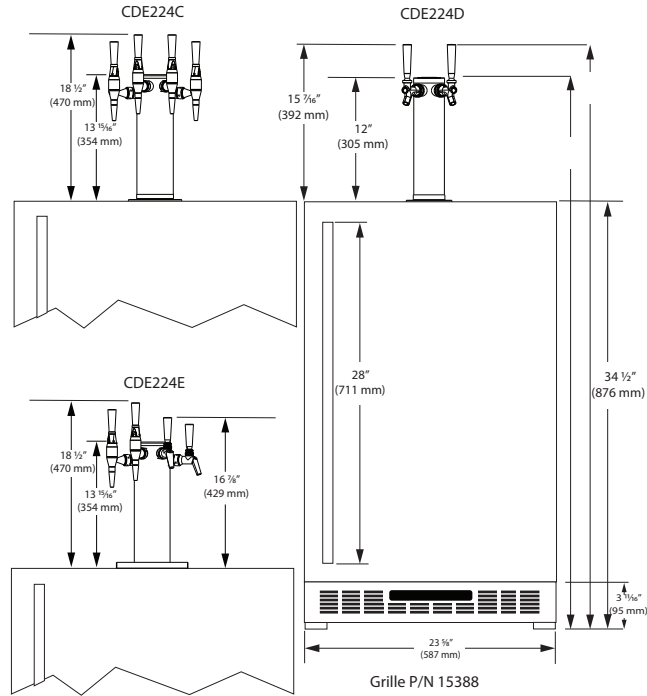

### Side

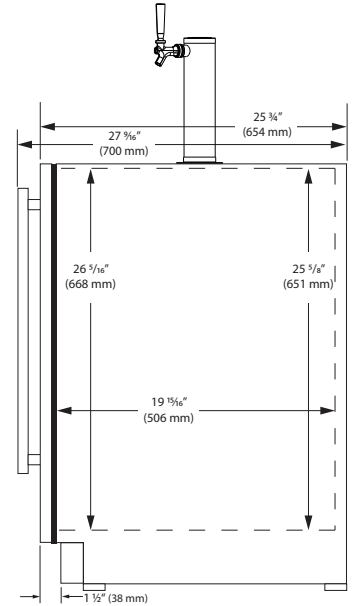

### Back

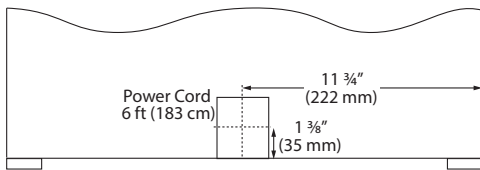

### Cabinet Cut-Out

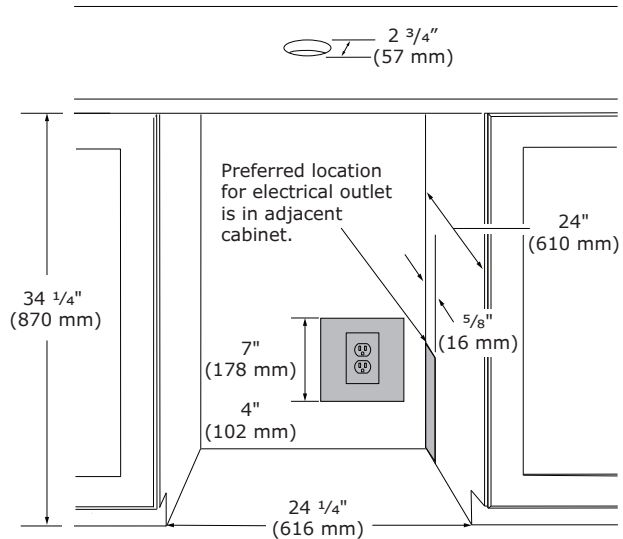

### Commercial Warranty

1 Year (parts & labor) / 5 year sealed system (parts)  
See complete warranty for details

### Installation Notes

- Power cord extends 2" beyond total depth
- No additional clearance is needed for ventilation
- Do not obstruct front grille air flow





## Product Specifications

# 15" Nugget Ice Machine

CNP115: 15" Nugget Ice Machine



CNP115

CNP115

Project:	Notes:
----------	--------

Features and Specifications
Industry exclusive U-Choose™ feature offers five levels of ice density
Produces up to 90 lb of ice per day
Stores 30 lb of ice
Makes cylindrical compressed ice bits approx. 3/4" L x 1/2" H
Indicator alert notifies when cleaning is needed
Stainless steel cabinet, grille, and full-wrap door
Dimensions: 34 11/16" H x 14 15/16" W x 22 15/16" D
Easiest nugget ice machine cleaning process in the industry
Designed for built-in or freestanding applications
Factory installed drain pump
High efficiency variable speed compressor with 1.2 running amps
Environmentally friendly R600a refrigerant (1.06 oz)

Model Details			
Model	Description	Voltage/Hz	Shipping Weight
UCNP115-SS01A	Nugget Ice Machine 15" Reversible Hinge Stainless Solid	115v / 60hz	96 lb

Accessories		
Model	Description	Shipping Weight
ULALINEFILTERHEAD	In-Line Water Filter Head 3/8" NPT (Required for initial setup)	1 lb
ULALINEFILTER	In-Line Water Filter (Standard)	4.5 lb
ULALINEFILTERL	In-Line Water Filter (Large)	7 lb
ULANUGGETCLEANKIT	Includes 1 Bottle Nugget Ice Cleaner, Funnel, & Hose	1 lb
ULANUGGETCLEAN	Nugget Ice Cleaner (Single 8 oz. bottle)	1 lb
ULAWATERHOOKUP	Braided Water Supply Line Kit	2 lb



# Product Specifications • 15" Nugget Ice Machine

**Top**

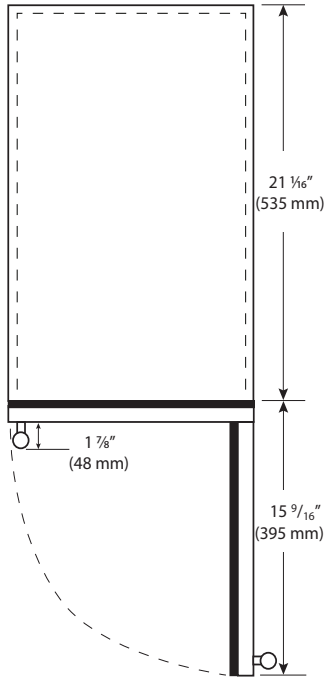

**Front**

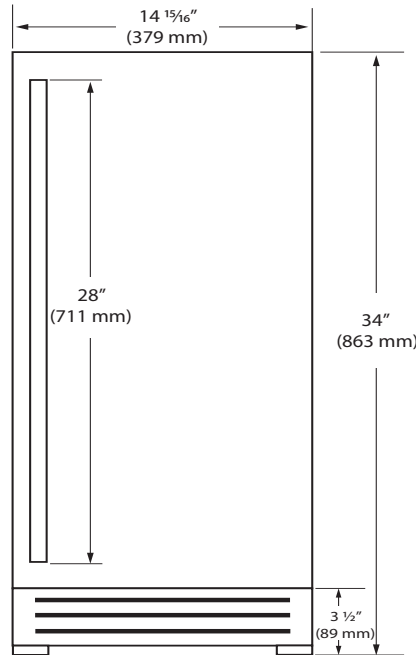

**Side**

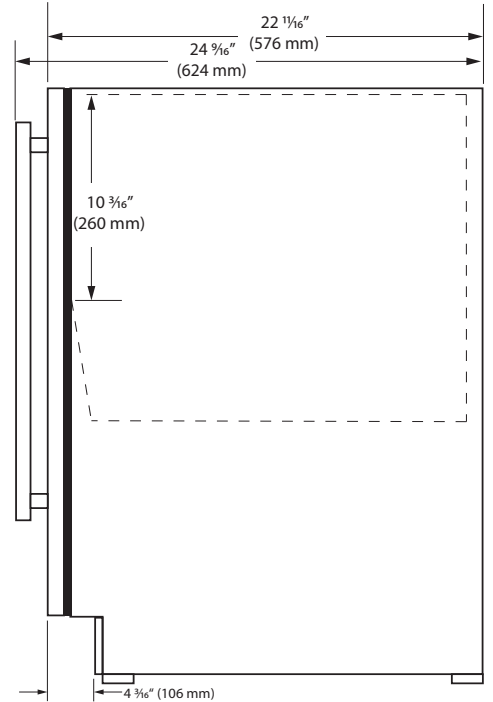

**Back**

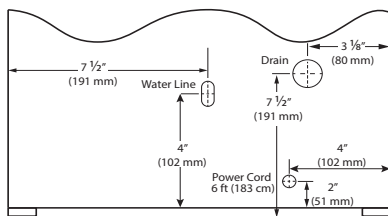

**Cabinet Cut-Out**

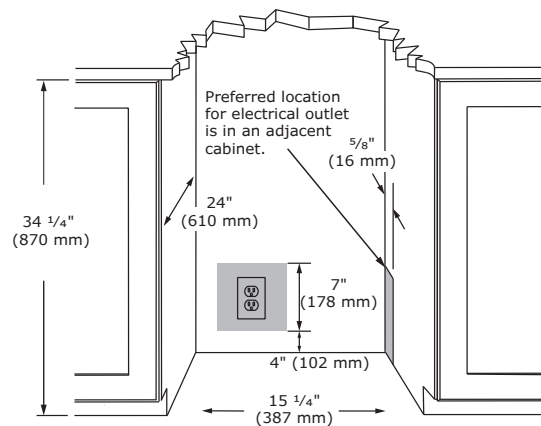

## Commercial Warranty

1 Year (parts & labor) / 5 year sealed system (parts)  
See complete warranty for details

## Installation Notes

- Power cord extends 2" beyond total depth
- No additional clearance is needed for ventilation
- Do not obstruct front grille air flow

**23 cu ft Refrigerator, Reach-In**

CRE427: Refrigerator, Reach-In



CRE427

**Features and Specifications**

Volume of 23 cu ft
AISI 441 stainless steel interior and exterior with lock
Temperature range: 28°F to 46°F
Electronic digital temperature control with alarms
Autodefrost
High efficiency compressor, top mount, with 3.8 running amps
High efficiency evaporator coil & condenser
Self-lubricating, sealed cast iron evaporator fan motor with high volume airflow design
CFC-free high-density polyurethane insulated cabinet
Factory pre-wired for dedicated outlet, 11 ft cord and plug included NEMA 5-15P
Environmentally friendly R290 refrigerant - 3.2 oz (0.090kg)
1 section, includes 3 epoxy coated wire shelves
Dimensions: 80 23/32" H x 27 9/16" W x 31 1/2" D
4 adjustable legs

**Model Details**

Model	Description	Voltage/Hz	Shipping Weight
UCRE427-SS01A	Refrigerator, Reach-In, Field Reversible Hinge	115v / 60hz	287 lb

**Accessories**

Model	Description	Shipping Weight
ULA4080584	Shelf Guide	.88 lb
ULAQ32-0002	Epoxy Coated Wire Shelf (20.86" x 25.6")	2.2 lb
ULA89020410	Adjustable Leg kit	11.02 lb
ULA89010340	Caster Kit	13.22 lb
ULA80010380	Door Lock Kit	2.2 lb
ULA80110300	Light Kit	2.2 lb





**Product Specifications • 23 cu ft Refrigerator, Reach-In**

**Front (Open)**

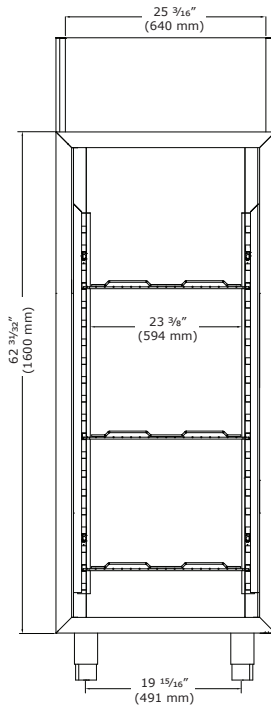

**Front (Closed)**

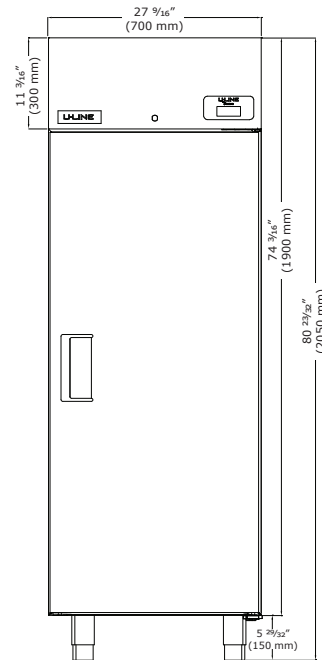

**Top**

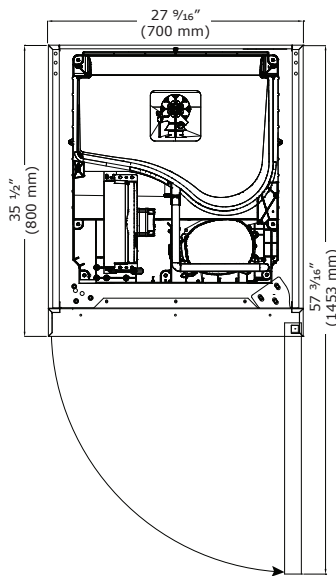

**Side**

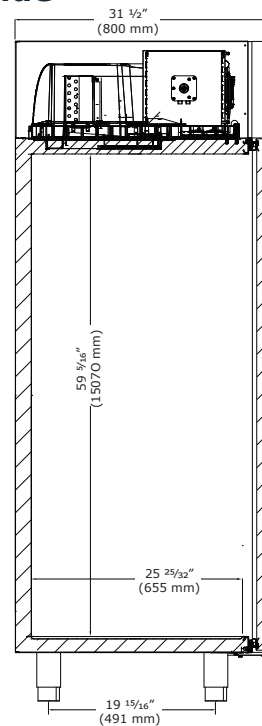

**Commercial Warranty**

1 Year (parts & labor) / 5 year sealed system (parts)  
See complete warranty for details



**23 cu ft Refrigerators, Reach-In**

CRE527-SS: Solid Door Refrigerator, Reach-In

CRE527-SG: Glass Door Refrigerator, Reach-In



CRE527-SS



CRE527-SG

**Features and Specifications**

Volume of 23 cu ft
AISI 304 stainless steel interior and exterior with lock
Temperature range: 28°F to 46°F
Electronic digital temperature control with alarms
Autodefrost
High efficiency compressor, top mount, with 3.2 running amps
High efficiency evaporator coil & condenser
Epoxy coated, sealed evaporator eliminates potential of corrosion
CFC-free high density polyurethane insulated cabinet
Factory pre-wired for dedicated outlet, 11 ft cord and plug included NEMA 5-15P
Environmentally friendly R290 refrigerant - 3.2 oz (0.090kg)
Includes 3 epoxy coated wire shelves
Dimensions: 82 9/32" H x 26 57/64" W x 31 1/2" D
LED lighting
4 adjustable stainless steel legs

**Model Details**

Model	Description	Voltage/Hz	Shipping Weight
UCRE527-SS31A	23 cu ft Refrigerator Solid Door, Reach-In, Field Reversible Hinge	115v / 60hz	287 lb
UCRE527-SG41A	23 cu ft Refrigerator Glass Door, Reach-In, Right Hand Hinge	115v / 60hz	327 lb

**Accessories**

Model	Description	Shipping Weight
ULAQ32-0002	Epoxy Coated Wire Shelf (20.86" x 25.6")	2.2 lb
ULA89010340	Caster Kit	13.22 lb



**Product Specifications • 23 cu ft Refrigerators, Reach-In**

**Front (Open)**

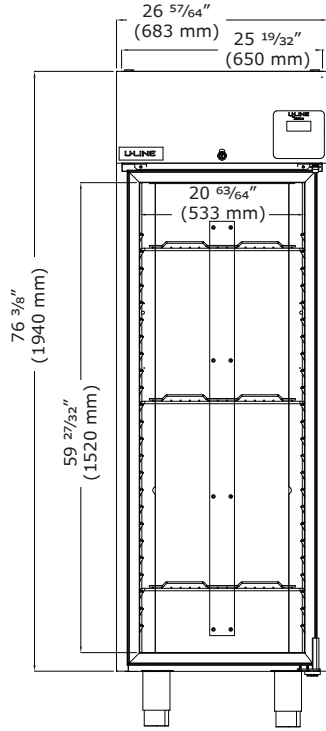

**Side**

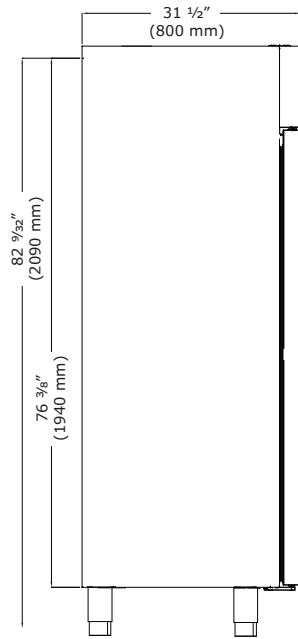

**Front (Closed - Glass Door)**

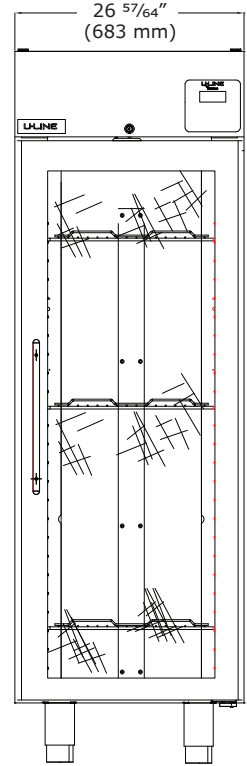

**Top**

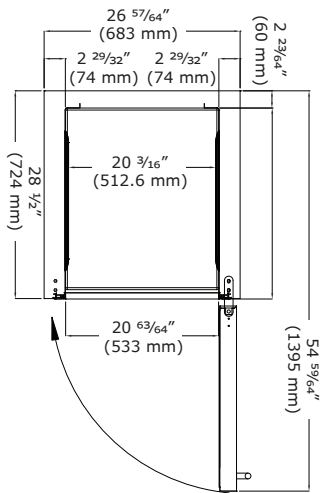

**Side**

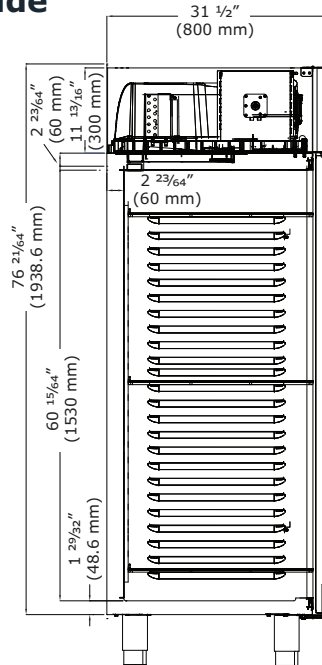

**Commercial Warranty**

1 Year (parts & labor) / 5 year sealed system (parts)  
See complete warranty for details



**48 cu ft Refrigerator, Reach-In**

CRE455: Refrigerator, Reach-In



CRE455

**Features and Specifications**

Volume of 48 cu ft
AISI 441 stainless steel interior and exterior with locks
Temperature range: 28°F to 46°F
Electronic digital temperature control with alarms
Autodefrost
High efficiency compressor, top mount, with 6.4 running amps
High efficiency evaporator coil & condenser
Self-lubricating, sealed cast iron evaporator fan motor with high volume airflow design
CFC-free high-density polyurethane insulated cabinet
Factory pre-wired for dedicated outlet, 11 ft cord and plug included NEMA 5-15P
Environmentally friendly R290 refrigerant - 3.5 oz (0.100kg)
2 sections, includes 6 epoxy coated wire shelves
Dimensions: 80 23/32" H x 55 1/8" W x 31 1/2" D
4 adjustable legs

**Model Details**

Model	Description	Voltage/Hz/Phase	Shipping Weight
UCRE455-SS71A	Refrigerator, Reach-In	115v / 60hz / 1	396 lb

**Accessories**

Model	Description	Shipping Weight
ULA4080584	Shelf Guide	.88 lb
ULAQ32-0002	Epoxy Coated Wire Shelf (20.86" x 25.6")	2.2 lb
ULA89030400	Adjustable Leg kit	11.02 lb
ULA81040300	Caster Kit	11.02 lb
ULA80010380	Door Lock Kit	2.2 lb
ULA80110300	Light Kit	2.2 lb





# Product Specifications • 48 cu ft Refrigerator, Reach-In

### Front (Open)

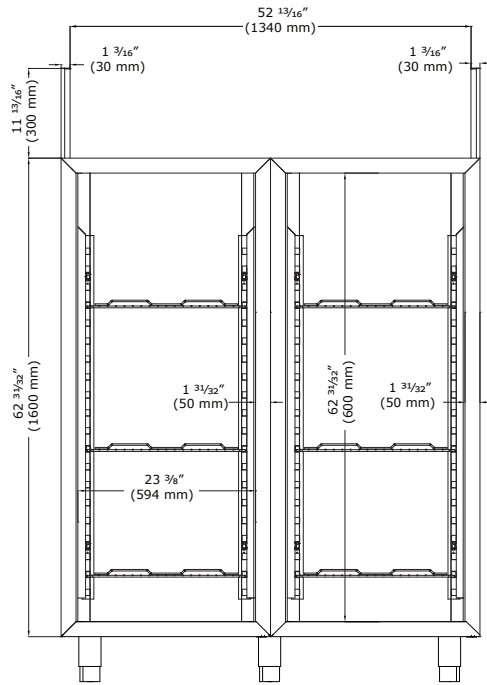

### Front (Closed)

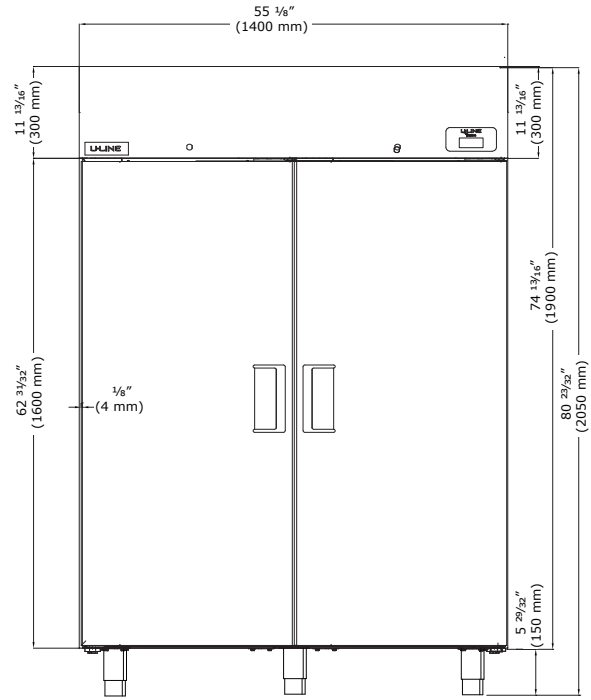

### Top

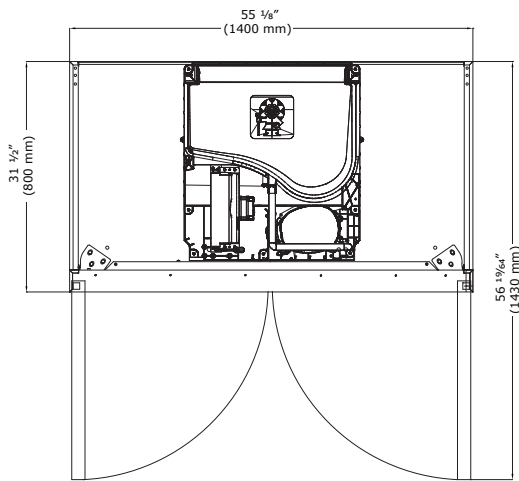

### Side

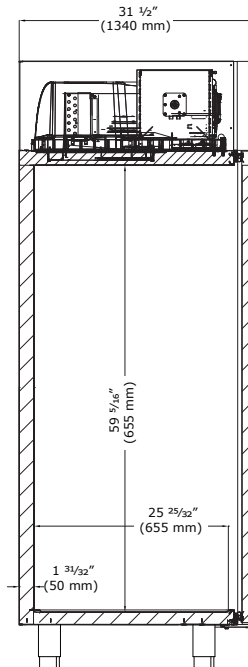

## Commercial Warranty

1 Year (parts & labor) / 5 year sealed system (parts)  
See complete warranty for details



### 49 cu ft Refrigerators, Reach-In

**CRE553-SS:** Solid Door Refrigerator, Reach-In

**CRE553-SG:** Glass Door Refrigerator, Reach-In



CRE553-SS



CRE553-SG

#### Features and Specifications

Volume of 49 cu ft

AISI 304 stainless steel interior and exterior with locks

Temperature range: 28°F to 46°F

Electronic digital temperature control with alarms

Autodefrost

High efficiency top-mounted compressor with 5.4 running amps

High efficiency evaporator coil & condenser

Epoxy coated, sealed evaporator eliminates potential corrosion

CFC-free high density polyurethane insulated cabinet

Factory pre-wired for dedicated outlet, 11 ft cord and plug included NEMA 5-15P

Environmentally friendly R290 refrigerant - 3.5 oz (0.100 kg)

2 sections, includes 6 epoxy coated wire shelves

Dimensions: 82 9/32" H x 52 9/16" W x 31 1/2" D

LED lighting

6 adjustable stainless steel legs

#### Model Details

Model	Description	Voltage/Hz	Shipping Weight
UCRE553-SS71A	49 cu ft Refrigerator, Reach-In, Solid Door	115v / 60hz	419 lb
UCRE553-SG71A	49 cu ft Refrigerator, Reach-In, Glass Door	115v / 60hz	518 lb

#### Accessories

Model	Description	Shipping Weight
ULA4080534	Shelf Guide	.88 lb
ULAQ32-0002	Epoxy Coated Wire Shelf (20.86" x 25.6")	2.2 lb
ULA81040300	Caster Kit	11.02 lb



**Product Specifications • 49 cu ft Refrigerators, Reach-In**

**Front  
(Closed - Solid Door)**

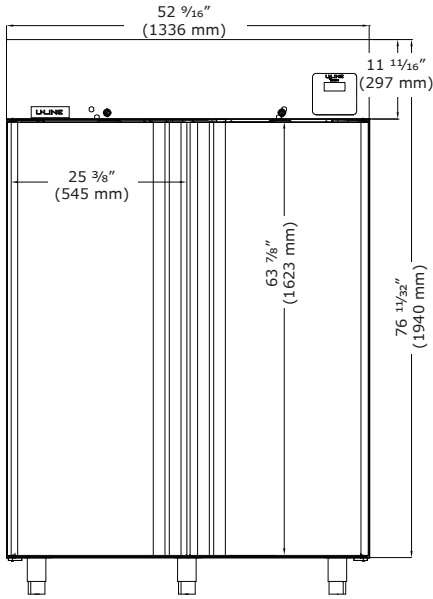

**Front  
(Closed - Glass Door)**

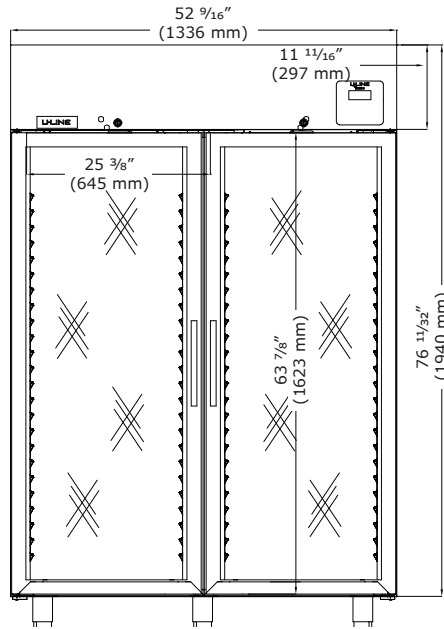

**Side**

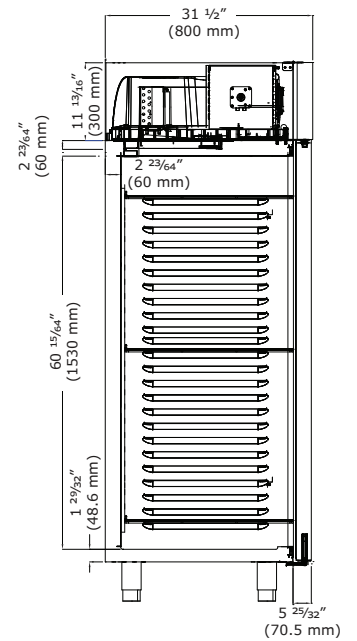

**Top**

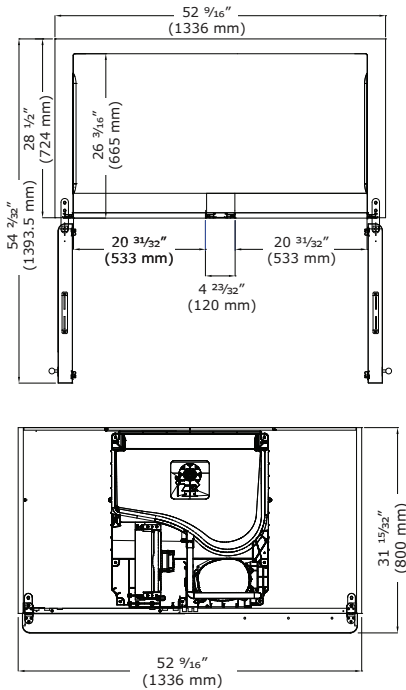

**Back**

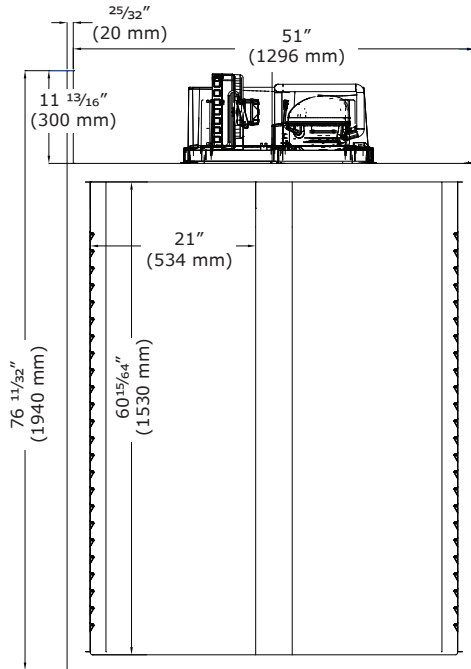

**Side**

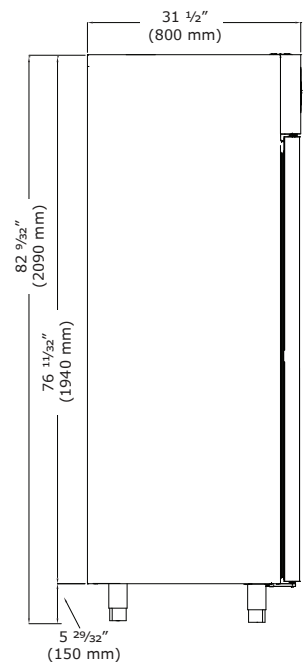

**Commercial Warranty**

1 Year (parts & labor) / 5 year sealed system (parts)  
See complete warranty for details



CRE585-SS: Solid Door Refrigerator, Reach-In

CRE585-SG: Glass Door Refrigerator, Reach-In



CRE585-SS



CRE585-SG

**Features and Specifications**

Volume of 74 cu ft

AISI 304 stainless steel interior and exterior with locks

Temperature range: 28°F to 46°F

Electronic digital temperature control with alarms

Autodefrost

High efficiency top-mounted compressor with 7 running amps

High efficiency evaporator coil & condenser

Epoxy coated, sealed evaporator eliminates potential corrosion

CFC-free high density polyurethane insulated cabinet

Factory pre-wired for dedicated outlet, 11 ft cord and plug included NEMA 5-15P

Environmentally friendly R290 refrigerant - 2 x 3.2 oz (2 x 0.090 kg)

3 sections, includes 9 epoxy coated wire shelves

Dimensions: 83 15/32" H x 85 3/64" W x 31 15/32" D

LED lighting

8 adjustable stainless steel legs

**Model Details**

Model	Description	Voltage/Hz	Shipping Weight
UCRE585-SS71A	Refrigerator, Reach-In, Solid Door	115v / 60hz	650 lb
UCRE585-SG71A	Refrigerator, Reach-In, Glass Door	115v / 60hz	750 lb

**Accessories**

Model	Description	Shipping Weight
ULA4080584	Shelf Guide	.88 lb
ULAQ32-0002	Epoxy Coated Wire Shelf (20.86" x 25.6")	2.2 lb
ULA89010360	Caster Kit	13.22 lb





**Front (Closed - Solid Door)**

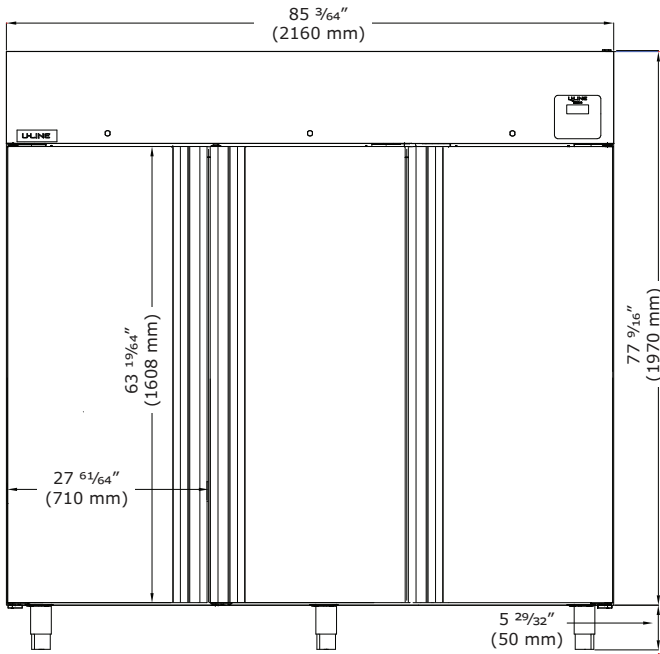

**Front (Open)**

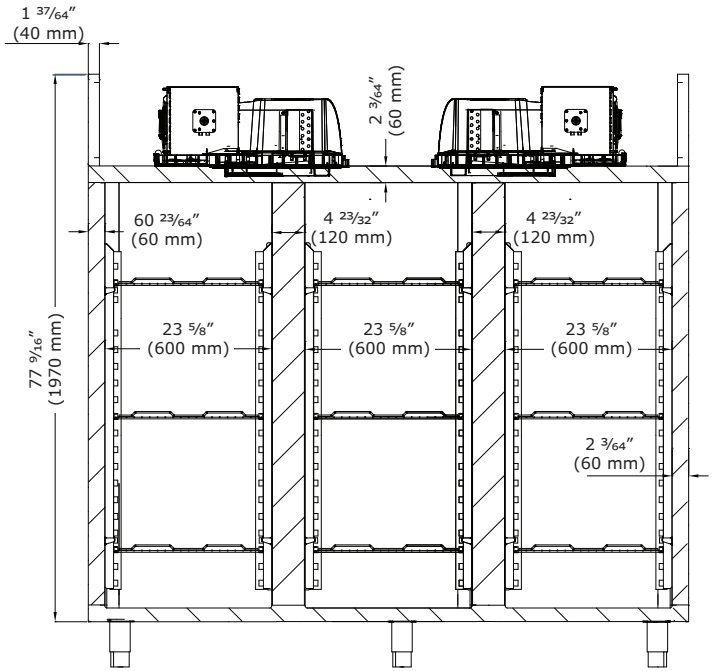

**Front (Closed - Glass Door)**

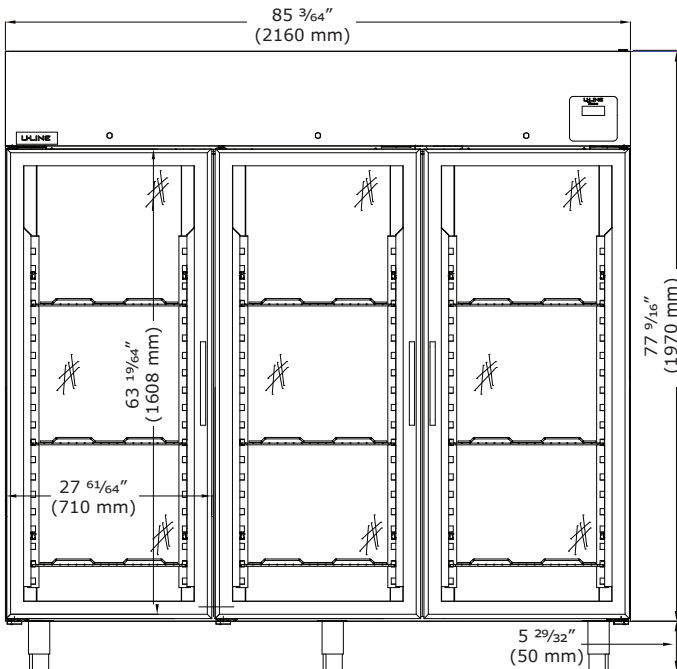

**Side**

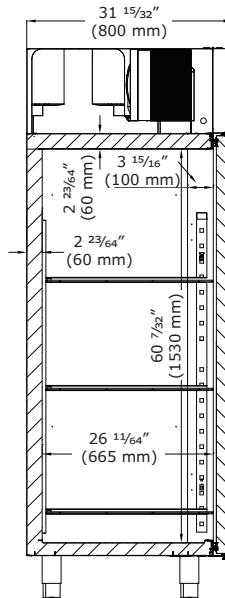

**Top**

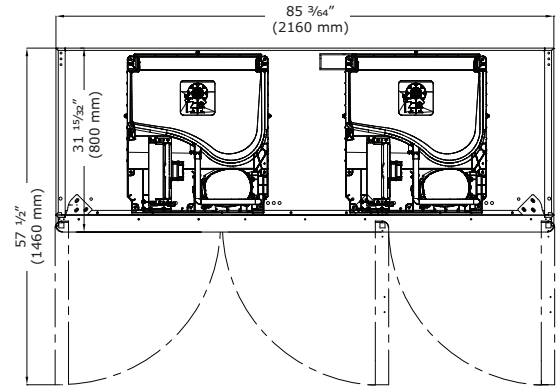

**Commercial Warranty**

1 Year (parts & labor) / 5 year sealed system (parts)  
See complete warranty for details



## Product Specifications Refrigerator Chef Bases

CRB536: 36" Refrigerator Chef Base  
CRB548: 48" Refrigerator Chef Base

CRB560: 60" Refrigerator Chef Base  
CRB572: 72" Refrigerator Chef Base



CRB536



CRB548



CRB560



CRB572

### Features and Specifications

CRB536 capacity: 2 drawers holds (2) standard size GN1/1 (12"x20"x4") pans (not included)

CRB548 capacity: 2 drawers holds (4) standard size GN1/1 (12"x20"x4") pans (not included)

CRB560 capacity: 2 drawers holds (4) standard size GN1/1 (12"x20"x4") pans (not included)

CRB572 capacity: 4 drawers holds (8) standard size GN1/1 (12"x20"x4") pans (not included)

AISI 304 stainless steel interior and exterior

Temperature range: 28°F to 46°F

Electronic digital temperature control with alarms

Autodefrost

High efficiency compressor, side mount (CRB536, CRB548, CRB560: 7.3 running amps) (CRB572: 8.7 running amps)

High efficiency evaporator coil & condenser

Self-lubricating, sealed cast iron evaporator fan motor with high volume airflow design

CFC-free high-density polyurethane insulated cabinet

Factory pre-wired for dedicated outlet, 11 ft cord and plug included NEMA 5-15P

Environmentally friendly R449a refrigerant - 16 oz (0.450 kg)

CRB536 dimensions: 26" H x 36" W x 32 1/2" D

CRB548 dimensions: 26" H x 48" W x 32 1/2" D

CRB560 dimensions: 26" H x 60" W x 32 1/2" D

CRB572 dimensions: 26" H x 72" W x 32 1/2" D

### Model Details

Model	Description	Voltage/Hz/Phase	Shipping Weight
UCRB536-SS61A	36" Refrigerator Chef Base	115v / 60hz / 1	340 lb
UCRB548-SS61A	48" Refrigerator Chef Base	115v / 60hz / 1	410 lb
UCRB560-SS61A	60" Refrigerator Chef Base	115v / 60hz / 1	549 lb
UCRB572-SS61A	72" Refrigerator Chef Base	115v / 60hz / 1	653 lb



# Product Specifications • Refrigerator Chef Bases

**Front (CRB536)**

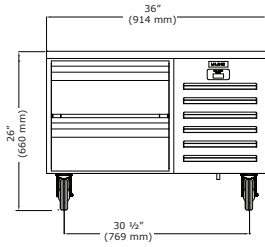

**Side**

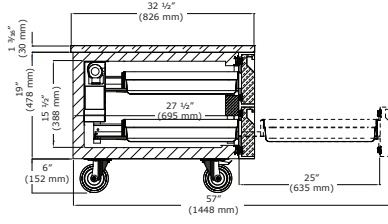

**Top**

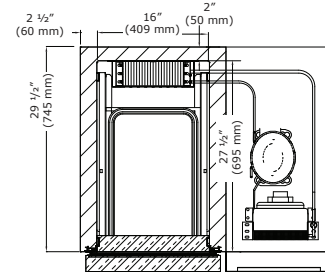

**Front (CRB548)**

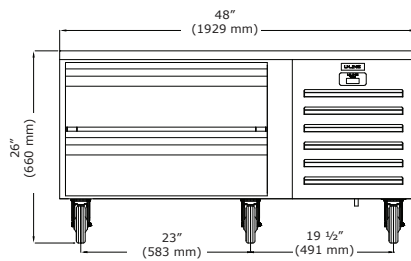

**Side**

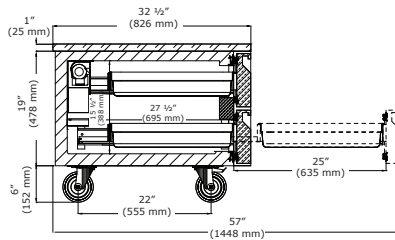

**Top**

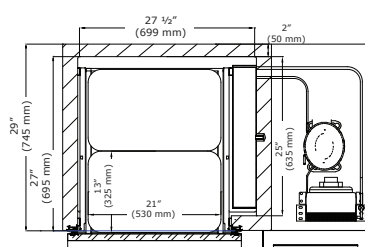

**Front (CRB560)**

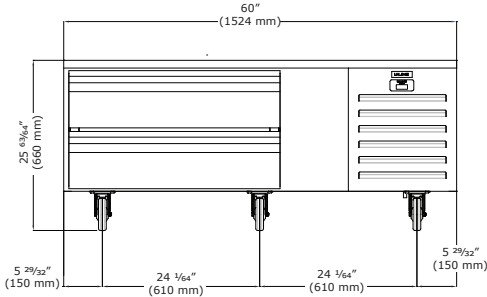

**Side**

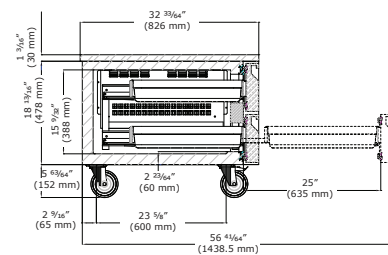

**Top**

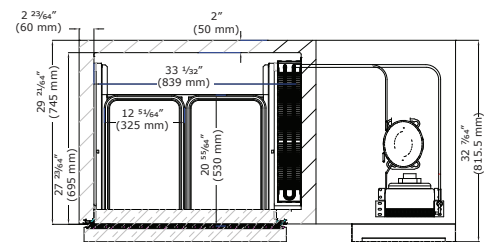

**Front (CRB572)**

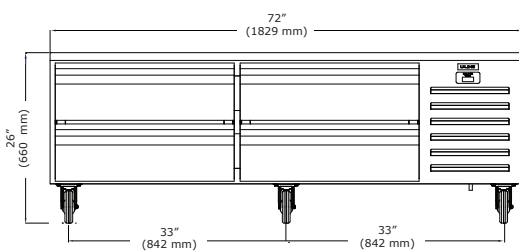

**Side**

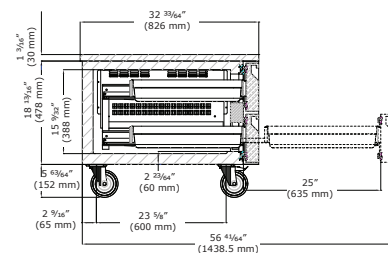

**Top**

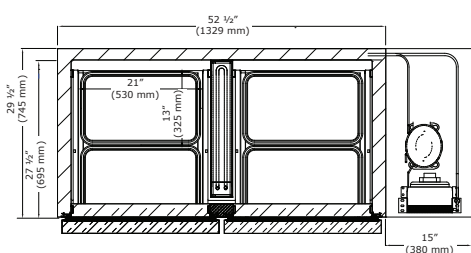

## Commercial Warranty

1 Year (parts & labor) / 5 year sealed system (parts)  
See complete warranty for details



CFZ427: Freezer, Reach-In



CFZ427

**Features and Specifications**

Volume of 23 cu ft
AISI 441 stainless steel interior and exterior with lock
Temperature range: -13°F to 14°F
Electronic digital temperature control with alarms
Autodefrost
High efficiency compressor, top mount, with 6.2 running amps
Self-lubricating, sealed cast iron evaporator fan motor with high volume airflow design
High efficiency evaporator coil & condenser
CFC-free high-density polyurethane insulated cabinet
Factory pre-wired for dedicated outlet, 11 ft cord and plug included NEMA 5-15P
Environmentally friendly R290 refrigerant - 3.9 oz (0.110 kg)
1 section, includes 3 epoxy coated wire shelves
Dimensions: 80 23/32" H x 27 9/16" W x 31 1/2" D
4 adjustable legs

**Model Details**

Model	Description	Voltage/Hz/Phase	Shipping Weight
UCFZ427-SS01A	23 cu ft Freezer, Reach-In, Field Reversible Hinge	115v / 60hz / 1	287 lb

**Accessories**

Model	Description	Shipping Weight
ULA4080584	Shelf Guide	.88 lb
ULAQ32-0002	Epoxy Coated Wire Shelf (20.86" x 25.6")	2.2 lb
ULA89020410	Adjustable Leg kit	11.02 lb
ULA89010340	Caster Kit	11.02 lb
ULA80010380	Door Lock Kit	2.2 lb
ULA80110300	Light Kit	2.2 lb





**Product Specifications • 23 cu ft Freezer, Reach-In**

**Front (Open)**

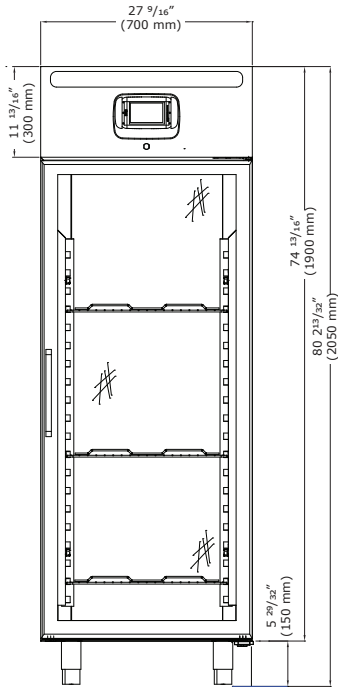

**Front (Closed)**

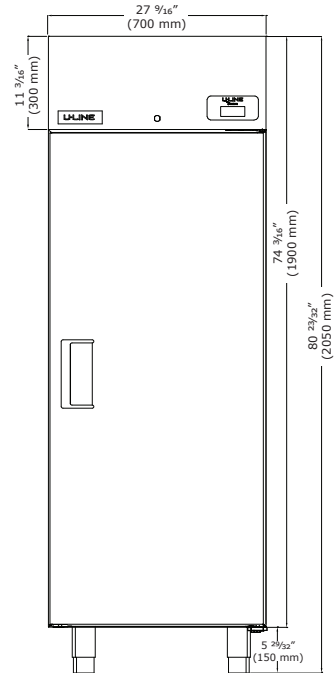

**Top**

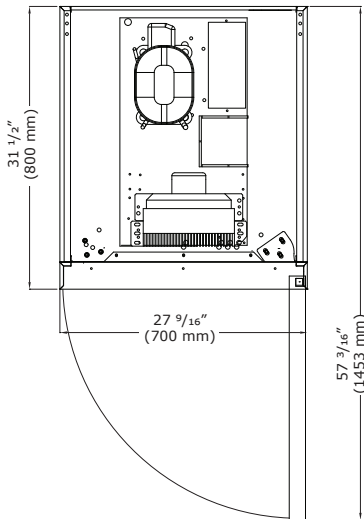

**Side**

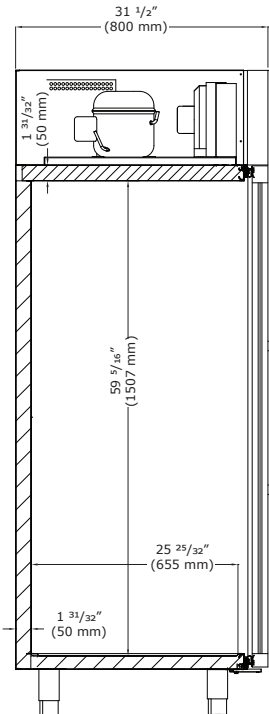

**Commercial Warranty**

1 Year (parts & labor) / 5 year sealed system (parts)  
See complete warranty for details



CFZ527-SS: Solid Door Freezer, Reach-In

CFZ527-SG: Glass Door Freezer, Reach-In



CFZ527-SS



CFZ527-SG

**Features and Specifications**

- Volume of 23 cu ft
- AISI 304 Stainless steel interior and exterior with lock
- Temperature range: -13°F to 14°F
- Electronic digital temperature control with alarms
- Autodefrost
- High efficiency top-mounted compressor with 6.2 running amps
- High efficiency evaporator coil & condenser
- Self-lubricating, sealed cast iron evaporator fan motor with high volume air flow design
- Removable magnetic gasket for easy cleaning
- CFC-free high-density polyurethane insulated cabinet
- Factory pre-wired for dedicated outlet, 11 ft. cord and plug included NEMA 5-15P
- Environmentally friendly R290 refrigerant - 3.9 oz (0.110 kg)
- 1 section, includes 3 epoxy coated wire shelves
- Dimensions: 82 9/32" H x 26 57/64" W x 31 1/2" D
- LED lighting
- 4 Adjustable stainless steel legs

**Model Details**

Model	Description	Voltage/Hz	Shipping Weight
UCFZ527-SS31A	Freezer Solid Door, Reach-In, Field Reversible Hinge	115v / 60hz	297 lb
UCFZ527-SG31A	Freezer Glass Door, Reach-In, Field Reversible Hinge	115v / 60hz	353 lb

**Accessories**

Model	Description	Shipping Weight
ULAQ32-0002	Epoxy Coated Wire Shelf (20.86" x 25.6")	2.2 lb
ULA89010340	Caster Kit (4 casters, 2 with brakes)	11.02 lb



**Product Specifications • 23 cu ft Freezers, Reach-In**

**Front (Open)**

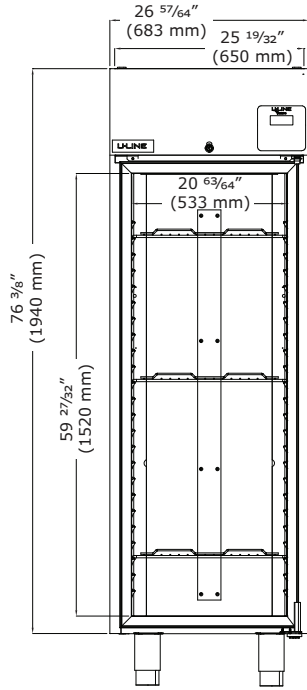

**Top**

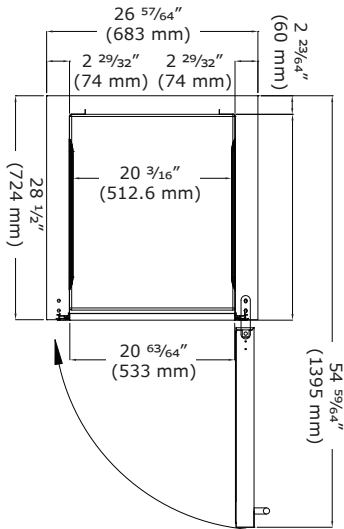

**Side**

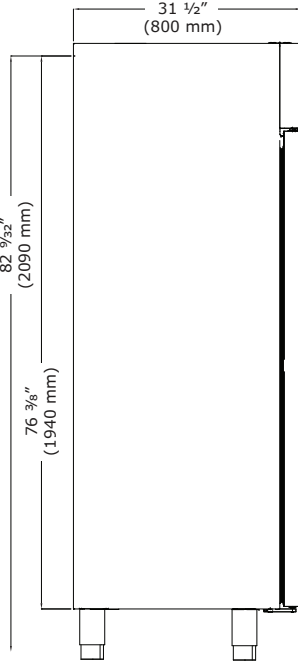

**Side**

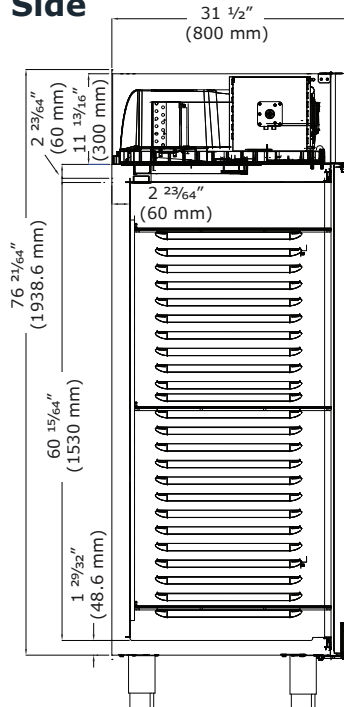

**Front (Closed - Glass Door)**

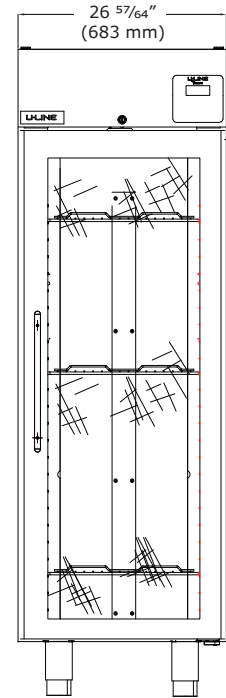

**Commercial Warranty**

1 Year (parts & labor) / 5 year sealed system (parts)  
See complete warranty for details



CFZ455: Freezer, Reach-In



CFZ455

**Features and Specifications**

Volume of 48 cu ft
AISI 441 stainless steel interior and exterior with locks
Temperature range: -13°F to 14°F
Electronic digital temperature control with alarms
Autodefrost
High efficiency compressor, top mount, with 9.6 running amps
High efficiency evaporator coil & condenser
Self-lubricating, sealed cast iron evaporator fan motor with high volume airflow design
CFC-free high-density polyurethane insulated cabinet
Factory pre-wired for dedicated outlet, 11 ft cord and plug included NEMA 5-15P
Environmentally friendly R290 refrigerant - 4.2 oz (0.120kg)
2 sections, includes 6 epoxy coated wire shelves
Dimensions: 80 23/32" H x 55 1/8" W x 31 1/2" D
4 adjustable legs

**Model Details**

Model	Description	Voltage/Hz/Phase	Shipping Weight
UCFZ455-SS71A	Freezer, Reach-In	115v / 60hz / 1	418 lb

**Accessories**

Model	Description	Shipping Weight
ULA4080584	Shelf Guide	.88 lb
ULAQ32-0002	Epoxy Coated Wire Shelf (20.86" x 25.6")	2.2 lb
ULA89030400	Adjustable Leg kit	11.02 lb
ULA81040300	Caster Kit	11.02 lb
ULA80010380	Door Lock Kit	2.2 lb
ULA80110300	Light Kit	2.2 lb





**Product Specifications • 48 cu ft Freezer, Reach-In**

**Front (Open)**

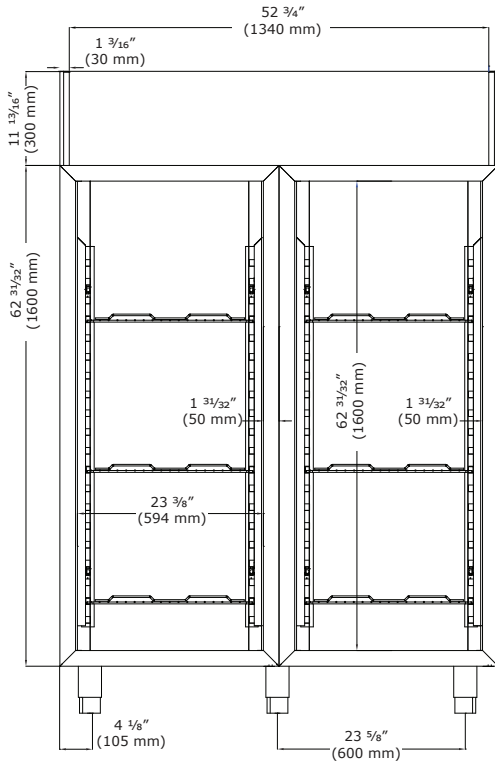

**Front (Closed)**

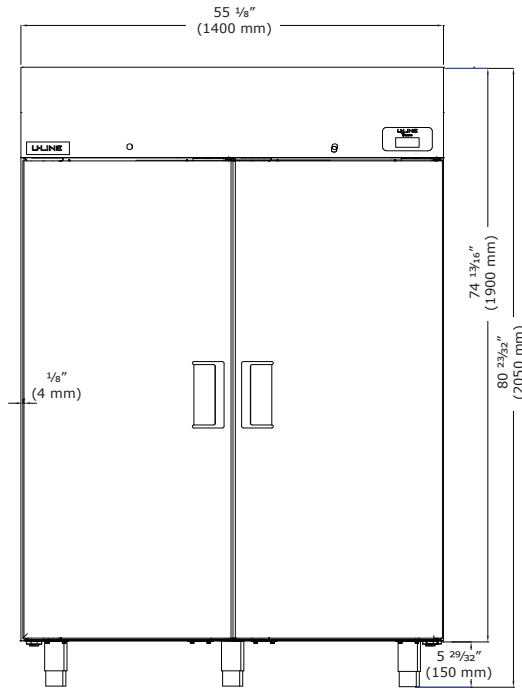

**Top**

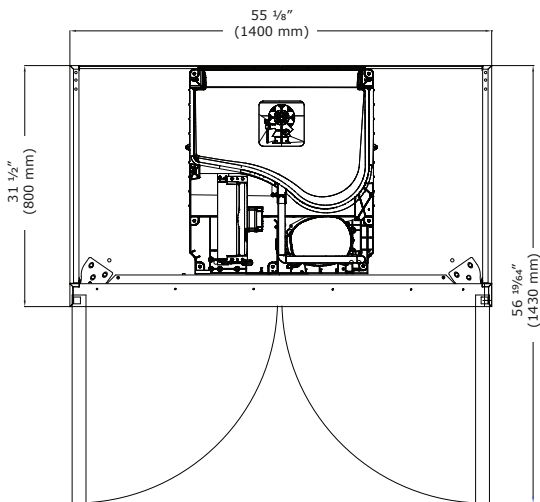

**Side**

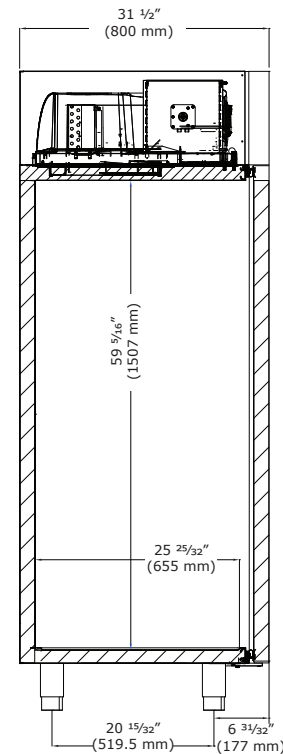

**Commercial Warranty**

1 Year (parts & labor) / 5 year sealed system (parts)  
See complete warranty for details



### 49 cu ft Freezers, Reach-In

CFZ553-SS: Solid Door Freezer, Reach-In

CFZ553-SG: Glass Door Freezer, Reach-In



CFZ553-SS



CFZ553-SG

#### Features and Specifications

Volume of 49 cu ft
AISI 304 Stainless steel interior and exterior with locks
Temperature range: -13°F to 14°F
Electronic digital temperature control with alarms
Autodefrost
High efficiency top-mounted compressor with 9.6 running amps
High efficiency evaporator coil & condenser
Self-lubricating, sealed cast iron evaporator fan motor with high volume air flow design
Removable magnetic gasket for easy cleaning
CFC-free high-density polyurethane insulated cabinet
Factory pre-wired for dedicated outlet, 11 ft cord and plug included NEMA 5-15P
Environmentally friendly R290 refrigerant - 4.2 oz (0.120kg)
2 sections, includes 6 epoxy coated wire shelves
Dimensions: 82 3/32" H x 52 9/16" W x 31 1/2" D
LED lighting
6 Adjustable stainless steel legs

#### Model Details

Model	Description	Voltage/Hz	Shipping Weight
UCFZ553-SS71A	49 cu ft Freezer Solid Door, Reach-In	115v / 60hz	441 lb
UCFZ553-SG71A	49 cu ft Freezer Glass Door, Reach-In	115v / 60hz	617 lb

#### Accessories

Model	Description	Shipping Weight
ULA4080534	Shelf Guide	.88 lb
ULAQ32-0002	Epoxy Coated Wire Shelf (20.86" x 25.6")	2.2 lb
ULA81040300	Caster Kit (6 casters, 2 with brakes)	11.02 lb



Product Specifications • 49 cu ft Freezers, Reach-In

Front

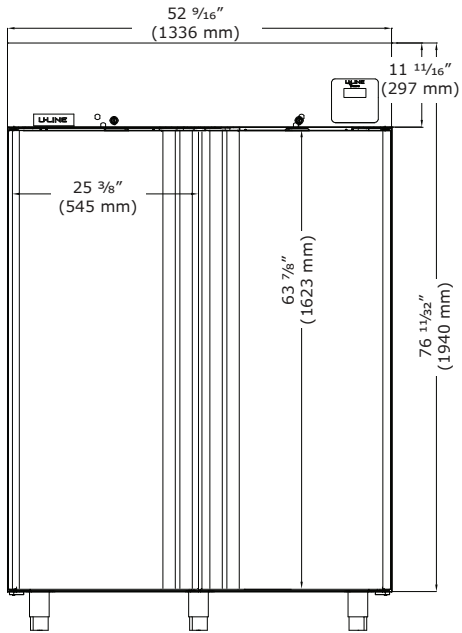

Front (Closed - Glass Door)

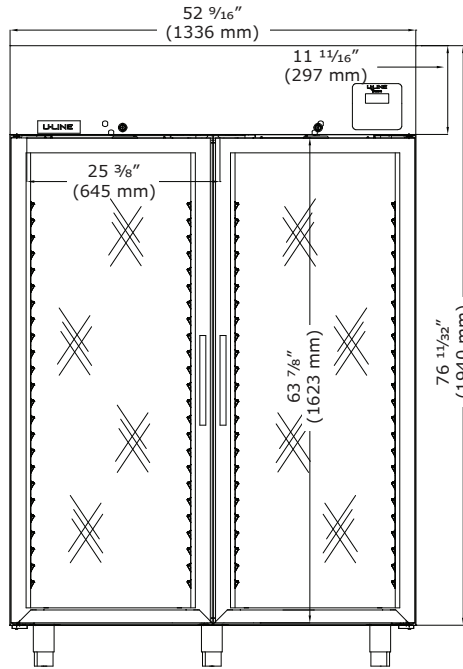

Side

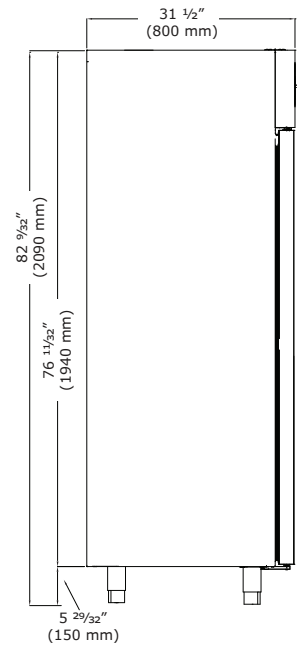

Top

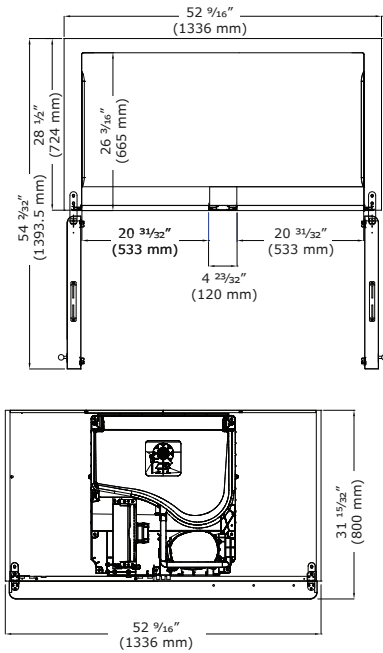

Back

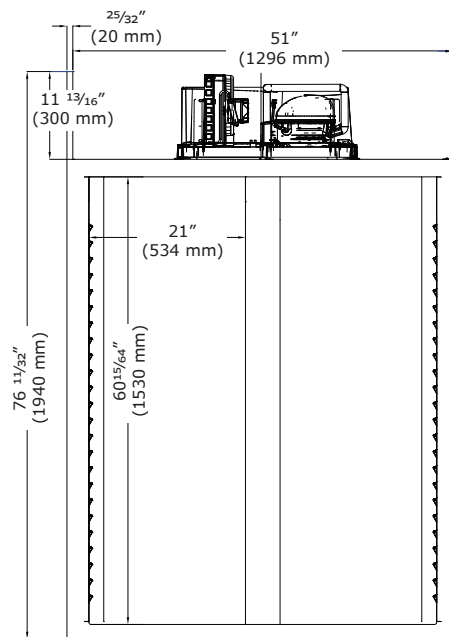

Side

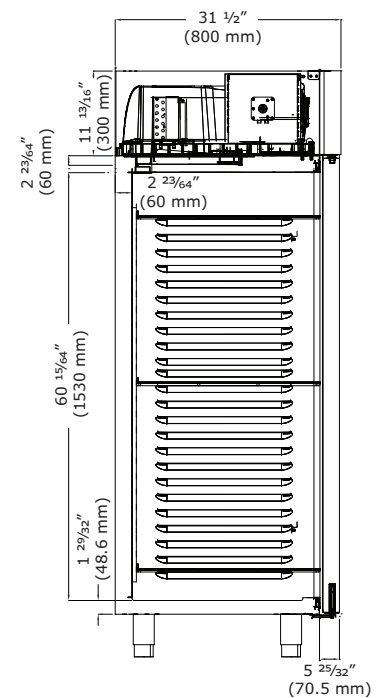

**Commercial Warranty**

1 Year (parts & labor) / 5 year sealed system (parts)  
See complete warranty for details



### 72 cu ft Freezers, Reach-In

CFZ585-SS: Solid Door Freezer, Reach-In

CFZ585-SG: Glass Door Freezer, Reach-In



CFZ585-SS



CFZ585-SG

#### Features and Specifications

Volume of 72 cu ft
AISI 304 stainless steel interior and exterior with locks
Temperature range: -13°F to 14°F
Electronic digital temperature control with alarms
Autodefrost
High efficiency compressor with 20 running amps
High efficiency evaporator coil & condenser
Self-lubricating, sealed cast iron evaporator fan motor with high volume air flow design
Removable magnetic gasket for easy cleaning
CFC-free high-density polyurethane insulated cabinet
Factory pre-wired for dedicated outlet, 11 ft. cord and plug included NEMA 5-20P
Environmentally friendly R290 refrigerant - 2 x 3.5 oz (2 x 0.100kg)
3 sections, includes 9 epoxy coated wire shelves
Dimensions: 83 15/32" H x 85 3/64" W x 31 15/32" D
LED lighting
8 Adjustable stainless steel legs

#### Model Details

Model	Description	Voltage/Hz	Shipping Weight
UCFZ585-SS71A	72 cu ft Freezer Solid Door, Reach-In	115v / 60hz	650 lb
UCFZ585-SG71A	72 cu ft Freezer Glass Door, Reach-In	115v / 60hz	750 lb

#### Accessories

Model	Description	Shipping Weight
ULA4080584	Shelf Guide	.88 lb
ULAQ32-0002	Epoxy Coated Wire Shelf (20.86" x 25.6")	2.2 lb
ULA89010360	Caster Kit (8 casters, 2 with brakes)	13.22 lb



**Product Specifications • 72 cu ft Freezers, Reach-In**

**Front (Closed - Solid Door)**

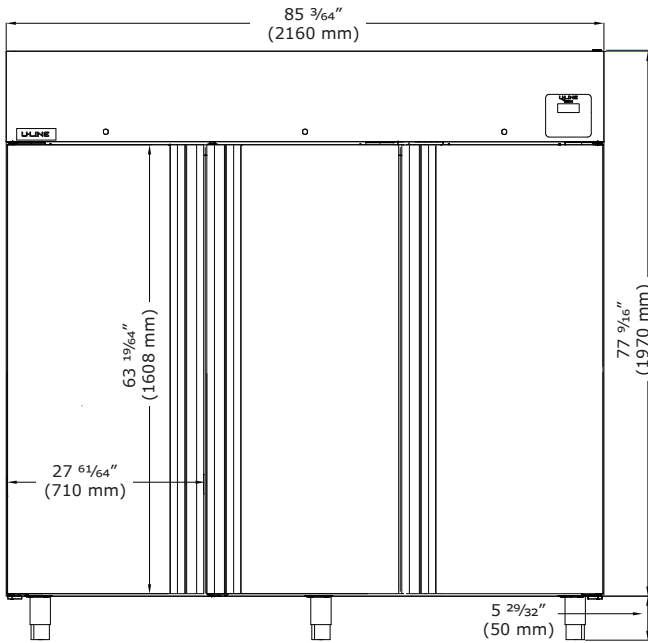

**Front (Open)**

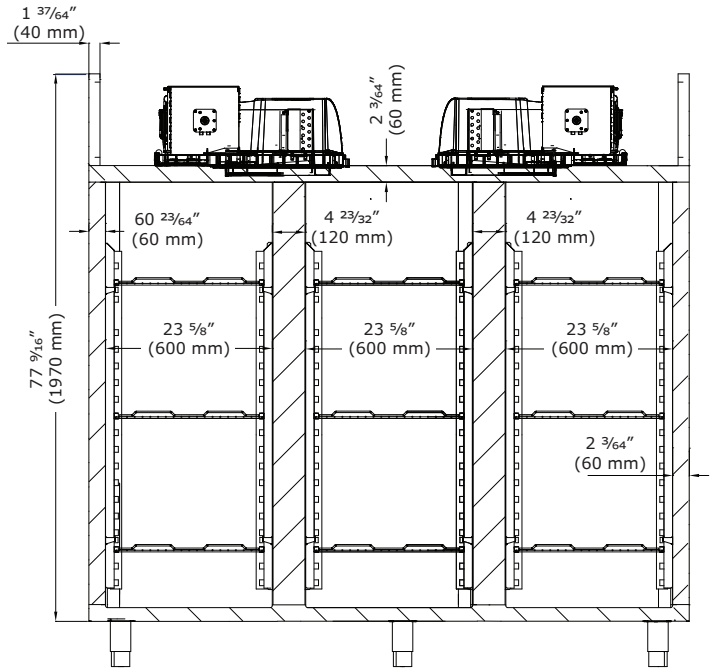

**Front (Closed - Glass Door)**

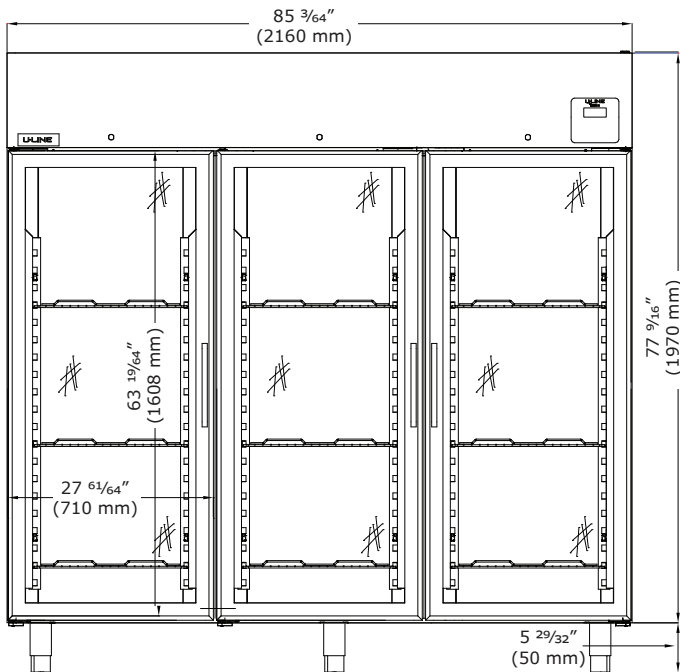

**Side**

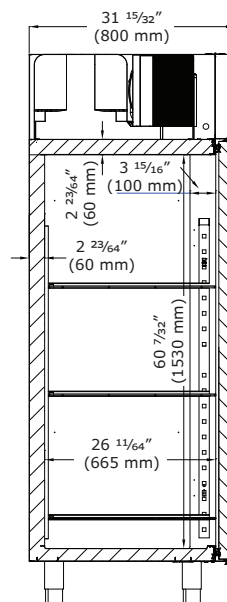

**Top**

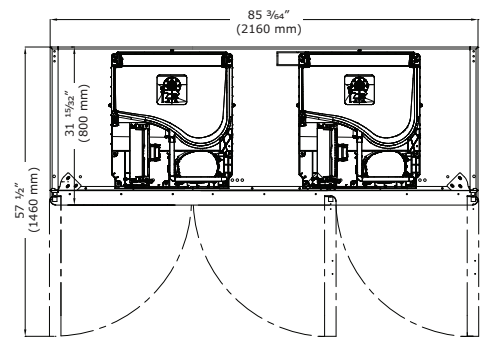

**Commercial Warranty**

1 Year (parts & labor) / 5 year sealed system (parts)  
See complete warranty for details



CFB536: 36" Freezer Chef Base  
CFB548: 48" Freezer Chef Base

CFB560: 60" Freezer Chef Base  
CFB572: 72" Freezer Chef Base



CFB536



CFB548



CFB560



CFB572

### Features and Specifications

CFB536 capacity: 2 drawers holds (2) standard size GN1/1 (12"x20"x4") pans (not included)
CFB548 capacity: 2 drawers holds (4) standard size GN1/1 (12"x20"x4") pans (not included)
CFB560 capacity: 2 drawers holds (4) standard size GN1/1 (12"x20"x4") pans (not included)
CFB572 capacity: 4 drawers holds (8) standard size GN1/1 (12"x20"x4") pans (not included)
AISI 304 stainless steel interior and exterior
Temperature range: -13°F to 14°F
Electronic digital temperature control with alarms
Autodefrost
High efficiency compressor, side mount (CFB536, CFB548, CFB560: 7.3 running amps) (CFB572: 8.7 running amps)
High efficiency evaporator coil & condenser
Self-lubricating, sealed cast iron evaporator fan motor with high volume airflow design
CFC-free high-density polyurethane insulated cabinet
Factory pre-wired for dedicated outlet, 11 ft cord and plug included NEMA 5-15P
Environmentally friendly R449a refrigerant - 16 oz (0.450 kg)
CFB536 dimensions: 26" H x 36" W x 32 1/2" D
CFB548 dimensions: 26" H x 48" W x 32 1/2" D
CFB560 dimensions: 26" H x 60" W x 32 1/2" D
CFB572 dimensions: 26" H x 72" W x 32 1/2" D

### Model Details

Model	Description	Voltage/Hz/Phase	Shipping Weight
UCFB536-SS61A	36" Freezer Chef Base	115v / 60hz / 1	340 lb
UCFB548-SS61A	48" Freezer Chef Base	115v / 60hz / 1	410 lb
UCFB560-SS61A	60" Freezer Chef Base	115v / 60hz / 1	549 lb
UCFB572-SS61A	72" Freezer Chef Base	115v / 60hz / 1	653 lb





# Product Specifications • Freezer Chef Bases

**Front (CFB536)**

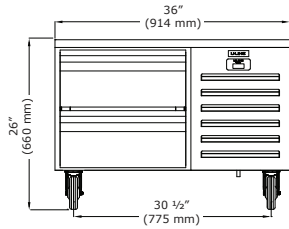

**Side**

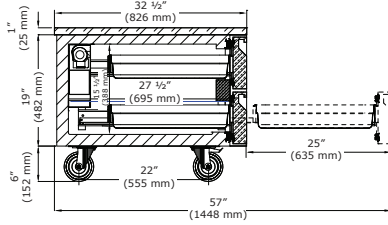

**Top**

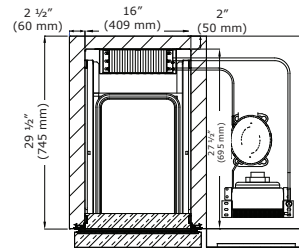

**Front (CFB548)**

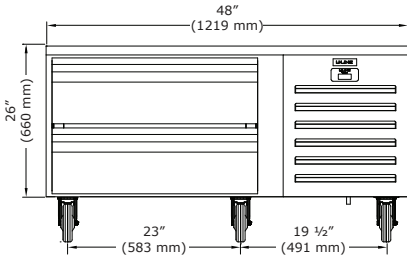

**Side**

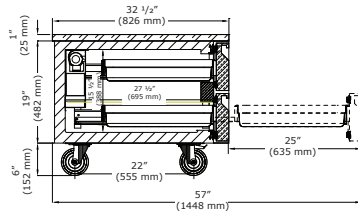

**Top**

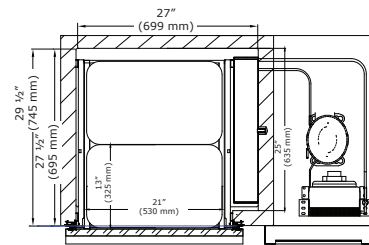

**Front (CFB560)**

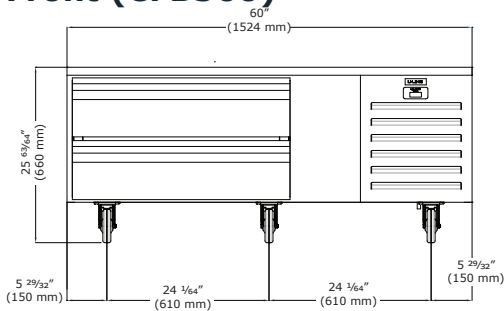

**Side**

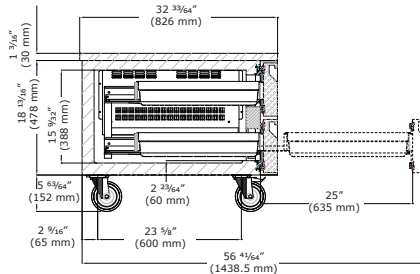

**Top**

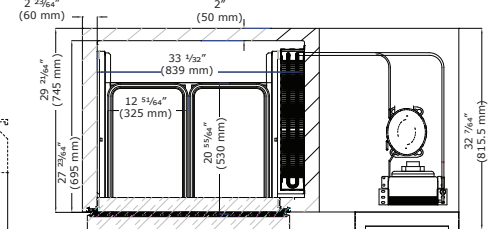

**Front (CFB572)**

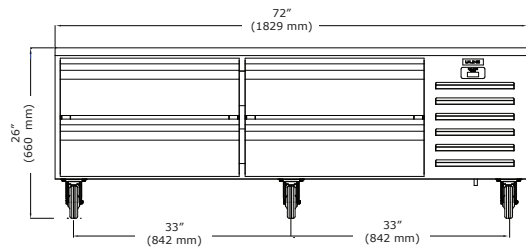

**Side**

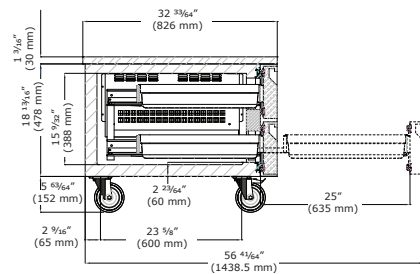

**Top**

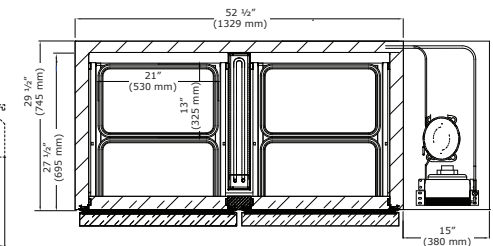

## Commercial Warranty

1 Year (parts & labor) / 5 year sealed system (parts)  
See complete warranty for details



Intertek

**Undercounter Refrigerators**

CRE552: 2 Door Undercounter Refrigerator  
 CRE570: 3 Door Undercounter Refrigerator  
 CRE588: 4 Door Undercounter Refrigerator



CRE552



CRE570



CRE588

**Features and Specifications**

CRE552: volume of 9.88 cu ft, 2 epoxy coated shelves

CRE570: volume of 15.57 cu ft, 3 epoxy coated shelves

CRE588: volume of 21.2 cu ft, 4 epoxy coated shelves

Max weight per shelf: 66 lb

AISI 304 stainless steel interior and exterior

Temperature range: 28°F to 46°F

Electronic Control

Autodefrost

Epoxy coated, sealed evaporator eliminates potential corrosion

CFC-free high density polyurethane insulated cabinet

Factory pre-wired for dedicated outlet, 11 ft cord and plug included NEMA 5-15P

Environmentally friendly R449a refrigerant    CRE552: 41.1 oz (0.400 kg)    CRE570: 17.5 oz (0.500 kg)    CRE588: 17.5 oz (0.500 kg)

CRE552 dimensions: 33" H x 57 <sup>15</sup>/<sub>32</sub>" W x 27 <sup>9</sup>/<sub>16</sub>" D

CRE570 dimensions: 33" H x 76 <sup>37</sup>/<sub>64</sub>" W x 27 <sup>9</sup>/<sub>16</sub>" D

CRE588 dimensions: 33" H x 95 <sup>43</sup>/<sub>64</sub>" W x 27 <sup>9</sup>/<sub>16</sub>" D

**Model Details**

Model	Description	Voltage/Hz/Phase/Amps	Shipping Weight
UCRE552-SS61A	2 Door Undercounter Refrigerator	115 / 60 / 1 / 5	353 lb
UCRE570-SS61A	3 Door Undercounter Refrigerator	115 / 60 / 1 / 5	507 lb
UCRE588-SS61A	4 Door Undercounter Refrigerator	115 / 60 / 1 / 5	551 lb



**Product Specifications • Undercounter Refrigerators**

**Front (CRE552)**

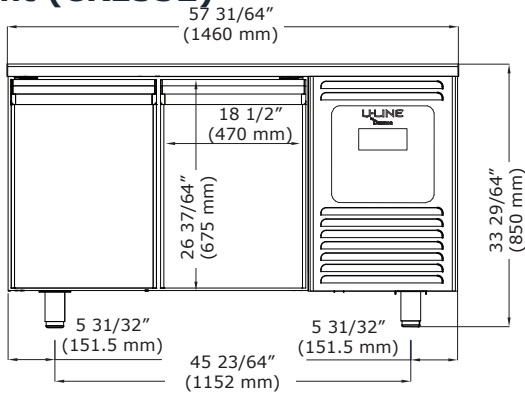

**Top**

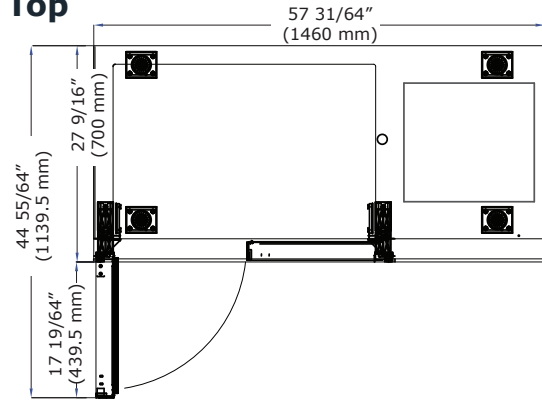

**Front (CRE570)**

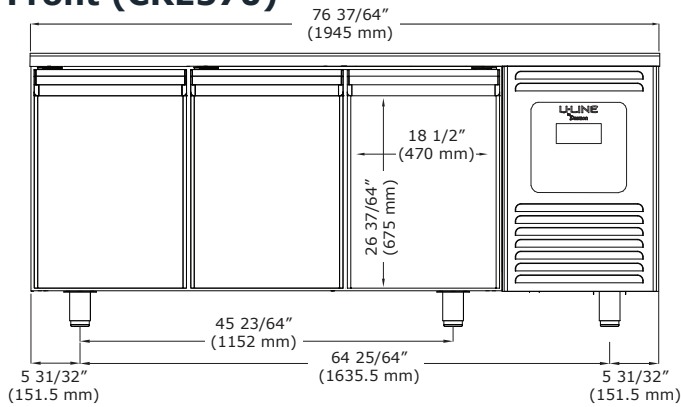

**Top**

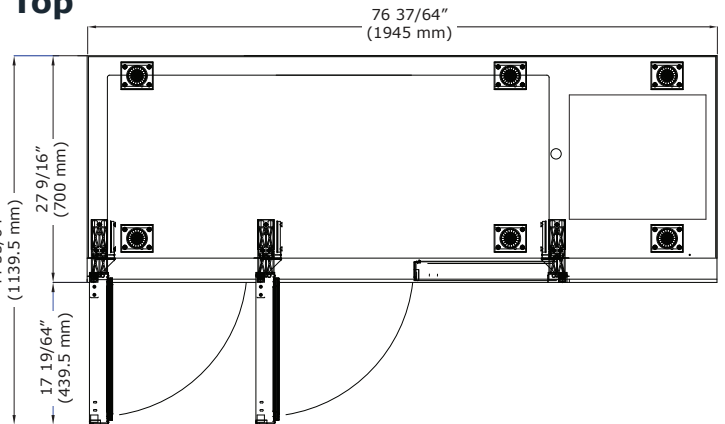

**Front (CRE588)**

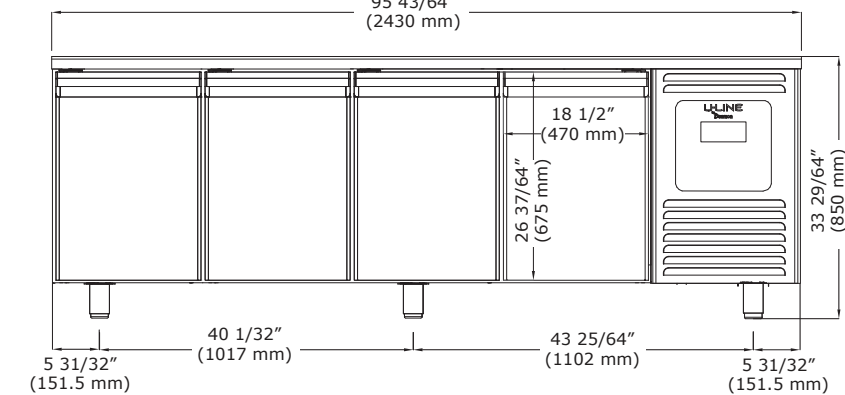

**Top**

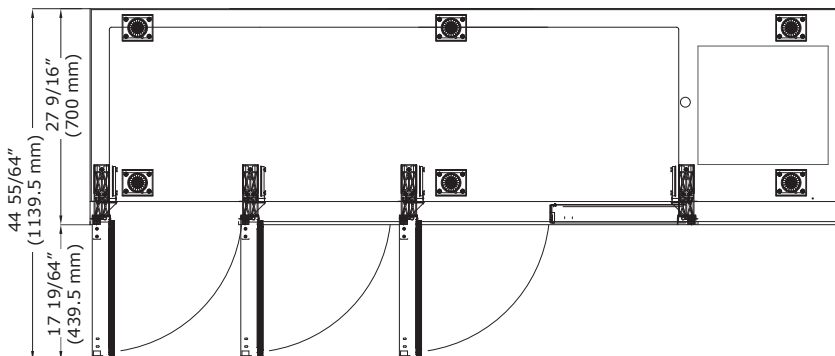

**Side (all models)**

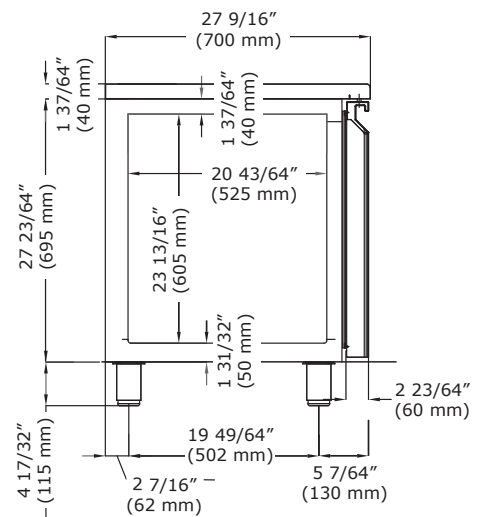

**Commercial Warranty**

1 Year (parts & labor) /  
5 year sealed system (parts)  
See complete warranty for details



CFZ552: 2 Door Undercounter Freezer  
 CFZ570: 3 Door Undercounter Freezer  
 CFZ588: 4 Door Undercounter Freezer



CFZ552



CFZ570



CFZ588

### Features and Specifications

CFZ552: volume of 9.88 cu ft, 2 epoxy coated shelves

CFZ570: volume of 15.57 cu ft, 3 epoxy coated shelves

CFZ588: volume of 21.2 cu ft, 4 epoxy coated shelves

Max weight per shelf: 66 lb

AISI 304 stainless steel interior and exterior

Temperature range: -13°F to 14°F

Electronic Control

Autodefrost

Epoxy coated, sealed evaporator eliminates potential corrosion

CFC-free high density polyurethane insulated cabinet

Factory pre-wired for dedicated outlet, 11 ft cord and plug included NEMA 5-15P

CFZ552 dimensions: 33" H x 57 <sup>15</sup>/<sub>32</sub>" W x 27 <sup>9</sup>/<sub>16</sub>" D

CFZ570 dimensions: 33" H x 76 <sup>37</sup>/<sub>64</sub>" W x 27 <sup>9</sup>/<sub>16</sub>" D

CFZ588 dimensions: 33" H x 95 <sup>43</sup>/<sub>64</sub>" W x 27 <sup>9</sup>/<sub>16</sub>" D

Environmentally friendly R449a refrigerant	CFZ552: 8.1 oz (0.230 kg)	CFZ570: 14.1 oz (0.400 kg)	CFZ588: 14.1 oz (0.400 kg)
--	---------------------------	----------------------------	----------------------------

### Model Details

Model	Description	Voltage/Hz/Phase/Amps	Shipping Weight
UCFZ552-SS61A	2 Door Undercounter Freezer	115 / 60 / 1 / 5	353 lb
UCFZ570-SS61A	3 Door Undercounter Freezer	115 / 60 / 1 / 5	507 lb
UCFZ588-SS61A	4 Door Undercounter Freezer	115 / 60 / 1 / 5	551 lb



**Product Specifications • Undercounter Freezers**

**Front (CFZ552)**

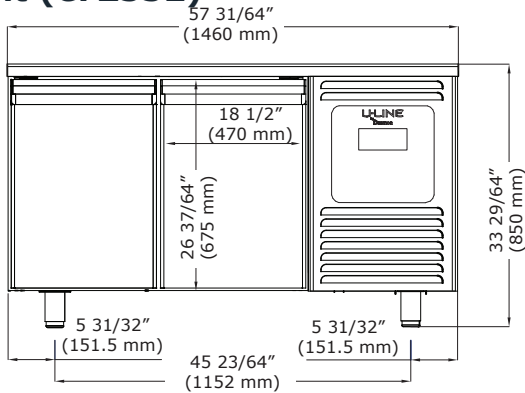

**Top**

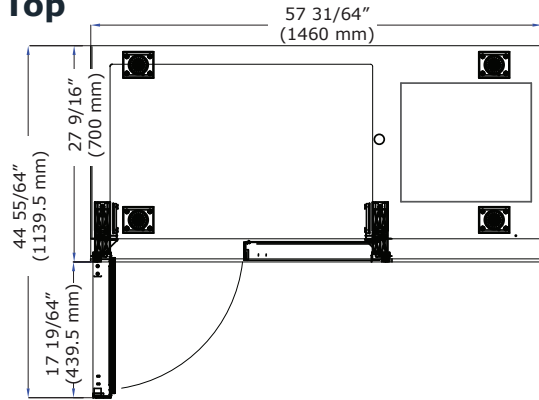

**Front (CFZ570)**

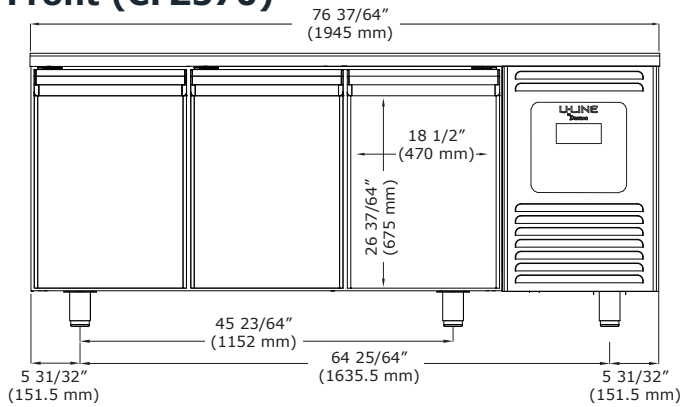

**Top**

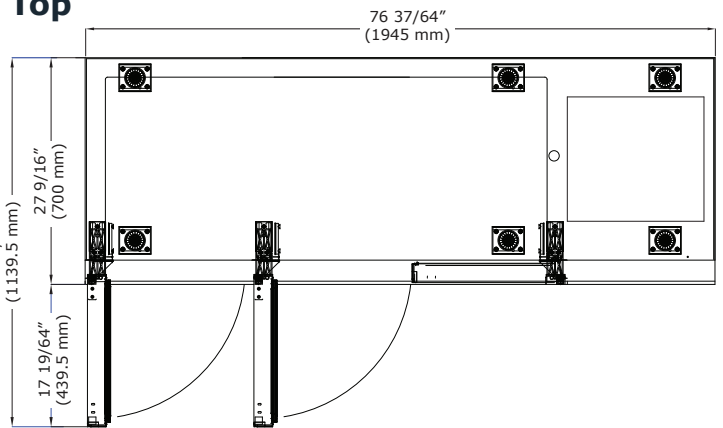

**Front (CFZ588)**

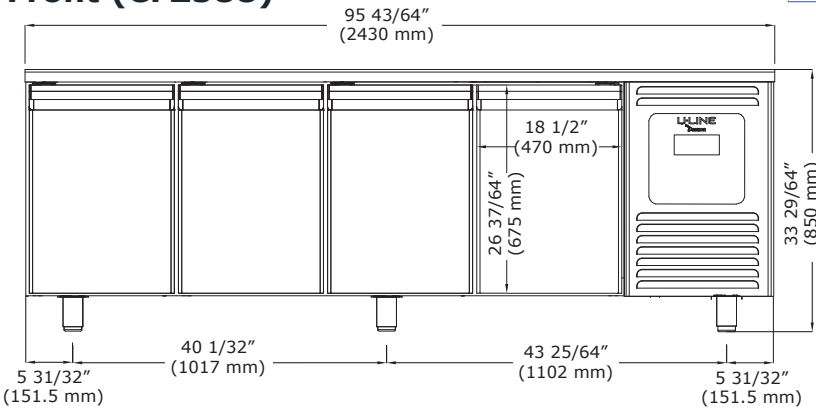

**Top**

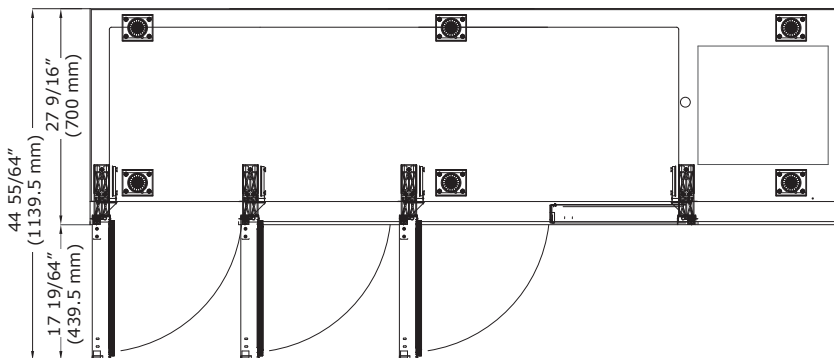

**Side (all models)**

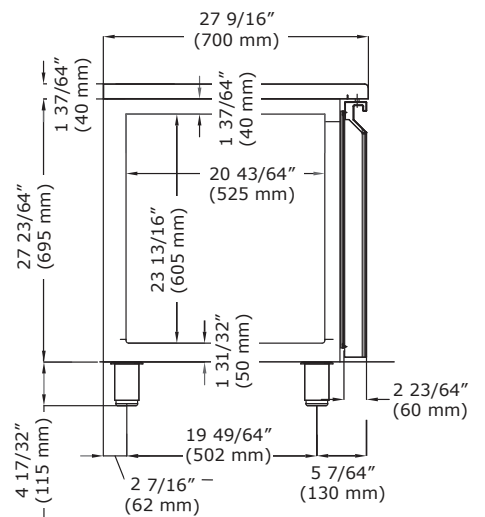

**Commercial Warranty**

1 Year (parts & labor) /  
5 year sealed system (parts)  
See complete warranty for details



# Blast Chillers/Shock Freezers

**CBF432:** 5 Tray Blast Chiller/Shock Freezer, Reach-In

**CBF532:** 10 Tray Blast Chiller/Shock Freezer, Reach-In

**CBF632:** 15 Tray Blast Chiller/Shock Freezer, Reach-In



CBF432



CBF532



CBF632

### Features and Specifications

CBF432 capacity: (5) 18" x 26" sheet pans, (5) 20" x 12" sheet pans, or (2) 12" x 20" x 2 1/2" H steam table pans

CBF532 capacity: (10) 18" x 26" sheet pans, (10) 20" x 12" sheet pans, or (5) 12" x 20" x 2 1/2" H steam table pans

CBF632 capacity: (15) 18" x 26" sheet pans, (15) 20" x 12" sheet pans, or (7) 12" x 20" x 2 1/2" H steam table pans

AISI 304 Stainless steel interior and exterior, ETL sanitation certified

Operating temperature range: -40°F to 50°F

CBF432 blast chilling yield (194°F to 37°F in 90 min): 44.09 lb

CBF432 shock freezing yield (194°F to 0°F in 270 min): 26.46 lb

CBF532 blast chilling yield (194°F to 37°F in 90 min): 77.16 lb

CBF532 shock freezing yield (194°F to 0°F in 270 min): 55.11 lb

CBF632 blast chilling yield (194°F to 37°F in 90 min): 143.3 lb

CBF632 shock freezing yield (194°F to 0°F in 270 min): 110.23 lb

7" digital touch screen control with HACCP data tracker and alarms. Cycles include soft chill, hard chill, soft freeze, hard freeze, thawing, holding, and end of cycle hold mode.

Autodefrost

Multi-core probe with 4 reading points

High efficiency compressor, bottom mount

Self-lubricating, sealed cast iron evaporator fan motor with high volume air flow design

Interior rounded corners, removable door gasket, interior side racks, and evaporator compartment for easy cleaning

CFC-free high-density polyurethane insulated cabinet

Factory pre-wired dedicated outlet with cord, plug not included (Recommended plug CBF 432: NEMA 5-20P, CBF532: NEMA L15-30P, CBF632: NEMA L15-30P)

CBF432: 6400 BTU/h / 1.6 HP

CBF532: 11000 BTU/h / 2.75 HP

CBF632: 8000 BTU/h / 2 HP

Environmentally friendly R452A refrigerant

CBF432: 35.3 oz (1.0 kg)

CBF532: 70.5 oz (2.0 kg)

CBF632: 88.2 oz (2.5 kg)

Self-closing door with 105° stop

CBF432 dimensions: 33 15/32" H x 31 1/2" W x 31 11/16" D

CBF532 dimensions: 64 11/32" H x 31 1/2" W x 32 7/8" D

CBF632 dimensions: 77 5/16" H x 31 1/2" W x 32 7/8" D

4 casters included (2 locking)

### Model Details

Model	Description	Voltage/Hz/Phase/ Amps	Shipping Weight
UCBF432-SS11A	5 Tray Blast Chiller/Shock Freezer, Reach-In, Right Hand Hinge	115v / 60 hz / 1 / 11	287 lb
UCBF532-SS12A	10 Tray Blast Chiller/Shock Freezer, Reach-In Right Hand Hinge	230v / 60 hz / 3 / 10	463 lb
UCBF632-SS12A	15 Tray Blast Chiller/Shock Freezer, Reach-In, Right Hand Hinge	230v / 60 hz / 3 / 16	541 lb





# Product Specifications • Blast Chillers/Shock Freezers

## Front (CBF432) Interior

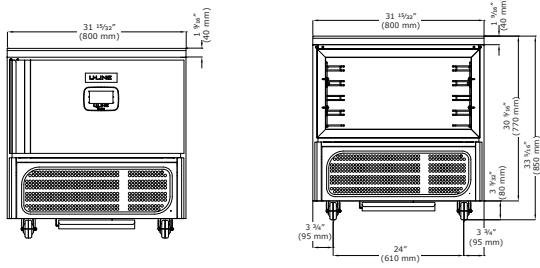

## Side

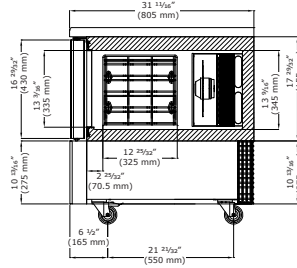

## Top

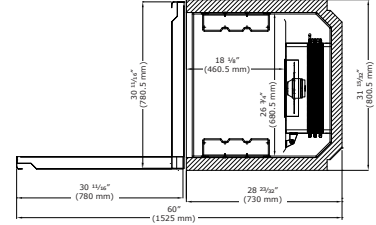

## Front (CBF532) Interior

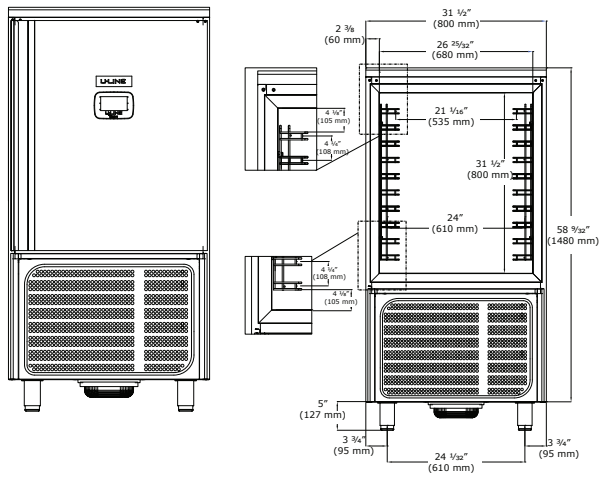

## Side

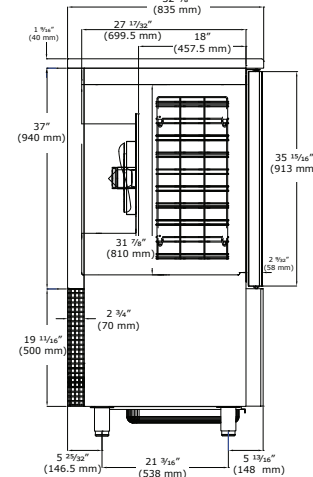

## Top

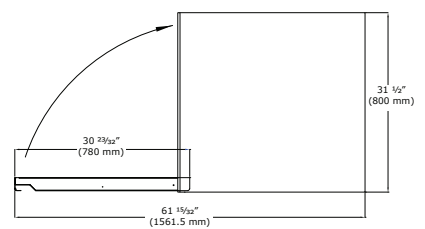

## Front (CBF632) Interior

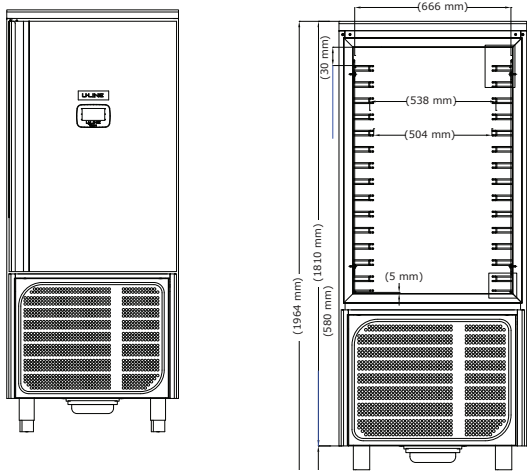

## Side

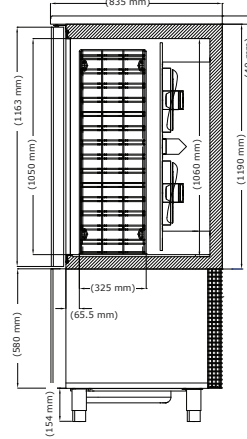

## Top

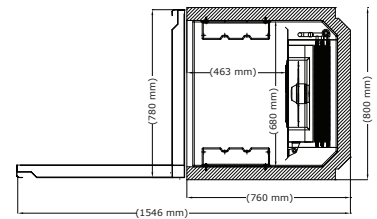

Note: Clearance of 11 13/16" in the back and 19 43/64" on sides & top is required for proper ventilation.

## Commercial Warranty

1 Year (parts & labor) / 5 year sealed system (parts)

See complete warranty for details

\*All tests completed using 2" thick food products



Intertek

**CBF559:** 20 Tray Blast Chiller/Shock Freezer, Roll-in



CBF559

(Cabinet)



(Remote condenser unit)

**Features and Specifications**

Capacity: 1 full-sized speed rack (18" x 26" sheet pans) or 1 combi cart (70.055" H x 30.35" W x 35.15" D)
AISI 304 Stainless steel interior and exterior, ETL sanitation certified
Operating temperature range: -40°F to 50°F
Blast chilling yield (194°F to 37°F in 90 min): 440.93 lb   Shock freezing yield (194°F to 0°F in 270 min): 385.81 lb
7" digital touch screen control with HACCP data tracker and alarms. Cycles include soft chill, hard chill, soft freeze, hard freeze, thawing, holding, and end of cycle hold mode.
Autodefrost
Multi-core probe with 4 reading points
Remote condensing unit included (assembly required). 33' run distance
Self-lubricating, sealed cast iron evaporator fan motor with high volume air flow design
Interior rounded corners, removable door gasket, interior side racks, and evaporator compartment for easy cleaning
Environmentally friendly R452A refrigerant: 212 oz (6.0 kg)
Self-closing door with 105° stop. Lock included.
Cabinet dimensions: 88 7/8" H x 59 1/16" W x 52 11/16" D
Remote condenser unit dimensions: 28"H x 56 1/8" W x 40 1/2" D
5 1/2" ramp included

**Model Details**

Model	Description	Voltage/Hz/Phase/Amps	Shipping Weight
UCBF559-SS12A	20 Tray Blast Chiller/Shock Freezer, Roll-in (Cabinet)	230 / 60 / 1 / 4	1,565 lbs
	Remote Condenser	230 / 60 / 3 / 15	



**Product Specifications • Blast Chiller/Shock Freezer**

**Top**

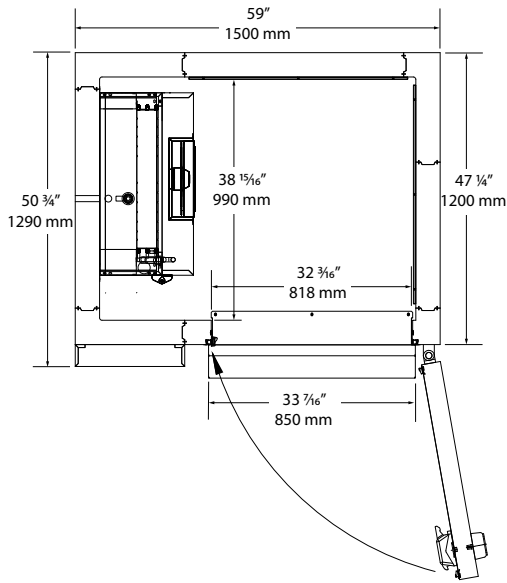

**Remote Condensing Unit**

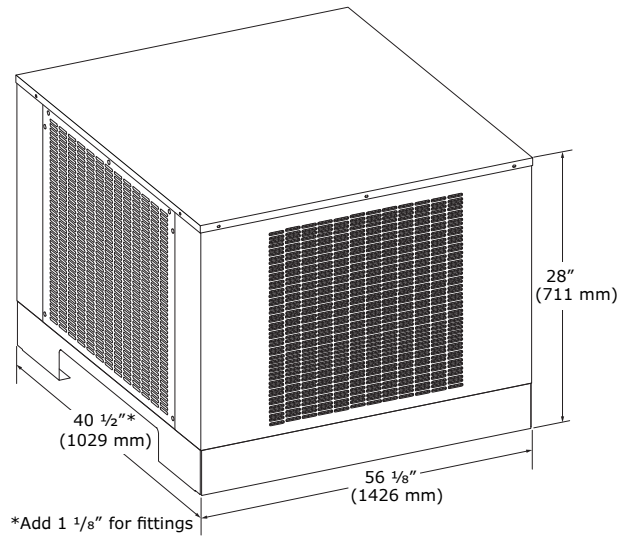

**Front**

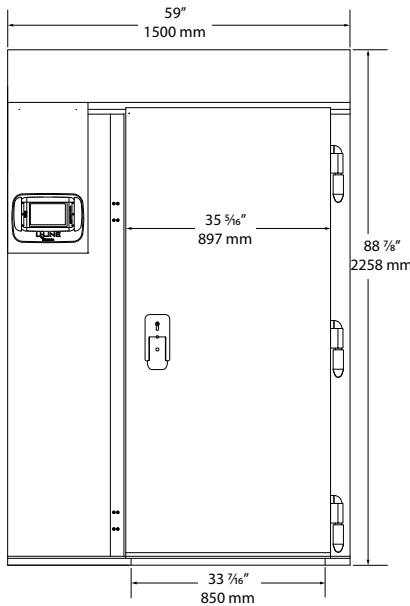

**Side**

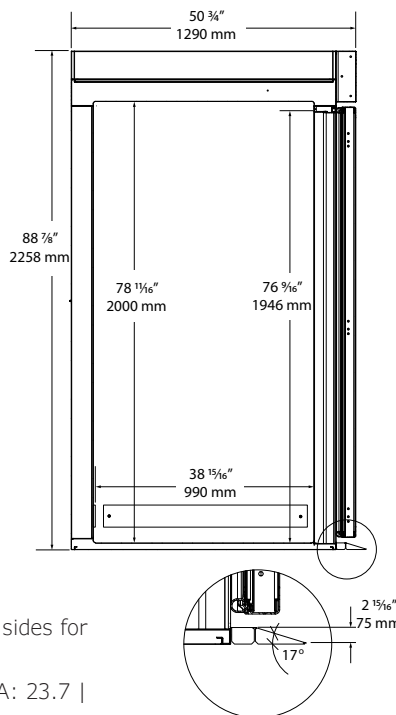

**Interior**

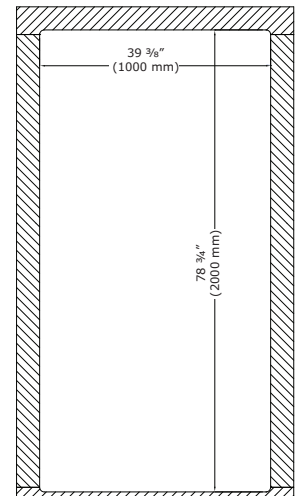

Note: Condensing unit requires clearance of 39 3/8" on all sides for proper ventilation.

Remote condenser unit 300,000 BTU/h / 7.5 HP RLA: 23.7 | LRA: 107 | MCA: 34.725 | MOP: 58.425

**Commercial Warranty**

1 Year (parts & labor) / 5 year sealed system (parts)  
See complete warranty for details

\*All tests completed using 2" thick food products



# Refrigerated Pizza Prep-Table

CPP466: 65" 2 Door Refrigerated Pizza Prep Table

CPP488: 88" 3 Door Refrigerated Pizza Prep Table



CPP466



CPP488

### Features and Specifications

CPP466: volume of 14 cu ft	CPP488: volume of 21.89 cu ft	
AISI 304 stainless steel interior and exterior with granite worktop, ETL sanitation certified		
Temperature range: 28°F to 46°F		
Electronic digital temperature control with alarms		
Autodefrost		
High efficiency compressor, side mount, with 5 running amps		
Epoxy coated, sealed evaporator eliminates potential corrosion		
Self-lubricating, sealed cast iron evaporator fan motor with high volume airflow design		
Interior rounded corners for easy cleaning		
CFC-free high-density polyurethane insulated cabinet		
Factory pre-wired for dedicated outlet, 11 ft cord and plug included NEMA 5-15P		
Environmentally friendly R449a refrigerant	CPP466: 10.6 oz (0.280 kg)	CPP488: 17.5 oz (0.500 kg)
CPP466 includes 2 epoxy coated wire shelves	CPP488 includes 3 epoxy coated wire shelves	
CPP466 Dimensions: 40 5/16" H x 65 1/8" W x 31 15/32" D	CPP488 Dimensions: 40 5/16" H x 88 3/8" W x 31 15/32" D	

### Model Details

Model	Description	Voltage/Hz/Phase	Shipping Weight
UCPP466-SS61A	65" 2 Door Refrigerated Pizza Prep Table	115v / 60hz / 1	662 lb
UCPP488-SS61A	88" 3 Door Refrigerated Pizza Prep Table	115v / 60hz / 1	882 lb

### Accessories

Model	Description	Shipping Weight
ULA4082514	Shelf Guide	.88 lb
ULAQ32-4666-ETL	Epoxy Coated Wire Shelf	2.2 lb
ULAGN-1315-T	Stainless GN 1/3 Pan (6.93" x 12.79" x 5.9")	1.67 lb
ULAGNC-13	Stainless GN 1/3 Pan Top (6.93" x 12.79")	.77 lb
ULAGN-1615	Stainless GN 1/6 Pan (6.93" x 6.37" x 5.9")	.88 lb
ULAGNC-16	Stainless GN 1/6 Pan Top (6.93" x 6.37")	.77 lb
ULAGN-2815	Stainless GN 2/8 Pan (UCPP466 Only) (5.19" x 12.79" x 5.9")	1.3 lb
ULAGNC-28	Stainless GN 2/8 Pan top (UCPP466 Only) (5.19" x 12.79")	.77 lb



**Product Specifications • Refrigerated Pizza Prep Table**

**Front (2 Door)**

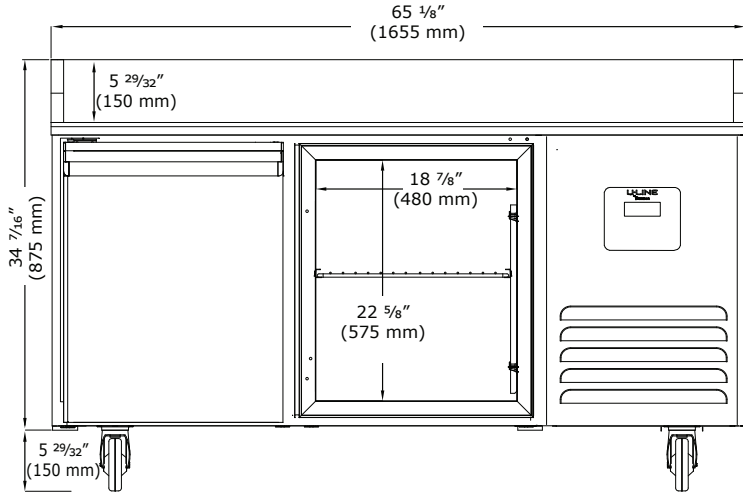

**Side**

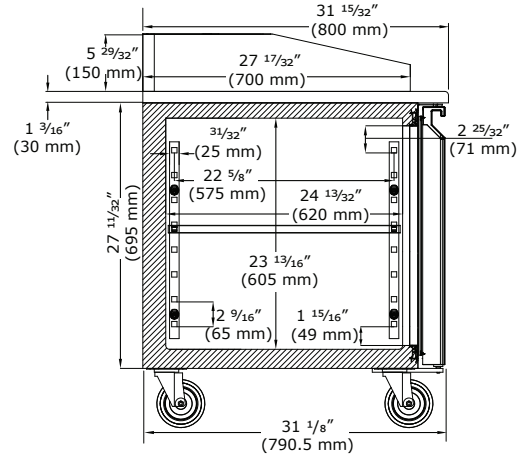

**Front (3 Door)**

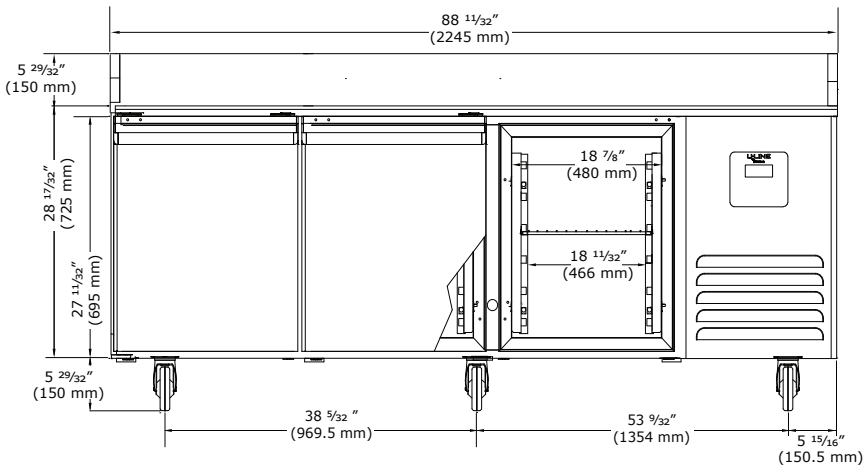

**Top**

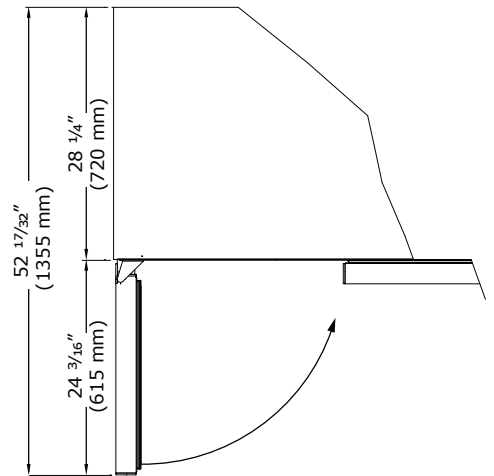

**Commercial Warranty**

1 Year (parts & labor) / 5 year sealed system (parts)  
See complete warranty for details



**Intertek**

# Refrigerated Pizza Prep Table

**CPP566:** 65" 2 Door Refrigerated Pizza Prep Table + Condiment Rail

**CPP588:** 88" 3 Door Refrigerated Pizza Prep Table + Condiment Rail



CPP566



CPP588

### Features and Specifications

CPP566: volume of 14 cu ft	CPP588: volume of 21.89 cu ft
Pans not included	
AISI 304 stainless steel interior and exterior with granite worktop and refrigerated condiment rail, ETL sanitation certified	
Temperature range: 28°F to 46°F	
Electronic digital temperature control with alarms	
Autodefrost	
High efficiency compressor, side mount, with 6.5 running amps	
High efficiency evaporator coil & condenser	
Self-lubricating, sealed cast iron evaporator fan motor with high volume airflow design	
Interior rounded corners for easy cleaning	
CFC-free high-density polyurethane insulated cabinet	
Factory pre-wired for dedicated outlet, 11 ft cord and plug included NEMA 5-15P	
Environmentally friendly R449a/R134a (top) refrigerant	CPP566: 10.6 oz (0.280 kg) / 7.0 oz (0.200 kg)      CPP588: 17.5 oz (0.500 kg) / 8.8 oz (0.250 kg)
CPP566 includes 4 epoxy coated wire shelves	CPP588 includes 6 epoxy coated wire shelves
CPP566 dimensions: 63 15/16" H x 65 1/8" W x 31 1/8" D	CPP588 dimensions: 63 15/16" H x 88 11/32" W x 31 1/8" D

### Model Details

Model	Description	Voltage/Hz/Phase	Shipping Weight
UCPP566-SS61A	65" 2 Door Refrigerated Pizza Prep Table + Condiment Rail	115v / 60hz / 1	772 lb
UCPP588-SS61A	88" 3 Door Refrigerated Pizza Prep Table + Condiment Rail	115v / 60hz / 1	992 lb

### Accessories

Model	Description	Shipping Weight
ULA4082514	Shelf Guide	.88 lb
ULAQ32-4666-ETL	Epoxy Coated Wire Shelf	2.2 lb
ULAGN-1315-T	Stainless GN 1/3 Pan (6.93" x 12.79" x 5.9")	1.67 lb
ULAGNC-13	Stainless GN 1/3 Pan Top (6.93" x 12.79")	.77 lb
ULAGN-2815	Stainless GN 2/8 Pan (UCPP566 Only) (5.19" x 12.79" x 5.9")	1.3 lb
ULAGNC-28	Stainless GN 2/8 Pan top (UCPP566 Only) (5.19" x 12.79")	.77 lb
ULAGN-1615	Stainless GN 1/6 Pan (UCPP566 Only) (6.93" x 6.38" x 5.9")	.88 lb
ULAGNC-16	Stainless GN 1/6 Pan top (UCPP566 Only) (6.93" x 6.38")	.77 lb





# Product Specifications • Refrigerated Pizza Prep Table

## Front (2 Door with Condiment Rail)

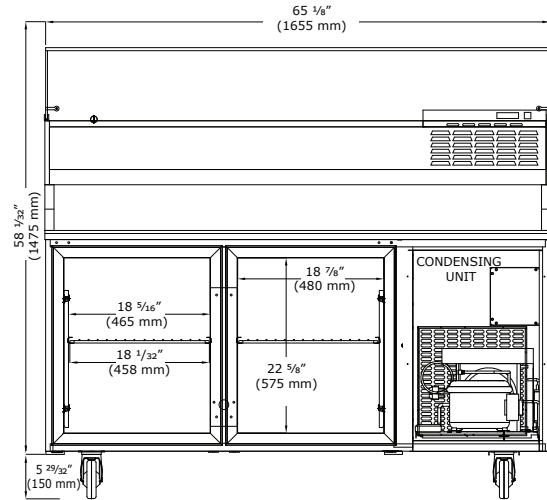

## Side

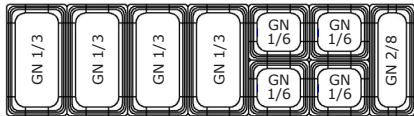
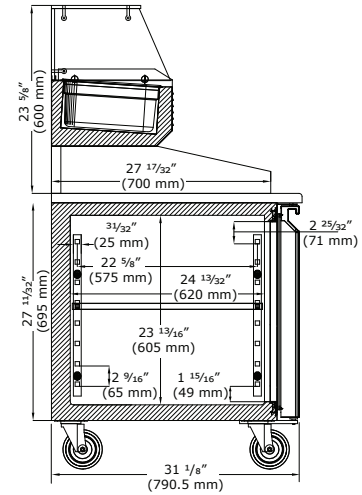

CPP566 condiment rail (for reference only - pans not included)

## Front (3 Door with Condiment Rail)

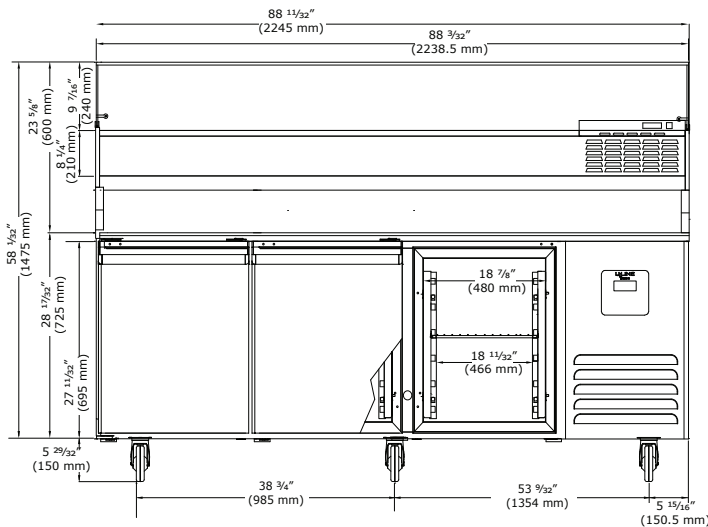

## Top

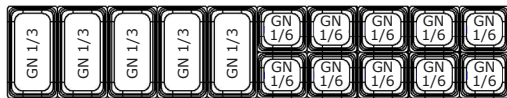
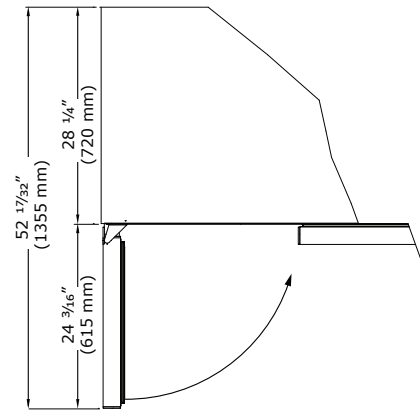

CPP588 condiment rail (for reference only - pans not included)

### Commercial Warranty

1 Year (parts & labor) / 5 year sealed system (parts)  
See complete warranty for details



## Product Specifications Refrigerated Prep Table

**CPT565:** 65" 2 Door Refrigerated Prep Table + Sealed Condiment Rail

**CPT588:** 88" 3 Door Refrigerated Prep Table + Sealed Condiment Rail



CPT565



CPT588

### Features and Specifications

CPT565: volume of 14.95 cu ft	CPT588: volume of 21.89 cu ft	
Pans not included		
AISI 304 stainless steel interior & exterior with refrigerated sealed condiment rail and removable plastic catch trays		
Base temperature range: 28°F to 46°F	Condiment rail temperature range: 36°F to 50°F	
Electronic digital temperature control with alarms		
Autodefrost		
CPT565: high efficiency compressor with 7 running amps		
CPT588: high efficiency compressor, side mount with 9 running amps		
Epoxy coated, sealed evaporator eliminates potential corrosion		
Self-lubricating, sealed cast iron evaporator fan motor with high volume airflow design		
Interior rounded corners for easy cleaning		
CFC-free high-density polyurethane insulated cabinet		
Factory pre-wired for dedicated outlet, 11 ft cord and plug included NEMA 5-15P		
Environmentally friendly 449a refrigerant	CPT565: 35 oz (1.0 kg)	CPT588: 49 oz (1.4 kg)
CPT565 includes 2 epoxy coated wire shelves	CPT588 includes 3 epoxy coated wire shelves	
CPT565 dimensions: 63 11/16" H x 65 5/16" W x 36 5/8" D	CPT588 dimensions: 63 11/16" H x 88 5/16" W x 36 5/8" D	

### Model Details

Model	Description	Voltage/Hz/Phase	Shipping Weight
UCPT565-SS61A	65" 2 Door Refrigerated Prep Table + Sealed Condiment Rail	115v / 60hz / 1	653 lb
UCPT588-SS61A	88" 3 Door Refrigerated Prep Table + Sealed Condiment Rail	115v / 60hz / 1	741 lb

### Accessories

Model	Description	Shipping Weight
ULA4082514	Shelf Guide	.88 lb
ULAQ32-4666-ETL	Epoxy Coated Wire Shelf	2.2 lb
ULAGN-1315-T	Stainless GN 1/3 Pan (6.93" x 12.79" x 5.9")	1.67 lb
ULAGNC-13	Stainless GN 1/3 Pan Top (6.93" x 12.79")	.77 lb
ULAGN-2815	Stainless GN 2/8 Pan (UCPT565 Only) (5.19" x 12.79" x 5.9")	1.3 lb
ULAGNC-28	Stainless GN 2/8 Pan top (UCPT565 Only) (5.19" x 12.79")	.77 lb



# Product Specifications • Refrigerated Prep Table

## Front (2 Door)

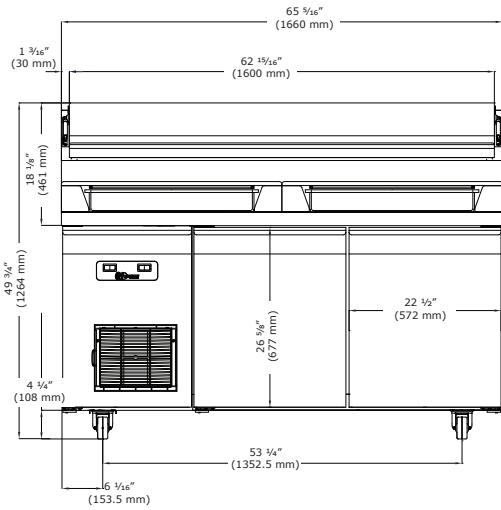

## Front (3 Door)

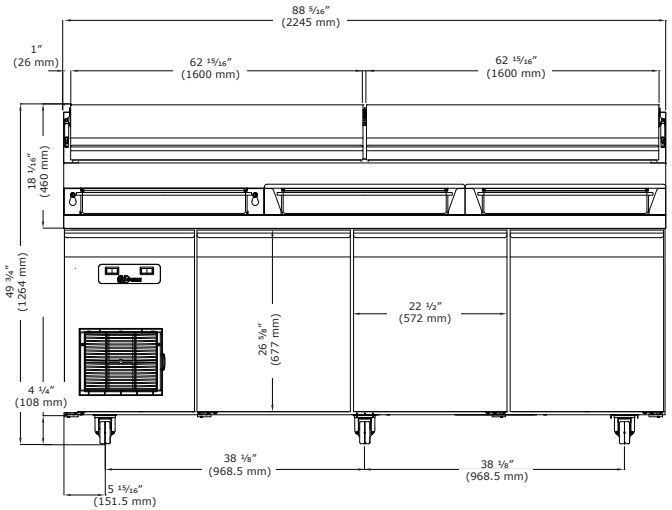

## Side

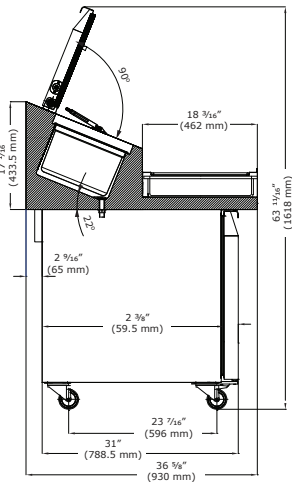

## Top (2 Door)\*

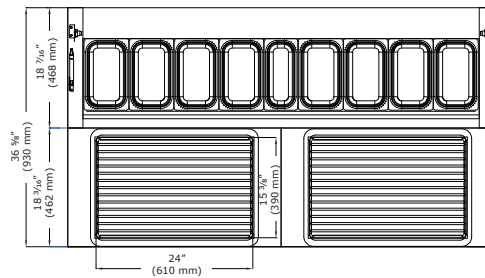

## Top (3 Door)\*

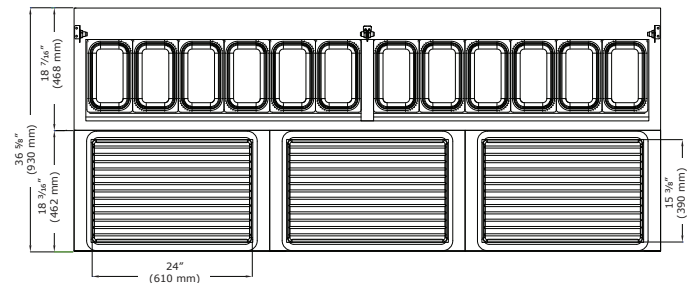

\*Pans not included

### Commercial Warranty

1 Year (parts & labor) / 5 year sealed system (parts)  
See complete warranty for details



Complies with NSF/ANSI 7 Standard



# Prep Top Glass Coolers

CGAC166: 66" Prep Top Glass Cooler

CGAC223: 88" Prep Top Glass Cooler



CGAC166



CGAC223

### Features and Specifications

CGAC166 storage capacity: 7 GN 1/3 pans (not included)

CGAC223 storage capacity: 10 GN 1/3 pans (not included)

Stainless Steel and Glass Construction

Temperature range: 28°F to 46°F

Electronic Control

Factory pre-wired for dedicated outlet, 11 ft cord and plug included NEMA 5-15P

Environmentally friendly R134a refrigerant

CGAC166: 7.0 oz (0.200 kg)

CGAC223: 8.8 oz (0.250 kg)

### Model Details

Model	Description	Voltage/Hz/Phase/Amps	Shipping Weight
UCGAC166	66" Prep Top Glass Cooler	115 / 60 / 1 / 1.5	137 lb
UCGAC223	88" Prep Top Glass Cooler	115 / 60 / 1 / 1.5	165 lb

### Accessories

Model	Description	Shipping Weight
ULAGN-1315-T	Stainless GN 1/3 Pan (6.93" x 12.79" x 5.9")	1.67 lb
ULAGNC-13	Stainless GN 1/3 Pan Top (6.93" x 12.79")	.77 lb
ULAGN-2815	Stainless GN 2/8 Pan (5.19" x 12.79" x 5.9")	1.3 lb
ULAGNC-28	Stainless GN 2/8 Pan top (5.19" x 12.79")	.77 lb
ULAGN-1615	Stainless GN 1/6 Pan (6.93" x 6.38" x 5.9")	.88 lb
ULAGNC-16	Stainless GN 1/6 Pan top (6.93" x 6.38")	.77 lb

### UCGAC166

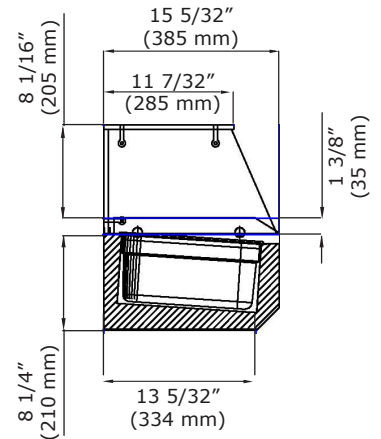
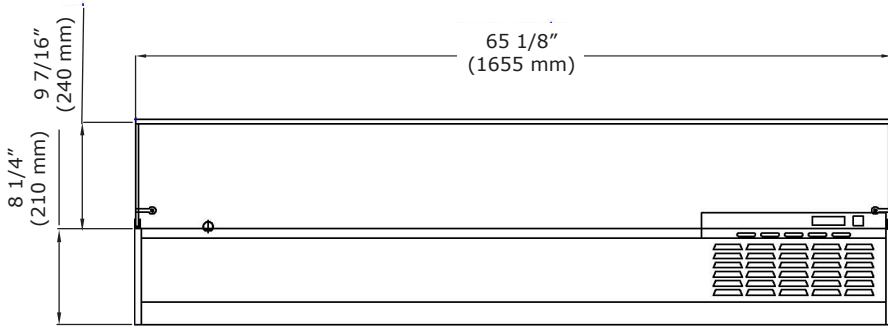

For reference only - pans not included

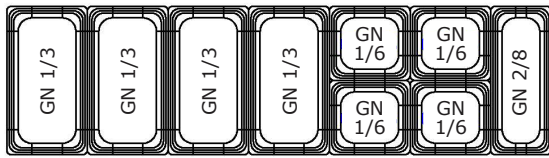

### UCGAC223

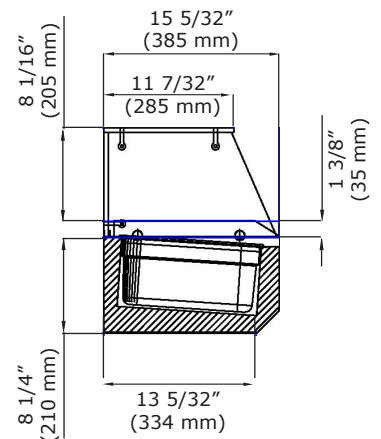
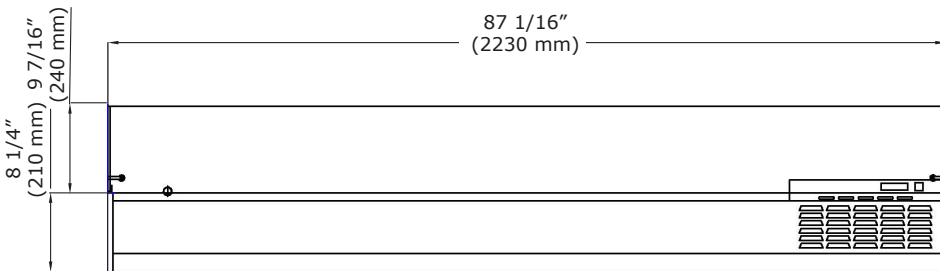

For reference only - pans not included

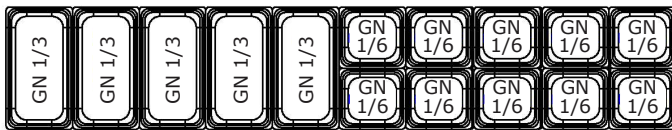

### Commercial Warranty

1 Year (parts & labor) / 5 year sealed system (parts)  
See complete warranty for details



CCATP: 6 Drawer Storage Cabinet



CCATP

### Top

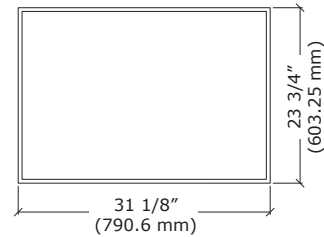

### Front

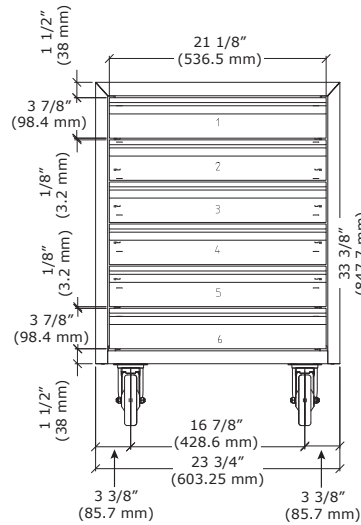

### Side

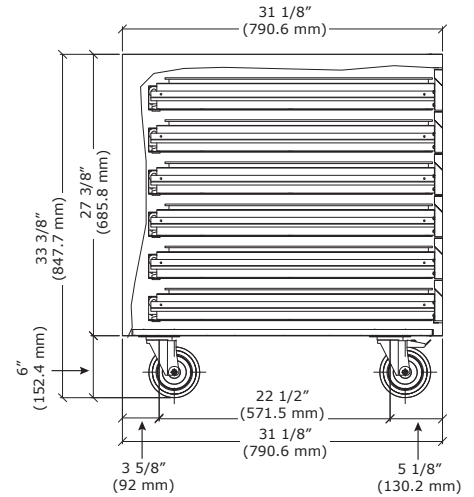

### Features and Specifications

- AISI 304 stainless steel interior and exterior
- Prep table storage companion
- Perfect pizza dough storage
- 6 Drawers
- Casters included

### Model Details

Model	Description	Shipping Weight
UCCATP	6 Drawer Storage Cabinet	132 lb

### Commercial Warranty

1 Year (parts & labor) / 5 year sealed system (parts)  
See complete warranty for details









# Cool to the Last Drop

U-Chill® is an in-counter cooling cylinder that maintains the temperature of chilled beverages while they are being enjoyed. Perfect for wine, champagne, craft beer, carafes, bottled water, spirits, and other beverages.

This truly unique product integrates into any surface and incorporates into almost any setting - from bars to tables, spas to suites. U-Chill® is maintenance free, easy to clean, and nearly silent in operation. With 27 different color lighting options to gently light the bottle, this interactive, beautiful, and functional piece creates a one of a kind experience for your guests.





**Product Specifications**  
**UCC1A • U-Chill®**



**Smart-Touch Crown**

- Control with just a touch
- Hand-polished marine-grade stainless steel (316L)
- Powers off automatically after 4 hours

**Interactive LED Lighting**

- 27 different color options
- Optional color-flow setting

**Simple Installation**

- Installs in 6 1/16" diameter opening in countertops from 1/16" to 2 1/2" thick
- Plugs into standard 115v/60Hz outlet
- AC/DC adapter included
- Width: 6 5/16"
- Height: 11 13/16"

**Patented Kryolux™ Technology\***

- Dry cooling
- Cold jacket of air surrounds your beverage
- Optimal ambient temp. range: 50°F - 90°F
- Energy efficient
- Near-silent operation

**Surface Cutout**

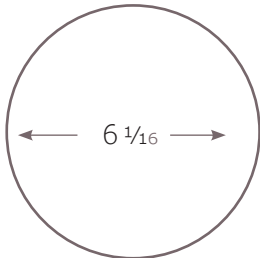

Use 6" hole saw

**Minimum Space Below Crown**

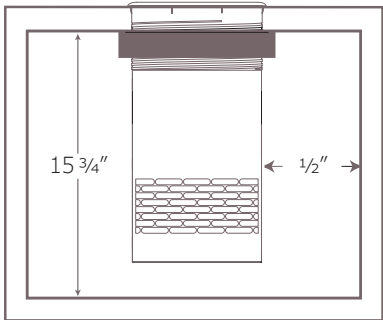

**Craftsmanship Handmade in England**

U-Line backs each U-Chill® with a 2 year warranty

**Model Details**

Model	Description	Finish	Shipping Weight
UCC1A	U-Chill® In-Counter Cooling Cylinder	Stainless	7 lb

\*Kryolux™ is a registered trademark of Kaelo LTD.





### CUSTOMER CARE

Our Customer Care group is equipped with the knowledge and skills to find a solution for you, and fast. Our facility is equipped to handle any service request. With live products readily available for diagnostics, our Customer Care group can walk you through a solution while doing it themselves on the same model. Our efficient call center management system ensures minimal wait time for consumers. We believe product support should be quick, simple, and frustration-free.

### INQUIRIES

Monday - Friday 8:00 am to 4:30 pm CST  
8900 North 55th Street  
Milwaukee, Wisconsin 53223 USA  
T: +1.414.354.0300  
Inquiries: [commercial@u-line.com](mailto:commercial@u-line.com)  
Customer Care: [customercare@u-line.com](mailto:customercare@u-line.com)  
[u-line.com/commercial](http://u-line.com/commercial)

