

## ELECTRIC TILTING SKILLET



- ETS-30
- ETS-40

### OPERATION SHALL BE BY:

Electric heating elements equipped for operation on:

- 208 VAC, 1 or 3 phase, 50/60 Hz
- 220 VAC, 1 or 3 phase, 50/60 Hz
- 240 VAC, 1 or 3 phase, 50/60 Hz
- 380/220 VAC, 3 phase, 50/60 Hz
- 415/240 VAC, 3 phase, 50/60 Hz

### OPTIONS & ACCESSORIES AT ADDITIONAL COST

- |  |  |  |
|--|--|--|
| <input type="checkbox"/> 380 VAC, 3 phase, 50/60 Hz                      | <input type="checkbox"/> 3" (76 mm) draw-off valve with strainer (TVT-3)               | <input type="checkbox"/> 12" Double pantry faucet with swing spout (DF-12)     |
| <input type="checkbox"/> 415 VAC, 3 phase, 50/60 Hz                      | <input type="checkbox"/> 60 minute mechanical timer mounted on left console            | <input type="checkbox"/> Single pantry rinse spray head with 68" hose (SP-RSH) |
| <input type="checkbox"/> 480 VAC, 3 phase, 50/60 Hz                      | <input type="checkbox"/> 4" All swivel casters, (2) with foot brakes, set of 4 (SCK-1) | <input type="checkbox"/> Double pantry rinse spray head with 68" hose (DP-RSH) |
| <input type="checkbox"/> Etched liter markings (LMS-30, LMS-40)          | <input type="checkbox"/> Correctional package  | <input type="checkbox"/> Faucet bracket (FB)                                   |
| <input type="checkbox"/> 2" (51 mm) draw-off valve with strainer (TVT-2) | <input type="checkbox"/> Pan carrier (PC-1)  |  |
|  | <input type="checkbox"/> Steam pan insert (SPI-30, SPI-40)                             |  |
|  | <input type="checkbox"/> 12" Single pantry faucet with swing spout (SF-12)             |  |

### STANDARD CONSTRUCTION SPECIFICATIONS

Shall be a Crown model ETS-30 or ETS-40, electrically heated tilting skillet, c-CSA-us and NSF Certified.

The skillet shall be of one piece covered corner, 10 gauge T-304 stainless steel with a #4 exterior finish and a polished interior with etched gallon markings.

Heating shall be accomplished by electric elements embedded in a full 1-3/8" (35 mm) thick aluminum casting bolted to the underside of the pan for even heat distribution across the entire surface.

Pan shall pivot on side trunnions connected to the gear and control consoles.

The consoles shall be drip proof, stainless steel clad and shall be supported by an all welded 1-5/8" (41 mm) stainless steel pipe frame with front legs fitted with adjustable bullet feet and rear legs fitted with flange adjustable feet for securing to the floor.

The worm and gear tilt mechanism shall allow the pan to tilt forward manually for complete emptying of contents.

The controls shall be integrally mounted in the left console and shall include a thermostat, power switch and pilot light.

As a safety feature the pan shall be equipped with a high limit thermostat on each element assembly to shut down operation should the thermostat fail.

Convenience features shall include a spring assist hinged stainless steel cover with handle and no drip condensate guide, vent port with swing cover and a removable pour strainer on the pour lip.

The skilled shall operate in a temperature range of 160°F to 445°F (71°C to 229°C) with a high temperature safety cut-off at 500°F (260°C).



Approval Notes: \_\_\_\_\_

\_\_\_\_\_

Models:  ETS-30  ETS-40

ETS

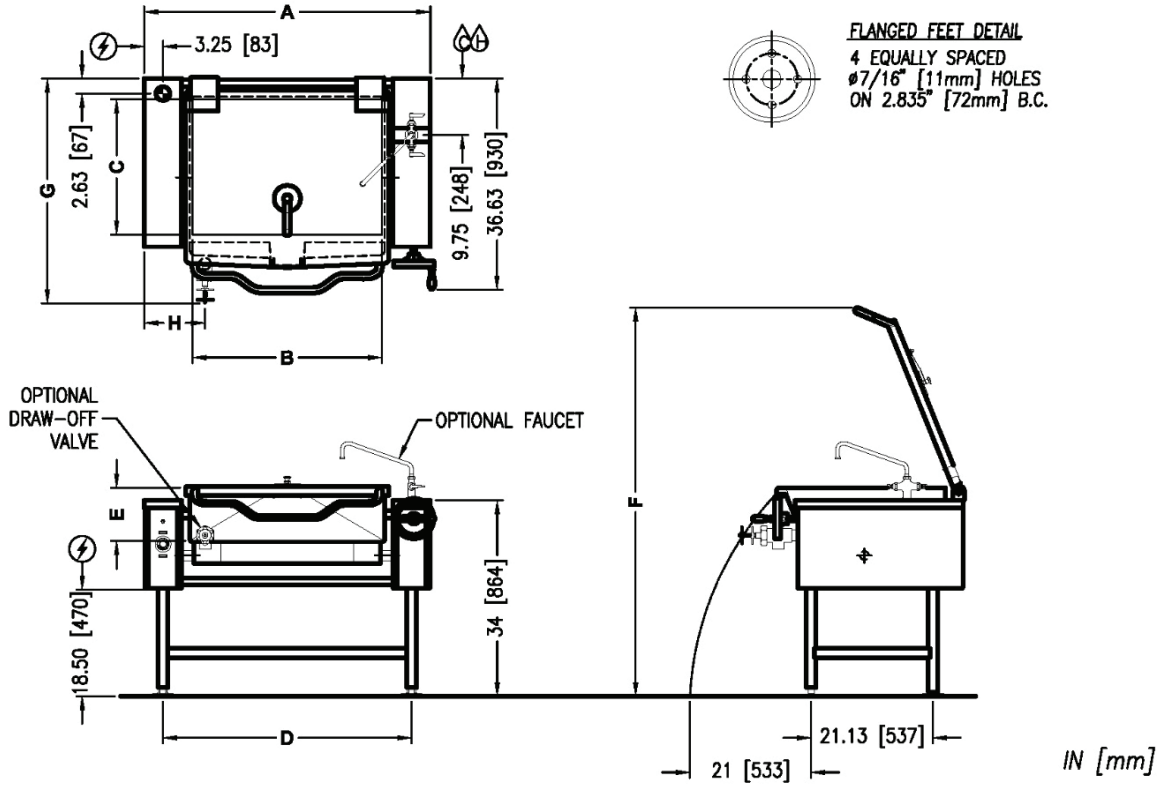

**SERVICE CONNECTIONS**

⚡ – ELECTRICAL CONNECTION: As specified on data plate.

**DIMENSIONS**

MODEL	CAPACITY	A	B	C	D	E	F	G		H	
								Ø2	Ø3	Ø2	Ø3
ETS-30	30 Gallons (114 liters)	49.75" (1264)	32.88" (835)	23.50" (597)	43.13" (1095)	9.25" (235)	67.63" (1718)	39" (991)	43.5" (1105)	10.63" (370)	11.13" (283)
ETS-40	40 Gallons (152 liters)	59" (1499)	42.88" (1089)	23" (584)	52.50" (1334)	9.25" (235)	67.63" (1715)	38.75" (984)	43.25" (1099)	10.25" (260)	10.75" (273)

**ELECTRICAL CHARACTERISTIC**

MODEL	kW	
	STANDARD	OPTIONAL
ETS-30	18	12
ETS-40	27	18

kW	PHASE	AMPS PER LINE					
		208V	220V	240V	380V	415V	480V
12	1	57.7	54.5	50.0	N/A	N/A	N/A
	3	33.3	31.5	28.9	18.2	16.7	14.4
18	1	86.5	81.8	75.0	N/A	N/A	N/A
	3	50.0	47.2	43.3	27.3	25.0	21.7
27	3	75.0	70.9	65.0	41	37.6	32.5

**SPECIFICATIONS**

MODEL	CAPACITY	
ETS-30	30 Gallon	114 Liter
ETS-40	40 Gallon	152 Liter

MODEL	SHIPPING WEIGHT	MINIMUM CLEARANCE *	
ETS-30	501 lbs. (228 kg)	SIDES	6" (152)
ETS-40	547 lbs. (248 kg)	BACK	6" (152)

**INTENDED FOR COMMERCIAL USE ONLY.  
NOT FOR HOUSEHOLD USE.**

