



PROOFER1



Proofer Cabinet, Roll-In, One-Cavity, Single (1) Rack Capacity or (36) 18"x26" Sheet Pans, Solid State Heat & Humidity Controls, Auto Water Entry, Full View Glass Door, Stainless Steel Interior and Exterior, Aluminum Floor, NSF, cETLus, ETL



PROJECT _____

ITEM NO. _____

NOTES _____

MODEL NUMBER: **DRIP 1**



*rack not included

FEATURES

- Even Airflow Heating System Maintains the Right Combination of Heat and Humidity for Optimal Proofing
- Proofs from Room Temperature up to 110°F (43°C)
- Relative Humidity up to 95%
- Automatic Water Fill System (no water pans required)
- Manual Controls
- Independent Controls for Heat, Humidity and Timer

CONSTRUCTION

- Stainless Steel Construction
- Aluminum Flush Floor Entry
- Ships in One Piece
- Available with Left or Right Hinge Door

CLEARANCES

Minimum Clearance from Combustible Materials:

- 4" (102mm) Sides & Back
- 24" (609mm) Top

OPTIONS & ACCESSORIES

- Stainless Steel Door (suffix SD)
- Door Bumpers (suffix DB)
- Prison Package (suffix PPE)
- Water Filter (PLF240) (recommended)

WARRANTY

- One Year Labor & Two Year Parts



Model	Crated Weight	Overall Dimensions				Single Rack Capacity	Door Opening	
		W	D	H	B		L	H
DRIP1	400 (182)	33" (838)	46 1/2" (1181)	86" (2184)	42 1/4" (1073)	1	27" (686)	73 1/2" (1867)

SPECIFICATIONS SUBJECT TO CHANGE WITHOUT NOTICE

KCL & REVIT DRAWINGS UPON REQUEST

REVISION B | 6/1/2021

Follow Us



Doyon

5600 13th Street, Menominee, MI 49858

906.863.4401 | 800.338.9886 | www.doyon.qc.ca





PROJECT _____

ITEM NO. _____

NOTES _____

MODEL NUMBER: **DRIP 1**

DRAWINGS

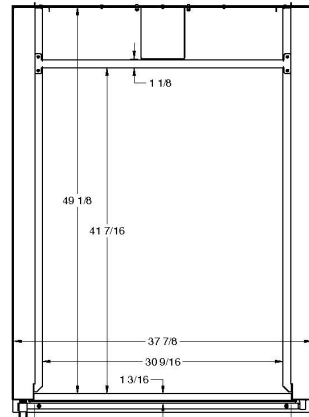
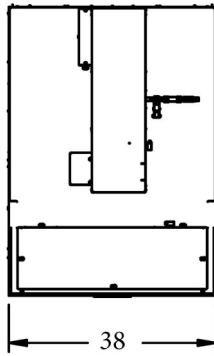

INTERIOR

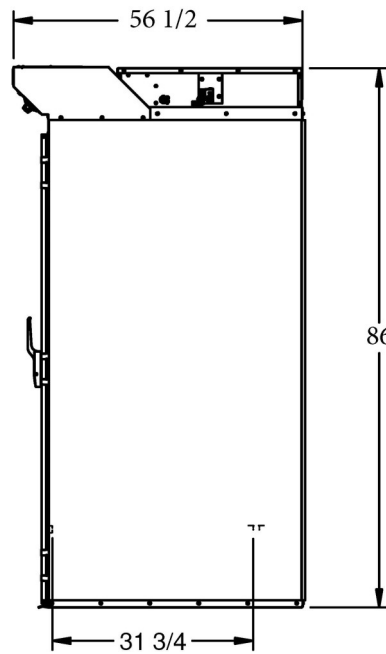
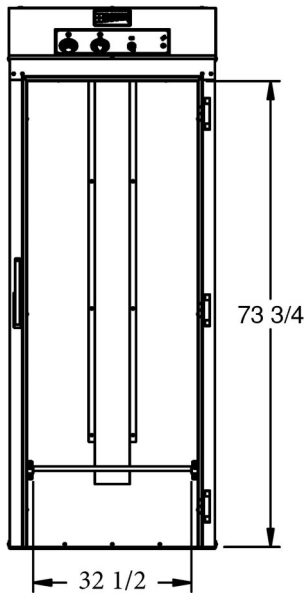

Model	Water Inlet	Electrical System			
		Volts	Phases	Amps	kW
DRIP1	1/4"	120	1	39	4.7
	(6)	120/208		28	5.7

