



Chef Tables - Hard Maple Top

Stainless Steel Cabinet Base Tables with Sliding Doors

Certifications:



CMT-3672S2
Dual Sided Unit Shown



Doors on Both Sides

Features:

- 1 3/4" Thick Hard Maple Bakers Top w/ Penetrating Oil Finish
- Sliding Doors
- Single or Dual Sided (Doors on Both Sides)
- 1 5/8" x 6" Straight S/S Leg
- Legs Adjust 1" in Height
- 96" Units have a Center Mullion with Two Sets of 48" Doors
- Extra Supporting "C" Channels
- Casters Available

Material:

- Hard Maple Top
- T-304 18 ga. Stainless Steel Body
- Stainless Steel Legs & Feet

Options:

- Adjustable Shelf



Sliding Doors	Unit Size (W x L x H)
CMT-3648S	36" x 48" x 34.75"
CMT-3660S	36" x 60" x 34.75"
CMT-3672S	36" x 72" x 34.75"
CMT-3696S*	36" x 96" x 34.75"

* Has a Center Mullion

Dual Sided (Doors on Both Sides):

Sliding Doors	Unit Size (W x H x L)
CMT-3648S2	36" x 48" x 34.75"
CMT-3660S2	36" x 60" x 34.75"
CMT-3672S2	36" x 72" x 34.75"
CMT-3696S2*	36" x 96" x 34.75"

* 96" Has a Center Mullion with Two Sets of 48" Doors on Each Side

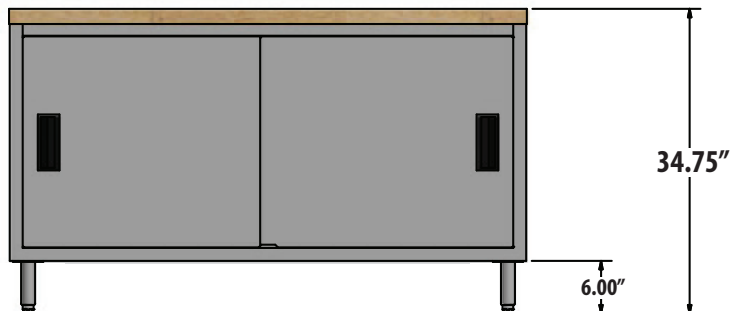
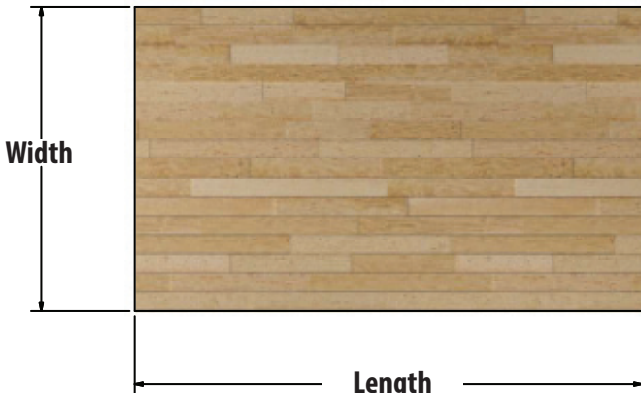

PRODUCT DATA SHEET

BK RESOURCES

