



Model #ABB-48-27

Cooling

Temperature Range	33°F-41°F
Refrigerant	R290
Max. Ambient Temperature	90°F
Defrosting	Automatic
Temperature Controller	Digital
Horsepower	1/5

Electrical

Voltage	115
Amps	2.8
Hz	60
Phase	1
Plug Type	NEMA-5-15P
Electrical Cord Length	84"

Standard Features – Back Bar Refrigerator #ABB-48-27

- Environmentally safe R290 refrigerant
- Durable black coated steel exterior with solid doors
- Painted aluminum interior
- 1-1/2" built-in stainless steel top
- Foamed-in-place polyurethane insulation
- Accommodates up to (2) ½ kegs or 88 6-packs
- 19 cu. Ft. interior
- (4) epoxy coated steel shelves
- Digital temperature controller
- 115V; 1/5 HP

Construction

Exterior Material	Black Coated Steel
Interior Material	Painted aluminum
Insulation Material	Foamed-In-Place Polyurethane
Shelf Size	(4) 17-5/8" x 18-1/8" epoxy coated steel
Load Capacity	90 lb.

Dimensions

Exterior Dimensions	58-3/4"W x 27-3/4"D x 35-1/2"H
Interior Dimensions	48"W x 22-1/2"D x 33"H
Shipping Dimensions	61-1/2"W x 30-1/2"D x 41-3/4"H
Net Volume	19 cu. ft.
Net Weight	229 lb.
Gross Weight	273 lb.



Parts & Labor



Compressor

PLAN VIEW

Front View

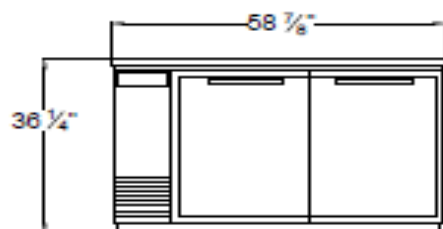

Side View



Top View

