



**Model #ABB-60**

**Cooling**

Temperature Range	33°F-40°F
Refrigerant	R290
Max. Ambient Temperature	90°F
Defrosting	Automatic
Temperature Controller	Digital
Horsepower	1/5

**Electrical**

Voltage	115
Amps	2.88
Hz	60
Phase	1
Plug Type	NEMA-5-15P
Electrical Cord Length	106"

**Standard Features – Back Bar Refrigerator #ABB-60**

- Environmentally safe R290 refrigerant
- Durable black coated steel exterior with solid doors
- Painted aluminum interior
- Painted aluminum 1-1/2" built-in stainless steel top
- Foamed-in-place polyurethane insulation
- Accommodates up to (2) ½ kegs
- 17.3 cu. ft. interior
- (4) epoxy coated steel shelves
- Digital temperature controller
- 115V; 1/5 HP

**Construction**

Exterior Material	Black Coated Steel
Interior Material	Painted aluminum
Insulation Material	Foamed-In-Place Polyurethane
Shelf Size	(4) 23-5/8" x 18-1/8" epoxy coated steel
Load Capacity	90 lb.

**Dimensions**

Exterior Dimensions	60-3/4"W x 25-3/4"D x 35-5/8"H
Interior Dimensions	48-1/4"W x 18-1/2"D x 28-7/8"H
Shipping Dimensions	63-1/2"W x 27-1/2"D x 41-3/4"H
Net Volume	17.3 cu. ft.
Net Weight	276 lb.
Gross Weight	319 lb.



Parts & Labor



Compressor

**PLAN VIEW**

Front View

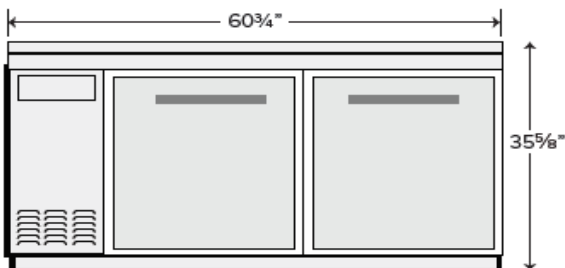

Side View

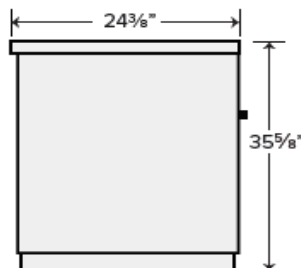

Top View

