

Standard Features – Back Bar Refrigerator #ABB-79-27

- Environmentally safe R290 refrigerant
- Durable black coated steel exterior with solid doors
- Painted aluminum
- 1-1/2" built-in stainless steel top
- Foamed-in-place polyurethane insulation
- (3) Solid doors
- Accommodates up to (4) ½ kegs
- (6) epoxy coated steel shelves
- Digital temperature controller
- 115V; 1/4 HP
- ETL listed. Conforms to UL STD. 471, Certified to CSA STD. C22. 2No.120
- Conforms to NSF/ANSI STD. 7.

Construction

Exterior Material	Black Coated Steel
Interior Material	Painted Aluminum
Insulation Material	Foamed-In-Place Polyurethane
Shelf Size	(6) epoxy coated steel
Load Capacity	90 lb.

Model #ABB-79-27

Cooling

Temperature Range	33°F-41°F
Refrigerant	R290
Max. Ambient Temperature	90°F
Defrosting	Automatic
Temperature Controller	Digital
Horsepower	1/4

Electrical

Voltage	115
Amps	4.7
Hz	60
Phase	1
Plug Type	NEMA-5-15P
Electrical Cord Length	98"

Dimensions

Exterior Dimensions	78-15/16"W x 27-3/4"D x 35-5/8"H
Shipping Dimensions	80-11/16"W x 30-5/16"D x 41-3/4"H
Net Weight	320 lb.
Gross Weight	375 lb.



PLAN VIEW

FRONT VIEW

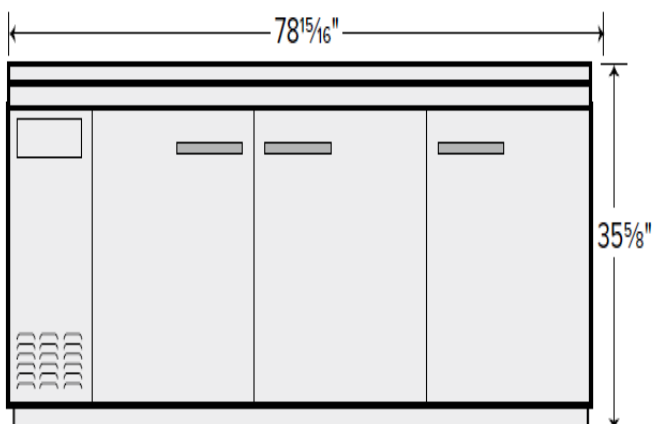

SIDE VIEW

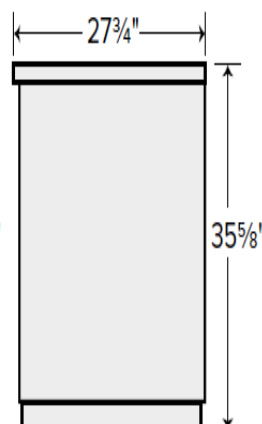

TOP VIEW

