



Model #AF-23

Cooling

Temperature Range	-5°F - 2°F
Refrigerant	R290
Max. Ambient Temperature	90°F
Defrosting	Automatic
Temperature Controller	Digital
Horsepower	3/4

Electrical

Voltage	115
Amps	7.1
Hz	60
Phase	1
Plug Type	NEMA-5-15P
Electrical Cord Length	96"

Standard Features

- Self-closing door with convenient stay-open feature
- 430 Stainless steel exterior
- Painted aluminum interior
- Temperature range of (-5)°F - 2°F
- 3 shelves included: versatile shelf slide design also accepts full size food pans
- Environmentally-safe R290 refrigerant
- Digital temperature controller with automatic defrost function
- 115V; 3/4 HP ETL Safety & Sanitation Listed
- ETL listed. Conforms to UL STD. 471, Certified to CSA STD. C22. 2No.120
- Conforms to NSF/ANSI STD. 7.

Construction

Exterior Material 430 Stainless Steel
 Interior Material Painted aluminum
 Insulation Material Foamed-In-Place Polyurethane
 Shelf Size (3) 20-7/8"W x 25-3/16"D
 Shelf Material Epoxy-Coated Steel
 Shelf Load Capacity 120 lbs.

Dimensions

Exterior Dimensions	29"W x 32-1/4"D x 82-1/2"H
Interior Dimensions	24-3/8"W x 27-1/8"D x 53-1/2"H
Shipping Dimensions	30-1/4"W x 34"D x 84-1/2"H
Net Volume	23 cu. ft.
Net Weight	321 lbs.
Gross Weight	382 lbs.



PLAN VIEW

Front View

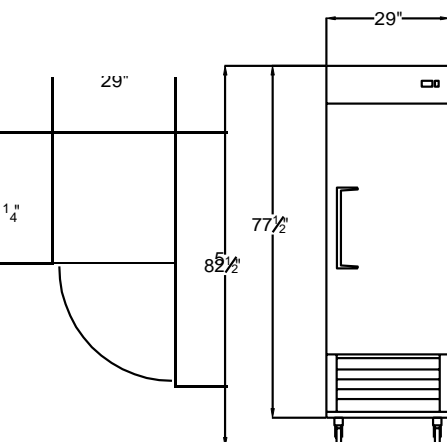

Side View



Top View

