



Model #AGM-78

Cooling

Temperature Range	33°F-40F
Refrigerant	R290
Max. Ambient Temperature	90°F
Defrosting	Automatic
Temperature Controller	Digital
Horsepower	3/4

Electrical

Voltage	115
Amps	10.7
Hz	60
Phase	1
Plug Type	NEMA-5-15P
Electrical Cord Length	84"

Standard Features – Glass Door Refrigerator Model #AGM-78

- (3) self-closing swing glass doors
- Interior LED lighting
- (12) epoxy-coated steel shelves included
- Foamed-in-place polyurethane insulation
- Bottom mount condensing unit
- Removable door gasket for easy cleaning
- Automatic defrosting
- Stainless steel floor
- Copper evaporator
- Black powder-coated steel exterior
- Eco-friendly R290 hydrocarbon refrigerant
- 5" Casters
- ETL listed. Conforms to UL STD. 471, Certified to CSA STD. C22. 2No.120
- Conforms to NSF/ANSI STD. 7

Construction

Exterior Material	Powder Coated
Interior Material	Cold Rolled Steel
Door Type	Painted Aluminum
Insulation Material	Glass Swing
Shelf Sizes	Foamed-In-Place Polyurethane
	(4) 23" x 23-1/4"
	(4) 23" x 25-3/4"
Material	Epoxy-Coated Steel
Shelf Load Capacity	90 lbs.

Dimensions

Exterior Dimensions	78-1/4"W x 30"D x 84-3/8"H
Interior Dimensions	73-1/2"W x 23-5/8"D x 55-1/8"H
Shipping Dimensions	81"W x 33"-3/4D x 87-1/2"H
Net Volume	57.5 cu. ft.
Net Weight	615 lbs.
Gross Weight	671 lbs.



Parts & Labor

Compressor

PLAN VIEW

Front View

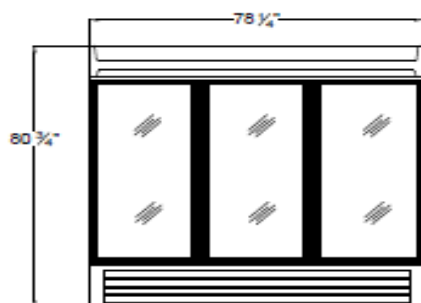

Side View



Top View

