



**Model #AST-27**

### Standard Features

- Eco-friendly R290 hydrocarbon refrigerant
- Sleek, stainless steel exterior
- Painted aluminum interior maintains temperatures from 33-40°F
- Top holds up to (6) 1/6 size and (2) 1/9 size, 6" deep food pans (sold separately)
- Full length, 10" deep cutting board
- Insulated lid helps maintain safe product temperatures
- Single self-closing swing door with recessed handles
- 115V, 1/4 hp
- Conforms to NSF/ANSI STD.7.
- ETL Safety & Sanitation Listed

### Construction

|                     |                              |
|---------------------|------------------------------|
| Exterior Material   | 430 Stainless Steel          |
| Interior Material   | Painted Aluminum             |
| Insulation Material | Foamed-In-Place Polyurethane |
| Shelf Size          | (1) 17-1/16"W x 23-1/2"D     |
| Shelf Material      | Epoxy-Coated Steel           |
| Shelf Load Capacity | 90 lbs                       |

### Cooling

|                          |             |
|--------------------------|-------------|
| Temperature Range        | 33°F - 40°F |
| Refrigerant              | R290        |
| Max. Ambient Temperature | 90°F        |
| Defrosting               | Automatic   |
| Temperature Controller   | Digital     |
| Horsepower               | 1/4         |

### Electrical

|                        |            |
|------------------------|------------|
| Voltage                | 115        |
| Amps                   | 5.3        |
| Hz                     | 60         |
| Phase                  | 1          |
| Plug Type              | NEMA-5-15P |
| Electrical Cord Length | 84"        |

### Dimensions

|                           |                                |
|---------------------------|--------------------------------|
| Exterior Dimensions       | 27-1/2"W x 31"D x 42-3/8"H     |
| Interior Dimensions       | 24"W x 23-3/4"D x 23-1/2"H     |
| Shipping Dimensions       | 31-3/4"W x 33-3/4"D x 45-1/2"H |
| Working Height            | 35-1/4"                        |
| Overall Height (Lid Open) | 47-1/4"                        |
| Cutting Board Dimensions  | 27-1/4"W x 10"D x 3/4"H        |
| Net Volume                | 6 cu. ft.                      |
| Net Weight                | 176 lbs.                       |
| Gross Weight              | 231 lbs.                       |
| Pan Capacity              | (6) 1/6 Size + (2) 1/9 Size    |



Parts & Labor

Compressor

### PLAN VIEW

Front View

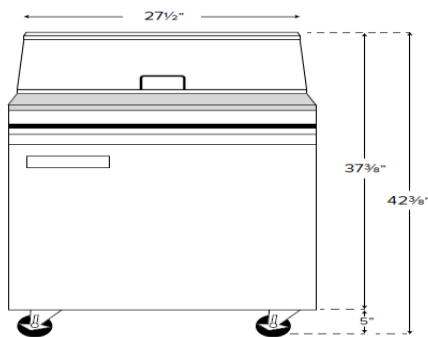

Side View

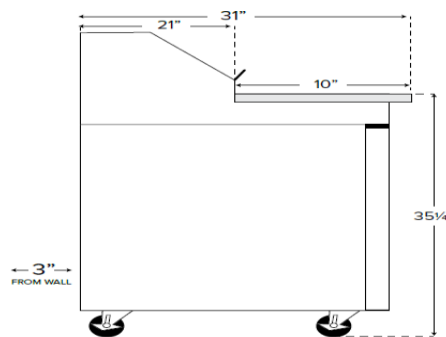

Top View

