

Standard Features

- Eco-friendly R290 hydrocarbon refrigerant
- Sleek, stainless steel exterior
- Painted aluminum interior maintains temperatures from 33-40°F
- Top holds up to (18) 1/6 size, 6" deep food pans
- Full length, 11-1/2" deep cutting board
- Insulated lid helps maintain safe product temperatures
- Three self-closing swing doors with recessed handles
- Pan rail is air cooled from the bottom
- 115V, 3/4 hp

Construction

Exterior Material	430 Stainless Steel
Interior Material	Painted aluminum
Insulation Material	Foamed-In-Place Polyurethane
Shelf Size	(3) 27-9/16"W x 17-1/16"D
Shelf Material	Epoxy-Coated Steel
Shelf Load Capacity	90 l



Model #AST-72

Cooling

Temperature Range	33°F - 40°F
Refrigerant	R290
Max. Ambient Temperature	90°F
Defrosting	Automatic
Temperature Controller	Digital
Horsepower	3/4

Dimensions

Exterior Dimensions	70-3/8"W x 31"D x 42-3/8"H
Interior Dimensions	66-1/2"W x 23-3/4"D x 23-1/2"H
Shipping Dimensions	64-1/2"W x 33-3/4"D x 45-1/2"H
Working Height	35-1/4"
Overall Height (Lid Open)	47-1/4"
Cutting Board Dimensions	70-3/8"W x 11-1/2"D x 3/4"H
Net Volume	18 cu. ft.
Net Weight	343 lbs.
Gross Weight	525 lbs.
Pan Capacity	(18) 1/6 Size

Electrical

Voltage	115
Amps	7.8
Hz	60
Phase	1
Plug Type	NEMA-5-15P
Electrical Cord Length	84"



Parts & Labor



Compressor

PLAN VIEW

Front View

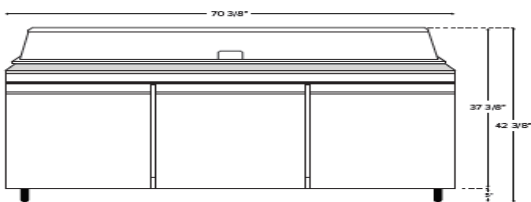

Side View

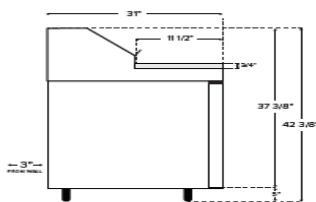

Top View

