

BLACK◆DIAMOND®

Project Name: _____

Location: _____

Item #: _____

Qty: _____

Black Diamond Countertop Refrigerated Cake Display, Single Glass Door, 3.53 cu ft, in Stainless Steel

BDRCK-100/CT



Crafted for bakeries, cafes, and restaurants, the Black Diamond Countertop Refrigerated Cake Display is perfect for showcasing cakes, cupcakes, and pastries. Featuring a stainless steel body and a single glass door, it offers a 3.53 cubic feet capacity. The temperature range of 35.6° to 46.4°F ensures optimal freshness. Equipped with a digital control system, R290 refrigerant, and automatic defrost, this unit is easy to maintain and clean, making it a reliable addition to any establishment.

FEATURES AND CONSTRUCTION

- Capacity of 3.53 cu ft offers ample space for various desserts
- Equipped with a 0.25 horsepower compressor located at the bottom front for efficient cooling
- Constructed with a durable stainless steel body and PVC glass door
- Temperature range from 35.6° to 46.4°F ensures freshness of desserts
- Utilizes R290 refrigerant for an eco-friendly operation
- Operates on 110-120V with a NEMA 5-15 plug type for convenience
- Includes three adjustable and rotating shelves for flexible display
- Designed for countertop use
- Automatic self-closing door enhances ease of use and energy efficiency
- Digital temperature controller allows for precise adjustments

ELECTRIC

110-120V / 60Hz / 1Ph
Cord Length (Inches): 50"
Plug Type: NEMA 5-15P
Cord set included

NEMA 5-15P



3RD PARTY APPROVALS



Intertek

WARRANTY (USA / CANADA)

1 Year Warranty on Parts & Labor, 1 Year
Warranty on Compressor

Contact Admiral Craft Equipment
for details at 1-877-672-7740



STORAGE CAPACITY

- Cubic Feet: 3.53 cu. ft.

TEMPERATURE

- Holding Temperature (Fahrenheit): 32° - 50°

These models are designed to operate in an environment where temperature and humidity do not exceed 75°F (24°C) and 55% relative humidity

Black Diamond Countertop Refrigerated Cake

BLACK♦DIAMOND® Display, Single Glass Door, 3.53 cu ft

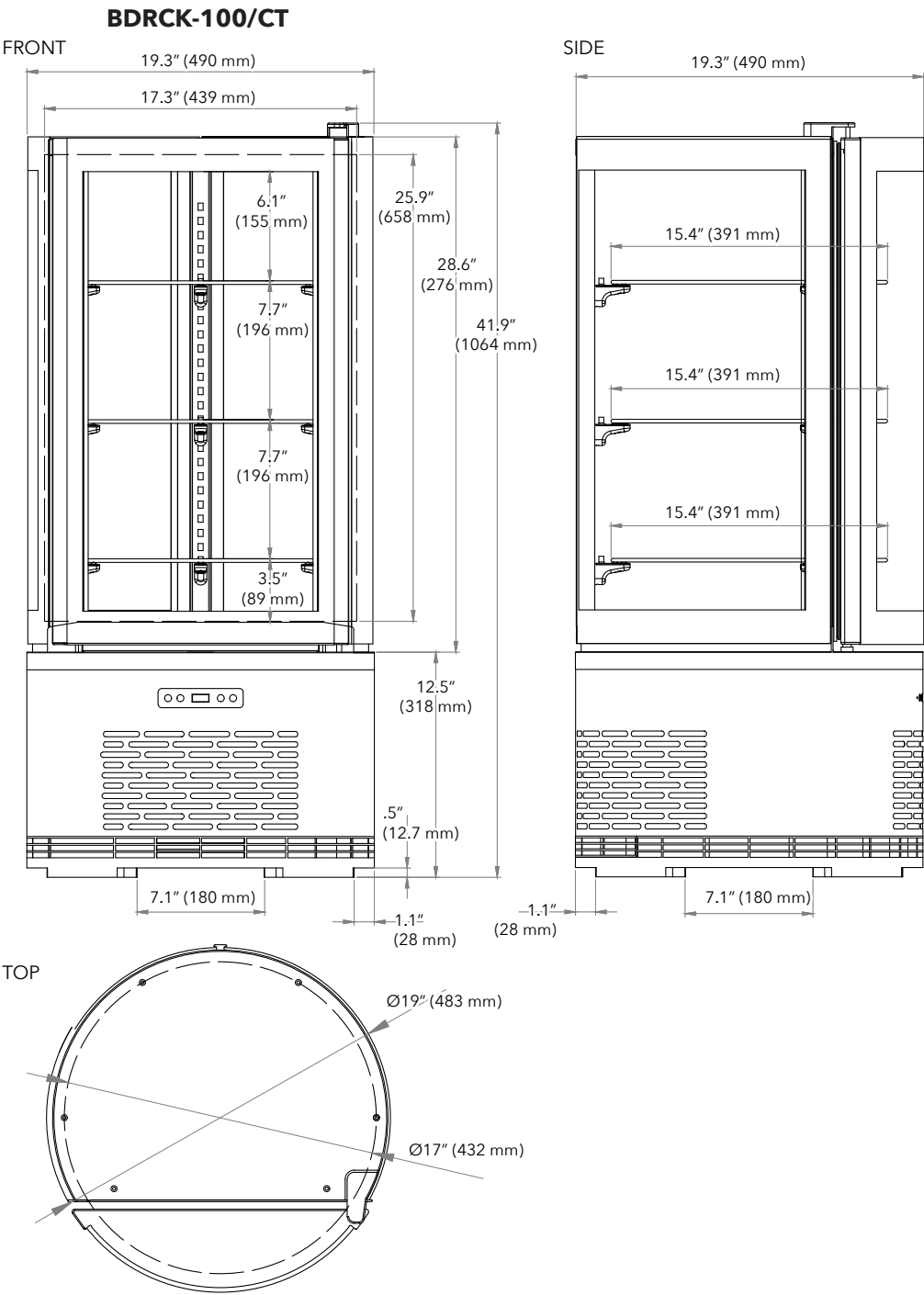

Cake Displays

Doors	Shelves	Amps	HP	Refrigerant	Capacity	Assembled Dimensions (in)	Item Weight (lbs)	Shipping Weight (lbs)
1	3	1.95A	1/4	R290 1.66 oz	3.53 cu. ft.	19" x 19" x 40.6"	110.0	121.0

Due to periodic changes in designs, methods, procedures, policies and regulations, the specifications contained in this document are subject to change without notice. While we exercise good faith efforts to provide information that is accurate, we are not responsible for errors or omissions in information provided or conclusions reached as a result of using the specifications. By using the information provided, the user assumes all risks in connection with such use.