

## Black Diamond Countertop Display Refrigerator, Single Glass Door, 1.5 cu ft, in Black

### CDRF-1D/1.5



Black Diamond Countertop Display Refrigerator combines quality and functionality, ideal for showcasing beverages, sandwiches, and snacks. Its durable PVC glass door enhances visibility, while the compact 1.5 cubic foot capacity is perfect for small spaces. Maintaining a temperature range of 32° to 50°F, this unit ensures optimal freshness. The mechanical control and R600A refrigerant offer efficient performance. Easy to clean and maintain, making it perfect for busy environments.

### FEATURES AND CONSTRUCTION

- Offers a 1.5 cu ft storage capacity for versatile product display
- Features a 0.25 horsepower compressor for efficient cooling
- Constructed with a PVC glass door and black-coated steel exterior
- Maintains a temperature range of 32° to 50°F
- Uses R600A refrigerant for eco-friendly operation
- Operates on 110V with a NEMA 5-15 plug for convenience
- Includes 2 adjustable shelves for customizable storage
- Compact design fits seamlessly on countertops without casters
- Manual control system for straightforward temperature adjustments
- Brilliant LED lighting enhances product visibility

### STORAGE CAPACITY

- Cubic Feet: 1.5 cu. ft.

### TEMPERATURE

- Holding Temperature (Fahrenheit): 32° - 50°

These models are designed to operate in an environment where temperature and humidity do not exceed 75°F (24°C) and 55% relative humidity

### ELECTRIC

110V / 60Hz / 1Ph

Cord Length (Inches): 70.87"

Plug Type: NEMA 5-15P

Cord set included

NEMA 5-15P



### 3RD PARTY APPROVALS



### WARRANTY (USA / CANADA)

1 Year Warranty on Parts & Labor, 1 Year Warranty on Compressor

Contact Admiral Craft Equipment for details at 1-877-672-7740



Black Diamond Countertop Display Refrigerator,  
BLACK◆DIAMOND® Single Glass Door, 1.5 cu ft

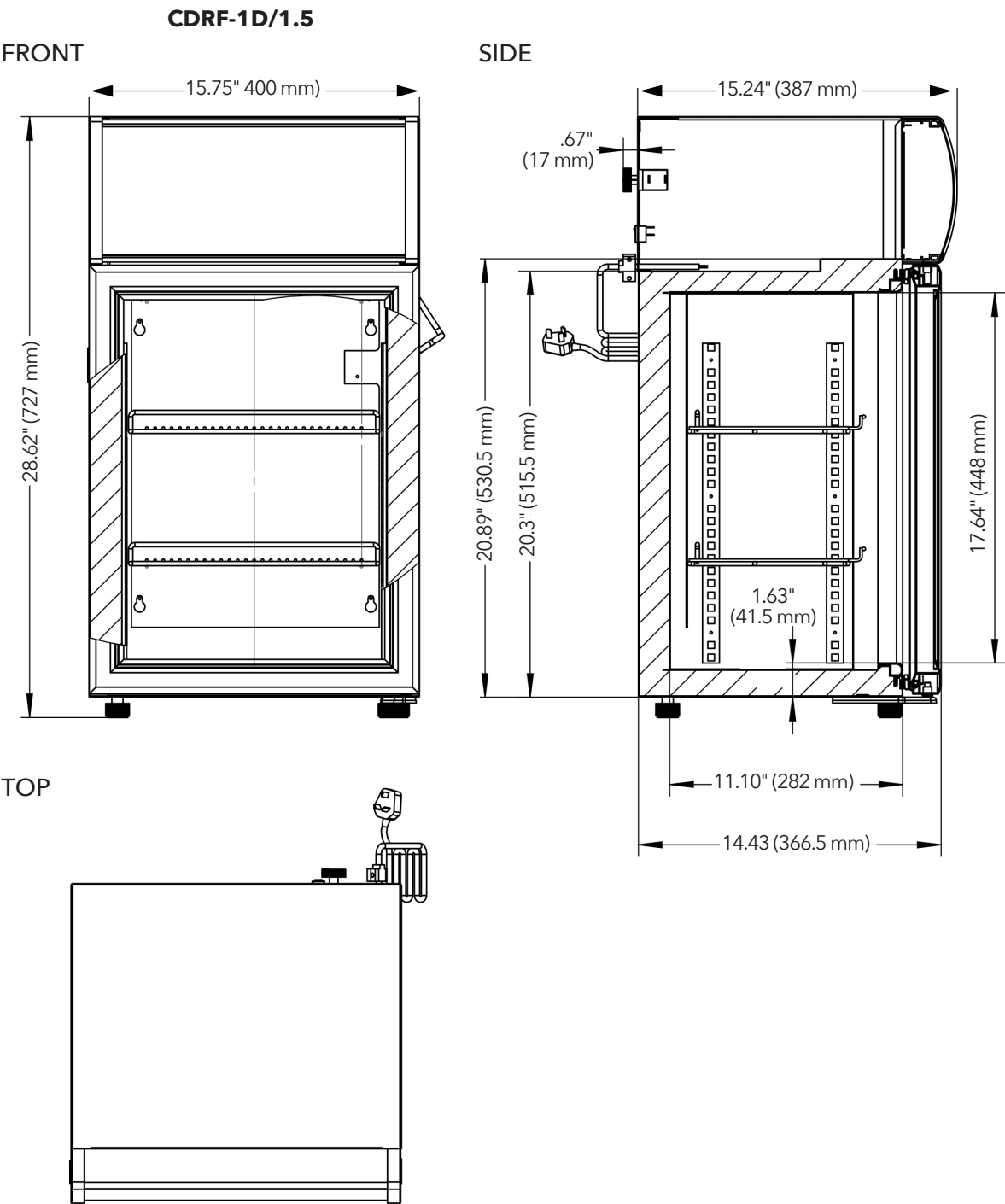

Merchandiser

Doors	Shelves	Amps	HP	Refrigerant	Capacity	Assembled Dimensions (in)	Item Weight (lbs)	Shipping Weight (lbs)
1	2	0.81A	1/10	R600A 0.71 oz	1.5 cu. ft.	15.90" x 15.75" x 28.62"	44.1	48.5

Due to periodic changes in designs, methods, procedures, policies and regulations, the specifications contained in this document are subject to change without notice. While we exercise good faith efforts to provide information that is accurate, we are not responsible for errors or omissions in information provided or conclusions reached as a result of using the specifications. By using the information provided, the user assumes all risks in connection with such use.