



T&S BRASS AND BRONZE WORKS, INC.
 2 SADDLEBACK COTE / P.O. BOX 1088 / TRAVELERS REST, SC 29690
 PHONE 800-476-4103 FAX 864-834-3518



REG. #42001
 SQ 29601

Job Name:

Architect/Engineer Approval:

Notes:

TO RETRO-FIT A FISHER PRE RINSE UNIT:

PARTS NEEDED:	QTY.
1. 010476-45 HOSE WASHER	(3)
2. 146X COUPLING	(1)
3. 53-A ADAPTER	(2)
4. AW-5B QUICK-CONNECT	(1)

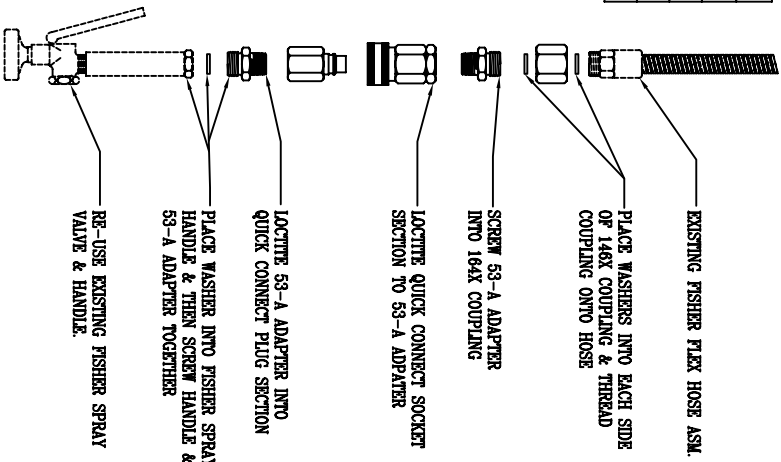

TO RETRO-FIT A T&S PRE RINSE UNIT:

PARTS NEEDED:	QTY.
1. 000729-40 ADAPTER	(1)
2. 010476-45 HOSE WASHER	(2)
3. 53-A ADAPTER	(1)
4. AW-5B QUICK-CONNECT	(1)
5. 3/8" NPT CLOSE NIPPLE	(1)
6. 005A GRIP HANDLE	(1)

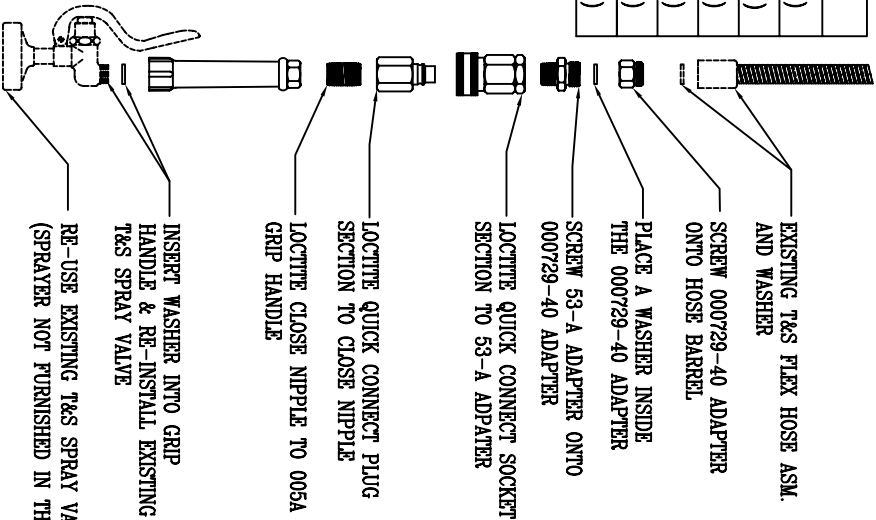

Product Description:

COSTCO PARTS KIT
 RETROFITS EITHER T&S or FISHER PRE RINSES

Model No. B-0133-QD-1
 Item No.:

Drawn: GEF
 Checked: MAV
 Approved: JHB
 Scale: 1 : 4
 Date: 6/26/07