

# BSSM 48-6 ETL

STAINLESS STEEL EXHAUST HOOD WITH MAKEUP AIR VENT  
 ETL APPROVED. N.S.F. LISTED. CONFORMS TO NFPA 96  
 ETL LISTED # 3148390 CONFORMS TO UL STD 710

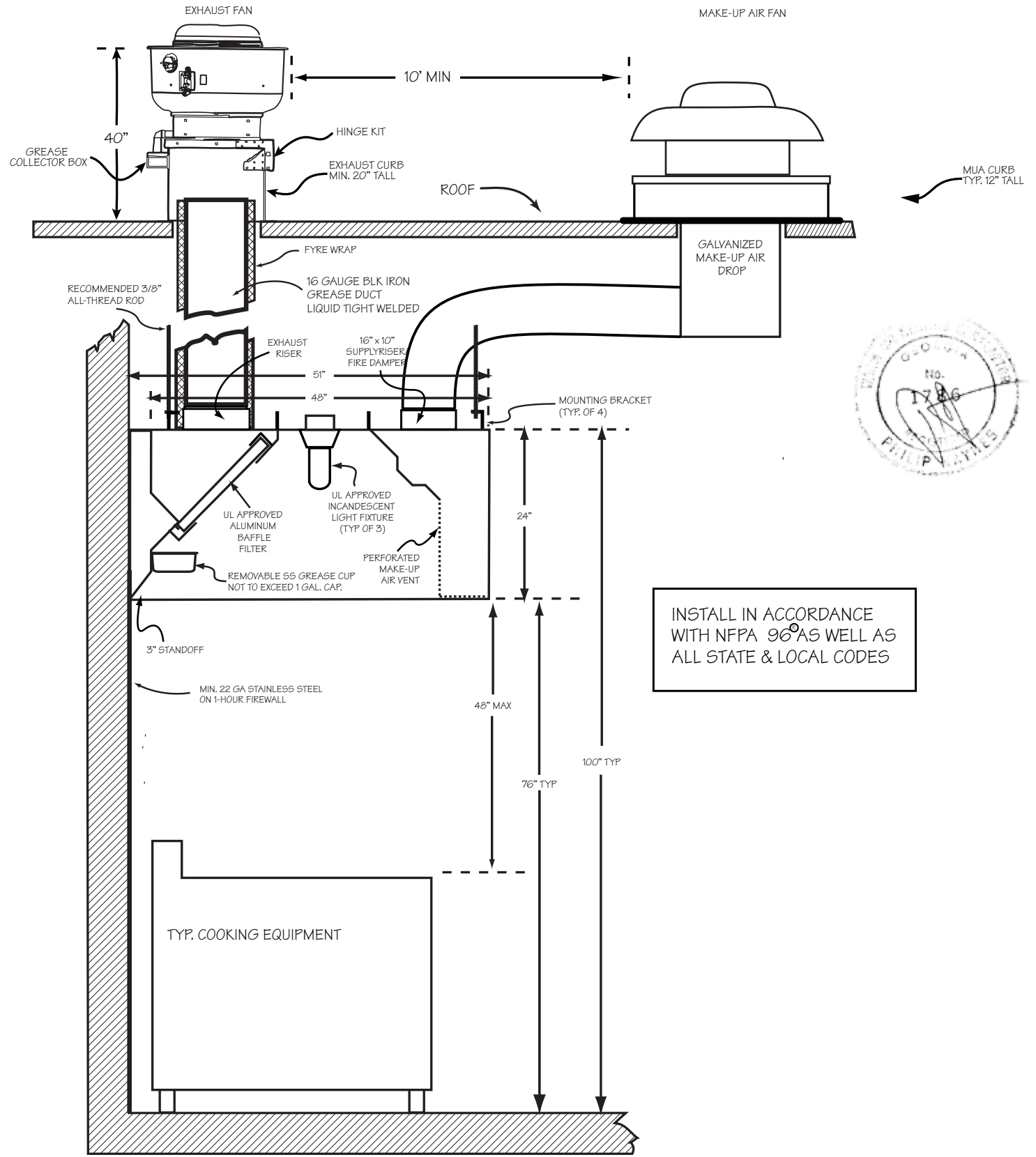

PROFILE VIEW - TYPICAL HOOD SYSTEM INSTALLATION



INSTALL IN ACCORDANCE WITH NFPA 96 AS WELL AS ALL STATE & LOCAL CODES

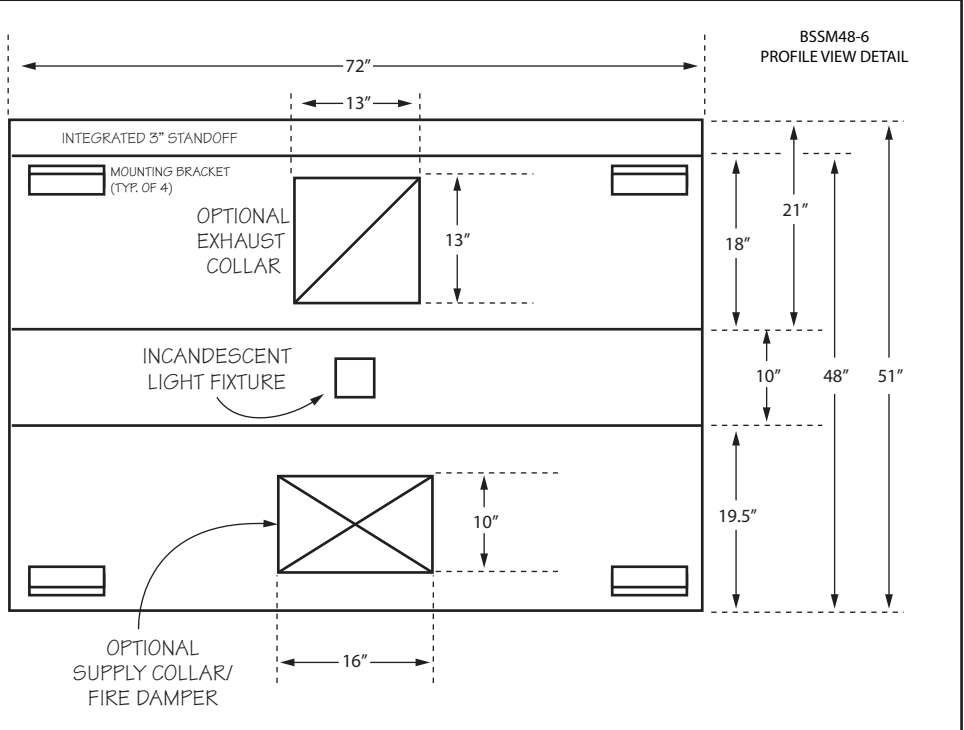
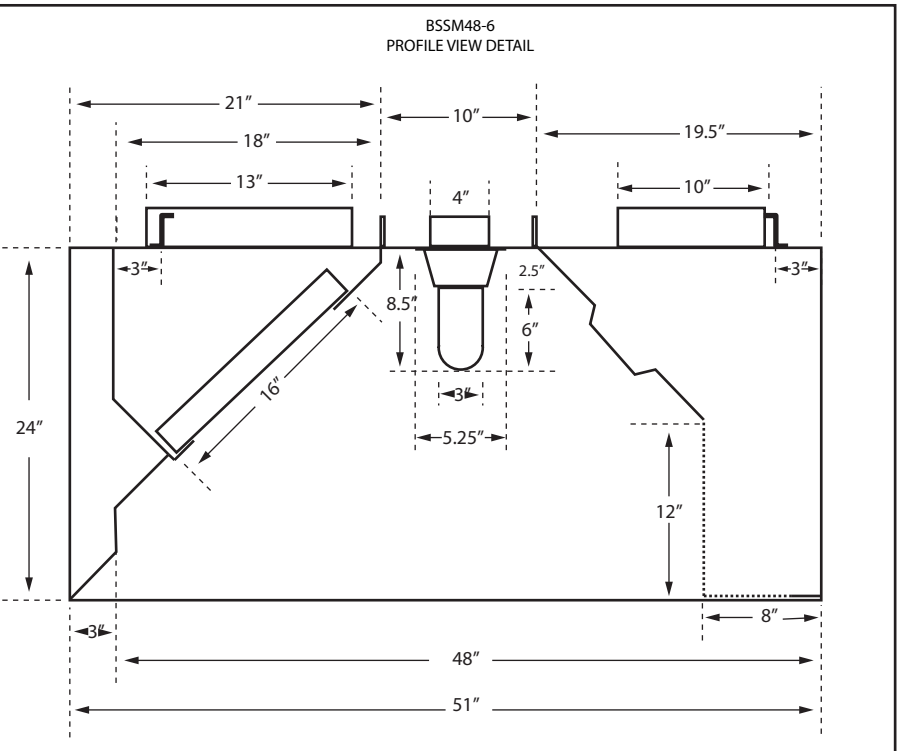

**SUPERIOR HOODS**

2018 STEEL DRIVE TUCKER GA 30084  
 TEL (770) 936 0770 FAX (770) 936 9914

HOOD INFORMATION (PER HOOD)										
MODEL	LENGTH	WIDTH	HEIGHT	HOOD CONSTRUCTION	FILTERS				LIGHTS	
					TYPE	QTY	HEIGHT	LENGTH	QTY	TYPE
BSSM48-6-ETL	6'	48"	24"	TYPE: 430 STAINLESS STEEL GAUGE: 18 POLISH: #3	ALUMINUM BAFFLE w/HANDLES UL APPROVED	1	16"	20"	1	INCANDESCENT LIGHT FIXTURE UL APPROVED
CFM REQUIREMENTS (PER HOOD)			OPTIONAL COLLARS (PER HOOD)							
EXHAUST		SUPPLY		EXHAUST	SUPPLY	STANDOFF	NOM WEIGHT		ACCESSORIES	
1,680 @ .75 S.P.		1,344 @ .12 S.P.		QTY	SIZE	QTY	SIZE	300 LBS		
1		13" X 13"		1	16" X 10"	<input type="checkbox"/> NONE <input checked="" type="checkbox"/> 3"				