



# BEVERAGE-AIR®

Project: _____	AIA# _____
Item: _____	
Location: _____	SIS# _____
Approved: _____	

## MARKETEER™ MERCHANDISERS

MT41-48 Black Sliding Door Model

Hydrocarbon Series

MODEL:

MT41-48-1-SDB



**3 Year Parts/Labor Warranty**

**5 Year Compressor Warranty**

### CABINET CONSTRUCTION

- Standard cabinet exterior finish is prepainted black steel
- Heavy duty interior construction includes prepainted white steel
- Mechanical temperature control
- Modern one piece grille
- Double pane lowE argon filled glass door feature outside pane that is tempered for added safety
- Self-closing sliding glass doors, black door frames regardless of exterior color
- Pocket door handles
- LED lighting
- Six (6) epoxy coated shelves
- Leveling feet

### OPTIONS & ACCESSORIES

- Extra shelves and clips
- 3" Casters

### REFRIGERATION SYSTEM

- Uses environmentally friendly, energy efficient R290 refrigerant, and meets all regulatory requirements for CARB, SNAP, DOE & more
- Condenser is designed to be low maintenance, and energy efficient
- Automatic, non-electric defrost
- Epoxy coated evaporator coil
- Maintains product temperatures between 32°F and 44.6°F

MT41-48™ MERCHANDISER: SLIDING DOOR MODEL



  
Please verify qualifying units by visiting:  
[www.energystar.gov/cfs](http://www.energystar.gov/cfs)

3779 Champion Blvd., Winston-Salem, NC 27105  
1-888-845-9800 Fax: 1-336-245-6453  
Beverage-Air.com Sales@bevair.com



# BEVERAGE-AIR®

MODEL	MT41-48-1-SDB
<b>EXTERNAL DIMENSIONAL DATA</b>	
Width Overall	47 1/4"
Depth Overall	21 3/4"
Height Overall	48 1/8"
Number of Doors	2
<b>INTERNAL DIMENSIONAL DATA</b>	
NET Capacity (cubic ft.)	16.4
Capacity 20 oz	180
Internal Width Overall (in)	43 1/8"
Internal Depth Overall (in)	19 1/2"
Internal Height Overall (in)	33 7/16"
Internal Height Useable (in)	27 1/8"
Number of Shelves	6
<b>ELECTRICAL DATA</b>	
Full Load Amperes	3.1
Voltage	115/60/1
Nema Plug (8' cord)	5-15P
<b>REFRIGERATION DATA</b>	
Horsepower	1/4
Energy Consumption	1.630 Kwh / 24h
Capacity (BTU/Hr)	1900
Heat Rejection (BTU/Hr)	2850
Charge (lbs/grams/ounces)	0.1102 / 50 / 1.76
<b>WEIGHT DATA</b>	
Gross Weight - Crated	262 lbs
Height - Crated	52"
Width - Crated	51"
Depth - Crated	27"

We reserve the right to change specifications and product design without notice. Such revisions do not entitle the buyer to corresponding changes, improvements, additions or replacements for previously purchased equipment. Dimensional tolerances +/- 1/4". Metric dimensions (MM).

## Glass Sliding Door Model Model: MT41-48-1-SDB

### Model Views

Required Clearance: 4" Top, Bottom, Rear, & Sides

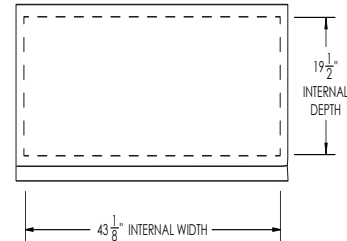

### PLAN VIEW

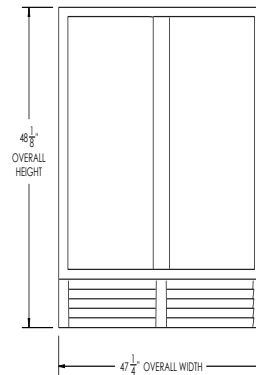

### ELEVATION VIEW

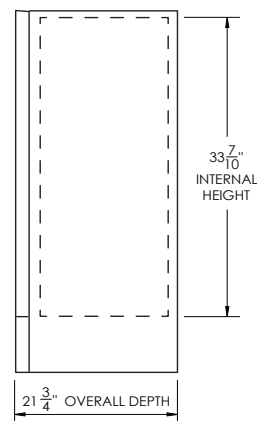

### SIDE VIEW

### ELECTRICAL CONNECTION



115/60/1  
NEMA 5-15P

Unit pre-wired at factory and include 8' long cord and plug set.



3779 Champion Blvd., Winston-Salem, NC 27105 1-888-845-9800 Fax: 1-336-245-6453 Beverage-Air.com Sales@bevair.com

