



[C-SP48-12]



[C-SP72-18]



[C-SP27-8]



[C-SP60-16]



STANDARD TOP SANDWICH PREP TABLES

- Beautiful Ergonomic Construction
- All Stainless Steel Exterior & Interior
- Recessed Door Handles
- Forced Air Refrigeration System
- Rear Mount Compressor
- Electro-mechanical thermostat
- Insulated Hood & Roll Cover to prevent condensation
- (2) Locking, (2) Non-locking Casters
- 1 Year Parts & Labor Warranty
- 5 Years Compressor Warranty
- Refrigerators Temp Range: 33°F (~) 41°F
- Pans Not Included, Sold Separately

Call Toll Free: 800 852 5292
 Web: www.migali.com

CERTIFICATIONS		MEDIA	
Conforms to NSF 7 Foodservice			

Model	Pans	Cu/Ft	Shelves	H/P	Amps	Voltage	Weight (lbs)	Energy Consumption Kwh/24Hr	Cabinet Construction WxDxH (inches)
REFRIGERATORS									
C-SP27-8	8	6.5	1	1/4	3.3	115/60/1	198	2.6	27.5 x 30 x 43.7
C-SP48-12	12	12	2	1/3	5.1	115/60/1	242	3.6	48.2 x 30 x 43.7
C-SP60-16	16	18.2	2	1/2	5.1	115/60/1	330	3.6	60.2 x 30 x 43.7
C-SP72-18	18	32.8	3	1/2	5.7	115/60/1	375	4.1	72.7 x 30 x 43.7

* DRAWER MODELS AVAILABLE WITH CONTAINER ORDERS ONLY

PLAN VIEWS

C-SP72-18

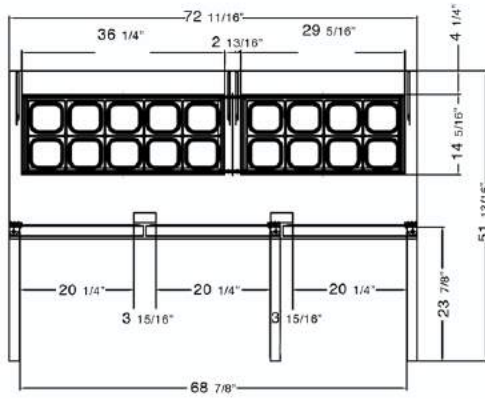

C-SP60-16

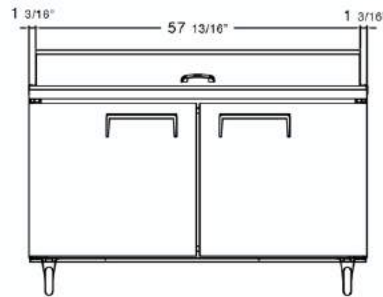
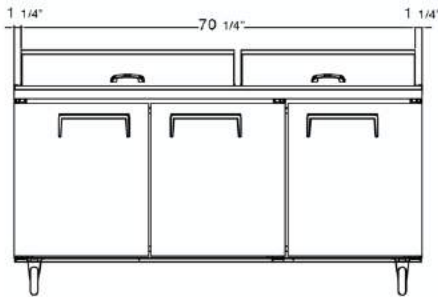
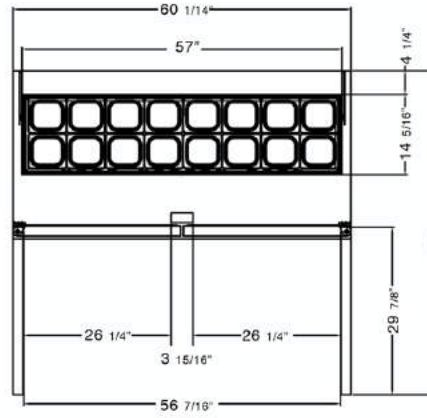

C-SP48-12

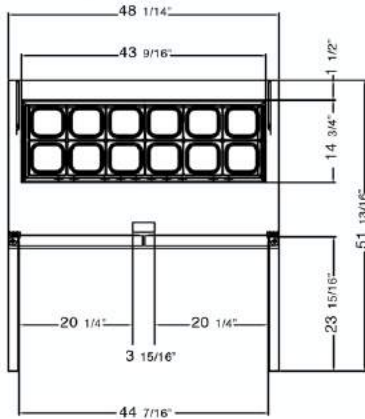

C-SP27-8

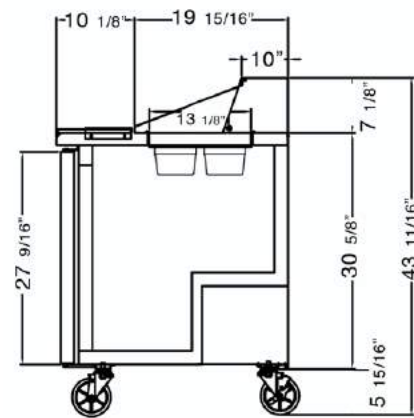
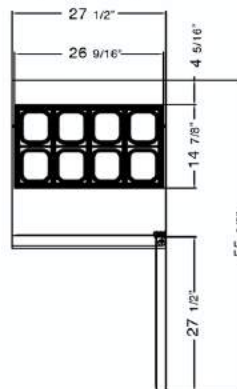

SIDE VIEW

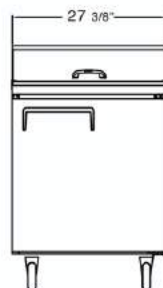

T: 800.852.5292
F: 856.963.3604
E: contact@migali.com
W: www.migali.com