



# Chef Tables - Hard Maple Top

## Stainless Steel Cabinet Base Tables - No Doors

### Certifications:



Shown With Optional Adjustable Shelf



### Features:

- 1 3/4" Thick Hard Maple Bakers Top w/ Penetrating Oil Finish
- 1 5/8" x 6" Straight S/S Leg
- Legs Adjust 1" in Height
- 96" Units have a Center Mullion
- Extra Supporting "C" Channels
- Casters Available

### Material:

- Hard Maple Top
- T-304 18 ga. Stainless Steel Body
- Stainless Steel Legs & Feet

### Options:

- Adjustable Shelf



Open Front	Unit Size (W x L x H)
CMT-3648	36" x 48" x 34.75"
CMT-3660	36" x 60" x 34.75"
CMT-3672	36" x 72" x 34.75"
CMT-3696*	36" x 96" x 34.75"

\* Has a Center Mullion

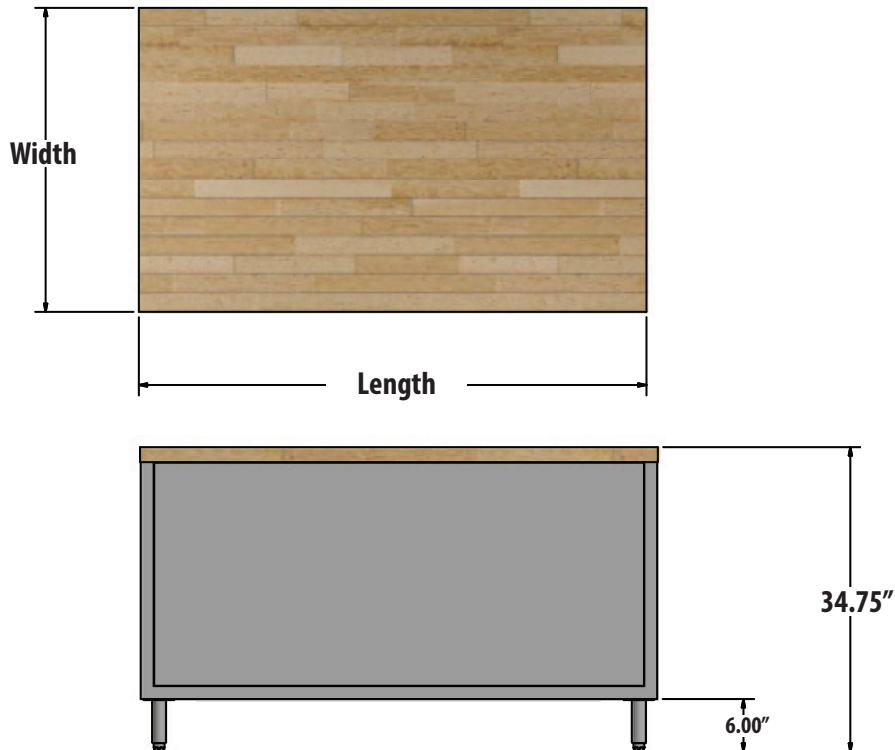

PRODUCT DATA SHEET

BK RESOURCES

