

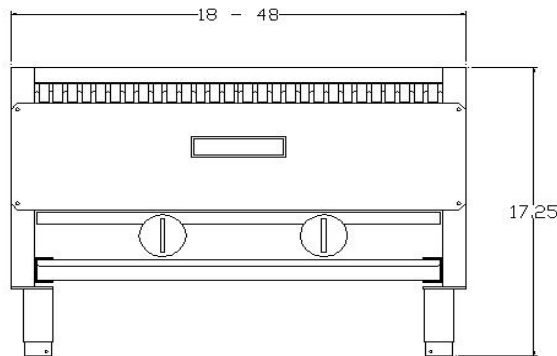

LAVA BROILER



Model #	Width x Depth		Burners	Ship Wgt.	
	in.	mm	Total BTU	lbs.	kg.
ELB36	36"	914	3	280	127
	x 24"	x 610	----- 90,000		



FRONT VIEW

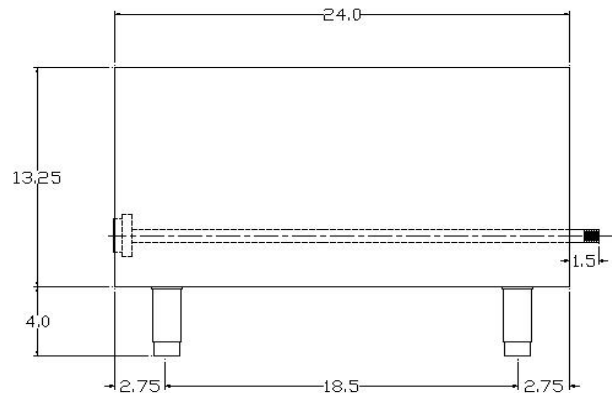

SIDE VIEW

Standard Features, Benefits & Options

CONSTRUCTION: 36" wide x 24" deep x 17¼" tall. Easy cleaning corrosion resistant stainless steel finish. Double wall construction, insulated for energy efficiency.

CONTROLS: Model ELB36 char-broiler is equipped with brass gas valves, adjustable standing pilots and pressure regulators.

BURNERS: 3, efficient straight burners each rated at 30,000 BTU's. Heavy cast iron bottom grates hold lava rock.

COOK TOP: Heavy cast iron top grates each measuring 3" wide x 20¼" deep. Grates feature a cast in trough to channel grease to the front trough to reduce flare-up.

TESTING: Optimal pressure is 4" WC for natural gas, 10" WC for propane. ETL design & ETL Sanitation (ANSI-NSF4) certified.



Comstock-Castle Stove Co. • 119 W. Washington St. • Quincy, IL 62301
Tel.: 217-223-5070 • Fax.: 217-223-0007 • Web: www.castlestove.com

