



CSHRI Roll-Ins

Coolscapes™ Heated Roll-In

Project _____
Item _____
Quantity _____
CSI Section 11400
Approved _____
Date _____

CSHRI Roll-Ins

Models

CSHRI1-S

CSHRI2-S



CSHRI1-S

Standard Features

- GreenGenius™ R290 top mount refrigeration system featuring TXV expansion valve and hot gas condensate removal
- Digital exterior temperature display with high/low temp visual alarms
- Removable side louver
- Raised ABS interior door liner
- Smart door hinge that auto closes up to 90° and stays open past 90°
- Energy efficient door gasket – removable without tools
- Door locks
- 10' cord and plug attached
- Stainless steel exterior front, sides & interior
- 115V / 60C / 1 P Standard

Options

- S/S finish door liner
- Stainless steel back
- Laminate – front, ends, shroud
- Heat shield end – max temp 400 degrees
- Trim strips

Specifications

Heating system: All components are mounted to the top cabinet ceiling, outside the food zone. Cabinets are designed to maintain temperatures between 120°F and 200°F. Heating elements are located behind the vertical ducts. The design of the heater, which is full length of the vertical duct, allows for optimal air flow and energy efficiency. Fan motor is mounted outside of the heated compartment. System is controlled using an electronic temperature control.

Units are completely insulated with high density foamed in place environmentally friendly, Kyoto Protocol Compliant, Non ODP (Ozone Depletion Potential), Non GWP (Global Warming Potential) polyurethane.

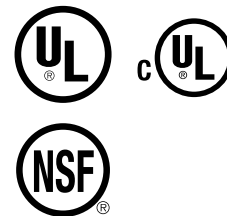

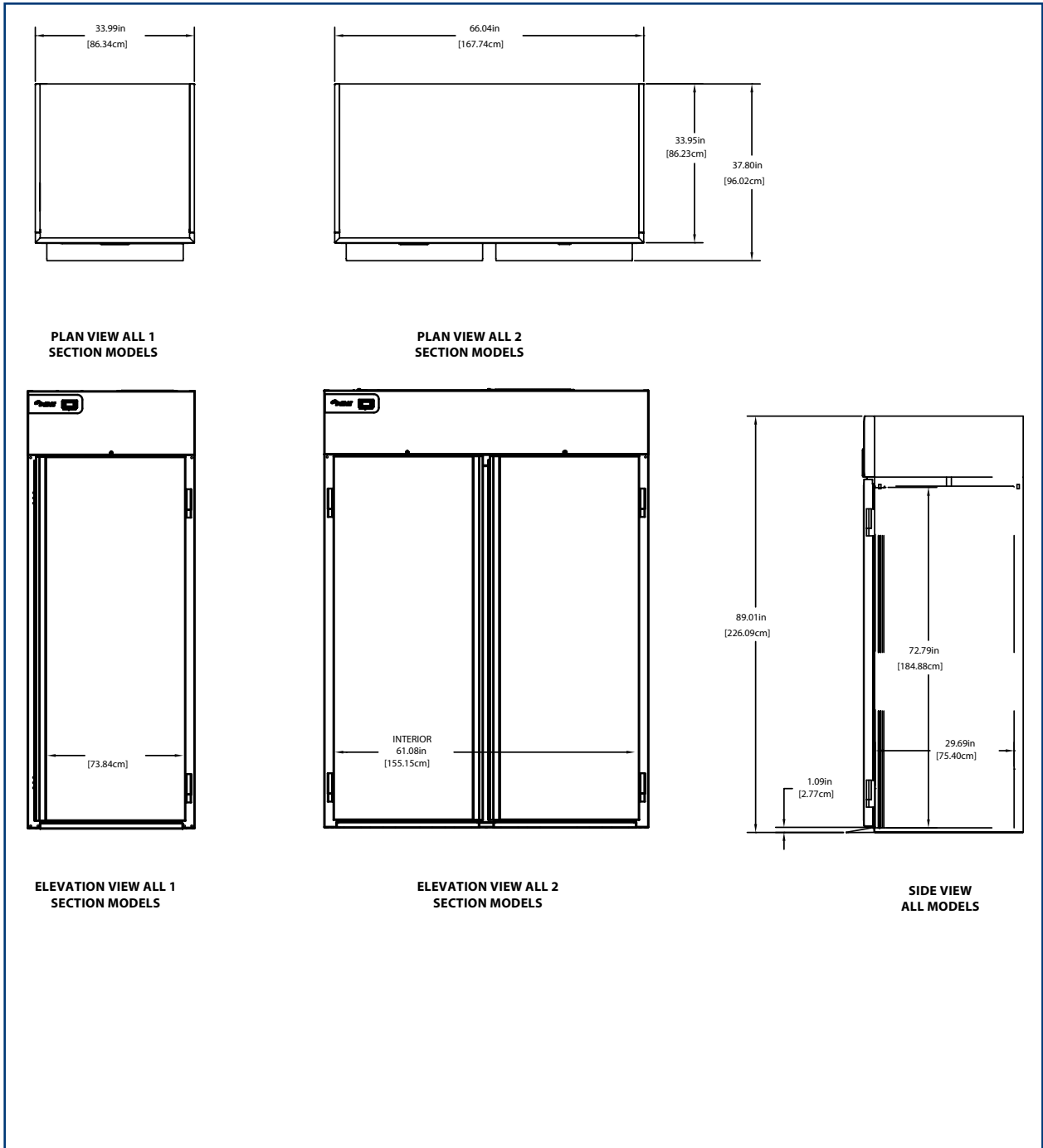

CSHRI Roll-Ins
 Coolscares™ Heated Roll-In

Specifications									
Model	V/Hz/Ph	Amps	Volume Cu. Ft.	SHELF CAPACITY SQ. FT.	No. of Shelves	Unit H.P.	Btu/Hr System Cap	Ship Weight	Nema Plug
CSHRI1-S	208-240/60/1	6	37	N/A	N/A	N/A			6-20P
CSHRI2-S	208-240/60/1	10.5	76.5	N/A	N/A	N/A			6-20P

Delfield reserves the right to make changes to the design or specifications without prior notice.