

Item #: _____ **Qty #:** _____
Model #: _____
Project #: _____



MODEL #	Length	A	Wt.
EDC-1548-X	48"	15"	155 lbs.
EDC-1560-X	60"	15"	195 lbs.
EDC-1572-X	72"	15"	225 lbs.
EDC-1848-X	48"	18"	170 lbs.
EDC-1860-X	60"	18"	205 lbs.
EDC-1872-X	72"	18"	245 lbs.

DETAILS and SPECIFICATIONS

FEATURES:

FLAT TOP is furnished with a 1 5/8" sanitary rolled rim on the front and 1 5/8" square bend edges on the 2 sides and rear.
 Rear flush panel along the rear of the base unit.

MATERIAL:

TOP is heavy gauge stainless steel with galvanized hat channel.
 BODY is heavy gauge stainless steel.
 LEGS are 1 5/8" diameter tubular stainless steel with stainless steel gussets and 1" adjustable stainless steel bullet feet.

CONSTRUCTION:

All TIG welded. Exposed areas finished to match adjacent surfaces.
 Entire Top is mechanically polished to a satin finish and is sound deadened.
 Roll formed embossed galvanized hat channels are secured to top by means of structural sound-deadening adhesive and weld studs.
 UNIT-BODY DESIGN sides, back and shelf are welded to form a single rigid structure.
 Gussets welded to support hat sections.

TOL ± .500"

ALL DIMENSIONS ARE TYPICAL

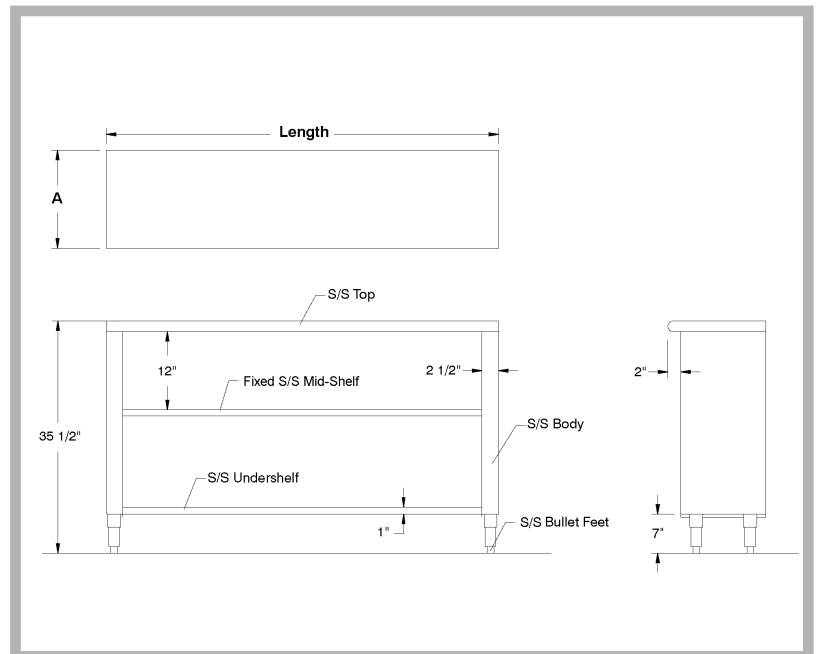

Customer Service Available To Assist You 1-800-645-3166 8:30 am - 8:00 pm E.S.T.
 Email Orders To: customer@advancetabco.com. For Smart Fabrication™ Quotes, Email To: smartfab@advancetabco.com or Fax To: 631-586-2933

NEW YORK
 Fax: (631) 242-6900

GEORGIA
 Fax: (770) 775-5625

TEXAS
 Fax: (972) 932-4795

NEVADA
 Fax: (775) 972-1578