

# COUNTERTOP REFRIGERATED DISPLAY CASE SELF-CONTAINED CONDENSING UNIT



ESC83R

ESC Series



### Refrigeration System

- Right mounted self-contained condensing unit uses environmentally friendly, EPA compliant R290 refrigerant with zero (0) Ozone Depletion Potential (ODP) and three (3) Global Warming Potential (GWP).
- Rear condenser airflow intake and side louver exhaust promote efficient ventilation.
- Top to bottom evaporator tubes provide balanced cooling. Triple-looped and nickel plated copper tubing. Bottom coil is located under the interior flooring.
- Corrosion-resistant condenser coil.
- Electronically commuted (ECM) condenser fan motor achieve rapid cooling with less energy consumption.
- Removable and washable condenser coil air filter.
- Exterior on/off power switch.
- Pre-wired and ready to plug, 115V/60Hz/1Ph, NEMA 5-15P.

### Cabinet Construction

- Wide single piece, curved glass display window.
- Open spaced interior with no walls between compartments.
- Heavy duty, ABS plastic exterior casing.
- Black coated steel housing for condensing unit.
- Stainless steel floor interior has rounded corners and two drain holes for ease of cleaning.
- High density, foamed-in-place insulation.

### Lighting

- Shielded LED bar lighting with on/off switch provides bright, high color illumination at lower heat output.

### Doors

- 6 3/4" high removable sliding glass doors for storage accessibility and ease of cleaning.

### Trays

- Durable plastic trays have two mounting styles which offer medium to low temperature coverage.

### Temperature Control

- Factory preset temperature of 38°F at an ambient temperature of 80°F. (no controls equipped)
- NSF certified thermometer.



Type	Doors	Capacity Cu. Ft.	# of Pans (Top)	# of Pans (Drawer)	Shelves	Refrigerant	HP	Power V-Hz-Ph	Amps	Crated Weight	Exterior Dimensions		
											L	D	H*
REF	4	3	-	-	-	R-290	1/8	115-60-1	1.5	165 lbs	82.625"	14"	11.125"

(†)Based on evaporating temperature of 23°F (-5°C) & condensing temperature of 131°F (55°C). (‡) Product capacity is calculated based on standard industry figures. (\*) Reference plan view for clarification on caster/unit height. If dimensions and capacity are critical, please contact Everest Refrigeration. Blizzard R290 replacement is at the sole discretion of Everest Refrigeration. Specifications subject to change without notice.

# COUNTERTOP REFRIGERATED DISPLAY CASE SELF-CONTAINED CONDENSING UNIT



## ESC83R

## ESC Series

### DIMENSIONAL DATA

External Dims.	L	82.625 in.
	D	14 in.
	H*	11.125 in.
Crated Weight		165 lbs.
Doors/Drawers/Lids		4
Max Weight Support		-

### STORAGE DATA

Net Capacity Cu. Ft. $\blacktriangleright$	3
Shelves	-
Barrels	-
20 oz. Bottles	-
12 oz. Bottles	-
12 oz. Cans	-
8" Mugs	-
# of Pans (Top)	-
# of Pans (Drawer)	-
Dividers	-
Trays	6

### ELECTRICAL DATA

Voltage	115-60-1
Full Load Amperage	1.5A
Feed Wires w/ Ground	3
Cord Length	9ft
NEMA Plug Type	 NEMA 5-15P

### REFRIGERATION DATA

Compressor	Right
Refrigerant	R-290
Compressor HP	1/8
BTU/HR <sup>†</sup>	1211

### KEY

<b>D</b>	Door	<b>R</b>	Refrigerator
<b>L</b>	Lid	<b>REF</b>	Refrigerator
<b>H</b>	Half Door	<b>F</b>	Freezer
<b>FD</b>	Full Door	<b>FRZ</b>	Freezer
<b>SD</b>	Solid Door	<b>DUAL</b>	REF/FRZ Combo
<b>GD</b>	Glass Door	<b>DR</b>	Drawer

	Elevation	Right	Plan	3D	Back

### PLAN VIEW

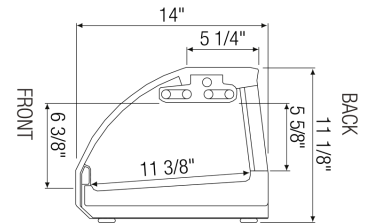

FRONT

SIDE

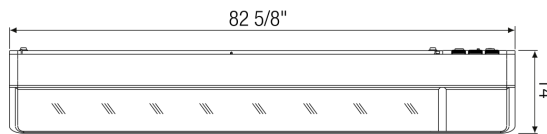

TOP

### ACCESSORIES & OPTIONS

(<sup>†</sup>)Based on evaporating temperature of 23°F (-5°C) & condensing temperature of 131°F (55°C). ( $\blacktriangleright$ ) Product capacity is calculated based on standard industry figures. (<sup>\*</sup>) Reference plan view for clarification on caster/unit height. If dimensions and capacity are critical, please contact Everest Refrigeration. Blizzard R290 replacement is at the sole discretion of Everest Refrigeration. Specifications subject to change without notice.