

# Reach In Refrigerators - Bottom Mount



**CR-17-SDR**  
(formerly VR-17-A-SA-US)

Height 74"  
Length 30"  
Depth 25.75"



**CR-23-SDR**  
(formerly CR-23-A-SA-US)

Height 78"  
Length 30"  
Depth 29.5"



**CR-49-SDR**  
(formerly CR-49-A-SA-US)

Height 78"  
Length 60"  
Depth 29.5"

## Features

- Stainless steel doors with door locks
- Heavy duty hinge with self closing mechanism
- Exterior galvanized pre painted steel
- Stainless steel floor, aluminum interior
- Heavy duty epoxy coated shelves
- Digital temperature display
- Door locks
- 5" casters
- Robust body with 2-1/2" thick walls, injected with CFC-free polyurethane
- UL Classified to ANSI/NSF 7
- Forced air evaporator for rapid temperature "Pull Down"
- Self contained heavy duty 134a condensing unit
- 10' power cord



**CR-65-SDR**  
(formerly CR-65-A-SA-US)

Height 78"  
Length 76.75"  
Depth 29.5"

Model No.	Description	Voltage	Amps	Temp	HP	Est. Ship Weight
CR-17-SDR	1 Door/3 Shelves	115	3.8	32°F - 39°F	1/4	240#
CR-23-SDR	1 Door/4 Shelves	115	4	32°F - 39°F	1/4	318#
CR-49-SDR	2 Door/8 Shelves	115	6.5	32°F - 39°F	1/3	548#
CR-65-SDR	3 Door/12 Shelves	115	10.2	32°F - 39°F	1/2	758#



# Technical Data / Reach In Refrigerators



Model #	CR-17-SDR	CR-23-SDR	CR-49-SDR	CR-65-SDR
<b>Outside Dimensions</b>				
Depth	25.75"	29.5"	29.5"	29.5"
Length	30"	30"	60"	76.75"
Height	74"	78"	78"	78"
Door Size	30.75" x 45.875"	30" x 51.75"	30" x 51.75"	25.75" x 51.75"
Door Type	1 swing	1 swing	2 swing	3 swing
<b>Inside Dimensions</b>				
Depth	21.75"	25.25"	25.5"	25.5"
Length	25.25"	25.25"	55.25"	72"
Height	54.375"	61.25"	61.25"	61.25"
Shelf Size	24.5"x19.5"	24.56"x23.125"	27.125"x21.688"	(8) 22.125"x22.375" (4) 22.75"x22.375"
# of Shelves	3	4	8	12
Capacity: Cubic Foot	17	23	49	65
<b>Specifications</b>				
Operating Temperature	32°F-39°F	32°F-39°F	32°F-39°F	32°F-39°F
Refrigerant	134a	134a	134a	134a
Compressor Size HP	1/4	1/4	1/3	1/2
Voltage	115	115	115	115
Amperage	3.8	4	6.5	10.2
Cord and Plug	yes	yes	yes	yes
<b>Shipping Dimensions</b>				
Depth	30"	34"	34"	34"
Length	34"	34"	67"	84"
Height	80"	88"	88"	88"
Gross Weight lbs.	240	318	548	758
Cubic feet	47	59	116	145

**CR-17-SDR**

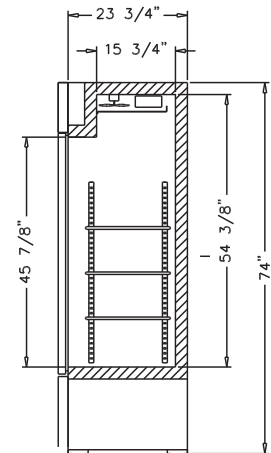
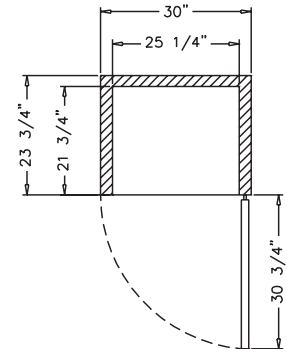

- Cases are designed to operate at 75°F and 55% relative humidity.
- Specification subject to change without notice.

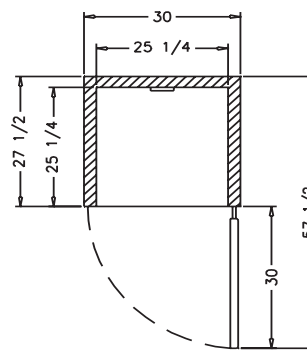
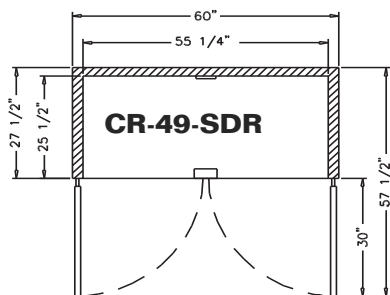
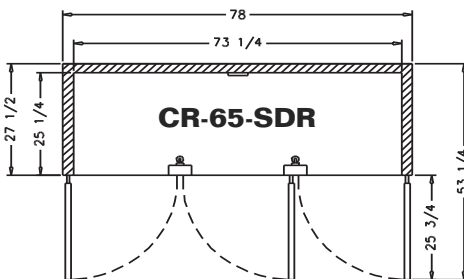

**CR-23-SDR**

