

# Horizontal Beer Frosters



**Froster-B-25-US**

Height 33.63"  
Length 26"  
Depth 27.25"



**Froster-B-50-US**

Height 33.63"  
Length 51.25"  
Depth 27.25"



**Froster-B-65-US**

Height 33.63"  
Length 66.25"  
Depth 27.25"

## Features

- Cabinet made of galvanized steel, internally reinforced to support the full weight of the beer bottles
- Full color decals to attract consumers at the point of sale
- Top and sliding doors constructed of stainless Steel
- UL Classified to ANSI/NSF 7
- Self contained heavy duty 134a condensing unit
- Forced air evaporator for rapid temperature "Pull Down"



**Froster-B-95-US**

Height 33.63 "  
Length 96"  
Depth 27.25"

Model No.	Description	Voltage	Amps	Temp	HP	Est. Ship Weight
Froster-B-25-US	1 Door/96 Bottles	115	4.3	23°F - 34°F	1/5	178#
Froster-B-50-US	2 Door/336 Bottles	115	7.6	23°F - 34°F	1/3	284#
Froster-B-65-US	3 Door/480 Bottles	115	9.2	23°F - 34°F	1/2	348#
Froster-B-95-US	4 Door/720 Bottles	115	12.6	23°F - 34°F	3/4	378#

# Technical Data / Horizontal Beer Frosters



Model #	Froster-B-25-US	Froster-B-50-US	Froster-B-65-US	Froster-B-95-US
<b>Outside Dimensions</b>				
Depth	27.25"	27.25"	27.25"	27.25"
Length	26"	51.25"	66.25"	96"
Height	33.63"	33.63"	33.63"	33.63"
Door Size	22.312"x13.375"	(1) 30.5"x13.375" (1) 16.85"x13.375"	(2)22.625"x13.375" (1) 16.85"x13.375"	(3) 23"x13.375" (1) 16.375X13.375"
Door Type	1 sliding	2 sliding	3 sliding	4 sliding
<b>Inside Dimensions</b>				
Depth	22.5"	22.5"	22.5"	22.5"
Length	21.25"	46.5"	61.5"	91.25"
Height	22.5"	22.5"	22.5"	22.5"
# of 12oz Bottles	96	336	480	720
Dividers Included	0	3	4	5
Capacity: Cubic Foot	5	15	21	31
<b>Specifications</b>				
Operating Temperature	23°F-34°F	23°F-34°F	23°F-34°F	23°F-34°F
Refrigerant	134a	134a	134a	134a
Compressor Size HP	1/5	1/3	1/2	3/4
Defrost	3 @ 30 min.	3 @ 30 min.	3 @ 30 min.	3 @ 30 min.
Voltage	115	115	115	115
Amperage	4.3	7.6	9.2	12.6
Cord and Plug	yes	yes	yes	yes
<b>Shipping Dimensions</b>				
Depth	31"	31"	31"	31"
Length	31"	56"	71"	100"
Height	40"	40"	40"	40"
Gross Weight lbs.	178	284	348	378
Cubic feet	22	40	51	72

- Cases are designed to operate at 75°F and 55% relative humidity.
- Specification subject to change without notice.

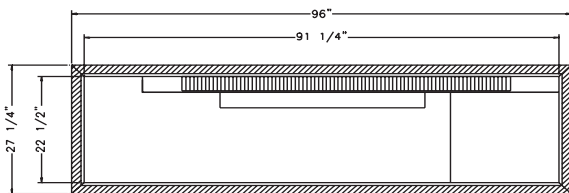

**Froster-B-95-US**

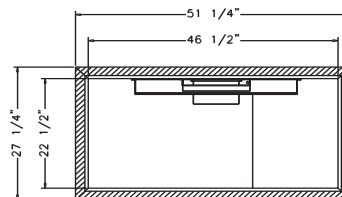

**Froster-B-50-US**

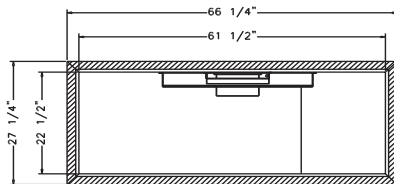

**Froster-B-65-US**

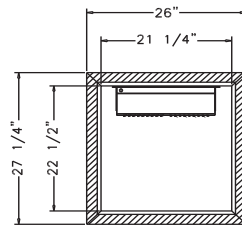

**Froster-B-25-US**

