

Beer Dispensers



DBD-1E

Height 51.5" / 56.5" casters
 Length 25.25"
 Depth 33.75"



DBD-2E2

Height 51.5"
 Length 56.25"
 Depth 25.13"



DBD-4

Height 51.5"
 Length 90.13"
 Depth 25.13"



DBD-3

Height 51.5"
 Length 69.13"
 Depth 25.13"

Features

- 24" deep stainless steel top
- Top guard rail on DBD-1
- Pre painted black steel exterior
- Stainless steel interior floor
- Self closing glass doors with safety stop at 120 degrees and recesses handles
- Door locks
- Heavy duty lift off chrome plated hinges
- Foamed in place high density CFC free polyurethane foam insulation provides a solid structure and low energy consumption
- Forced air evaporator for rapid temperature "Pull Down"
- Self contained heavy duty 134a condensing unit
- Bumpers on back for protection
- UL Classified to ANSI/NSF 7

Model No.	Description	Voltage	Amps	Temp	HP	Est. Ship Weight
DBD-1E	1 Dispenser/1 Tower	115	4.7	33°F - 41°F	1/5	230#
DBD-1E-2	2 Dispensers/1 Tower	115	4.7	33°F - 41°F	1/5	230#
DBD-2E2	2 Dispenser/2 Tower	115	8.2	33°F - 41°F	1/3	341#
DBD-2E2-2	4 Dispenser/2 Tower	115	8.2	33°F - 41°F	1/3	341#
DBD-3	2 Dispenser/2 Tower	115	8.2	33°F - 41°F	1/3	425#
DBD-3-2	4 Dispenser/2 Tower	115	8.2	33°F - 41°F	1/3	425#
DBD-4	4 Dispenser/2 Tower	115	10.4	33°F - 41°F	1/3	525#



Technical Data / Beer Dispensers



Model #	DBD-1E	DBD-2E2	DBD-3	DBD-4
Outside Dimensions				
Depth	33.25"	25.13"	25.13"	25.13"
Length	25.25"	56.25"	69.13"	90.13"
Height	51.5"/56.5" with caster	51.5"	51.5"	51.5"
Door Size	31.375" x 22.625"	31.375" x 19.25"	31.625" x 22.5"	31.625" x 22.5"
Door Type	1 swing	2 swing	2 swing	3 swing
Inside Dimensions				
Depth	25.5"	20.375"	20.375"	20.375"
Length	21.25"	52.25"	65.13"	86.13"
Height	31.25"	31.75"	31.75"	31.75"
# of Kegs	1	2	3	-
# of Taps	1 (2 taps DBD1E-2)	2 (4 taps DBD2E2-2)	2(4 taps DBD3-2)	4
Capacity: Cubic Foot	9.81	14.5	19	26
Specifications				
Operating Temperature	33°F-41°F	33°F-41°F	33°F-41°F	33°F-41°F
Refrigerant	134a	134a	134a	134a
Compressor Size HP	1/5	1/3	1/3	1/3
Voltage	115	115	115	115
Amperage	4.7	8.2	8.2	10.4
Cord and Plug	yes	yes	yes	yes
Shipping Dimensions				
Depth	30"	30"	30"	30"
Length	42"	64"	73"	93"
Height	44"	44"	44"	44"
Gross Weight lbs.	230	341	425	525
Cubic feet	26	40	55	71

DBD-1E

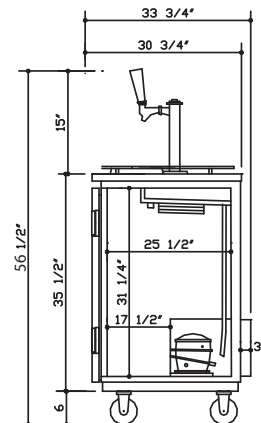
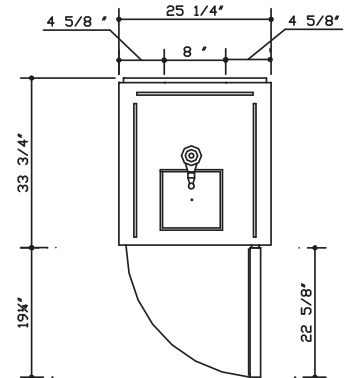

- Cases are designed to operate at 75°F and 55% relative humidity.
- Specification subject to change without notice.

