

# R-290 Glass Door Merchandiser



## VR-12-HC

Height	62.13"
Length	25.63"
Depth	22.75"
Cubic Ft.	12
Liters	340
Bottles (20 oz)	168
Cans (12oz)	384



## VR-26-HC

Height	78"
Length	30"
Depth	29.5"
Cubic Ft.	26
Liters	736
Bottles (20 oz)	355
Cans (12oz)	890

## Features

- Hydrocarbon R-290 propane grade refrigerant, which is environmentally friendly, making the HC units a greener cooler
- Electronic control with energy saving button and three different temperature range settings
- Double pane glass door with Low-E protection to avoid condensation.
- Heavy duty adjustable shelves
- Robust body made of pre-painted galvanized steel
- Heavy duty condensing unit for R-290, with easy access for service
- Forced air evaporator for quick temperature pull down, with low maintenance condenser
- Polyurethane insulation with cyclopentane as blowing agent
- Energy efficient LED lighting

Model No.	Description	Voltage	Amps	Temp	HP	Est. Ship Weight
VR-12-HC	1 Glass Door / 3 Shelves	115	4.2	32°F - 39°F	1/4	235#
VR-26-HC	1 Glass Door / 4 Shelves	115	5.8	32°F - 39°F	1/2	498#



# Technical Data / R-290 Glass Door Merchandiser



Model #	VR-12-HC	VR-26-HC
<b>Outside Dimensions</b>		
Depth	22.75"	29.5"
Length	25.63"	30"
Height	62.13"	78"
Door Size	25.25"x50.31"	29.75"x55.13"
Door Type	1 swing	1 swing
<b>Inside Dimensions</b>		
Depth	19"	25.75"
Length	22"	26.5"
Height	42.5"	55"
Shelf Size	21.25"x17.56"	25.68"x24"
# of Shelves	3	4
Capacity: Cubic Foot	12	26
<b>Specifications</b>		
Operating Temperature	32°F-39°F	32°F-39°F
Refrigerant	R290	R290
Compressor Size HP	1/4	1/2
Voltage	115	115
Amperage	4.2	5.8
Cord and Plug	yes	yes
<b>Shipping Dimensions</b>		
Depth	27"	34"
Length	30"	34"
Height	69"	82"
Gross Weight lbs.	235	498
Cubic feet	32	56

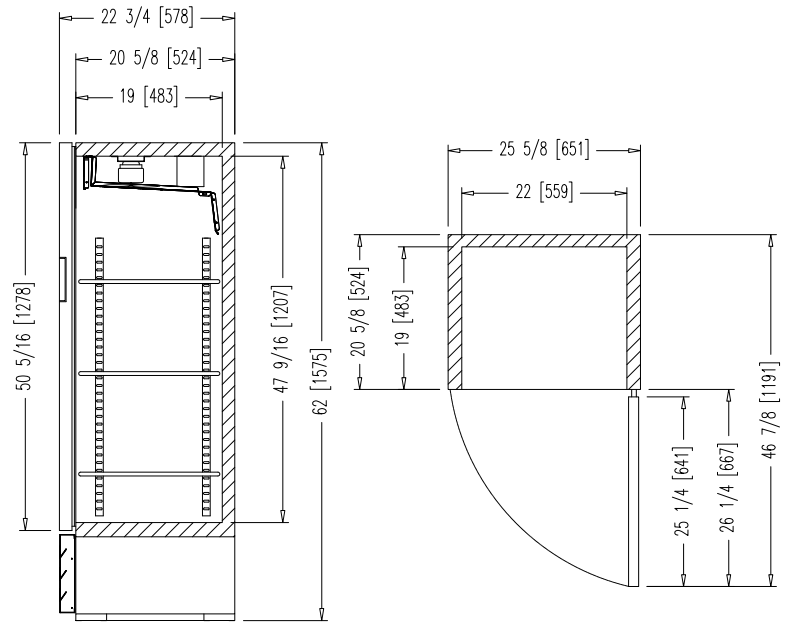

**VR-12-HC**

**SIDE VIEW**

**TOP VIEW**

- Cases are designed to operate at 75°F and 55% relative humidity.
- Specification subject to change without notice.

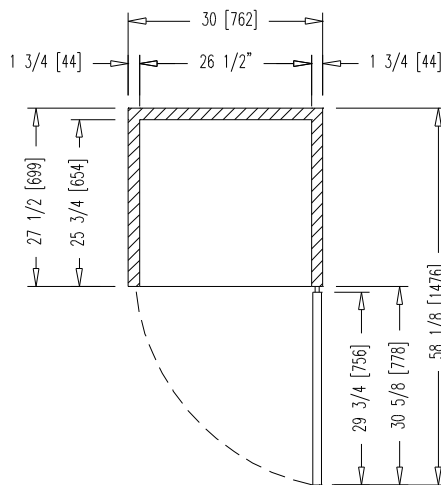

**TOP VIEW**

**VR-26-HC**

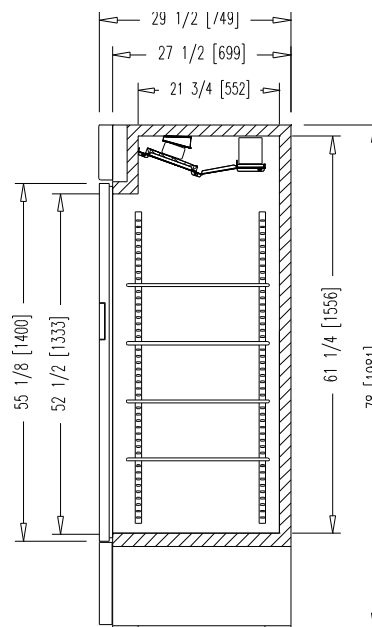

**SIDE VIEW**

