

Standard Features – Back Bar Refrigerator #ABB-90G-27



Model #ABB-90G-27

Cooling

| | |
|--------------------------|-----------|
| Temperature Range | 33°F-41°F |
| Refrigerant | R290 |
| Max. Ambient Temperature | 90°F |
| Defrosting | Automatic |
| Temperature Controller | Digital |
| Horsepower | 1/4 |

Electrical

| | |
|------------------------|------------|
| Voltage | 115 |
| Amps | 4.7 |
| Hz | 60 |
| Phase | 1 |
| Plug Type | NEMA-5-15P |
| Electrical Cord Length | 84" |

- Environmentally safe R290 refrigerant
- Durable black coated steel exterior with solid doors
- Painted aluminum
- 1-1/2" built-in stainless steel top
- Foamed-in-place polyurethane insulation
- (3) Thermal pane glass doors
- Accommodates up to (2) ½ kegs
- 32 cu. ft. interior
- (6) epoxy coated steel shelves
- Digital temperature controller
- 115V; 1/4 HP
- ETL listed. Conforms to UL STD. 471, Certified to CSA STD. C22. 2No.120
- Conforms to NSF/ANSI STD. 7.

Construction

| | |
|---------------------|------------------------------|
| Exterior Material | Black Coated Steel |
| Interior Material | Painted aluminum |
| Insulation Material | Foamed-In-Place Polyurethane |
| Shelf Size | (6) epoxy coated steel |
| Load Capacity | 90 lb. |

Dimensions

| | |
|---------------------|--------------------------------|
| Exterior Dimensions | 72-3/4"W x 27-3/4"D x 36-1/2"H |
| Shipping Dimensions | 91-3/4"W x 30-1/2"D x 41-3/4"H |
| Net Volume | 23.3 cu. ft. |
| Net Weight | 370 lb. |
| Gross Weight | 414 lb. |



Parts & Labor

Compressor

PLAN VIEW

Front View

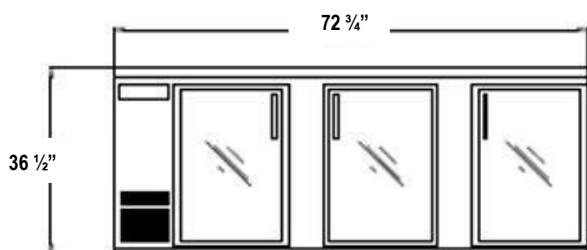

Side View

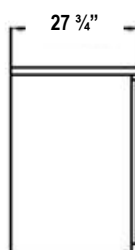

Top View

