

Slope Top Wall Cabinets

- * 18 gauge stainless steel.
- * Machine mold with manual welding.
- * Mination control .
- * Special wall hung design w/ adjustable middle shelf.
- * Cabinets are available with hinged or sliding doors.

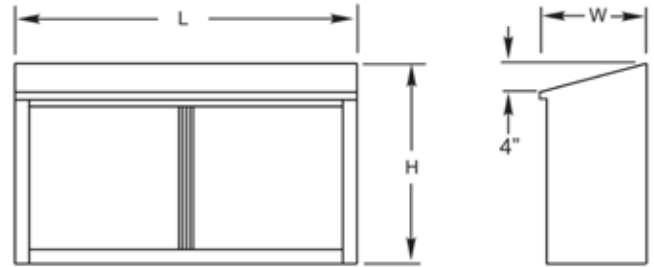

CWD-1536H



Adjustable Shelf



CWD-1536S

Order No		W	L	H	Weight lbs/ea
Hinged Door	Sliding Door				
CWD-1536H	CWD-1536S	15	36	35	83
CWD-1548H	CWD-1548S	15	48	35	92
CWD-1560H	CWD-1560S	15	60	35	101
CWD-1572H	CWD-1572S	15	72	35	166

Flat Top Dish Cabinet Tables

- * 18 gauge stainless steel.
- * Machine mold with manual welding.
- * Full range fixed stainless steel under middle shelves.
- * S/S 1-1/2" of adjustable hex foot legs.

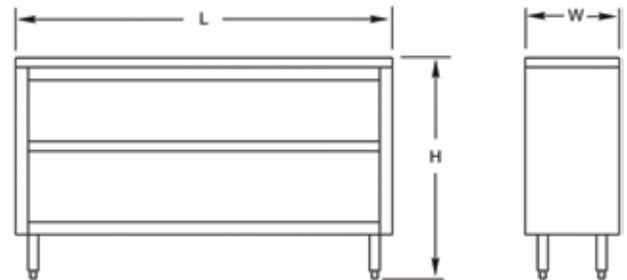

CDN-1548

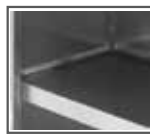

Fixed Shelf

Order No	W	L	H	Weight lbs/ea
CDN-1536	15	36	35	100
CDN-1548	15	48	35	140
CDN-1560	15	60	35	170
CDN-1572	15	72	35	200

Cabinets (3~5)