



C1SL48
 with compressor left,
 stainless steel doors,
 and stainless top



Intertek
 EP 5016978
 Energy Performance
 Verified / Rendement
 Énergétique Vérifié



Intertek
 4004503
 Conforms to NSF/ANSI STD 7
 and UL STD 471
 Certified to CSA STD C22.2 No. 120
 Listed to NSF Standard 7
 for open food as a storage refrigerator



Intertek

Standard Features

- Self-contained
- Stainless steel interior
- Locking door(s)
- LED interior lighting
- Heated mullion to minimize condensation

Project: _____	AIA# _____
Item #: _____ Qty: _____	SIS# _____
Model #: _____	

**Coolers,
 One Zone, Side Serviced,
 Low Profile**

C1SL	C1SL24, C1SL28, C1SL36, C1SL44, C1SL48
-------------	---

CONFIGURATION HIGHLIGHTS

 DOORS IN NINE FINISHES	 DRAWERS IN FIVE FINISHES
--	---

Configurable Options

- Temperature:**
- Beer/Food - 34°F to 40°F
 - White wine - 50°F to 55°F
 - Red wine - 60°F to 65°F
- Refrigeration Compartment Location:**
- Left or Right
- Refrigeration Compartment Cover Finish:**
- Black vinyl-clad
 - Stainless steel
 - Jeweled stainless
- Door Style & Finish (specify per door section):**
- Black vinyl-clad
 - Stainless steel
 - Jeweled stainless
 - Laminated
 - Unlaminated
 - Glass, black vinyl-clad
 - Glass, stainless steel
 - Glass, jeweled stainless
 - Glass, laminated
- Drawer Style & Finish:**
- Black vinyl-clad
 - Stainless steel
 - Jeweled stainless
 - Laminated
 - Unlaminated
- Door Hinge Location (specify for each door):**
- Left or Right
- Door Handle:**
- Signature
 - Pull-tab
 - Tube
- Shelving (specify per door section):**
- Two adjustable, coated-wire shelves
 - Pull-out wine shelves (C1SL36 excluded):
 - » one upright and two horizontal storage combination
 - » four horizontal storage or five if not next to compressor compartment
- Top Style:**
- No finished top
 - Stainless top
 - Drainboard top
- Left and Right Side Finish:**
- Black vinyl-clad
 - Stainless steel
- Back Finish:**
- Galvanized steel
 - Stainless steel
- LED Lighting Style:**
- Bright white (7,000k)
 - Warm white (3,500k)
 - Amber (2,700k)
 - Blue

Glastender, Inc. • 5400 N Michigan Rd • Saginaw, MI • 48604-9780 989.752.4275 • 800.748.0423 • Fax 989.752.4444 www.glastender.com	Approval/Notes:
Specifications subject to change without notice. For current specifications please visit our website.	

Coolers - One Zone, Side Serviced, Low Profile

Specifications

		C1SL24	C1SL28	C1SL36	C1SL44	C1SL48
Dimensions	Length	24"	28"	36"	44"	48"
	Number of Sections	1	1	2	2	2
	Door Opening	17.5"	20"	12"	16"	18"
Electrical	Electrical Supply	120V, 1 phase, 60 Hz, dedicated 15A circuit required				
	Full Load Amps	2.75				
	Plug Type	8 foot NEMA 5-15P grounded cord and plug which exits the back of refrigeration compartment*				
Refrigeration	Refrigerant	R290 - 105 grams, 3.7 oz., 0.23 pounds				
	Compressor	Reciprocating, 1/8HP, 1,000 BTUH, 0.08 Tons				
	Heat Rejection	1126 BTU/hr				
Operating Range		34°F (1°C) to 65°F (18°C)				
Plumbing		Automatic condensate evaporator. No drain connection required †				
Weight Bearing Capacity		Countertops and other accessories should not exceed 500 pounds per door				

Materials

- Stainless steel parts include: exterior sub-top, interior, front of cabinet, hinges, hinge and lock brackets, and optional legs
- Black vinyl-clad steel parts include: standard sides, doors and compressor cover
- Galvanized steel parts include: back and bottom
- Zinc plated CR steel parts include: leg sockets

Plumbing

- Optional drainboard top 1/2" ID drain line stubs out beneath the compressor compartment; field connection required



5-15P

† Building conditions outside the guidelines of ASHRAE 55 and ASHRE 62.1 may need to be plumbed to a drain.

Capacities

		C1SL24	C1SL28	C1SL36	C1SL44	C1SL48
12 oz. bottles, cases		4.5	5.1	6.9	8.9	10.3
750ml wine bottles		36	42	54	72	84
1/2 barrel kegs		N/A	N/A	N/A	N/A	N/A
1/6 barrel kegs		N/A	N/A	N/A	N/A	N/A
Capacity values below are per door/drawer section (750ml wine bottles)						
Next to compressor	Drawers	0*	0*	0*	0*	0*
	Upright	N/A	N/A	N/A	N/A	N/A
	Horizontal	24	32	N/A	24	28
	Combination pull-out	34	42	N/A	30	36
Not next to compressor	Drawers	N/A	N/A	0*	0*	0*
	Upright	N/A	N/A	N/A	N/A	N/A
	Horizontal	N/A	N/A	N/A	30	35
	Combination pull-out	N/A	N/A	N/A	40	52

* Not tall enough for wine bottles



5400 N Michigan Rd • Saginaw, MI • 48604-9780
989.752.4275 • 800.748.0423 • Fax 989.752.4444
www.glastender.com

Printed in USA

Coolers - One Zone, Side Serviced, Low Profile

Drawings

PLAN VIEWS

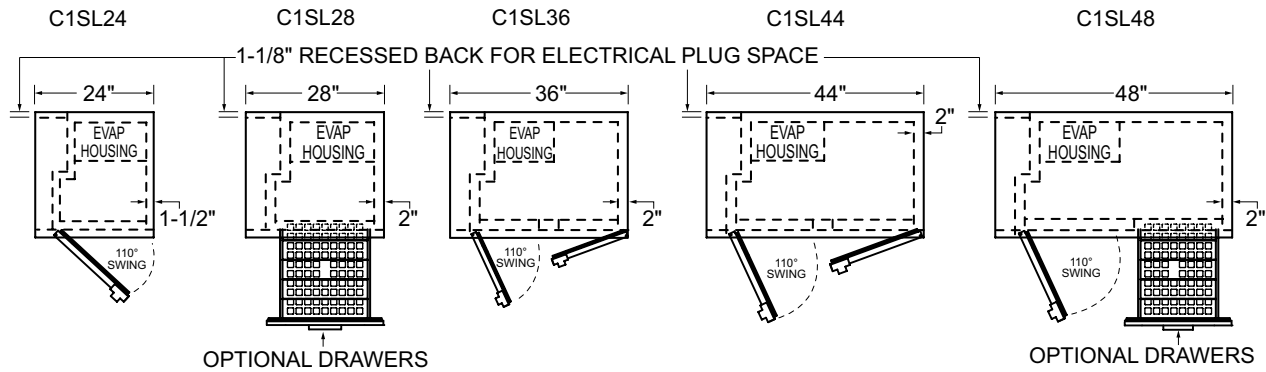

FRONT VIEWS

* ADD 1" HEIGHT TO TOP FOR FACTORY INSTALLED TOP

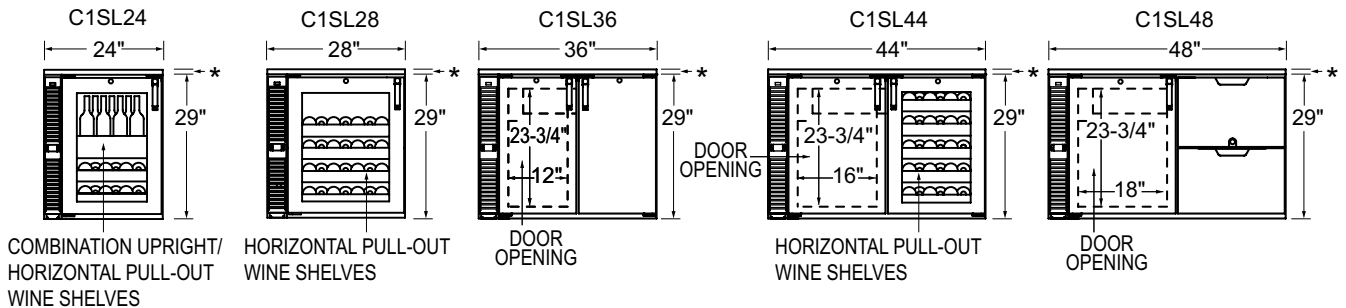

SIDE VIEWS

* ADD 1" HEIGHT TO TOP FOR FACTORY INSTALLED TOP

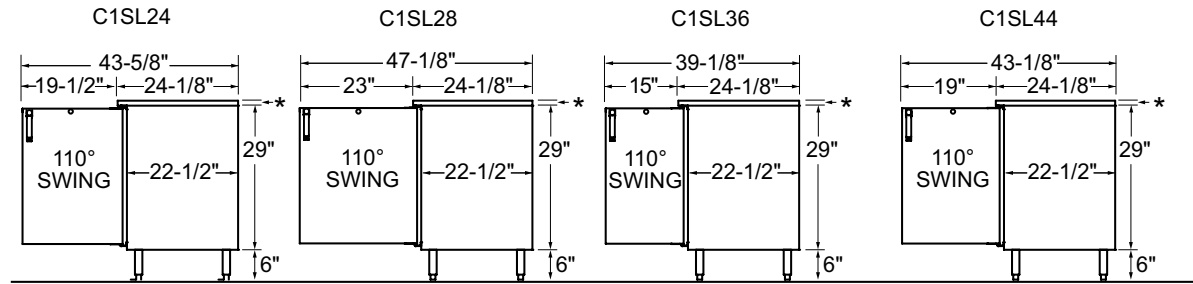

C1SL48

ALL MODELS SHOWN WITH OPTIONAL 6" LEGS

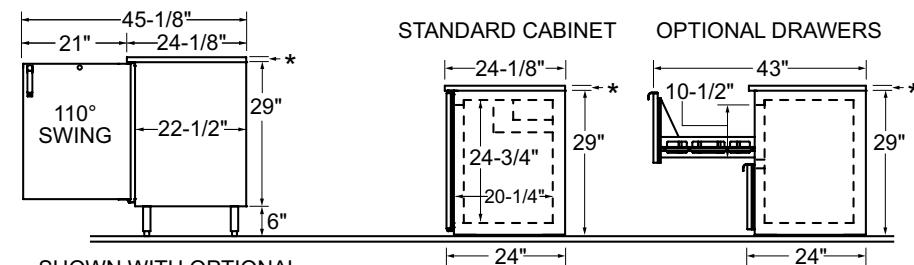

SHOWN WITH OPTIONAL
6" LEGS

OPTIONAL LEGS AND CASTERS

