



WLF60B

Worktop 60" Side Mount
Freezer with Two Doors



WLF60B
11/18/24
Item # 13730

W x D x H
60" x 33.25" x 40.25"*
Work Height 36"*
*with 6" casters



Dimensions / Capacity

Interior Storage Capacity (CF) (AHAM)

Overall Width x Depth (including 1" bumper)

Height (including 6" casters)

Door Opening Width x Height

Depth with Door Open at 90° (including 1" bumper)

Adjustable Shelves

Shelf Dimensions (W x D)

Crated Weight

Crated Length x Width x Height

Two-Section WLF60B

17.22 ft³

60" x 33.25"

40.25"

19.5" x 23"

54.75"

4

21.5" x 25.5"

344 lbs.

63.75" x 35.75" x 40"

Electrical / Refrigeration

Voltage

HACR Breaker

Electrical Connection (NEMA)

Voltage Range

Ambient Temp. Range

Control Setpoint Range

Recommended Setpoint

Amperage

Energy Consumption (kWh/day) @ASHRAE

Heat Rejection (BTU/Hr.) @NSF

Approx. Nominal Compres. BTU/HR (HP)

Refrigerant / Charge Amount (oz)

Two-Section WLF60B

115/60/1

15.0 Amps

5-15P ⚡

104-126

45° to 100°F

-10° to 10°F

2°F

5

4.50

786

2870 (1/2+HP)

R290 (2.8 oz)

Options

- ☐ 2" Casters (HS-5037, set of 4)
- ☐ 4" Casters (HS-5035, set of 4)
- ☐ Foot pedal kit (HS-5555, Lft hinge)
- ☐ Foot pedal kit (HS-5556, Rt hinge)
- ☐ Pan slide rack (HS-5514)
- ☐ Overshelves (HS-5639 single)
- ☐ Overshelves (HS-5640 double)
- ☐ Addtl. Epoxy Shelves (HS-5579, 1pk)
- ☐ Addtl. Stainless Shelves (HS-5580, 1pk)



Valid in United States, Canada, Puerto Rico and U.S. Territories. *Please visit hoshizakiamerica.com/support/warranty/ for more information.

If GFCI is required, a GFCI breaker MUST be used in lieu of GFCI receptacle

Hoshizaki reserves the right to change specifications without notice.

Item #: _____
Project: _____
Qty: _____
AIA#: _____

Features

- ▶ **Front breathing air flow design allows for 1" of rear wall clearance**
- ▶ **Stainless steel exterior front, sides, and top with stainless steel interior**
- ▶ **Engineered to maintain NSF-7 temperatures in 100°F ambient**
- Environmentally friendly R290 hydrocarbon refrigerant
- Cabinet and doors are insulated with 2" CFC free, foamed in place polyurethane
- Exclusive "stepped" door design to protect door gasket
- Spring assisted self-closing doors with stay open feature
- Extruded aluminum flush mount door handle
- Magnetic door gaskets are snap in and easily removable for cleaning
- Removable air filter for easy cleaning
- Hot gas condensate removal
- Mullion heaters for reduced condensation
- E-coated evaporator coil
- Digital temperature display
- Four epoxy coated shelves is standard
- Shelves hold a full sized sheet pan & 120 lbs. capacity
- Anodized aluminum shelf supports adjustable in 1/2" increments
- Standard with 6" casters (two with brakes)
- 10 ft. cord and plug



WLF60B

Worktop 60" Side Mount Freezer with Two Doors



WLF60B
11/18/24
Item # 13730

FRONT VIEW

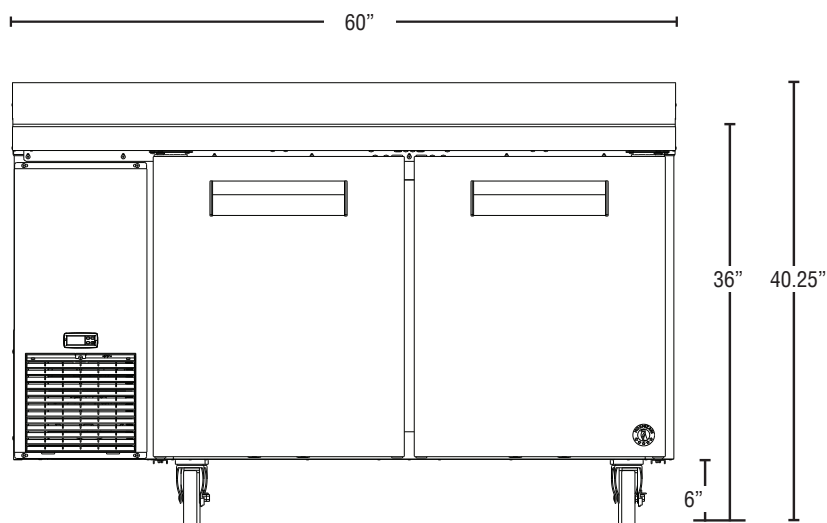

SIDE VIEW

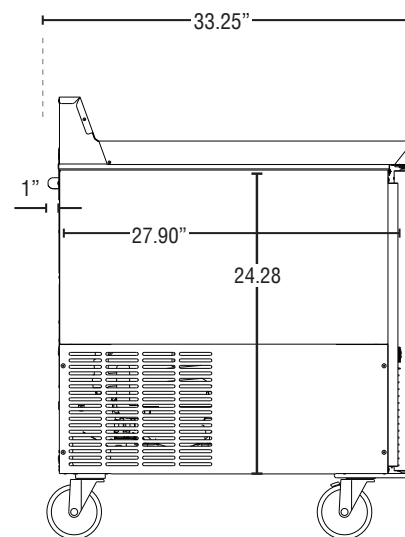

PLAN VIEW

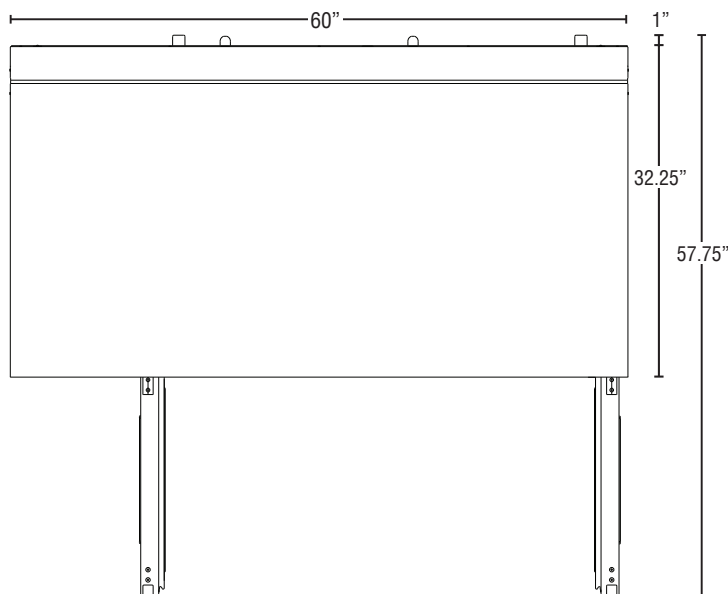

Cabinet Construction

The exterior cabinet top, front, and sides, are constructed of high quality stainless steel. The exterior back and bottom are constructed of coated steel. The cabinet interior features stainless steel back, sides, top and floor. Four heavy duty epoxy coated shelves is standard. Mounted on anodized aluminum pilasters the shelves are adjustable in 1/2" increments. Cabinet walls are insulated with 2" CFC free, foamed in place polyurethane. 6" polyolefin, stem casters (two with brakes) are standard.

Door Construction

Doors are constructed of high grade stainless steel exterior with an ABS interior liner and are insulated with 2" CFC free, foamed in place polyurethane. Hoshizaki's exclusive "stepped" design protects the gasket while product is removed from the cabinet. Doors are provided with a one piece, extruded aluminum, flush mount handle. Spring assisted self-closing doors are equipped with a stay open feature past 90 degrees. Snap-in magnetic door gaskets are durable and easily removed for cleaning. Field reversible door hinging is standard.

Refrigeration System

The high efficiency refrigeration system is self-contained with an E-coated evaporator for extended life. Condensate removal is accomplished with an energy efficient non-electric evaporation system. A capillary tube controls the flow of environmentally friendly R290 refrigerant through the evaporator. Unit uses a heated, time initiated defrost to eliminate any ice on the evaporator coil. 115 volt units are equipped with a ten foot cord and plug (20.0 amps or less).