

# "PB-WL" FLEXIBLE WATER LINE CONNECTORS

## 36" Long - Shallow Mount Faucets Only

**FEATURES:**

- (2) 36" Long Hoses Per Kit
  - (1) Red Hose For Hot
  - (1) Blue Hose For Cold
  - Includes 2 O-Rings
  - Faucet Side Connection 1/2-14 NPSM Thread
  - Supply Line Connection 3/8" Compression Thread
- Hoses Allows Flexibility: Easily Connect Water Lines To Shallow Mount Faucets So Underbar Equipment Can Be Slid Back Flush To Wall

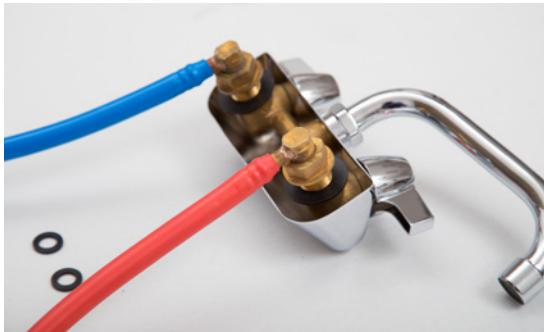
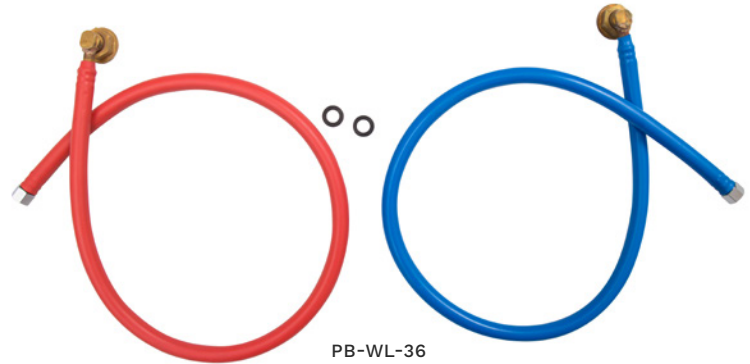

### "PB-WL" FLEXIBLE WATER LINE CONNECTORS

MODEL	SIZE (LXWXH)	DESCRIPTION	WEIGHT (LBS)
PB-WL-36	12"x12"x2"	2 Hoses Per Kit, (1) Red For Hot, (1) Blue For Cold	1

ALL DIMENSIONS ARE TYPICAL. TOLERANCE +/- .500". JOHN BOOS & CO. RESERVES THE RIGHT TO CHANGE SPECIFICATIONS WITHOUT NOTICE.

# DETAILED SPECIFICATIONS

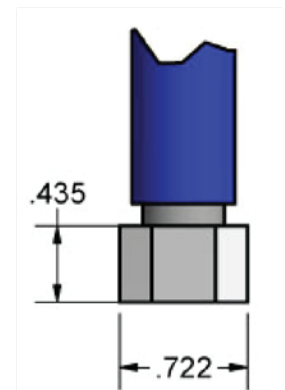
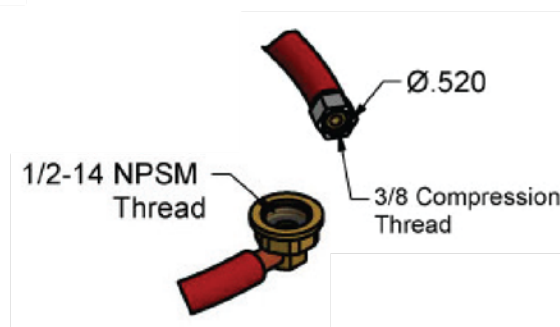
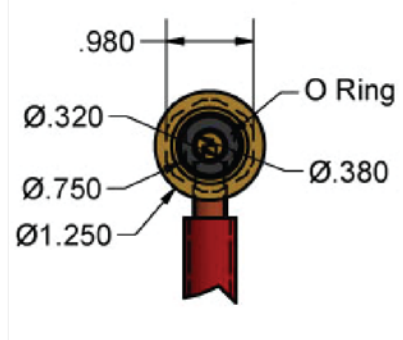
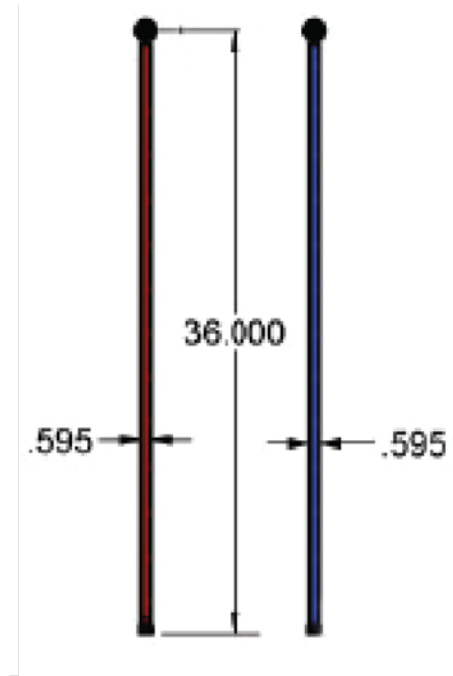

## "PB-WL" FLEXIBLE WATER LINE CONNECTORS

MODEL	SIZE (LXWXH)	DESCRIPTION	WEIGHT (LBS)
PB-WL-36	12"x12"x2"	2 Hoses Per Kit, (1) Red For Hot, (1) Blue For Cold	1

ALL DIMENSIONS ARE TYPICAL. TOLERANCE +/- .500". JOHN BOOS & CO. RESERVES THE RIGHT TO CHANGE SPECIFICATIONS WITHOUT NOTICE.