



Model: _____ Item #: _____ Date: _____

Project: _____ Qty: _____ Approved By: _____

Combination Ice Bin

Royal Series Underbar



KR19-M36L-10

Options & Accessories

| | |
|---------|---|
| KR-101 | Condiment Tray |
| KR-103 | 12" deep Stainless Steel Divider |
| KR-113 | 15" deep Stainless Steel Divider |
| KR-303 | Left and Right End Side Splashes |
| KR-310 | Right End Side Splash |
| KR-311 | Left End Side Splash |
| KR-401 | Cap Catcher and Opener |
| KR-406 | Faucet Installed Over Ice Bin |
| KR-421 | 2 Metal Wire Bottle Racks |
| KR-501 | Towel Ring |
| KR-502 | 15" Deep Liner on Ice Station |
| SC"XX"H | Partial Sliding Cover Ice Bin ("XX" denotes size of Ice Bin) |
| SC"XX"F | Full Sliding Cover for Ice Bin ("XX" denotes size of Ice Bin) |

Standard Features & Specifications

- 12" deep ice bin with 1" drain, 1/2" drain with cold plate
- Insulated bottle section with wire bottle racks (KR-421) and 1" drain
- Soda line access cutout in rear on cold plate units
- Optional 15" deep liner that holds 25% more ice (KR-502)
- Optional built-in speed rail
- 10 circuit cold plate available

Materials

- Interior: 20 gauge stainless steel. 12" deep ice bin section. 10" deep bottle section, wire racks included
- Front Apron: 20 gauge stainless steel clad over 20 gauge galvanized steel
- Sides: 20 gauge stainless steel
- Backsplash: 20 gauge stainless steel
- Back & Bottom: 20 gauge galvanized steel

Drains & Plumbing

- 1" NPS Drain, Elixir section
- 1" IPS Drain, Ice bin
- 1/2" IPS Drain, Ice bin with Cold Plate. 4" PVC tailpiece provided. PVC tailpiece required to avoid condensation through metal to metal contact.

Cold Plate

- Cast aluminum post mix plate with 10 circuits. Plate is sealed into bottom. Each circuit is 5/16" OD stainless steel tubing. Two full with remainder to be half circuits. Bump and swedge fittings on ends.

Tubing Access (Cold Plate)

- 3/4" x 3-1/2" cutout in left side of backsplash

Insulation

- Foamed-in-place polyurethane

Backsplash

- 6-1/2"H x 1-1/2"D

Legs

- 1-5/8" tubular legs w/ grey plastic bullet foot

Top View

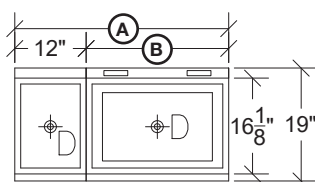

Front View

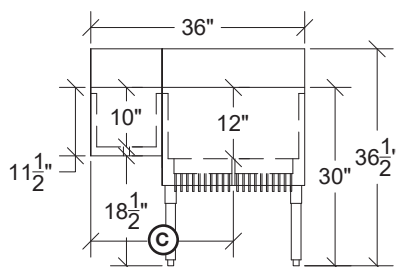

| Model | Overall Length (A) | Overall Depth (B) | Ice Bin Length | Ice Bin Location | Ice Bin Capacity (lbs.) | Left Side to Ice Bin Drain (C) | Bottles Stored | Cold Plate Circuits | Weight (lbs.) |
|--------------|--------------------|-------------------|----------------|------------------|-------------------------|--------------------------------|----------------|---------------------|---------------|
| KR19-M36R | 36" | 19" | 24" | Right | 74 | 24" | 6 | N/A | 95 |
| KR19-M36L | 36" | 19" | 24" | Left | 74 | 12" | 6 | N/A | 95 |
| KR19-M36R-10 | 36" | 19" | 24" | Right | 74 | 24" | 6 | 10 | 172 |
| KR19-M36L-10 | 36" | 19" | 24" | Left | 74 | 12" | 6 | 10 | 172 |
| KR19-M42R | 42" | 19" | 30" | Right | 92 | 27" | 6 | N/A | 108 |
| KR19-M42L | 42" | 19" | 30" | Left | 92 | 15" | 6 | N/A | 108 |
| KR19-M42R-10 | 42" | 19" | 30" | Right | 92 | 27" | 6 | 10 | 185 |
| KR19-M42L-10 | 42" | 19" | 30" | Left | 92 | 15" | 6 | 10 | 185 |
| KR19-M48C | 48" | 19" | 24" | Center | 74 | 24" | 12 | N/A | 116 |
| KR19-M48R | 48" | 19" | 36" | Right | 110 | 30" | 6 | N/A | 116 |
| KR19-M48L | 48" | 19" | 36" | Left | 110 | 18" | 6 | N/A | 116 |
| KR19-M48C-10 | 48" | 19" | 24" | Center | 74 | 24" | 12 | 10 | 193 |
| KR19-M48R-10 | 48" | 19" | 36" | Right | 110 | 30" | 6 | 10 | 193 |
| KR19-M48L-10 | 48" | 19" | 36" | Left | 110 | 18" | 6 | 10 | 193 |