



Model: \_\_\_\_\_ Item #: \_\_\_\_\_ Date: \_\_\_\_\_  
 Project: \_\_\_\_\_ Qty: \_\_\_\_\_ Approved By: \_\_\_\_\_

# Combination Ice Bin

# Royal Series Underbar



KR19-M36L-10

### Options & Accessories

|         |   |
|---------|---|
| KR-101  | Condiment Tray  |
| KR-103  | 12" deep Stainless Steel Divider                              |
| KR-113  | 15" deep Stainless Steel Divider                              |
| KR-303  | Left and Right End Side Splashes                              |
| KR-310  | Right End Side Splash   |
| KR-311  | Left End Side Splash  |
| KR-401  | Cap Catcher and Opener  |
| KR-406  | Faucet Installed Over Ice Bin                                 |
| KR-421  | 2 Metal Wire Bottle Racks                                     |
| KR-501  | Towel Ring  |
| KR-502  | 15" Deep Liner on Ice Station                                 |
| SC"XX"H | Partial Sliding Cover Ice Bin ("XX" denotes size of Ice Bin)  |
| SC"XX"F | Full Sliding Cover for Ice Bin ("XX" denotes size of Ice Bin) |

### Standard Features & Specifications

- 12" deep ice bin with 1" drain, 1/2" drain with cold plate
- Insulated bottle section with wire bottle racks (KR-421) and 1" drain
- Soda line access cutout in rear on cold plate units
- Optional 15" deep liner that holds 25% more ice (KR-502)
- Optional built-in speed rail
- 10 circuit cold plate available

### Materials

- Interior: 20 gauge stainless steel. 12" deep ice bin section. 10" deep bottle section, wire racks included
- Front Apron: 20 gauge stainless steel clad over 20 gauge galvanized steel
- Sides: 20 gauge stainless steel
- Backsplash: 20 gauge stainless steel
- Back & Bottom: 20 gauge galvanized steel

### Drains & Plumbing

- 1" NPS Drain, Elixir section
- 1" IPS Drain, Ice bin
- 1/2" IPS Drain, Ice bin with Cold Plate. 4" PVC tailpiece provided. PVC tailpiece required to avoid condensation through metal to metal contact.

### Cold Plate

- Cast aluminum post mix plate with 10 circuits. Plate is sealed into bottom. Each circuit is 5/16" OD stainless steel tubing. Two full with remainder to be half circuits. Bump and swedge fittings on ends.

### Tubing Access (Cold Plate)

- 3/4" x 3-1/2" cutout in left side of backsplash

### Insulation

- Foamed-in-place polyurethane

### Backsplash

- 6-1/2"H x 1-1/2"D

### Legs

- 1-5/8" tubular legs w/ grey plastic bullet foot

### Top View

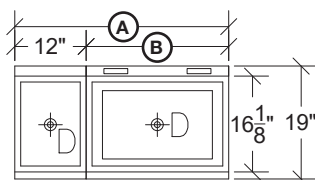

### Front View

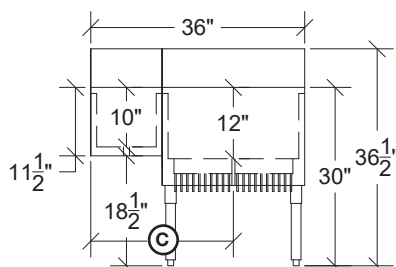

| Model        | Overall Length (A) | Overall Depth (B) | Ice Bin Length | Ice Bin Location | Ice Bin Capacity (lbs.) | Left Side to Ice Bin Drain (C) | Bottles Stored | Cold Plate Circuits | Weight (lbs.) |
|--------------|--------------------|-------------------|----------------|------------------|-------------------------|--------------------------------|----------------|---------------------|---------------|
| KR19-M36R    | 36"                | 19"               | 24"            | Right            | 74                      | 24"                            | 6              | N/A                 | 95            |
| KR19-M36L    | 36"                | 19"               | 24"            | Left             | 74                      | 12"                            | 6              | N/A                 | 95            |
| KR19-M36R-10 | 36"                | 19"               | 24"            | Right            | 74                      | 24"                            | 6              | 10                  | 172           |
| KR19-M36L-10 | 36"                | 19"               | 24"            | Left             | 74                      | 12"                            | 6              | 10                  | 172           |
| KR19-M42R    | 42"                | 19"               | 30"            | Right            | 92                      | 27"                            | 6              | N/A                 | 108           |
| KR19-M42L    | 42"                | 19"               | 30"            | Left             | 92                      | 15"                            | 6              | N/A                 | 108           |
| KR19-M42R-10 | 42"                | 19"               | 30"            | Right            | 92                      | 27"                            | 6              | 10                  | 185           |
| KR19-M42L-10 | 42"                | 19"               | 30"            | Left             | 92                      | 15"                            | 6              | 10                  | 185           |
| KR19-M48C    | 48"                | 19"               | 24"            | Center           | 74                      | 24"                            | 12             | N/A                 | 116           |
| KR19-M48R    | 48"                | 19"               | 36"            | Right            | 110                     | 30"                            | 6              | N/A                 | 116           |
| KR19-M48L    | 48"                | 19"               | 36"            | Left             | 110                     | 18"                            | 6              | N/A                 | 116           |
| KR19-M48C-10 | 48"                | 19"               | 24"            | Center           | 74                      | 24"                            | 12             | 10                  | 193           |
| KR19-M48R-10 | 48"                | 19"               | 36"            | Right            | 110                     | 30"                            | 6              | 10                  | 193           |
| KR19-M48L-10 | 48"                | 19"               | 36"            | Left             | 110                     | 18"                            | 6              | 10                  | 193           |