

**Refrigeration Equipment  
Bar Equipment 3-door Refrigerator,  
72", black with solid door (R290)**

ITEM # \_\_\_\_\_

MODEL # \_\_\_\_\_

NAME # \_\_\_\_\_

SIS # \_\_\_\_\_

AIA # \_\_\_\_\_

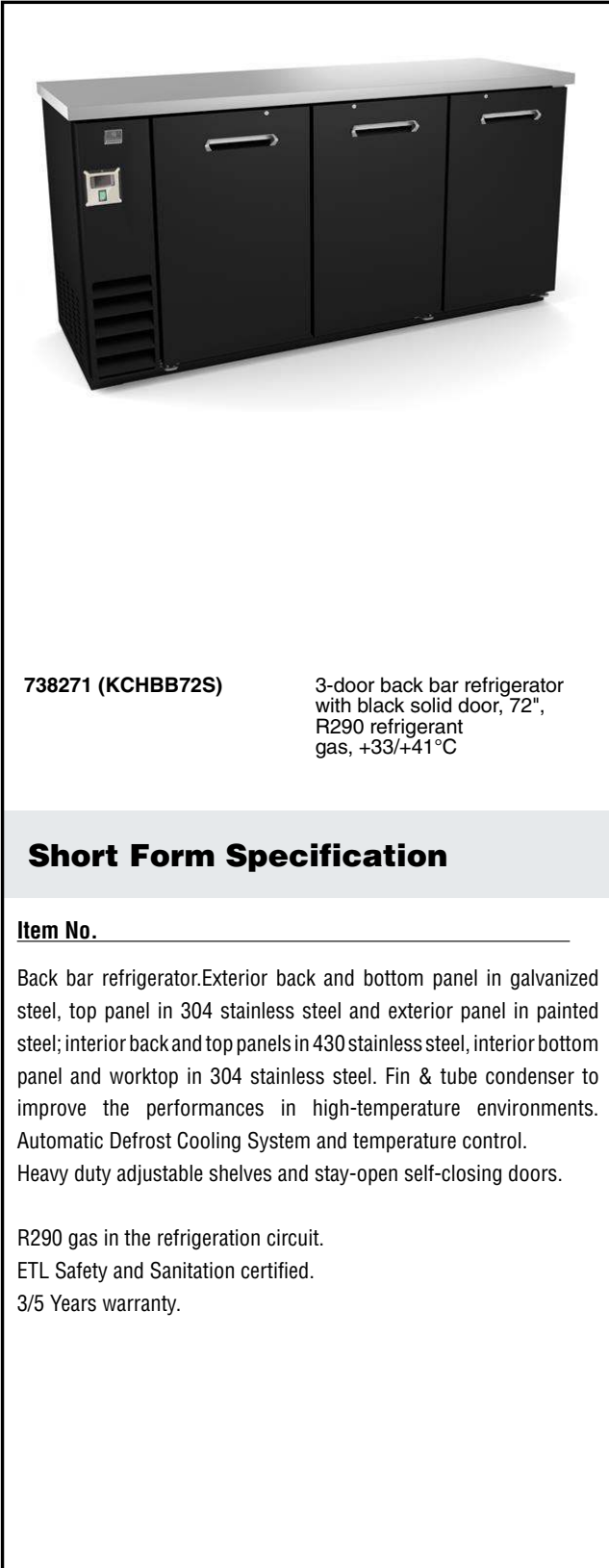

**738271 (KCHBB72S)**

3-door back bar refrigerator with black solid door, 72", R290 refrigerant gas, +33/+41 °C

**Short Form Specification**

**Item No.** \_\_\_\_\_

Back bar refrigerator. Exterior back and bottom panel in galvanized steel, top panel in 304 stainless steel and exterior panel in painted steel; interior back and top panels in 430 stainless steel, interior bottom panel and worktop in 304 stainless steel. Fin & tube condenser to improve the performances in high-temperature environments. Automatic Defrost Cooling System and temperature control. Heavy duty adjustable shelves and stay-open self-closing doors.

R290 gas in the refrigeration circuit.  
ETL Safety and Sanitation certified.  
3/5 Years warranty.

**Main Features**

- External digital temperature display.
- External temperature display.
- Hydrocarbon refrigerant gas R290 for the lowest environmental impact (GWP=3) - CFC and HCFC free.
- Fin & Tube Condenser improves performance in high temperature environments.
- Automatic Defrost Cooling System provides worry-free performance.
- Locking doors.
- Heavy duty Vinyl coated steel shelves.
- High efficiency components to minimize the energy consumption still guaranteeing the highest performances.
- Cabinet and door insulated with high density polyurethane for low environmental impact.
- CFC and HCFC free, highly ecological refrigerant type: R290 (ecological gas in foam: cyclopentane). Hydrocarbon refrigerant gas R290 for the lowest environmental impact (GWP=3), to reduce green house and ozone depletion effects.

**Construction**

- Lockable door.
- Self-closing door with 90-degree stay-open feature.
- Pre-wired heavy duty power cord.
- Heavy duty door hinges.
- Magnetic door gasket removable without tools for easy cleaning.

**Optional Accessories**

- two shelves for 72" back bar (one right and one left shelves)  PNC 880610
- shelf clips  PNC 880611

**APPROVAL:** \_\_\_\_\_

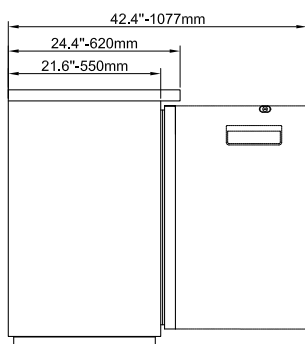
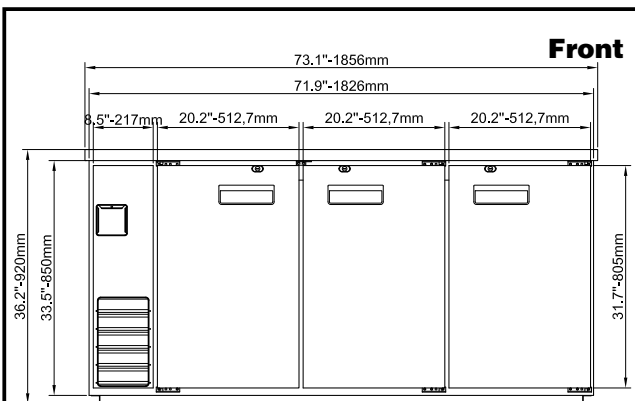

**EI** = Electrical connection  
**RI** = Refrigerant Inlet  
**RO** = Refrigerant Outlet

## Electric

<b>Supply voltage:</b>	<b>738271 (KCHBB72S)</b>	115 V/1 ph/60 Hz
<b>Electrical power, max:</b>		0.3 kW
<b>Current consumption:</b>		3 Amps
<b>Plug type:</b>		USA NEMA 5-15P

## Capacity:

<b>Gross capacity:</b>	20.8 cu.feet
------------------------	--------------

## Key Information:

<b>Door hinges:</b>	1 Left+2 Right
<b>External dimensions, Width:</b>	73 1/16" (1856 mm)
<b>External dimensions, Depth:</b>	24 7/16" (620 mm)
<b>External dimensions, Height:</b>	36 3/16" (919.48 mm)
<b>Number and type of doors:</b>	3 Full
<b>Internal Dimensions (depth):</b>	28 15/16"
<b>Internal Dimensions (height):</b>	18 1/2"
<b>Internal Dimensions (width):</b>	60 3/16"
<b>Shipping height:</b>	41 5/16" (1050 mm)
<b>Shipping weight:</b>	346 lbs (157 kg)
<b>Shipping volume:</b>	47.8 ft <sup>3</sup> (1.35 m <sup>3</sup> )
<b>Number and type of grids (included):</b>	6 - Vinyl-Coated Steel
<b>Type of external material:</b>	Black Prepainted Steel
<b>Type of internal material:</b>	Stainless Steel
<b>Warranty:</b>	3 / 5 years

## Refrigeration Data

<b>Compressor Horsepower:</b>	1/4
<b>Refrigerant type:</b>	R290
<b>Refrigerant weight:</b>	130 g
<b>Operating temperature min.:</b>	32 °F
<b>Operating temperature max.:</b>	41 °F
<b>Condenser type:</b>	Fin & tube



Refrigeration Equipment  
Bar Equipment 3-door Refrigerator, 72", black with solid door (R290)

The company reserves the right to make modifications to the products without prior notice. All information correct at time of printing.