

 <b>REFRIGERATOR MANUFACTURER</b> <b>Turbo air</b> more durable, efficient, beautiful	4184 E. Conant St. Long Beach, CA 90808 Tel. 310-900-1000 Fax. 310-900-1077 <a href="http://www.turboairinc.com">www.turboairinc.com</a>	Project:	
		Model #:	
		Item #:	
		Available W/H:	Qty:
		Approval:	
		AIA #:	SIS #:
		CSI Section 11400	

# Solid Door Heated Cabinet Reach-In M3 Series

**Model : M3H47-2**

## ≡ FEATURES & BENEFITS ≡

- **Digital temperature control & monitor system**

  - Keeps food products safe by maintaining constant temperatures
  - Alarm beeps when doors are not sealed
  - Digital display allows for easy monitoring
  
- **Ducted fan air distribution system**

Maintains temperature within the food zone
  
- **On/Off switch**

ON/OFF switch is located on control panel
  
- **Stainless steel cabinet construction**

The Turbo Air M3 heated cabinet model boasts a stainless steel exterior (galvanized steel top, bottom and back) and interior. It guarantees the utmost in cleanliness and long product life. Sharp corners and edges have been rounded to reduce the risk of injury. The M3 adds a touch of style to the most refined setting.
  
- **LED interior lighting**
  
- **High-density polyurethane insulation**

The entire cabinet structure and solid doors are foamed-in-place using high density, CFC free polyurethane insulation.
  
- **Adjustable, chrome-plated wire shelves**
  
- **Heated cabinet holds 140°F ~ 180°F for the best in food preservation**



Model	Swing Doors	CU./FT.	#of Shelves	Wattage (W)	AMPS	Crated Weight (lbs.)	L x D x H <sup>†</sup> (inches)
<b>M3H47-2</b>	<b>2</b>	<b>42.9</b>	<b>6</b>	<b>1550</b>	<b>13.5</b>	<b>345</b>	<b>51<sup>3</sup>/<sub>4</sub> x 30<sup>3</sup>/<sub>4</sub> x 78</b>

# Solid Door Heated Cabinet

Reach-In  
M3 Series

## Model : M3H47-2

ELECTRICAL DATA	
Voltage	115/60/1
Plug Type	 NEMA 5-15P
Wattage (W)	1550
Feed Wires with Ground	3
Cord Length (ft.)	8
DIMENSIONAL DATA	
# of Doors	2
# of Racks Accepted	2
Net Capacity (cu. ft.)	42.9
Ext. Length Overall (in.)	51 <sup>3</sup> / <sub>4</sub> (1314mm)
Ext. Depth Overall (in.)	30 <sup>3</sup> / <sub>4</sub> (780mm)
Ext. Height Overall (in.)†	78 (1981mm)
Int. Length Overall (in.)	45 <sup>1</sup> / <sub>4</sub> (1151mm)
Int. Depth Overall (in.)	25 <sup>1</sup> / <sub>8</sub> (639mm)
Int. Height Overall (in.)	58 <sup>3</sup> / <sub>4</sub> (1493mm)
# of Shelves	6
Shelf Size (L x D) (in.)	23 <sup>1</sup> / <sub>2</sub> x 21 <sup>5</sup> / <sub>8</sub>
Net Weight (lbs.)	282
Gross Weight (lbs.)	345

Design and specifications subject to change without notice.

Actual shipping weight may differ due to extra packing materials for product protection.

† Height does not include 5" for caster height.

### ■ WARRANTY : 5 Year Parts and Labor Warranty

### ■ STANDARD FEATURES

- Door locks
- 4" dia. swivel casters with locks on the front set
- Easy replaceable one piece magnetic door gaskets
- Solid and sturdy grille design

\*\* Lead time applies. Please contact your sales representative for more details to order.

### ■ OPTIONAL ACCESSORIES

- 5" caster, 1/2" diameter & 13 TPI:  
M726500100 (non-brake), M726500200 (w/ brake)
- 6" stainless steel leg: 30221M0600
- Half door bun tray rack: TSP-2224  
(each holds up to six 18"L x 26"D sheet pans)
- Full door bun tray rack: TSP-2250  
(each holds up to fifteen 18"L x 26"D sheet pans)
- 5 pairs of universal tray slides and pilasters for M3H47-2: TS2-UNM

## PLAN VIEW

(unit : inch)

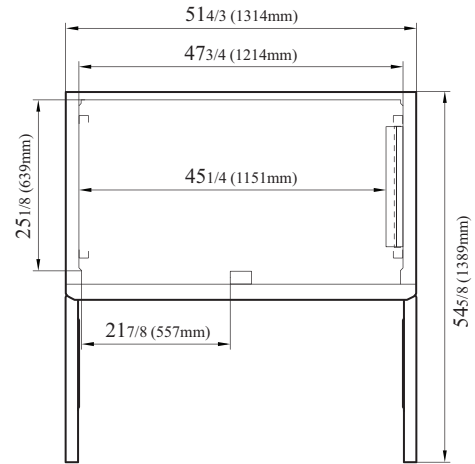

TOP VIEW

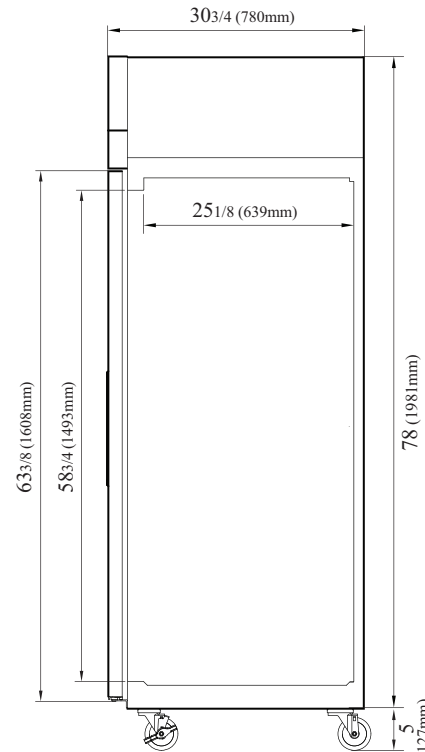

SIDE VIEW

Ver.20230106



- Turbo Air : 800-627-0032
- GK : 800-500-3519
- Warranty : 800-381-7770
- AC : 888-900-1002

REFRIGERATOR MANUFACTURER  
**Turbo air**

GERMAN  
KNIFE

IRADIANCE

REFRIGERATION SYSTEM  
**Turbo air**

**Texaking**

Continued product development may necessitate specification changes without notice.