



# "MS4-SSK" Heavy Duty Machine Stands

w/ 14 Gauge Stainless Steel Work Top  
w/ Stainless Steel Base



14 GAUGE TOP w/ STAINLESS  
STEEL BASE

24"WIDE	Qty	30"WIDE	Qty
MS4 2424SSK		MS4-3030SSK	
MS4-2430SSK		MS4-3036SSK	

### FEATURES:

- \* 14 Gauge Stainless Steel Top  
Type 300 stainless steel with # 4 polish, satin finish
- \* Reinforced with 1"x 2" channel running entire length of table
- \* Stainless Steel Legs and Shelve
- \* Shelve adjustable to desired height
- \* Adjustable bullet feet
- \* Shipped knocked-down, easy - to - assemble
- \* All models are approved by the National Sanitation Foundation and

### CONSTRUCTION:

Top: Stainless Steel Tops are TIG welded, Exposed welds are polished to match adjacent surface.

Base: Stainless Steel frame is MIG welded

### MATERIAL:

Top: 14 gauge Stainless Steel  
Type 300 stainless steel with # 4 polish, satin finish

Shelve: 18 gauge Stainless Steel

Gussets: Stainless Steel

Feet: 1" adjustable Stainless Steel bullet feet

## **John Boos & Co**

315 South First Street - Effingham, IL 62401  
Phone: 217-347-7701 - Fax: 217-347-7705  
Email: sales@johnboos.com - Web-site: www. johnboos.com

**DETAILED SPECIFICATIONS**

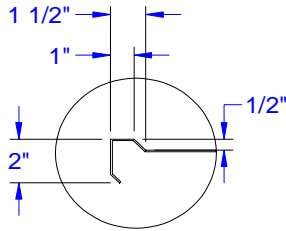
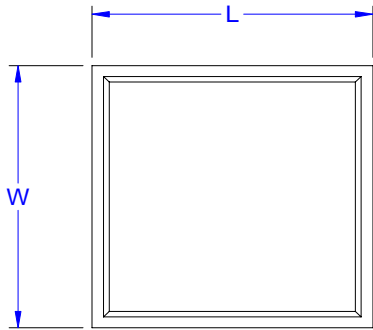

**MARINE EDGE  
DETAIL**

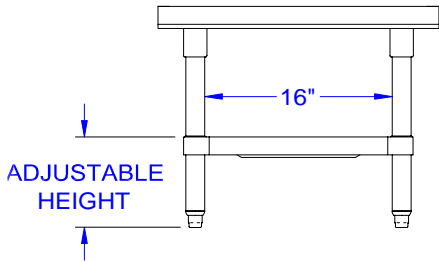

**ADJUSTABLE  
HEIGHT**

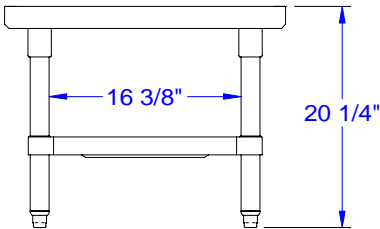

All units ship unassembled for reduced shipping cost.  
 All dimensions are typical.  
 Tolerance +/- .500".

**14 GAUGE TOP & BRACING**

L	24" WIDE	WT.	30" WIDE	WT.
24	MS4-2424SSK	34	MS4-3030SSK	43
30	MS4-2430SSK	38	MS4-3036SSK	52

**John Boos & Co**

315 South First - Effingham, IL 62401 Phone: 217-347-7701 - Fax: 217-347-7705  
 Email: sales@johnboos.com - Web-site: www.johnboos.com



November 2010

**John Boos** is constantly engaged in a program of improving products and therefore reserves the right to change specification without prior notice