

NOR-LAKE, INCORPORATED  
 727 Second Street  
 P.O. Box 248  
 Hudson, Wisconsin 54016

800-955-5253  
 715-386-2323  
 866-961-5253 Parts  
 800-388-5253 Service  
 715-386-6149 FAX  
 www.norlake.com



## ADVANTEDGE™ DIRECT DRAW BEER COOLERS



NLDD59

PROJECT:

ITEM NUMBER:

MODEL NUMBER:

DIRECT DRAW BEER COOLERS

### SPECIFICATIONS FOR: NLDD24, NLDD59, NLDD69, NLDD79, NLDD95

- **Finish:** Heavy duty stainless steel top, black vinyl coated front, sides and back. Galvanized steel interior walls with stainless steel floor.
- **Insulation:** Foamed-in-place 1-1/2" CFC-Free polyurethane insulation.
- **Hardware:** Solid doors with locks, magnetic door gaskets, plastic breaker strips around door openings to limit the formation of any condensation. Interior fluorescent light (except NLDD24). 3" diameter stainless steel draft towers. Heavy duty stainless steel threshold. Casters standard on NLDD24 model only.
- **Electrical:** 115 volt, 60 Hz, 1 phase with cord and NEMA 5-15P Plug.
- **Refrigeration:** Self-contained forced air R-134a capillary tube refrigeration system. Temperature range from 33°F to 38°F. Draft towers cooled by continuous cold air circulation. Channel air distribution system. Adjustable temperature control.
- **Approvals:** ETL Safety and Sanitation listed

### STANDARD FEATURES

- Adjustable temperature control
- Black vinyl steel front, sides and back
- Casters standard on NLDD24 model only
- Fluorescent interior light (except NLDD24)
- Free flowing refrigeration system at all times to ensure uniformly cooled product
- Heavy duty 18 gauge stainless steel top
- 3" diameter polished stainless steel draft tower
- 1 two-way gas manifold ( NLDD59 & NLDD69), 1 three-way gas manifold (NLDD79), 1 four-way gas manifold (NLDD95)
- Slide out condensing unit
- Temperature range: 33°F to 38°F
- ETL Safety and Sanitation listed
- Warranties: 1 year parts & labor, 5 year compressor

### OPTIONAL FEATURES

- Heavy Duty Mobility Kit (including 3" casters for support)
- Single, double and triple tap draft tower
- Floor rack



Nor-Lake, Inc.  
 Registered to ISO 9001:2008  
 File No. 10001816

SPECIFICATION  
**GUIDE**

TOP

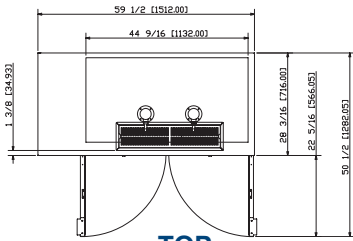

TOP  
NLDD59

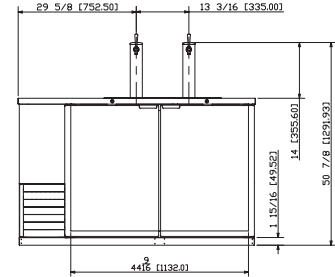

FRONT  
NLDD59

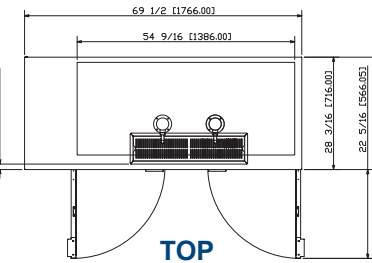

TOP  
NLDD69

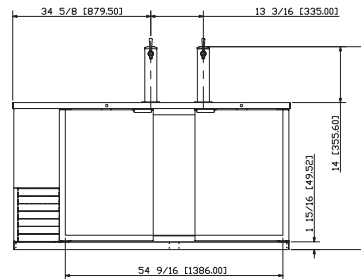

FRONT  
NLDD69

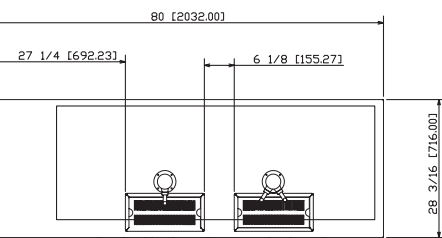

TOP  
NLDD79

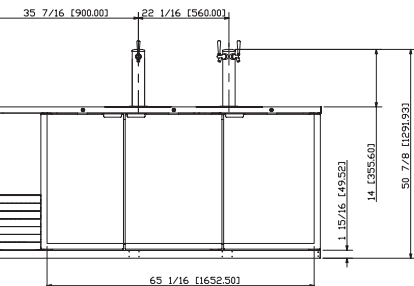

FRONT  
NLDD79

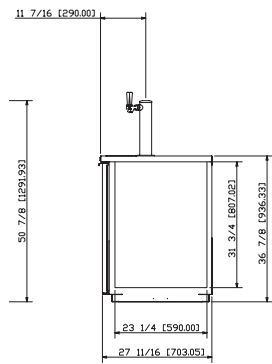

SIDE

NLDD59, 69, 79, 95

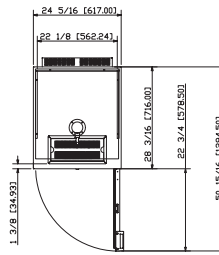

TOP  
NLDD24

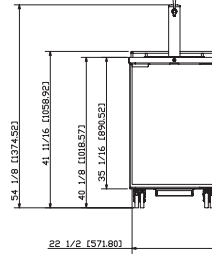

FRONT  
NLDD24

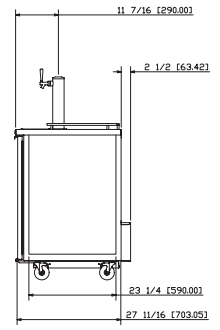

SIDE  
NLDD24

SPECIFICATIONS

Model	NLDD24	NLDD59	NLDD69	NLDD79	NLDD95
Crated Height	43"	43"	43"	43"	43"
Crated Width	32-1/4"	60-1/2"	70-1/2"	81"	96-1/2"
Crated Depth	26-1/4"	30"	30"	30"	30"
Crated Weight (lbs.)	181	310	356	375	418
Interior Height	31-13/16"	31-3/4"	31-3/4"	31-3/4"	31-3/4"
Interior Width	20-3/4"	44-9/16"	54-9/16"	65-1/16"	80-9/16"
Interior Depth	20-3/16"	24-3/4"	24-3/4"	24-3/4"	24-3/4"
Overall Height	38-1/8"	36-7/8"	36-7/8"	36-7/8"	36-7/8"
Overall Width	24-1/4"	59-1/2"	69-1/2"	80"	95-1/2"
Overall Depth	30-11/16"	28-3/16"	28-3/16"	28-3/16"	28-3/16"
Gross Cubage (ft. <sup>3</sup> )	8.4	23.7	28	30.8	39.2
Number of Towers	1 single	2 single	2 single	1 single 1 double	2 double
Number of Kegs	1	2**	3	4	5
Condensing Unit Size	1/6 HP	1/3 HP	1/3 HP	1/3 HP	1/3 HP
Refrigerant	R134a	R134a	R134a	R134a	R134a
Electrical Characteristics	115/60/1	115/60/1	115/60/1	115/60/1	115/60/1
Cord and Plug Furnished	Yes	Yes	Yes	Yes	Yes
Nema Plug Configuration	5-15P	5-15P	5-15P	5-15P	5-15P
Total Amp Draw	2.5	6.6	6.6	6.6	7.2

Specifications subject to change without notice.

\*\* The NLDD59 will hold (2) 1/2 barrel kegs and (1) slim quarter barrel.

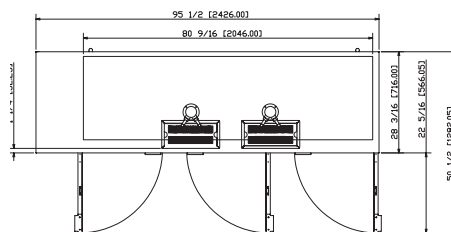

TOP  
NLDD95

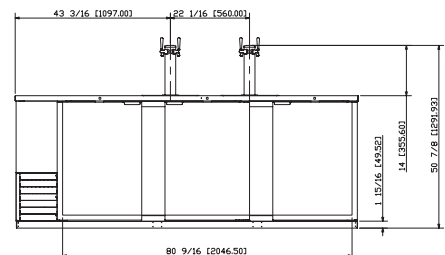

FRONT  
NLDD95



NORLAKE®

Revision Date: 06/12  
© 2012 NOR-LAKE, INC.  
Printed in the U.S.A.  
Part Number: 143585