

ADVANTEDGE™ HALF-DOOR REACH-IN FREEZERS



PROJECT:

 ITEM NUMBER:

 MODEL NUMBER:

SPECIFICATIONS FOR: NLF23-SH, NLF49-SH, NLF72-SH

- **Exterior finish:** Exterior front, sides and doors are stainless steel. Exterior top, bottom and back are galvanized steel.
- **Interior finish:** Interior liner and interior door panel are stainless steel.
- **Insulation:** Complete cabinet and door(s) are foamed-in-place with polyurethane foam insulation.
- **Hardware:** Heavy duty, pivot hinges; key locks; curved handle with recessed pocket; self-adjusting magnetic gaskets; 4" dia. casters (4 casters on one and two section models and 6 casters on three section model). 4 vinyl coated shelves per section.
- **Electrical:** All models are standard with complete perimeter, anti-condensate door frame heater wires. An interior light is activated by a switch for each upper door.
- **Instrumentation:** Microprocessor with digital display allows temperature adjustment at control panel. Reads °F or °C.
- **Refrigeration:** Complete bottom mounted refrigeration system with a copper tube, ceiling mount aluminum fin evaporator. The condensate is collected and automatically evaporated from an energy efficient air over wick style vaporizer. Refrigerant flow is controlled by a capillary tube. R-404a refrigerant. Operating temperature range: -5°F to 0°F.
- **Approvals:** UL, C-UL, ETL Sanitation and ENERGY STAR® listed **

STANDARD FEATURES

- Air-cooled condensing unit
- Anti-condensate heater wires on door openings
- Automatic condensate vaporizer
- Automatic defrost
- Casters
- Capillary tube system
- Curved handle with recessed pocket
- Door open alarm
- Interior light
- Key locks
- Magnetic gasket
- Microprocessor with digital display
- Operating temperature range: -5°F to 0°F
- Polyurethane insulation
- R-404a refrigerant
- Stainless steel interior and exterior
- Vinyl coated shelves
- UL, C-UL, ETL Sanitation & ENERGY STAR® listed **
- Warranties: 3 year parts and labor, 5 year compressor

OPTIONAL FEATURES*

- 6" adjustable legs
- Extra shelves
- Pan slide rack (part # 146515)

* Most options are available two weeks from receipt of order. Please contact us for specific questions.

** C-UL is Underwriters Laboratories Safety Certification Mark which indicates that UL has tested the equipment to applicable CSA Standards.

** ETL Sanitation is Intertek Labs Certification Mark which indicates that ETL has tested the equipment to applicable NSF Standards.

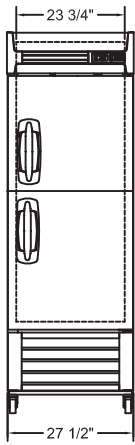

NLF23-SH
FRONT

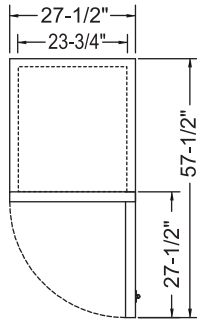

NLF23-SH
TOP

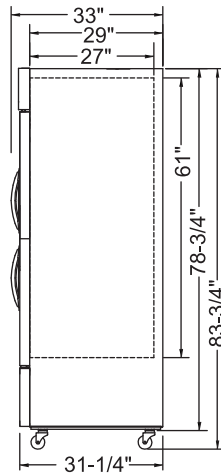

SIDE VIEW
ALL MODELS

SPECIFICATIONS

Models	NLF23-SH	NLF49-SH	NLF72-SH
Crated Weight (lbs) (kg)	313 (142)	491 (223)	664 (301)
Crated Height (in) (cm)	84-1/4 (214)	84-1/4 (214)	84-1/4 (214)
Crated Width (in) (cm)	29-1/8 (74)	56-3/4 (144)	78-3/8 (199)
Crated Depth (in) (cm)	33-1/2 (85)	33-1/2 (85)	33-1/2 (85)
Interior Height (in) (cm)	61 (155)	61 (155)	61 (155)
Interior Width (in) (cm)	23-3/4 (60)	51-1/2 (131)	74-1/4 (189)
Interior Depth (in) (cm)	27 (69)	27 (69)	27 (69)
Overall Height (in) (cm)	83-3/4 (213)	83-3/4 (213)	83-3/4 (213)
Overall Width (in) (cm)	27-1/2 (70)	55-1/4 (140)	78 (198)
Overall Depth (in) (cm)	33 (84)	33 (84)	33 (84)
Gross Cubage (CuFt) (L)	23.0 (651)	49.0 (1387)	72.0 (2038)
Number of Shelves	4	8	12
Shelf Area (SqFt) (Sqm)	18 (1.67)	39 (3.6)	56.5 (5.25)
Number of Doors	2	4	6
Number of Casters	4	4	6
Condensing Unit Size	3/5 HP	3/4 HP	1.1 HP
Refrigerant	R-404a	R-404a	R-404a
Electrical Characteristics	115/60/1	115/60/1	115/208-230/60/1
Cord & Plug Furnished	Yes	Yes	Yes
NEMA Plug Configuration	5-15P	5-15P	L14-20P
Total Amp Draw	8.5	9.5	9.0

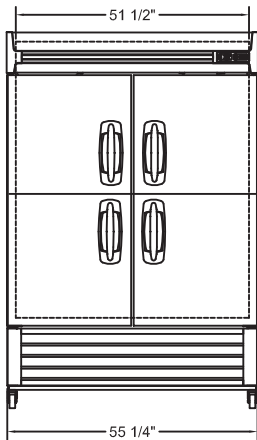

NLF49-SH
FRONT

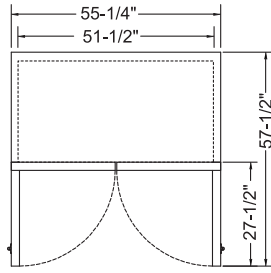

NLF49-SH
TOP

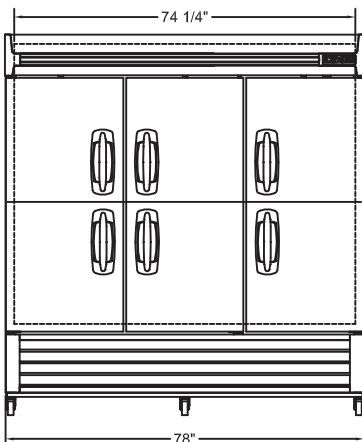

NLF72-SH
FRONT

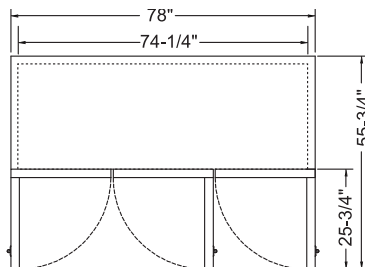

NLF72-SH
TOP

Specifications subject to change without notice.



Revision Date: 03/15
© 2015 NOR-LAKE, INC.
Printed in the U.S.A.
Part Number: 158006

