

# Commercial Gas range with oven

## SPEC SHEET

MODEL#: PRR-4B/6B



### Capacity

**PRR-4B**  
4 burners

**PRR-6B**  
6 burners

#### Standard Accessories

- Adjustable bullet legs
- Back riser with shelf
- Two oven racks

**MODEL # PRR-4B**

### Specifications

- Stainless steel front and sides
- Galvanized steel back
- Cast iron burners output 30,000 BTUs/hour
- Cast iron grates
- Italian SABAF thermostatic valve for oven
- Oven temp range: 200°F -550°F
- Manual ignition
- Easy-to-clean enamel oven interior
- Adjustable height legs
- ETL Safety and ETL Sanitation approved

#### Optional Accessories

- Casters

### PRODUCT DIMENSION CHART

Model: **PRR-4B/PRR-6B**

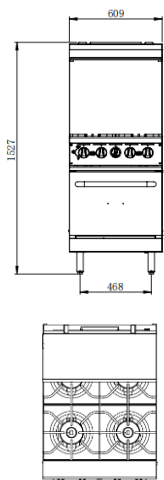

**PRR-4B**

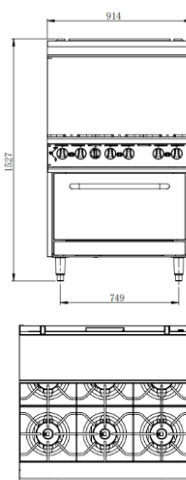

**PRR-6B**

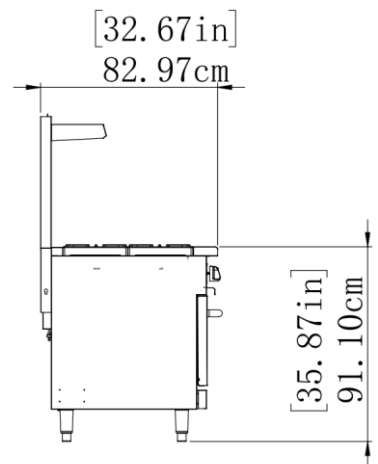

Model	Product Dimension	Heat Power	Heating Burner	Gas Consumption:	Gas inlet Connection	N.W	G.W	Packing dimension
PRR-4B	24x32.67x60.33inch 610x827x1532mm	Burner:30,000 BTUx4 Oven:30,000 BTUx1	Burner: 4 Oven: 1	LPG: 1.699m3/h NG: 3.946m3/h	3/4" NPT Male	129kg	161.5kg	720X1010X890mm
PRR-6B	36x32.67x60.33inch 915x827x1532mm	Burner:30,000 BTUx6 Oven:30,000 BTUx1	Burner: 6 Oven: 1	LPG: 2.3792m3/h NG:5.524m3/h	3/4" NPT Male	170kg	204kg	1010X1010X890mm