

Reach-in Refrigerators & Freezers

QV Series *New!*

- QVR-1-N • QVR-2-N • QVR-3-N
- QVR-1G-N • QVR-2G-N • QVR-3G-N
- QVF-1-N • QVF-2-N • QVF-3-N



Item # _____

Standard Features

- Our new “Next Generation” QV series Reach-in’s are built to the highest standards and redesigned to ensure proper temperature even in **100 deg. environments**.
- Heavy duty stainless steel door with full length recessed door handles; interior step design for added insulation and protection of door gasket to protect your long term investment. Single door units are **field reversible** for your ever changing needs.
- Air distribution channel on both single and double door freezers for proper temperature thru out the cabinet.
- Refrigerators maintain product temperatures from 33° to 38°F / freezers: -8°F, includes automatic defrost for the best temperatures in food preparation.
- Both Refrigerators and Freezers **accepts 18” x 26” sheet pans**.
- Enhanced digital controller with Energy Savings feature refrigerators and freezers to keep food quality for longer period of time. **Door alarm** to prevent food from spoiling.
- **2-3/8” Ecomate** CFC-free polyurethane insulation foamed in place for extra strength and energy efficiency. Environmentally friendly with zero ozone depletion (ODP) and zero global warming potential (GWP).
- Glass doors units are dual panel with aluminum frames and LED lighting for greater visibility of your products.



QVR(F)-1-N



QVR-2G-N



QVR(F)-3-N



Options & Accessories

- 6” adjustable legs (set of 4)
- Epoxy coated shelves
- Bun tray racks
- 220 volts / 50 cycles / 1 phase



Conforms to UL & NSF-7 standards

Model	Door	Capacity (Cu.Ft)	Shelves	Amps	HP	Voltage	Nema Plug	Cord Length	Cabinet Dimensions			Shipping	
									W	D	* H	(Wt.)	(Cubes)
Refrigerators													
QVR-1-N	1	24.5	3	5.6	1/4	115	5-15P	8'	27-1/2"	32"	79-3/8"	301	51
QVR-2-N	2	52	6	6.9	1/3	115	5-15P	8'	55-1/2"	32"	79-3/8"	474	95
QVR-3-N	3	76	9	11.5	3/4	115	5-15P	8'	83-1/4"	32"	79-3/8"	665	155
Refrigerators with glass door													
QVR-1G-N	1	24.5	3	6.0	1/4	115	5-15P	8'	27-1/2"	33"	79-3/8"	316	51
QVR-2G-N	2	52	6	7.3	1/3	115	5-15P	8'	55-1/2"	33"	79-3/8"	515	95
QVR-3G-N	3	76	9	12	3/4	115	5-15P	8'	83-1/4"	33"	79-3/8"	705	155
Freezers													
QVF-1-N	1	24.5	3	8.5	3/4	115	5-15P	8'	27-1/2"	32"	79-3/8"	327	51
QVF-2-N	2	52	6	12.9	1	115	5-15P	8'	55-1/2"	32"	79-3/8"	501	95
QVF-3-N	3	76	9	8.5	1 1/2	115-220	L14-20	8'	83-1/4"	32"	79-3/8"	685	155

* Height does not include 4” castors (5” overall) or 6” for legs.
 **All specifications are subject to change without notice

Specifications QV Series

Construction

Heavy duty stainless steel exterior front and sides. Aluminum top and galvanized back panel. Interior completely constructed of heavy duty stainless steel with coved cornered floor. Door is heavy duty stainless steel exterior and stainless steel interior, step design with stainless steel hinged solid doors and positive seal. Provided with locks per section, magnetic door gaskets, removable without tools, self-closing and with 90° stay open feature. Recessed full length door handle. Door openings have a plastic breaker strips to retard condensate formation. Single door units are field reversible. Glass door units have a dual pane glass, thermal insulated with heavy duty aluminum frame and door handle. Unit comes complete with a 2-3/8" Ecomate CFC-Free polyurethane insulation, foamed in place. Air distribution channel on both single and

double door freezers. Interior incandescent light with safety shield per section outside the food zone and activated by door rocker switch. Glass doors units have full height LED lighting along the side.

Refrigeration System

Self-contained capillary tube system using environmentally friendly (CFC Free) refrigerant. (R-134a refrigerator / R-404a 3 doors refrigerator & freezers) Bottom mount condensing unit on a rail system for easy access. Evaporator coil is mounted to interior top panel encased in stainless steel. Large fan motor and fan blades for better air flow.

Refrigerators are designed to maintain temperatures between 33° F to 38°F and freezers -8°F to 0°F during normal operations.

Energy savings digital controllers and thermostats. Automatic defrost, time initiated.

Shelving

(3) Epoxy coated wire shelves with clips per door. Adjustable in 1/2" increments. Aluminum pilasters with stainless steel clips.

Others

Unit is supplied standard with a 8' cord and plug (Nema 5-15p). Standard 4" diameter casters, front 2 with brakes.

Warranty

3 year parts and labor warranty plus 2 additional year compressor warranty. (Continental U.S.A. & Canada only).

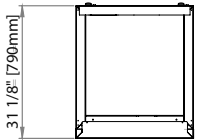

QVR(F)-1-N
Top View

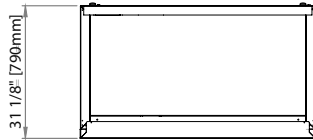

QVR(F)-2-N
Top View

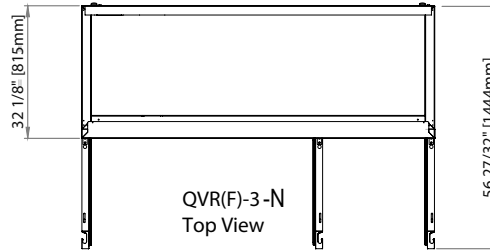

QVR(F)-3-N
Top View

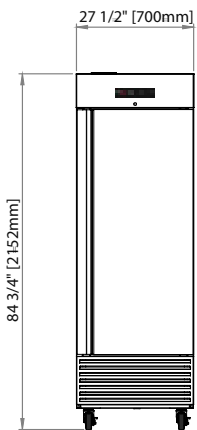

QVR(F)-1-N
Front View

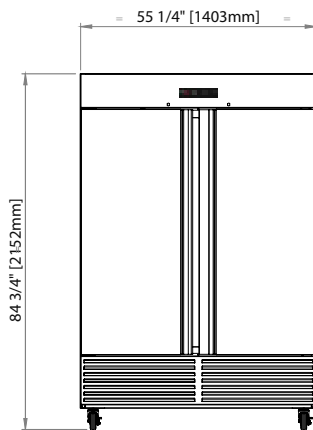

QVR(F)-2-N
Front View

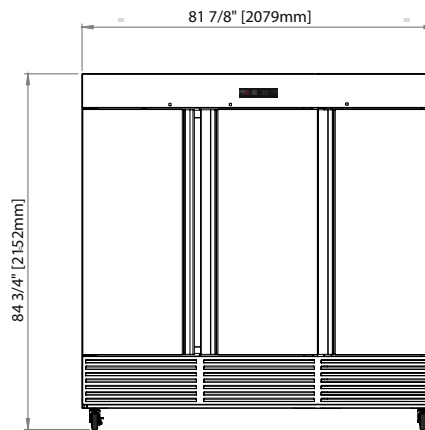

QVR(F)-3-N
Front View

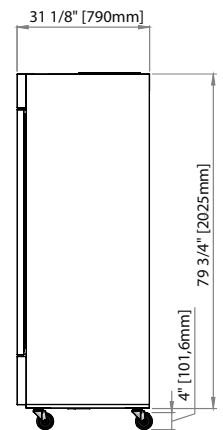

QVR(F)-N
Common View

The manufacturer reserves the rights to modify materials and specifications without notice.

