



Refrigeration Equipment Manufacturer

Sandwich Prep Unit

S1BRR-06S

Description: One solid door sandwich prep unit, 6 cu. ft

Features & Benefits

Stainless steel interior and exterior for greater durability, construction and appearance.

Self-contained **rear-mounted** refrigeration with high humidity coated **fin coil** evaporator.

- Holds 30° F to 42° F for refrigerator

2.5" thick, foamed-in-place polyurethane high density insulation.

Six poly-carbonate, 1/6 size pans. Two poly-carbonate, 1/9 size pans.

5" casters standard. **Easy mobility and installation.**

Twelve inch full length removable cutting board.

16 gauge, 300 series stainless steel top.

Heavy-duty overall construction for high-volume, constant duty operation.

Self-closing doors with 90 degree hold open feature and **fully-recessed handles.**

Electric condensate evaporator - **no floor drain required!**

| Dimensions | W | D | H |
|-----------------------|------|------|------|
| Exterior (inches) | 27.5 | 29.5 | 37.5 |
| (height with casters) | | | 42.5 |
| Pallet size (inches) | 29.5 | 31.5 | 4.5 |

| General Information | Cubic Feet Shelves | Pans |
|----------------------|--------------------|------|
| Refrigerator | 6 | 1 |
| Shelf size: | 22" x 19" | 8 |
| Exterior: | Stainless | |
| Interior: | Stainless | |
| Unit Weight (lbs.) | 160 | |
| Gross weight (lbs.) | 203 | |
| Cord length (inches) | 79 | |
| Nema | 5-20p | |

| Compressor Information | # compressors | Refrigerant Capacity |
|------------------------|---------------|----------------------|
| Refrigerant R134A | 1 | Medium/ Low Temp |

| Use | H.P | Volts | Amps |
|--------------|-----|-------|----------------------------|
| Refrigerator | 1/5 | 115 | 4.59 (run) 6.89 (start) |

SPECIFICATIONS SUBJECT TO CHANGE WITHOUT NOTICE

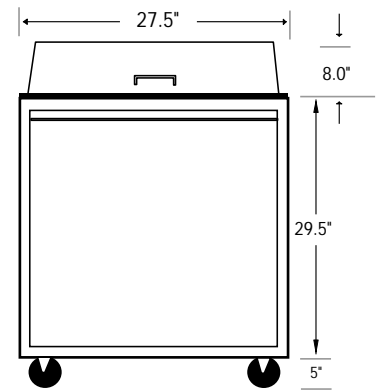
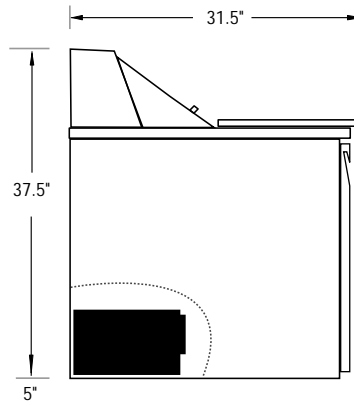
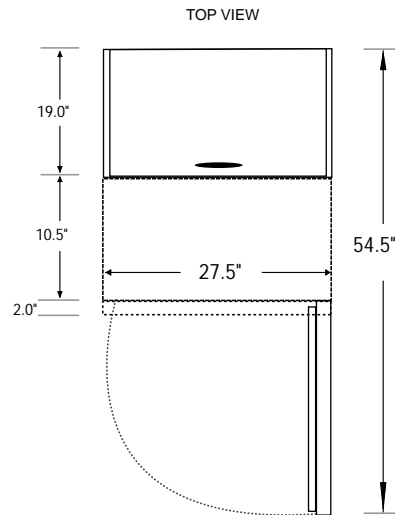

SIDE VIEW

FRONT VIEW