



ALUMINUM  
**STEAM TABLE PAN RACK**



**Item #:** \_\_\_\_\_

**Model #:** \_\_\_\_\_

**Project#:** \_\_\_\_\_



MODEL #	Qty
STR20-3W	

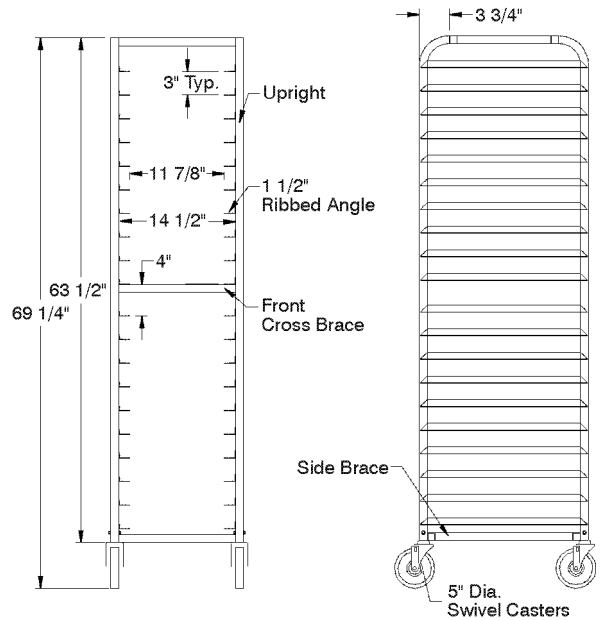
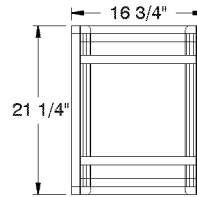

**FEATURES:**

- Curved top design.
- Heavy duty welded construction with 6 cross supports.
- Heavy duty 5" stem bolted swivel casters.
- Holds 23" x 23" and 24" x 24" donut screens.
- 1 1/2" Ribbed Angles.

**CONSTRUCTION:**

Fully welded 1" square tubing ladder assembly.

**MATERIAL:**

6063-T52 extruded aluminum angles, upright tubing, and support pieces.

MODEL #	Pan Capacity	Shelf Spacing	Overall Size L x W x H	Weight
STR20-3W	20	3"	16 3/4" x 21 1/4" x 69 1/4"	25 lbs.



**NEW YORK**  
(800) 645-3166  
Fax: (631) 242-6900

**GEORGIA**  
(800) 832-1218  
Fax: (770) 775-5625

**TEXAS**  
(800) 527-0353  
Fax: (972) 932-4795

**NEVADA**  
(800) 446-8684  
Fax: (775) 972-1578

200 Heartland Boulevard, Edgewood, NY 11717-8380  
e-mail: [advancetabco@advancetabco.com](mailto:advancetabco@advancetabco.com) [www.advancetabco.com](http://www.advancetabco.com)

A City Discount