

• B427WN 44-3/4"L x 24-3/8"D x 84-3/4"H

Included

- Breeze self-contained refrigeration
- (3) Levels solid, adjustable shelving
- Casters w/ levelers
- E-Coated evaporator coil
- Hydrocarbon refrigerant (R290)
- LED top light
- Price tag molding for deck and shelving



B427WN

Specify	Standard Features	Additional Options
EXTERIOR COLOR	• Powder coated Silversan Black	• Powder coated (stock/non-stock colors)
INTERIOR COLOR	• Powder coated Silversan Black	
LOWER FRONT PANEL COLOR	• Powder coated Silversan Black	• Powder coated (stock/non-stock colors)
BASE SUPPORT	• Casters w/ levelers	
END PANELS	• Full end panels	
PRICE TAG MOLDING	• 1" Price tag molding (black)	
SHELVING	• Metal shelves, non-lighted	
ELECTRICAL CONNECTION	• 6' Straight blade power cord	
REFRIGERATION	• Breeze self-contained refrigeration	

Intended Environment: Type I - Designed to operate in ambient conditions of 75°F with 55% relative humidity unless noted otherwise in system information below.		
Zone	Intended Product To Be Displayed	Warmest Avg Prod Temp ° F
1	Packaged refrigerated products	55

PLAN VIEW

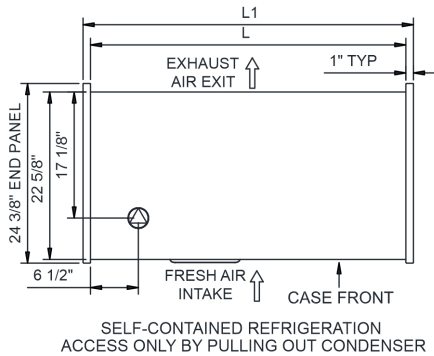

SIDE VIEW

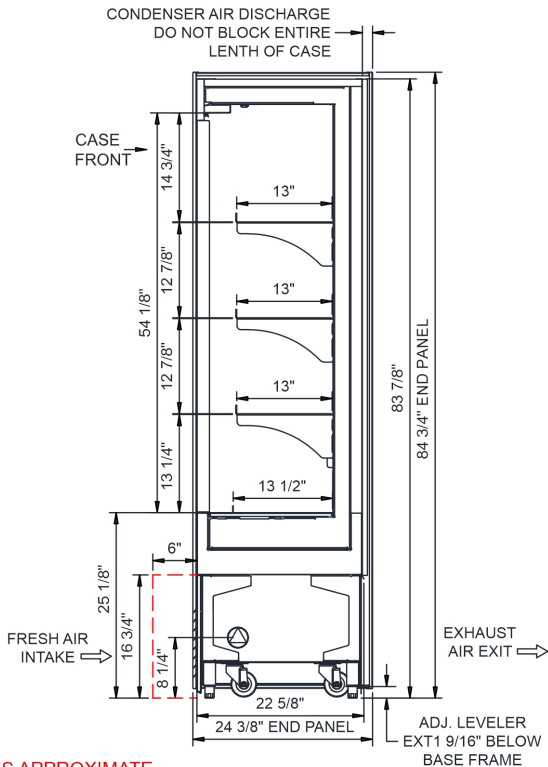

NOTE: ALL DIMENSIONS APPROXIMATE

-  ELECTRICAL JUNCTION BOX (SUPPLIED WITH 6" LEADS OR POWER CORD).
-  REFRIGERATION LINE CONNECTION.
-  SELF-CONTAINED CASE SERVICE ACCESS AREA.
-  LOCATION OF DRAIN TUBE FOR REMOTE REF. ONLY (SUPPLIED WITH 3/4" OR 1 1/2" PVC TUBE).
-  REMOTE FLOOR SINK & UTILITIES ACCESS AREA.
-  DRY CASE SERVICE ACCESS AREA.

Model Technical Specifications																
Model	L"	L1"	L2"	System Circuit Volts			Phs	Freq	Amps ***	Watts	Wires	NEMA Plug	SST	Conv. Rack BTUH	Para. Rack BTUH	Est Wt
B427WN	42.75	44.75	3.75	Self-Contained (R290)		Circuit #1	110-120	1	60	10.73	977	N/A	5-15P or L5-15P	N/A	N/A	N/A

*** Does not include electric defrost on freezer models.

Regulatory Approvals:	
All Models	ETL Listed to UL 471 ETL Listed to CAN/CSA 22.2 No. 120 ETL Sanitation to NSF/ANSI 7



Important Notes:

- 1) Units are supplied with levelers which must be adjusted during installation to ensure the unit is level and plumb.
- ⚠ WARNING:** This product can expose you to chemicals, including Urethane (Ethyl Carbamate), which are known to the State of California to cause cancer and birth defects or other reproductive harm. For more information go to www.P65Warnings.ca.gov.