

Oasis

Combination Ambient/Refrigerated Service Above Refrigerated Self-Service Case

Structural Concepts®

DELIVERING FRESH. ALWAYS.™

- **C3Z3667** 36"L x 41-7/8"D x 67-5/8"H
- **C3Z4867** 48"L x 41-7/8"D x 67-5/8"H

Included

- Breeze self-contained refrigeration
- Compressor air intake from rear and out front panel at toe kick. Front panel cannot be blocked.
- Full end panel w/mirror interior
- LED 3500K top & shelf lights
- Middle service area w/baffle
- Non-refrigerated upper display
- One year parts & labor; 5 year compressor warranty
- Rear wrapping board
- Self-service refrigerated lower display w/17" solid shelf
- Warmest average product temperature of 40°F or less



C3Z3667

| Specify | Standard Features | Additional Options |
|------------------------------|---------------------------------------------|------------------------------------------------------------------------------------------------------------------------|
| EXTERIOR COLOR | • Laminate (stock colors) | • Laminate (non-stock colors) • Stainless steel |
| INTERIOR COLOR | • Powder coated Silversan Black | • Stainless steel |
| BASE SUPPORT | • Levelers | • 6"H legs • Casters |
| REAR DOORS | • Clear glass rear sliding doors w/o lock | • Reflective glass rear sliding doors w/o lock |
| ELECTRICAL CONNECTION | • 6' Straight blade power cord (self-cont.) | • 6' Locking power cord (self-cont.) |
| MISCELLANEOUS | | • Rear door lock (for both sets of doors) • Second year parts & labor warranty (excludes compressor) |
| ACCESSORIES | | • Display steps (n/a w/shelf) • Night curtain, retractable, non-locking • Removable wire security cover, locking |

Intended Environment: Type I - Designed to operate in ambient conditions of 75°F with 55% relative humidity unless noted otherwise in system information below.

| Zone | Intended Product To Be Displayed | Warmest Avg Prod Temp ° F |
|------|---------------------------------------------|---------------------------|
| 1 | Packaged / unpackaged refrigerated products | 40 |

PLAN VIEW

SIDE VIEW

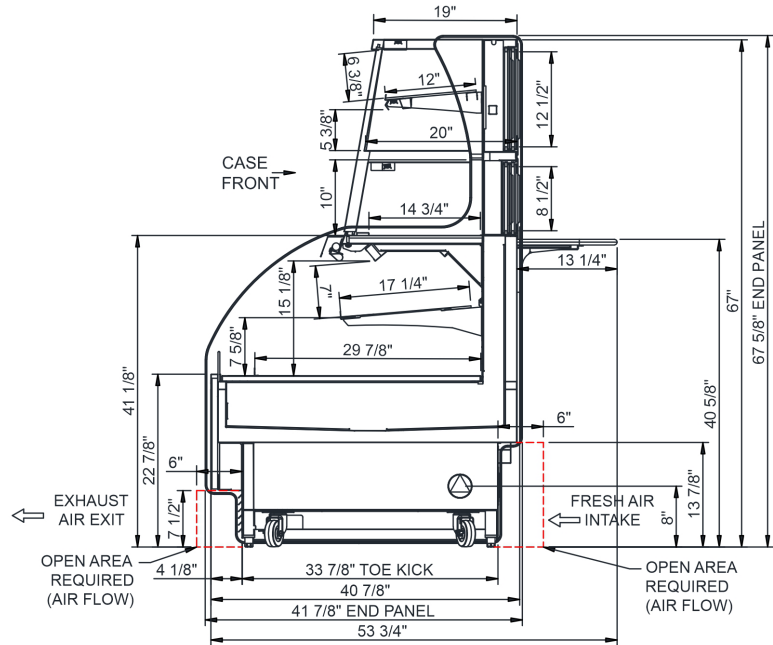
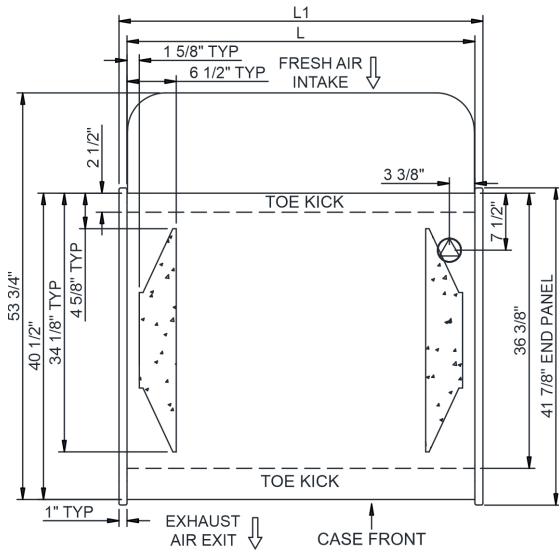

NOTE: ALL DIMENSIONS APPROXIMATE

⊕ ELECTRICAL JUNCTION BOX
(SUPPLIED WITH 6\"

⊕ REFRIGERATION LINE CONNECTION.
⊕ REMOTE FLOOR SINK & UTILITIES
ACCESS AREA.

⊕ SELF-CONTAINED CASE SERVICE ACCESS AREA.
⊕ DRY CASE SERVICE ACCESS AREA.

| Model Technical Specifications | | | | | | | | | | | | | | | | |
|--------------------------------|-------|-------|-------|-----------------------|------------|---------|-----|------|-------------|-------|-------|-----------------|-----|------------------------|------------------------|-----------|
| Model | L" | L1" | L2" | System Circuit Volts | | | Phs | Freq | Amps *** | Watts | Wires | NEMA Plug | SST | Conv. Rack BTU/H | Para. Rack BTU/H | Est Wt |
| C3Z3667 | 34.00 | 36.00 | 7.00 | Self-Contained (R290) | Circuit #1 | 110-120 | 1 | 60 | 14.75 | 1,502 | 2+G | 5-20P or L5-20P | N/A | N/A | N/A | 900 |
| C3Z4867 | 46.00 | 48.00 | 13.00 | Self-Contained (R290) | Circuit #1 | 110-120 | 1 | 60 | 15.24 | 1,536 | 2+G | 5-20P or L5-20P | N/A | N/A | N/A | 1,000 |

*** Does not include electric defrost on freezer models.

Regulatory Approvals:

All Models
 Accordance with AHRI Std 1200
 ETL Listed to UL 471
 ETL Listed to CAN/CSA 22.2 No. 120
 ETL Sanitation to NSF/ANSI 7



In Accordance with
AHRI Std 1200

DOE 2017
Energy Efficiency
Compliant

Important Notes:

- 1) ELECTRICAL NOTE: If GFCI is required, a GFCI breaker MUST be used in lieu of a GFCI receptacle
- 2) 43" minimum door entry clearance required (without shipping skid).
- 3) Units are supplied with levelers. They must be adjusted during installation to ensure the unit is level and plumb. Dimensions reflect levelers extended 1 1/4". 4) Compressor air ventilation is out the front panel. Front panel cannot be blocked.

⚠ WARNING: This product can expose you to chemicals, including Urethane (Ethyl Carbamate), which are known to the State of California to cause cancer and birth defects or other reproductive harm. For more information go to www.P65Warnings.ca.gov.