

- **CB5282** 52"L x 43-5/8"D x 82-3/4"H
- **CB7282** 72"L x 43-5/8"D x 82-3/4"H

Included

- CB5082 Supplied w/ (9) 16" x 12" x 4" & (3) 12" DIA x 20" wicker baskets
- CB7282 Supplied w/ (12) 16" X 12" X 4" & (4) 12" DIA X 20" wicker baskets
- Electrical leads
- LED 3500K w/ frosted lens
- Levelers
- One year parts & labor warranty
- Shelving removable and adjustable on 1" centers



Specify	Standard Features	Additional Options
EXTERIOR COLOR	• Laminate (stock colors)	• Laminate (non-stock colors)
INTERIOR COLOR	• Black	
BASE	• Straight base	
BUMPER FRONT	• 1" Boston bumper (specify color)	
END PANELS	• Cutaway end panel	
SHELVING	• (3) Lighted solid shelves	
MISCELLANEOUS		• Second year parts & labor warranty
ACCESSORIES		• Price tag molding (matches interior color)

Intended Environment: Type I - Designed to operate in ambient conditions of 75°F with 55% relative humidity unless noted otherwise in system information below.

Zone	Intended Product To Be Displayed	Warmest Avg Prod Temp ° F
1	Packaged non-refrigerated products	Ambient

PLAN VIEW

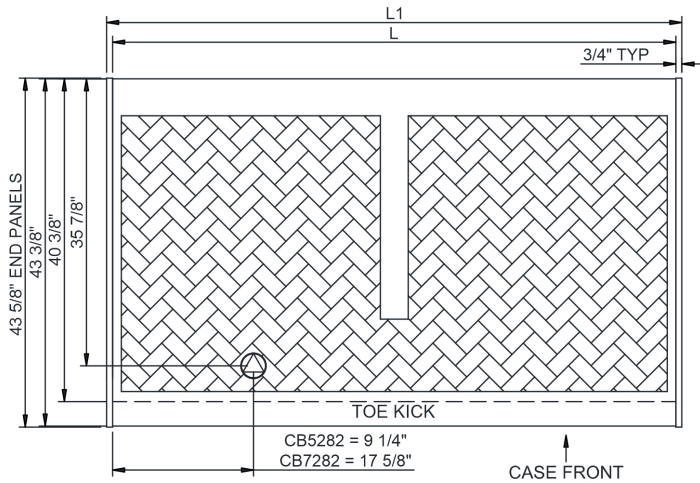

SIDE VIEW

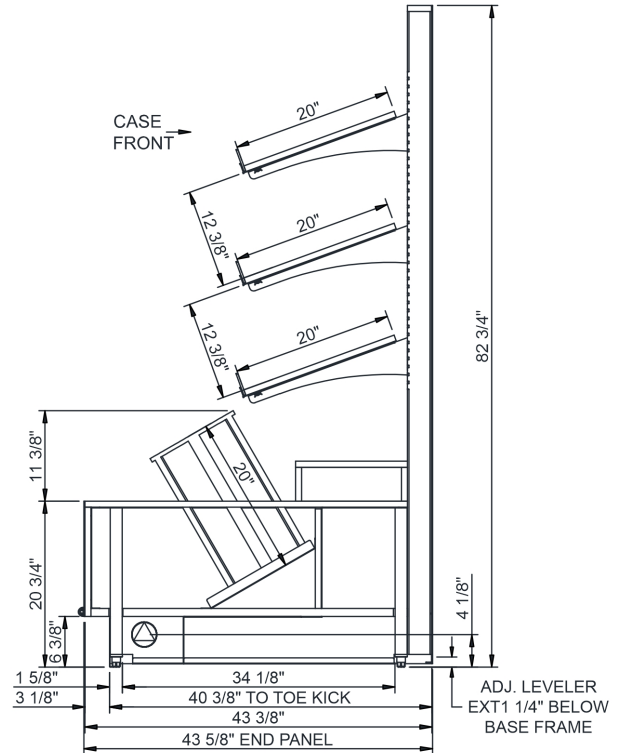

NOTE: ALL DIMENSIONS APPROXIMATE

ELECTRICAL JUNCTION BOX
(SUPPLIED WITH 6" LEADS OR POWER CORD).

LOCATION OF DRAIN TUBE FOR REMOTE REF.
ONLY (SUPPLIED WITH 3/4" OR 1 1/2" PVC TUBE).

REFRIGERATION LINE CONNECTION.

REMOTE FLOOR SINK & UTILITIES ACCESS AREA.

SELF-CONTAINED CASE SERVICE ACCESS AREA.

DRY CASE SERVICE ACCESS AREA.

Model Technical Specifications																
Model	L"	L1"	L2"	System Circuit Volts			Phs	Freq	Amps ***	Watts	Wires	NEMA Plug	SST	Conv. Rack BTUH	Para. Rack BTUH	Est Wt
CB5282	50.50	52.00	.00	Ambient/Lights (N/A)			1	60	0.70	19	2+G	Leads Single	N/A	N/A	N/A	725
CB7282	70.50	72.00	.00	Ambient/Lights (N/A)			1	60	0.70	26	2+G	Leads Single	N/A	N/A	N/A	975

*** Does not include electric defrost on freezer models.

Regulatory Approvals:

All Models ETL Listed to UL 65



Important Notes:

1) Units are supplied with levelers which must be adjusted during installation to ensure the unit is level and plumb.

⚠ WARNING: This product can expose you to chemicals, including Urethane (Ethyl Carbamate), which are known to the State of California to cause cancer and birth defects or other reproductive harm. For more information go to www.P65Warnings.ca.gov.