

• F2 63"L x 37-3/4"D x 84-3/4"H

Included

- (3) Levels clear glass shelving
- Clear glass front swinging doors
- Digital fahrenheit thermometer
- LED 3500K top & nose lights w/ frosted lens
- One year parts & labor warranty
- Shelving removable and adjustable on 1" centers



Specify	Standard Features	Additional Options
EXTERIOR COLOR	• Powder coated Silversan Black	• Powder coated (stock/non-stock colors)
INTERIOR COLOR	• Powder coated Silversan Black	• Stainless steel
LOWER PANEL COLOR	• Powder coated Silversan Black	• Powder coated (stock/non-stock colors)
REAR EXTERIOR COLOR	• Powder coated Silversan Black	
BASE SUPPORT	• Rail system for shims	
END PANELS	• Full end panel	• Cutaway end panel
SHELVING	• (3) Levels of clear glass, adjustable shelving	
ELECTRICAL CONNECTION	• Electrical leads	
REFRIGERATION	¹ • Remote DX refrigeration	¹ • Remote DX w/thermostat, solenoid & TXV
SENSOR	• None	• CPC discharge air sensor (remote)
MISCELLANEOUS		• Second year parts & labor warranty

Std Notes: 1 - Read important notes for remote options

Option Notes: 1 - Read important notes for remote options

Intended Environment: Type I - Designed to operate in ambient conditions of 75°F with 55% relative humidity unless noted otherwise in system information below.

Zone **Intended Product To Be Displayed**

Warmest Avg Prod Temp ° F

1 Floral products

40

PLAN VIEW

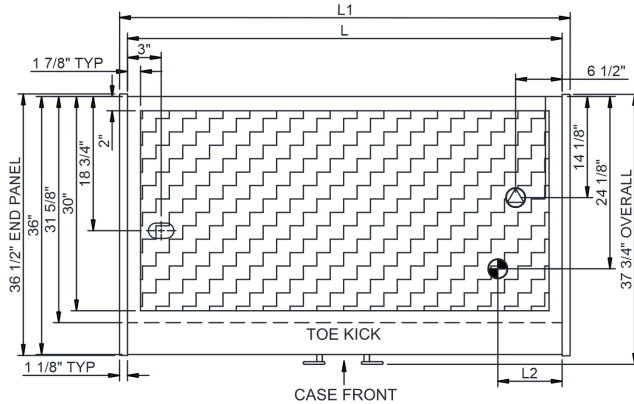

SIDE VIEW

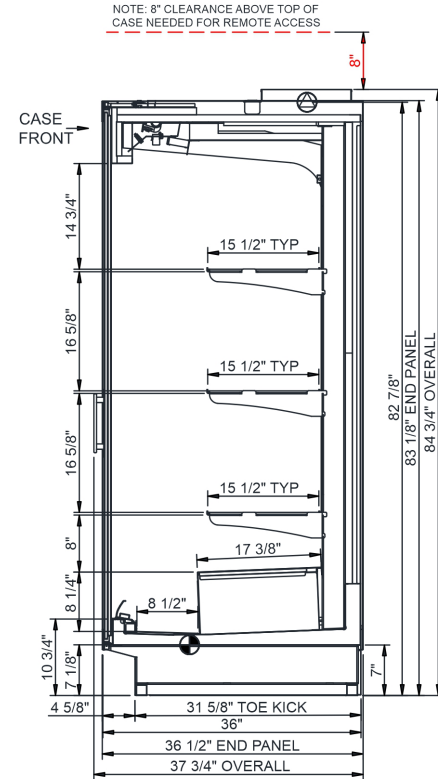

NOTE: ALL DIMENSIONS APPROXIMATE

ELECTRICAL JUNCTION BOX (SUPPLIED WITH 6\"/>

REFRIGERATION LINE CONNECTION.
 REMOTE FLOOR SINK & UTILITIES ACCESS AREA.

SELF-CONTAINED CASE SERVICE ACCESS AREA.
 DRY CASE SERVICE ACCESS AREA.

Model Technical Specifications

Model	L"	L1"	L2"	System Circuit Volts			Phs	Freq	Amps ***	Watts	Wires	NEMA Plug	SST	Conv. Rack BTU/H	Para. Rack BTU/H	Est Wt
F2	60.75	63.00	9.00	Remote (DX)	Circuit #1	110-120	1	60	1.30	52	2+G	Leads Single	26.00	2419	2240	N/A
				Remote (GLYCOL 35%)	Circuit #1	110-120	1	60	1.30	52	2+G	Leads Multiple	26.00	2419	2240	
				Remote (R744 LIQ OVERFE	Circuit #1	110-120	1	60	1.38	62	2+G	Leads Single		2592	2400	
				Remote (R744 TRANSCRIT	Circuit #1	110-120	1	60	1.30	52	2+G	Leads Single		2419	2240	

*** Does not include electric defrost on freezer models.

Regulatory Approvals:

All Models
 Accordance with AHRI Std 1200
 ETL Listed to UL 471
 ETL Listed to CAN/CSA 22.2 No. 120



In Accordance with
AHRI Std 1200

DOE 2017
 Energy Efficiency
 Compliant

Important Notes:

- 1) REMOTE REFRIGERATION NOTE: Condensing unit not included, floor drain required.
- 2) ELECTRICAL NOTE: If GFCI is required, a GFCI breaker MUST be used in lieu of a GFCI receptacle.
- 3) Top electrical access.
- 4) Units must be shimmed during installation to ensure the unit is level and plumb.
- 5) Keep unit at least 15' from exterior doors, 10' from overhead HVAC vents, 5' from exterior windows.
- 6) Performance issues (product temperatures, water on floor, etc) caused by adverse conditions are not covered by warranty.

⚠ WARNING: This product can expose you to chemicals, including Urethane (Ethyl Carbamate), which are known to the State of California to cause cancer and birth defects or other reproductive harm. For more information go to www.P65Warnings.ca.gov.