

REFRIGERATOR MANUFACTURER
Turbo air
 more durable, efficient, beautiful

4184 E. Conant St.
 Long Beach, CA 90808
 Tel. 310-900-1000
 Fax. 310-900-1077
www.turboairinc.com

Project :	
Model # :	
Item # :	Qty :
Available W/H :	
Approval :	

Removable Covers for Mega Top Units

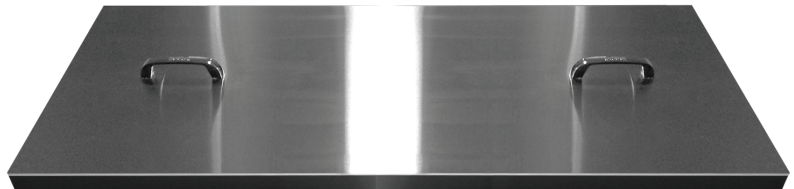

PLAN VIEW

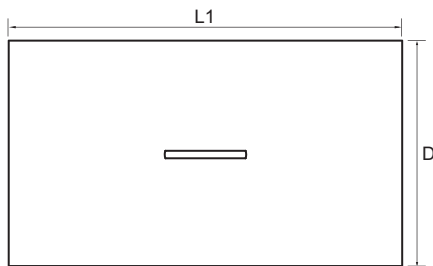

Plan View

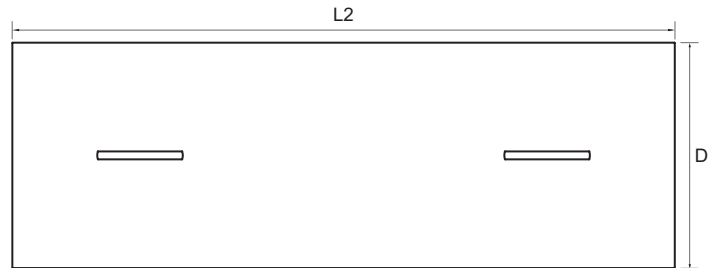

Plan View

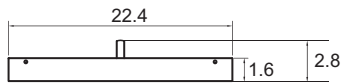

Side View

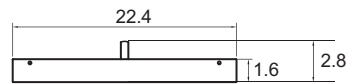

Side View

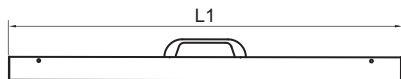

Front View

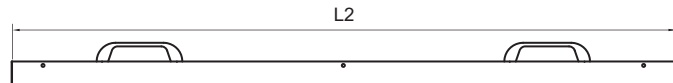

Front View

28"(L) Mega Top	36"(L) Mega Top	48"(L) Mega Top	60"(L) Mega Top	72"(L) Mega Top
Item No. RCT-28-12 (1ea)	Item No. RCT-36-15 (1ea)	Item No. RCT-48-18/72-30-L (1ea)	Item No. RCT-60-24/72-30-R (2ea)	Item No. RCT-48-18/72-30-L (1ea for left) RCT-60-24/72-30-R (1ea for right)
Dimension (Inch) 26.9(L1) x 22.4(D) x 2.8(H)	Dimension 33.3(L2) x 22.4(D) x 2.8(H)	Dimension 39.8(L2) x 22.4(D) x 2.8(H)	Dimension 27(L1) x 22.4(D) x 2.8(H)	Dimension 39.8(L2) x 22.4(D) x 2.8(H) 27(L1) x 22.4(D) x 2.8(H)
Weight (Lbs.) 9.5	Weight (Lbs.) 14.5	Weight (Lbs.) 14.5	Weight (Lbs.) 10.5 (ea)	Weight (Lbs.) 14.5 (left) / 10.5 (right)
Applicable Models PST-28-12-N / MST-28-12-N TST-28SD-12-N TST-48SD-12M-N TST-60SD-12M-N EST-28-12-N6	Applicable Models MST-36-15-N6 TST-36SD-15-N6 TST-72SD-15M-N EST-36-15-N6	Applicable Models PST-48-18-N MST-48-18-N TST-48SD-18-N EST-48-18-N	Applicable Models PST-60-24-N MST-60-24-N TST-60SD-24-N EST-60-24-N6	Applicable Models PST-72-30-N MST-72-30-N TST-72SD-30-N EST-72-30-N