

**Configurable Back Bar Refrigeration**



CBR532-SS



CBR552-SS



CBR572-SS



CBR592-SS



CBR532-SG



CBR552-SG



CBR572-SG



CBR592-SG

Project:	Notes:
----------	--------

**Features**

Convection cooling system provides a quick cool down and consistent temperature
Stainless steel inside and out
Temperature range: 33°F - 70°F
Bright white & blue LED interior lighting
Automatic defrost
Field reversible door(s) with lock(s)
Adjustable coated wire shelves
High efficiency compressor
NSF/ANSI Standard 7 compliant

**Specifications**

Model	CBR532/CBR632	CBR552/CBR652	CBR572/CBR672	CBR592/CBR692
Dimensions	34 9/16" H x 32" W x 24 3/4" D	34 9/16" H x 52" W x 24 3/4" D	34 9/16" H x 72" W x 24 3/4" D	34 9/16" H x 92" W x 24 3/4" D
Internal Volume	6.25 cu ft	12.52 cu ft	19.74 cu ft	28.5 cu ft
Refrigerant	R600a (2.12 oz)	R290 (4.06 oz)	R290 (4.06 oz)	R290 (4.06 oz)
Running Amps	1.7	1.7	2.0	2.0



## Product Specifications Configurable Back Bar Refrigeration

Model Details			
Model	Description	Voltage/Hz	Shipping Weight
UCBR532-SS01A	32" Back Bar, 1 Solid Door, Lock, Condenser Right, 3 Wire Shelves, Solid Top, Stainless Steel	115v / 60hz	302 lb
UCBR552-SS01A	52" Back Bar, 2 Solid Doors, Locks, Condenser Right, 6 Wire Shelves, Solid Top, Stainless Steel	115v / 60hz	382 lb
UCBR572-SS01A	72" Back Bar, 3 Solid Doors, Locks, Condenser Right, 9 Wire Shelves, Solid Top, Stainless Steel	115v / 60hz	496 lb
UCBR592-SS01A	92" Back Bar, 4 Solid Doors, Locks, Condenser Right, 12 Wire Shelves, Solid Top, Stainless Steel	115v / 60hz	542 lb
UCBR532-SG01A	32" Back Bar, 1 Glass Door, Lock, Condenser Right, 3 Wire Shelves, Solid Top, Stainless Steel	115v / 60hz	302 lb
UCBR552-SG01A	52" Back Bar, 2 Glass Doors, Locks, Condenser Right, 6 Wire Shelves, Solid Top, Stainless Steel	115v / 60hz	382 lb
UCBR572-SG01A	72" Back Bar, 3 Glass Doors, Locks, Condenser Right, 9 Wire Shelves, Solid Top, Stainless Steel	115v / 60hz	496 lb
UCBR592-SG01A	92" Back Bar, 4 Glass Doors, Locks, Condenser Right, 12 Wire Shelves, Solid Top, Stainless Steel	115v / 60hz	542 lb
UCBR632-SS01A	32" Back Bar, 1 Solid Door, Lock, Condenser Right, 3 Wire Shelves, 1 Tap & Drain Hole, Stainless Steel	115v / 60hz	302 lb
UCBR652-SS01A	52" Back Bar, 2 Solid Doors, Locks, Condenser Right, 6 Wire Shelves, 1 Tap & Drain Hole, Stainless Steel	115v / 60hz	382 lb
UCBR672-SS01A	72" Back Bar, 3 Solid Doors, Locks, Condenser Right, 9 Wire Shelves, 2 Taps & Drain Holes, Stainless Steel	115v / 60hz	496 lb
UCBR692-SS01A	92" Back Bar, 4 Solid Doors, Locks, Condenser Right, 12 Wire Shelves, 2 Taps & Drain Holes, Stainless Steel	115v / 60hz	542 lb

**Factory build options include:** Condenser on left side, glass & solid door combinations

Accessories		
Model	Description	Shipping Weight
ULACOMLEGS4	4, 6" Adjustable leveling legs for CBR532 & CBR552	10 lb
ULACOMLEGS6	6, 6" Adjustable leveling legs for CBR572 & CBR592	14 lb
ULACOMCASTERS4	4, 6" Casters for CBR532 & CBR552	12 lb
ULACOMCASTERS6	6, 6" Casters for CBR572 & CBR592	17 lb
ULASHELF24	Slide out metal shelf	9 lb
ULAWINERACK24	Slide out wine rack	8 lb
ULABIN24	Slide out bin	9 lb
ULATAPSINGLE	Single Beer Tap Tower Kit	20 lb
ULATAPDOUBLE	Double Beer Tap Tower Kit	24 lb
ULABACKBARCOFFEE2	2 Tap Nitro Coffee Kit	10 lb
ULABACKBARCOFFEE3	3 Tap Nitro Coffee Kit	11 lb
ULABACKBARCOFFEE4	4 Tap Nitro Coffee Kit	12 lb
ULAWINETAP1	Single Tap, Low Profile Coupler, Regulator, & Nitrogen Tank	16 lb
ULAWINETAP2	Double Tap, Low Profile Coupler, Regulator, & Nitrogen Tank	20 lb



# Product Specifications

## Configurable Back Bar Refrigeration

**CBR532**

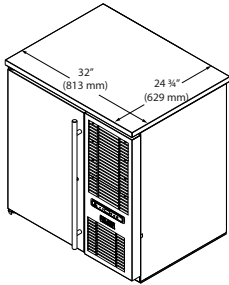

**CBR552**

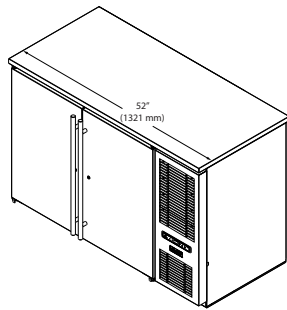

**CBR572**

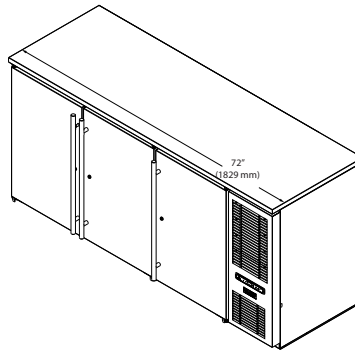

**CBR592**

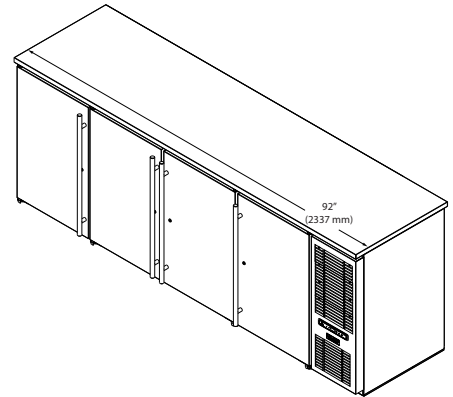

**Side**

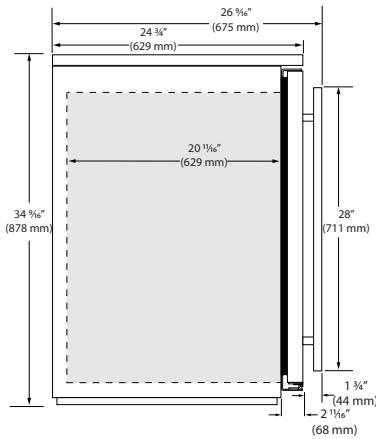

**Front**

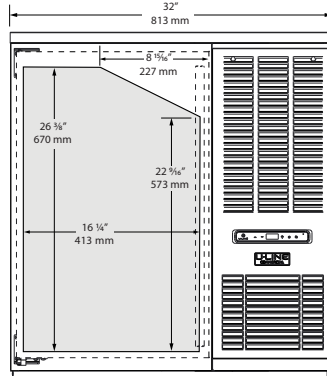

**Top**

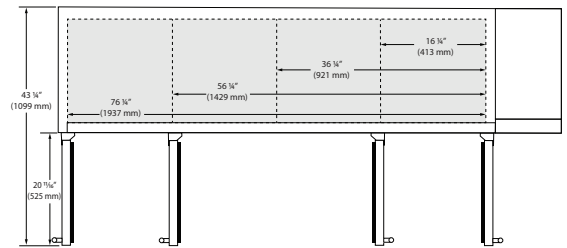

**Tower 2 3/4" (70 mm)/Drain 1" (25 mm) Location**

**Back Panel**

**CBR672**

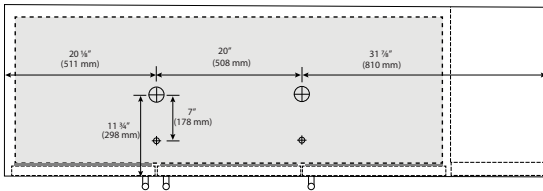

**CBR652**

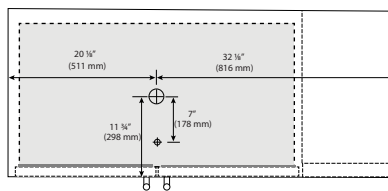

**CBR692**

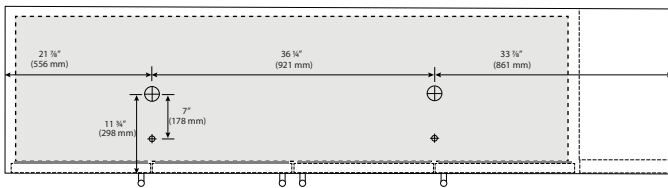

**CBR632**

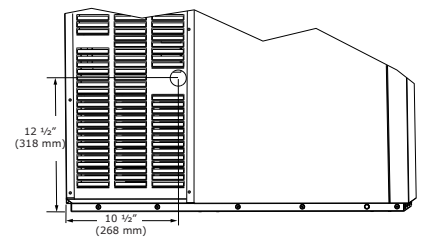
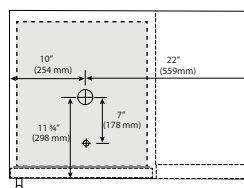

**Commercial Warranty**

1 Year (parts & labor) / 5 year sealed system (parts)  
See complete warranty for details

**Notes**

- Dimensions/image shown are for refrigeration unit on right