

HOLDING & TRANSPORT**VULCAN****VCD22
FIRST-IN FIRST-OUT CHIP WARMERS**

Model VCD22

**SPECIFICATIONS**

First-in First-out chip warming cabinet, Vulcan-Hart Model No. VCD22. Heavy duty 20 gauge polished stainless steel cabinet with tubular steel inner frame for increased durability. 1" legs. One-piece doors. Magnetic door latch with 90 degree stopping mechanism. Removable heating module (with fan) for easy cleaning. Illuminated on/off switch. Thermostat factory preset to 180F. Capacity 17.5 pounds / 22 gallons. One 1250 watt (10.5 amp) heating element. Requires 120 volt, 60 Hz, single phase power supply. 6' power cord with NEMA 5-15 plug.

Exterior Dimensions:24 $\frac{1}{4}$ "w x 27 $\frac{3}{4}$ "d x 20 $\frac{3}{4}$ "h

UL listed. UL listed to Canadian safety standards, Classified by UL to NSF Std. #4.

STANDARD FEATURES

- Heavy duty 20 gauge polished stainless steel cabinet.
- 1" legs.
- Magnetic door latch with 90 degree stopping mechanism.
- Removable heating module (with fan) for easy cleaning.
- One-piece doors.
- Illuminated on/off switch.
- Thermostat factory preset to 180°F.
- Capacity 17.5 pounds / 22 gallons.
- One 1250 watt (10.5 amp) heating element.
- Requires 120 volt, 60 Hz, single phase power supply. Furnished with 6' power cord with NEMA 5-15 plug.
- Lifetime warranty on heating element.
- One year limited parts and labor warranty.

OPTIONS

- Two year extended limited parts and labor warranty.

VULCAN

a division of ITW Food Equipment Group LLC

P.O. Box 696 ■ Louisville, KY 40201 ■ Toll-free: 1-800-814-2028 ■ Local: 502-778-2791 ■ Quote & Order Fax: 1-800-444-0602



VCD22
FIRST-IN FIRST-OUT CHIP WARMERS

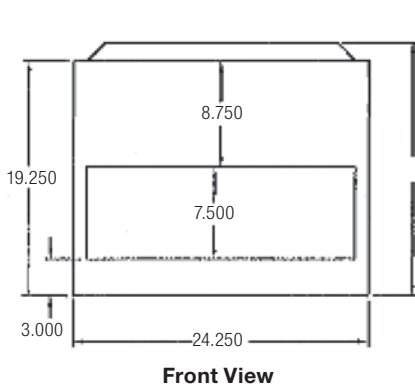

Front View

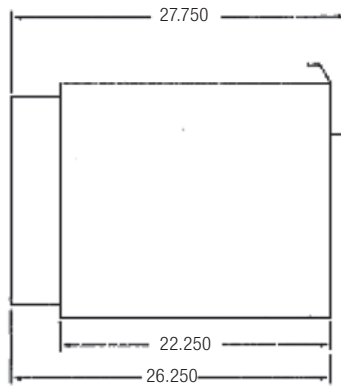

Side View

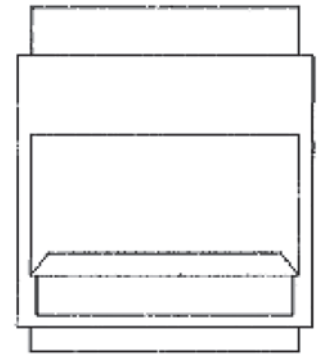

Top View

Model	Capacity	High	Deep	Wide	Shipping Weight	Volts	Watts	Amps
VCD22	22 gallon	20 ³ / ₄ "	27 ³ / ₄ "	24 ¹ / ₄ "	115 lbs.	120	1250	10.5

This appliance is manufactured for commercial use only and is not intended for home use.



a division of ITW Food Equipment Group LLC

P.O. Box 696 ■ Louisville, KY 40201 ■ Toll-free: 1-800-814-2028 ■ Local: 502-778-2791 ■ Quote & Order Fax: 1-800-444-0602