

# BUNN®

## Fresh Mix Dispenser with 4 or 5 Hoppers

ITEM#

PROJECT

DATE

### Features

#### Fresh Mix Dispensers with 4 and 5 Hoppers

- Capacity: FMD-4: One, 8-pound hopper; three, 4-pound hoppers  
FMD-5: Five, 4-pound hoppers
- Large, lighted front graphics for merchandising
- 6.4 gallon (24.2 liters) hot water tank to meet peak serving times
- Cup clearance at 7" (17.8 cm) to accommodate common cup sizes
- Electrical and plumbing components easily accessible through front and top
- Variable speed motors allow control of product consistency in mixing chamber (.75 to 6.6 grams of powder per second)
- High speed, heavy-duty whipper for complete product mixing
- Front of machine access to tank drain for easy service
- Key lock on the door prevents tampering



#### FMD-4

Dimensions: 29.3"H x 18.6"W x 21.2"D  
(74.4 cm H x 47.2 cm W x 53.8 cm D)



#### FMD-5

Dimensions: 29.3"H x 18.6"W x 21.2"D  
(74.4 cm H x 47.2 cm W x 53.8 cm D)

For current specification sheets and other information, go to [www.bunn.com](http://www.bunn.com).

### Related Products

#### Easy Clear® EQ-11-TL

Product No. : 30344.1001  
Dimensions:  
15<sup>7</sup>/<sub>8</sub>" H x 3<sup>3</sup>/<sub>8</sub>" W x 4<sup>17</sup>/<sub>32</sub>" D  
40.3cm H x 9.2cm W x 11.5cm D

#### Easy Clear® ED-11-TL

Product No. : 30244.1001  
Dimensions:  
14<sup>3</sup>/<sub>16</sub>" H x 5<sup>1</sup>/<sub>16</sub>" W x 5<sup>1</sup>/<sub>16</sub>" D  
36cm H x 12.9cm W x 12.9cm D



#### Features deluxe whipper chambers:

1. Robust whipper to ensure full flavor yield.
2. Specially designed self cleaning mixing chamber.
3. Exhaust fan to siphon off moisture that can cause powder buildup.
4. Hot water dispense for easy clean-out.
5. Quick disconnecting parts for thorough sanitizing.

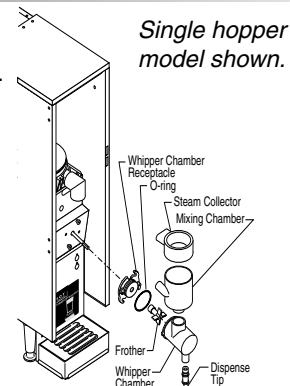

Single hopper model shown.

Model	Agency Listing	International Model	Agency Listing
FMD-4	NSF, UL	No International Model	
FMD-5	NSF, UL		

Patents Apply

11/04

D5

## Dimensions & Specifications

Model	Product #	Volts	Amps	Tank Heater Watts	Total Watts	Capacity	Cu. Ft.	Shipping Weight	Cord Attached
FMD-4	34900.0002	120	15	1700	1800	4.2 gal/hr.**	11.3	118 lbs.	Yes*
FMD-5	34900.0000	120	15	1700	1800	4.2 gal/hr.**	11	123 lbs.	Yes*

\*Power cord (NEMA 5-15P) 15 Amp-120V machine only. \*\*Based on incoming water temperature of 50°F.

Electrical: 120V model requires 2-wires plus ground service rated 120V, single phase, 60 hz. 120/240V model requires 3-wires plus ground service rated 120/208 or 120/240V, single phase, 60Hz.

Plumbing: 20-100 psi (138-690 kPa) from a 3/8" (10 mm) or larger supply line. A shut-off valve should be installed in the line before the unit. Install a regulator in line when pressure is greater than 90 psi to reduce it to 50 psi. Supplied with 3/8" (10 mm) male flare fitting.

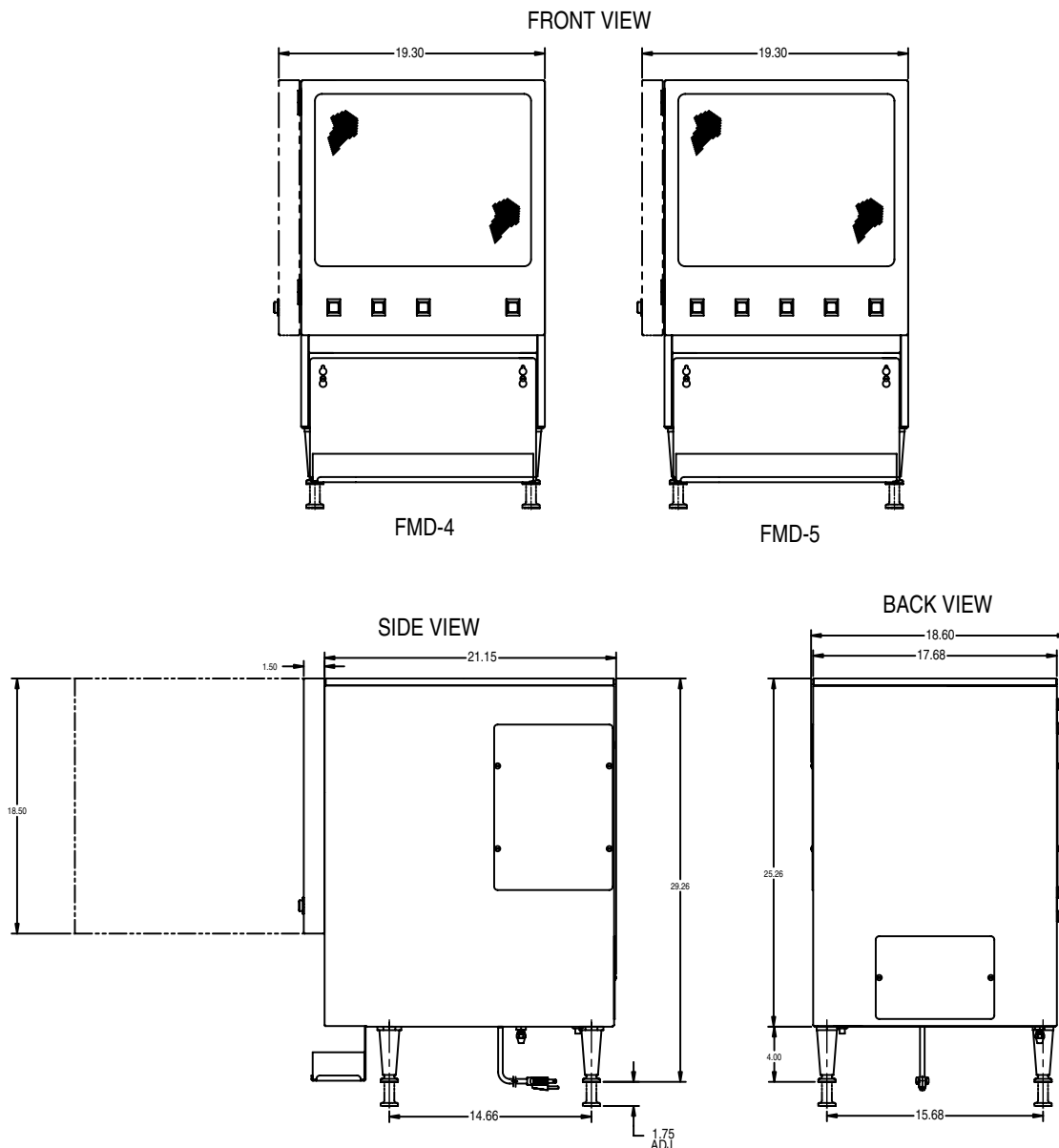

BUNN Corporation - 1400 Stevenson Drive Springfield, Illinois 62703 • 800-637-8606 • 217-529-6601 • Fax 217-529-6644 • [www.bunn.com](http://www.bunn.com)

BUNN® practices continuous product research and improvement. We reserve the right to change specifications and product design without notice. Such revisions do not entitle the buyer to corresponding changes, improvements, additions or replacements for previously purchased equipment.

All dimensions shown in inches. Bunn Corporation owns all copyrights relating to materials in this publication. Please contact Bunn Corporation to request permission to reproduce any portion of this publication.